

LEAD MATERIAL
18 GA, 125°C 2/64 INSUL.
X-LINKED POLY, (1) BLACK,
(1) WHITE, (1) BLUE, (1) RED
13.00/11.00 [330.20/279.40]
WITH .56/.44 [14.22/11.18] STRIP

GROUND LEAD MATERIAL, GRN/YEL
13.00/11.00 [330.20/279.40]
W/RING TERM.
AMP 350436-2

- NOTES:
1. MOTORS HAS 416 S.S. SHAFT.
2. NO PACKING TAPE OVER CARTON LABEL.

SAFETY WARNING
This motor must be grounded in accordance with local or national electrical codes to prevent possible injury due to electrical shock



AVERTISSEMENT DE SECURITE
Ce moteur doit être fondée sur conformément à la réglementation locale ou national électrique codes pour prévenir d'éventuelles blessures en raison de choc électrique

FASCO Fasco Industries, Inc. Motor Division

Assembled in Mexico
No. 71732175 TYPE U73B1 T.P. AO
115 V 60Hz Class B
1.5 A 1550 RPM
Model D535 E40513
Sealed Ball Brg
Reference 1/25 HP
Three-Speed Max Amb 40°C



Connection Diagram
Wht — Common
Blk — High
Blu — Med
Red — Low
Grn/Yel — Grd

CUSTOMER:	FASCO DIST.	APPLICATION:	COUNTER SALES								
CUSTOMER PN:	D535	MOTOR WEIGHT:	-								
	UP	ENVIRONMENT:	DAMP								
		MOTOR TYPE	REFERENCE SAMPLE								
		SHADED POLE	X-0006510-2								
		B LA FR A S C	E B A								
		00 73 30 V 07 PJ	7 0 0								
TYPICAL PERFORMANCE AT 115 VOLTS 60 HZ											
	IDLE			LOADED			LOCKED			BREAK	
MOTOR SPEED	RPM	AMP	WATT	IN OZ	RPM	AMP	WATT	IN OZ	AMP	WATT	IN OZ
1794	1.26	71	35.9	1550	1.56	112	15.6	2.18	143	37.8	
1753	.91	54	25.6	1550	1.10	81	10.7	1.51	102	26.9	
1750	.76	46	21.1	1550	.91	67	8.8	1.23	84	22.0	

61305568

00464537

00469111

61299553

DRAWING REVISION CB	REVISION BY BWB	DATE 9/20/2018	TOLERANCES UNLESS OTHERWISE SPECIFIED: DEC. INCH mm ANGLE .X ±0.1 [±2.5] ±1° .XX ±0.01 [±0.25] .XXX ±0.005 [±0.127] .XXXX ±0.0005 [±0.0127] REMOVE BURRS & BREAK SHARP EDGES. .003/.015 [0.076/.381] X 45° CORNER FILLETS: R.02 [.51] MACHINED SURFACES: 125/32 INCH/mly mm SHOWN IN [BRACKETS]	DRAWN BY BWB	DATE 9/20/2018	DESCRIPTION REGAL Regal Beloit America, Inc.
ECO ECO-0153028	APPROVED BY MLS	DATE 9/20/2018	ADD PAINT COLOR COPYRIGHT REGAL BELOIT AMERICA, INC. ALL RIGHTS RESERVED. PROPRIETARY AND CONFIDENTIAL INFORMATION. THIS DOCUMENT IS THE PROPERTY OF REGAL BELOIT AMERICA, INC. FORMER AND CONTAINING OWNERS PROPRIETARY INFORMATION. ANY PERSON, CORPORATION OR OTHER FIRM RECEIVING IT IS DEEMED BY RECEIVING IT, TO AGREE THAT IT, AND/OR ANY PART OF IT, SHALL NOT BE DISCLOSED TO ANY PERSON, CORPORATION OR OTHER ENTITY, DUPLICATED, AND/OR USED, EXCEPT AS EXPRESSLY APPROVED IN ADVANCE BY OWNER. THIS DOCUMENT SHALL BE RETURNED TO OWNER UPON REQUEST. IT MAY BE SUBJECT TO CERTAIN RESTRICTIONS UNDER APPLICABLE EXPORT CONTROL LAWS AND REGULATIONS.	APPROVED BY MLS	DATE 9/20/2018	REFERENCE THIRD ANGLE PROJECTION
MATERIAL			SIZE C	DRAWING NUMBER 71732175	PROCESS/FINISH BLACK	SHEET 1 OF 2

NOTES:

1. STAKE STATOR TO MAIN FRAME PER 88830264.
2. MAXIMUM TORQUE REQUIRED TO TURN MOTOR SHAFT IS 3/8 INCH-OUNCE.
3. ASSEMBLE SPRING BETWEEN WASHER AND BEARING ON FRONT END WITH SPRING FINGERS TOWARD BEARING.
4. ASSEMBLE BEARING CUSHION SQUARELY AND TO THE BOTTOM OF EACH BEARING RETAINER. ASSEMBLE PC 287 WASHER SQUARELY AND IN THE BOTTOM OF EACH BEARING CUSHION.

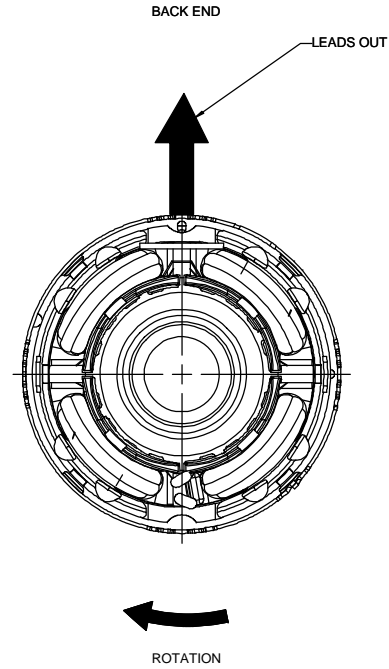
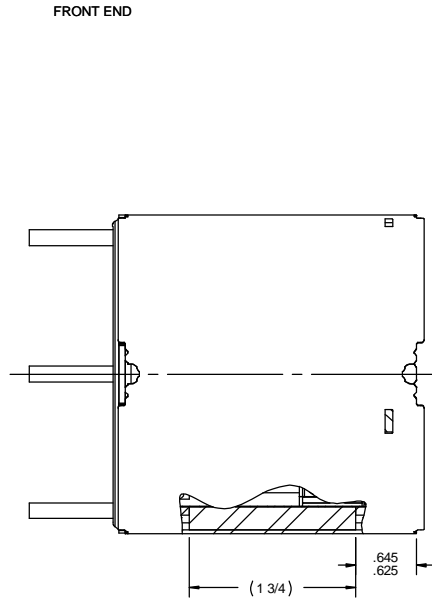

PACKING SPECIFICATIONS

1. PACK PER 88834200: 1 PER CONTAINER, 40 PER LAYER, 6 LAYER per pallet, 240 MAX. PER PALLET.
2. PLACE FILLER FOAM RING ON END OF MOTOR & FILLER TUBE ON SHAFT EXTENSION END, PLACE MOTOR IN CARTON, LEADS DOWN, CLOSE FLAPS AND TAPE.
3. CARTON LABELS MUST ALL FACE ONE DIRECTION TOWARD OPEN END OF PALLET. SEE 88834408.
4. NO PACKING TAPE OVER CARTON LABEL.
5. PLACE FLAT PAD ON PALLET, (1) BETWEEN EACH LAYER, & (1) ON TOP LAYER OF CARTON. PLACE ALL INSPECTION AND WRITING ON THE TOP FLAT OF PAD TO PREVENT MARKING ON CARTONS, PRIOR TO stretch wrap

DRAWING REVISION CB		REVISION BY BWB	DATE 9/20/2018	TOLERANCES UNLESS OTHERWISE SPECIFIED: DEC. INCH mm ANGLE		DRAWN BY BWB		Regal Beloit America, Inc.
ECO-0153028		APPROVED BY MLS	DATE 9/20/2018	.X ±0.1 [±2.5] 1°	.XX ±0.01 [±0.25]	DATE 9/20/2018	DESCRIPTION OUTLINE	
ECO DESCRIPTION		ADD PAINT COLOR		.XXX ±0.005 [±0.127]	.XXXX ±0.0005 [±0.0127]	DATE 9/20/2018	MATERIAL	PROCESS/FINISH BLACK
<small> COPYRIGHT REGAL BELOIT AMERICA, INC. ALL RIGHTS RESERVED. PROPRIETARY AND CONFIDENTIAL INFORMATION. THIS DOCUMENT IS THE PROPERTY OF REGAL BELOIT AMERICA, INC. FORMERLY AND CONTAINS OWNERS PROPRIETARY INFORMATION. ANY PERSON, CORPORATION OR OTHER FIRM RECEIVING IT IS DEEMED BY RECEIVING IT, TO AGREE THAT IT, AND/OR ANY PART OF IT, SHALL NOT BE DISCLOSED TO ANY PERSON, CORPORATION OR OTHER ENTITY, DUPLICATED, AND/OR USED, EXCEPT AS EXPRESSLY APPROVED IN WRITING IN ADVANCE BY OWNER. THIS DOCUMENT SHALL BE RETURNED TO OWNER UPON REQUEST. IT MAY BE SUBJECT TO CERTAIN RESTRICTIONS UNDER APPLICABLE EXPORT CONTROL LAWS AND REGULATIONS. </small>				REMOVE BURRS & BREAK SHARP EDGES: .0031 .015 [078/381] X 45° CORNER FILLETS: R.02 [51]		REFERENCE	SIZE C	DRAWING NUMBER 71732175
				MACHINED SURFACES: .125/ 3.2 INCH/ mm SHOWN IN [BRACKETS]		THIRD ANGLE PROJECTION		SHEET 2 OF 2