

25	CHANGED N/P FORMAT, ADDED PC. NUMBERS	BP 02/05/2008	26	REMOVED BARCODE FROM N/P, ADDED CSA NUMBER TO NAMEPLATE	BP 08/02/2010	27	ADDED FLAT LENGTH TO PRINT	4011377	BP 1/24/2014	STANDARD TOLERANCES: ANGULAR +/- 1 DEGREE 2 PLACE DECIMAL +/- .01 3 PLACE DECIMAL +/- .005
----	---------------------------------------	---------------	----	---	---------------	----	----------------------------	---------	--------------	---

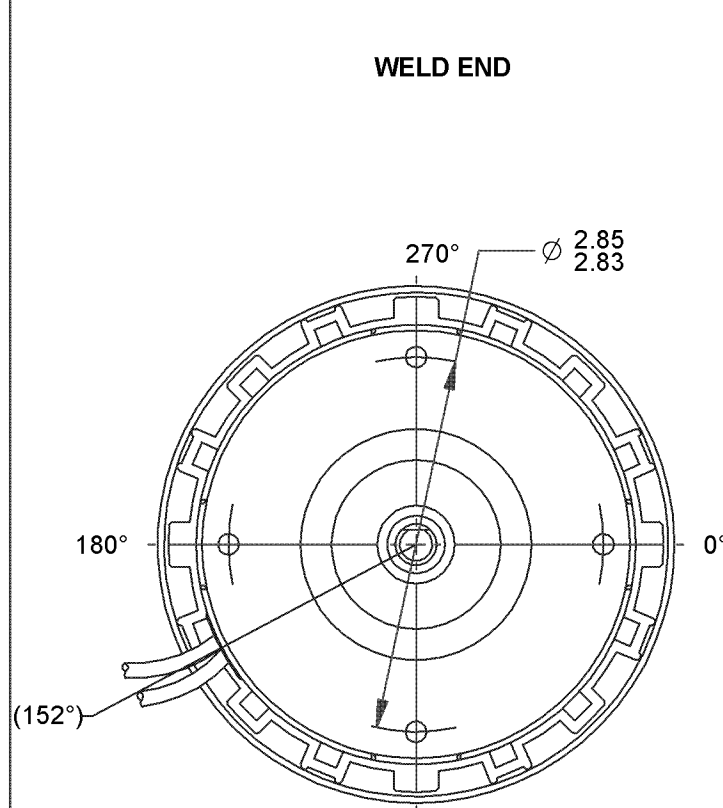

LEAD MATERIAL  
18 GA., 2/64 INSUL., 125°C,  
X-LINKED POLY.,  
(2) BLACK,  
14.00/12.00 IN. LONG  
.56/.44 IN. STRIP

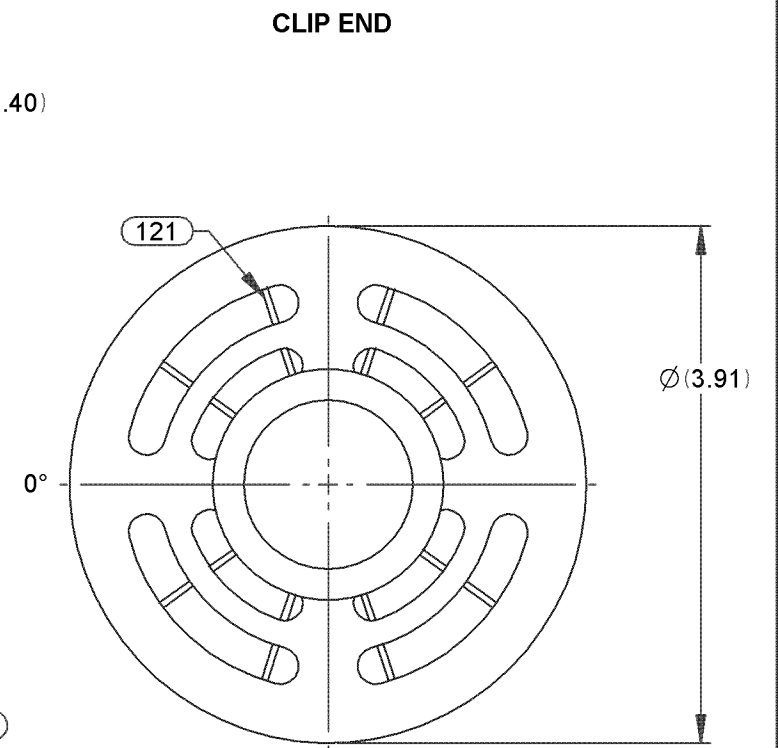
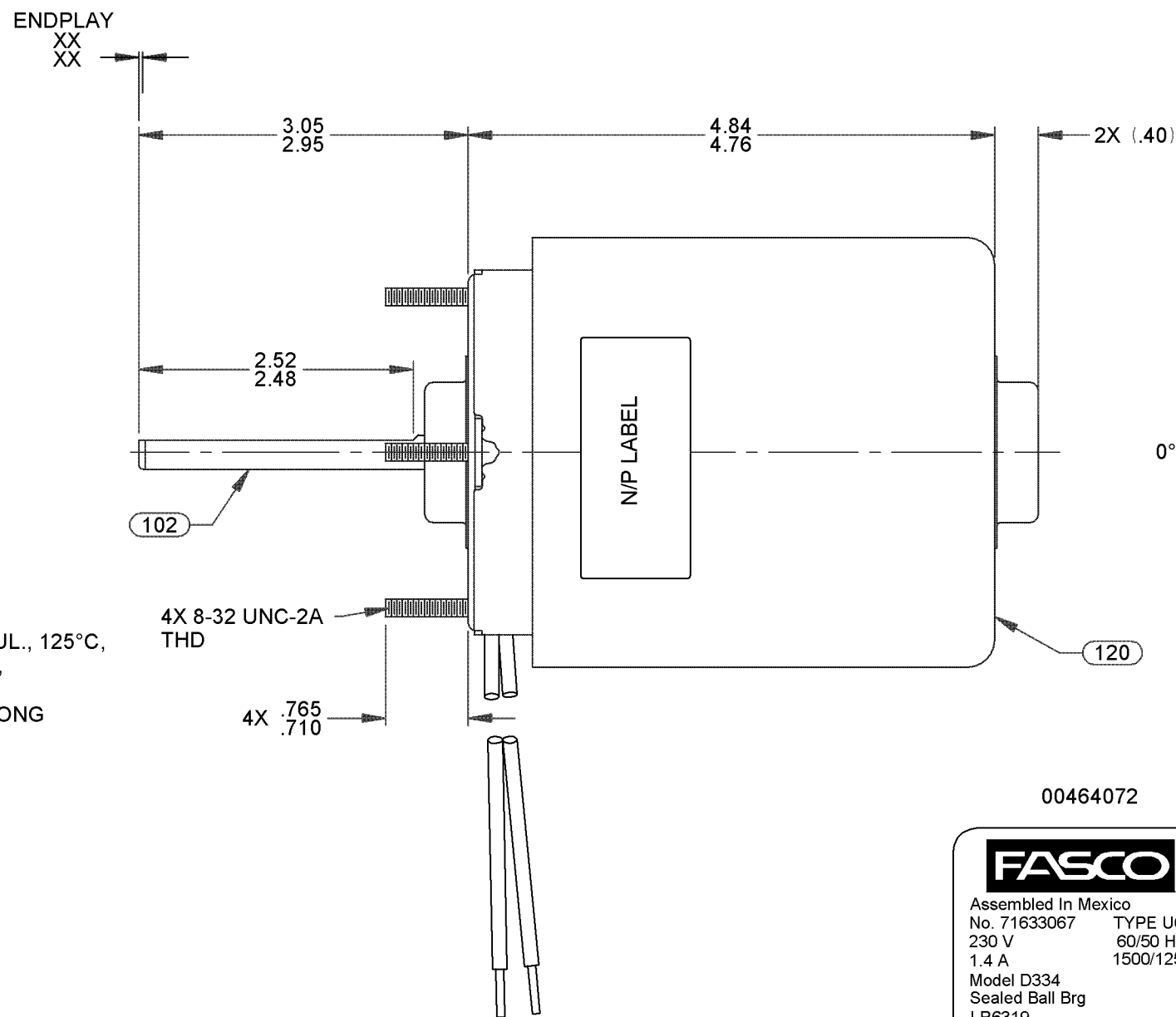

NOTES:

1. PACK 168 MAX. MOTORS PER PALLET.
2. NO PACKING TAPE OVER CARTON LABEL.
3. CARTON LABELS MUST ALL FACE ONE DIRECTION TOWARD THE OPEN END OF THE PALLET. SEE P.S. 88834408.

00464072

00464282

**FASCO** Fasco Industries, Inc  
Motor Division

Assembled In Mexico

No. 71633067	TYPE U63B1	T.P. TEAO
230 V	60/50 Hz	Class B
1.4 A	1500/1250 RPM	1/15 HP
Model D334		Max Amb: 40° C
Sealed Ball Brg		
LR6319		

**SAFETY WARNING**

This Motor Must Be Grounded in Accordance With Local Or National Electrical Codes To Prevent Possible Injury Due To Electrical Shock

61299553

<b>FRONT SHAFT POSITION</b>	<b>* TYPICAL PERFORMANCE AT 230 VOLTS 60 Hz.</b>												<b>CUSTOMER:</b> FASCO DIST.	<b>FASCO</b> FASCO MOTORS GROUP AC MOTOR/BLOWER DIVISION									
<b>HORIZONTAL</b>  <b>DOWN</b>	<b>MOTOR SPEED</b>	<b>IDLE</b>			<b>LOADED</b>			<b>LOCKED</b>			<b>BREAK</b>	<b>PART NUMBER:</b> D334	<b>CONFIDENTIAL:</b> DO NOT DUPLICATE OR DISCLOSE TO THIRD PARTIES WITHOUT WRITTEN PERMISSION OF FASCO MOTORS GROUP, AC MOTOR/BLOWER DIVISION.										
		R.P.M.	AMP.	WATT	IN.OZ.	R.P.M.	AMP.	WATT	IN.OZ.	AMP.	WATT	IN.OZ.		<b>APPLICATION:</b> COUNTER SALES									
		1780	.84	90	50.0	1580	1.08	155	15.0	1.53	212	54.0	<b>MOTOR WEIGHT:</b> 5.69 LBS.	<b>MOTOR TYPE</b>	<b>DRAWING NUMBER</b>								
<b>CUSTOMER APPROVAL:</b>													<b>ENVIRONMENT:</b> DRY	<b>SHADED POLE</b>	<b>7163 3067</b>								
<b>SIGNED:</b>													<b>FINISH COLOR:</b> BLACK	<b>B</b>	<b>LA</b>	<b>FR</b>	<b>A</b>	<b>S</b>	<b>C</b>	<b>E</b>	<b>B</b>	<b>A</b>	<b>REV.</b>
<b>DATE:</b>													<b>DRAWN BY:</b> S PHINNEY	00	63	28	T	08	OE	5	0	0	<b>27</b>
													<b>DATE DRAWN:</b> MAY 07, 2002										