

OPPOSITE LEAD END

LEAD END

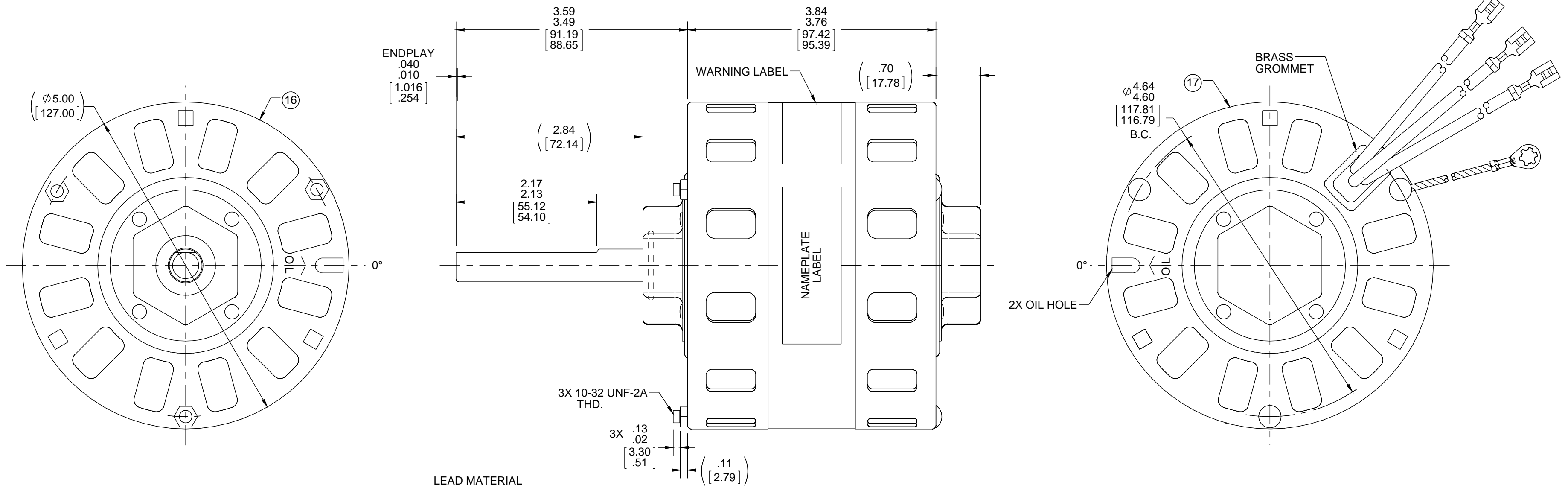

LEAD MATERIAL  
18 GA. 125°C 4/64 INSUL.  
EDPM. WHITE, BLACK,  
AND RED  
19.00/17.00 [482.60/431.80]  
W/ FSPADE TERMS. 89039169  
AMP 42692-2

GROUND LEAD MATERIAL  
18 GA. 105°C 2/64 INSUL.  
THERMO. GRN/YEL  
7.00/6.00 [177.80/152.40]  
W/ RING TERM. 89020157  
AMP 350436-2

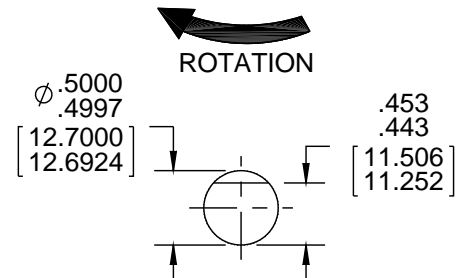

- NOTES:
1. THRU AIR SPACING BETWEEN WIRE AND METAL .10 [2.54] MIN.
  2. SHAFT IS BONDERIZED.
  3. FOR WASHER SET-UP, SEE CHART C6000279, DETAIL H".
  4. ROTOR FREENESS TO BE WITHIN 1 OZ.IN. TORQUE.
  5. TIE BOLT TORQUE TOLERANCE 7-12 IN.LBS.
  6. PLACE PAMPHLET, 61224579, IN CARTON WITH MOTOR.
  7. PACK 1 MOTOR PER CONTAINER, 32 MOTORS PER LAYER, 6 LAYERS PER PALLET, 192 MAX. PER PALLET.
  8. SEE PACKAGING MANUAL PAGE 2 FOR PACKAGING PROCEDURE.
  9. CENTER LABEL, 61196039, ON END OF CARTON.
  10. CARTON LABELS MUST ALL FACE ONE DIRECTION TOWARD THE OPEN END OF THE PALLET. SEE 88834408.
  11. NO PACKING TAPE OVER CARTON LABEL.
  12. SEE DRAWING 87856079 SHEET 1 FOR PALLET LAYOUT.

61035568

**SAFETY WARNING**  
This motor must be grounded in accordance with local or national electrical codes to prevent possible injury due to electrical shock

**AVERTISSEMENT DE SÉCURITÉ**  
Ce moteur doit être fondée sur conformément à la réglementation locale ou nationale électrique codes pour prévenir d'éventuelles blessures en raison de choc électrique

00464072

00464551

Fasco Industries, Inc. Motor Division

Assembled In Mexico

No. 71510189 Type U51  
230 V 60 Hz  
2.1-1.8 A 1050 RPM  
Model D316 Thermally Protected

AO LR6319 FH1  
1/8-1/10 HP (2 SPD)

Connection Diagram:  
White — Line  
Black-H — Line  
Red-LO — Line

61299553

CUSTOMER:	FASCO DIST.	APPLICATION:		HI-POT TEST 2000 VOLTS MAX. LEAKAGE CURRENT 5mA				
CUSTOMER PN:	D316	MOTOR WEIGHT:	8 LBS.					
		ENVIRONMENT:	DRY					
MOTOR TYPE		REFERENCE SAMPLE						
SHADED POLE								
B	LA	FR	A	S	C	E	B	A
00	51	10	V	06	EF	6	8	0
TYPICAL PERFORMANCE AT 230 VOLTS 60 HZ					PH 1 1/10 HP			
MOTOR SPEED	IDLE		LOADED			LOCKED		BREAK
	RPM	AMP	WATT	IN OZ	RPM	AMP	WATT	IN OZ
HIGH	1178	1.73	181	125	1050	2.0	270	49
LOW	1178	1.49	155	107	1050	1.7	232	42

PRODUCTION TEST AT IDLE		MOTOR SPEED
230 VOLTS 60 Hz		
AMP	WATT	
1.90 - 1.56	199.1 - 162.9	HIGH
1.64 - 1.34	170.5 - 139.5	LOW

DRAWING REVISION Y	REVISION BY SDM	DATE 6/28/2016	TOLERANCES UNLESS OTHERWISE SPECIFIED: DEC. INCH mm ANGLE .X ±0.1 [±2.5] ±1° .XX ±0.01 [±0.25] .XXX ±0.005 [±0.127] .XXXX ±0.0005 [±0.0127]	DRAWN BY SDM	DATE 6/28/2016	REGAL Regal Beloit America, Inc.
ECO-0104693	APPROVED BY SED	DATE 6/28/2016	REMOVE BURRS & BREAK SHARP EDGES: .003/.015 [0.076/.381] X 45° CORNER FILLETS: R.02 [0.51] MACHINED SURFACES: 125/ INCH 3.2/ mm	APPROVED BY SED	DATE 6/28/2016	DESCRIPTION MOTOR ASSY
THIRD ANGLE PROJECTION			SIZE C	DRAWING NUMBER 71510189	PROCESS/FINISH GRAY	SHEET 1 OF 1