

ORACLE PART REV. 035

NOTES:

1. MAXIMUM TORQUE REQUIRED TO TURN MOTOR SHAFT IS 3/8 INCH-OUNCE.
2. MAKE-UP WASHERS ARE TO BE ADDED OR DELETED TO ACHIEVE REQUIRED ENDPLAY.
3. ASSEMBLE GROUND STRAP TO COOLING CASE AND BASE BRACKET BY DRILLING A PILOT HOLE WITH A #27 DRILL .353/.293 [8.966/7.442] DEEP AT CENTER OF DRILL. ATTACH GROUND LEAD AND COOLING CASE WITH A SCREW AT LOCATION SHOWN. TURN TERMINALS SO THERE WIL BE NO SLACK IN GROUND STRAP. TORQUE MOUNTING SCREWS TO 5-10 IN. LBS.
4. SEE ROTOR/SHAFT DRAWING FOR WASHER SET UP.

WELD END

CLIP END

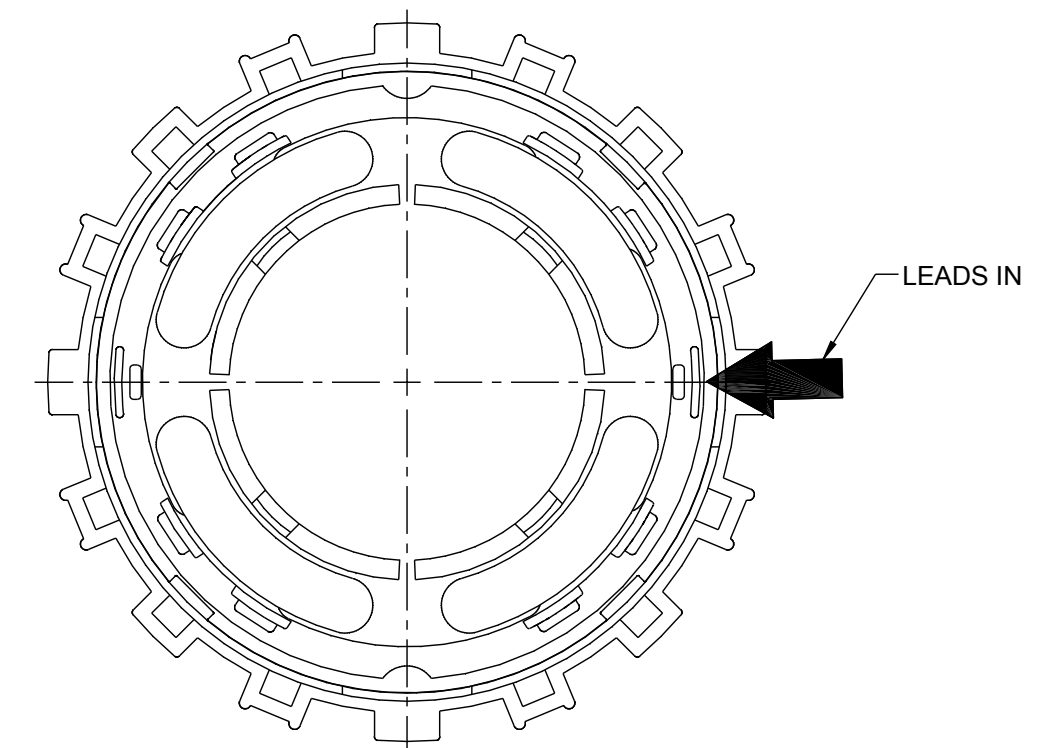
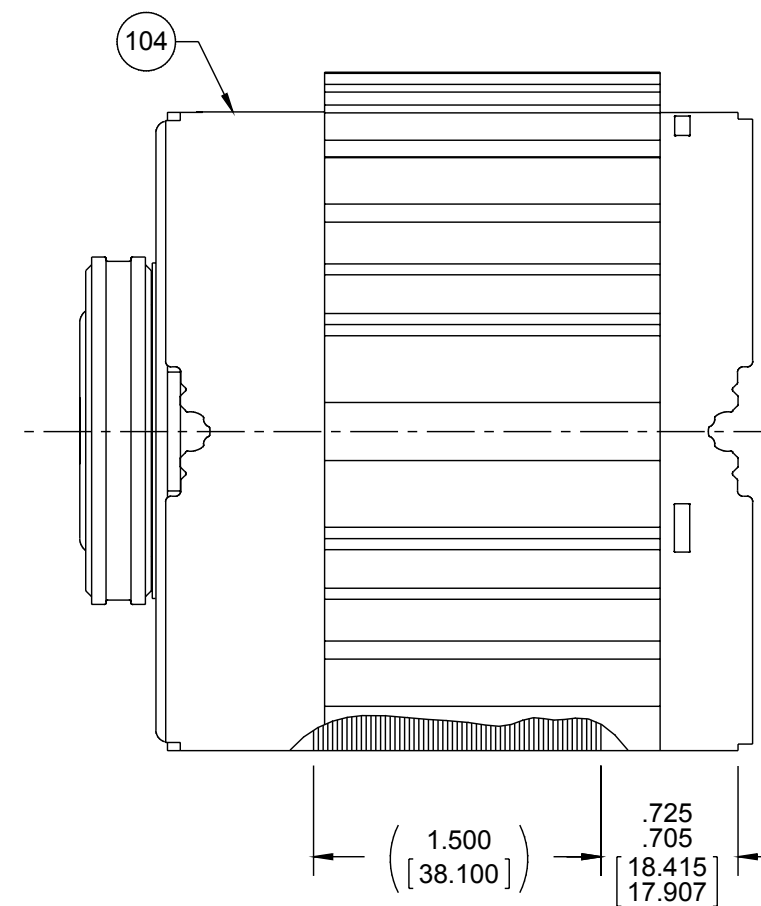

BLAST COOLED SPECIFICATIONS

1. FAN INSIDE COOLING CASE MUST TRACK WITHIN .035 [.889] AND HAVE .10 [.25] MIN. CLEARANCE TO BEARING BOSS AFTER PRESS ON OPERATION.
2. DIMENSION OVER ENDPLATES TO BE 3.24/3.20 [82.30/81.28].

PACKING SPECIFICATIONS

1. PACK PER P.S. 88834200. 1 PER CARTON, 25 PER LAYER, 6 LAYERS PER PALLET, 150 MAX. AMT. PER PALLET.
2. PLACE FILLER TUBE OVER SHAFT EXTENSION, PLACE MOTOR IN CARTON, CLOSE FLAPS AND TAPE. PLACE CARTON LABEL ON SHAFT END OF CARTON.
3. PLACE (1) FLAT PAD ON PALLET, (1) BETWEEN EACH LAYER AND (1) ON TOP. PLACE CARTONS ON PALLET WITH LABELED END OUT AND VISIBLE FOR STORAGE. PLACE ALL INSPECTION STICKERS AND WRITING ON TOP FLAT PAD.
4. CARTON LABELS MUST ALL FACE ONE DIRECTION TOWARD THE OPEN END OF THE PALLET. SEE P.S. 88834408.

DRAWING REVISION AT	REVISION BY KSA	DATE 8/5/2015	TOLERANCES UNLESS OTHERWISE SPECIFIED:		DRAWN BY KSA	REGAL TM Regal Beloit America, Inc.	
ECO ECO-0074037	APPROVED BY MLS	DATE 8/5/2015	DEC.	INCH	mm	ANGLE	DATE 8/5/2015
ECO DESCRIPTION REMOVE NOTE 2 FROM BLAST COOLED SPEC.			.X	±0.1	[±2.5]	±1°	APPROVED BY MLS
<small>COPYRIGHT REGAL BELOIT AMERICA, INC. ALL RIGHTS RESERVED. PROPRIETARY AND CONFIDENTIAL INFORMATION - THIS DOCUMENT IS THE PROPERTY OF REGAL BELOIT AMERICA, INC. (OWNER) AND CONTAINS OWNER'S PROPRIETARY INFORMATION. ANY PERSON, CORPORATION OR OTHER FIRM RECEIVING IT IS DEEMED, BY RECEIVING IT, TO AGREE THAT IT, AND/OR ANY PART OF IT, SHALL NOT BE DISCLOSED TO ANY PERSON, CORPORATION OR OTHER ENTITY, DUPLICATED, AND/OR USED, EXCEPT AS EXPRESSLY APPROVED IN WRITING IN ADVANCE BY OWNER. THIS DOCUMENT SHALL BE RETURNED TO OWNER UPON REQUEST. IT MAY BE SUBJECT TO CERTAIN RESTRICTIONS UNDER APPLICABLE EXPORT CONTROL LAWS AND REGULATIONS.</small>			.XX	±0.01	[±0.25]		DATE 8/5/2015
			.XXX	+0.005	[±0.127]		REFERENCE
			.XXXX	+0.0005	[±0.0127]		MATERIAL
			REMOVE BURRS & BREAK SHARP EDGES: .003/.015 [.076/.381] X 45° CORNER FILLETS: R.02 [.51]				PROCESS/FINISH BLACK
			MACHINED SURFACES: 125/3.2 INCH √ mm √				THIRD ANGLE PROJECTION
			mm SHOWN IN [BRACKETS]				SIZE C
							DRAWING NUMBER 71632129
							SHEET 2 OF 2