

NOTES

1. THRU AIR SPACING BETWEEN WIRE AND METAL .094 MIN.
2. TIE BOLT TOLERANCE 7 - 12 IN. LBS.
3. FOR WASHER SET-UP, SEE CHART C600 0279, DETAIL "A".
4. LOCATE CONNECTION DIAGRAM, 6129 6408, ON LEAD END COVER AT 0° TO READ RIGHT FROM LEAD END OF MOTOR.
5. CONNECT THE TWO YELLOW REV. LEADS TOGETHER AND THE TWO PURPLE REV. LEADS TOGETHER. THIS WILL GIVE CCWLE ROTATION.
6. SALES TO SPECIFY ON P.O. WHICH PACK TO USE.

ECO	REV.	DATE	SPEC/CHECK
638188	4	5-20-08	MKR/MKR
639184	5	03-10-09	GAE/GAE
641601	6	09-24-10	GAE/GAE
634178	3	1-20-05	JAK/RWS

- A. SEE PACKAGING MANUAL PAGE 2 FOR PACKAGING PROCEDURE.
- 1 MOTOR/CARTON;
  - 10 MOTORS/LAYER;
  - 6 LAYERS/PALLET;
  - 60 MOTORS/PALLET.
- B. CENTER LABEL, 6120 6426, ON END OF CARTON.
- C. SEE DRAWING 8785 6079 SH. 1 FOR PALLET LAYOUT.
- D. PLACE PAMPHLET, 6122 4579, IN CARTON WITH MOTOR.

71xx xxxx,R

71xx xxxxC

71xx xxxxZ

If Printed, this is an Uncontrolled Document

PRODUCTION TEST AT IDLE 115 VOLTS 60 HZ		MOTOR SPEED	PERFORMANCE TEST 120 VOLTS 60 HZ 1 PH 1/6 HP CAP. 5 MFD 370 VAC										
AMP	WATT		IDLE				LOADED				LOCKED		BREAK
			RPM	AMP	WATT	OZ/IN	RPM	AMP	WATT	OZ/IN	AMP	WATT	OZ/IN
1.44 — 1.18	93.5 — 76.5	HIGH	1784	1.43	95	155.0	1550	3.23	367	29.0	5.11	574	159.0
.59 — .49	44.0 — 36.0	MED. HI	1779	.56	42	87.0	1550	1.71	190	19.0	3.19	335	95.0
.45 — .37	36.3 — 29.7	MED. LO	1775	.43	35	66.0	1550	1.33	146	15.0	2.47	250	71.0
.36 — .30	29.7 — 24.3	LOW	1773	.33	28	53.0	1550	1.05	116	11.0	2.01	199	59.0

HI-POT TEST 2000 VOLTS  
MAX LEAKAGE CURRENT 5 mA

TYPICAL PERFORMANCE SHOWN ABOVE FOR CCWLE ROTATION.

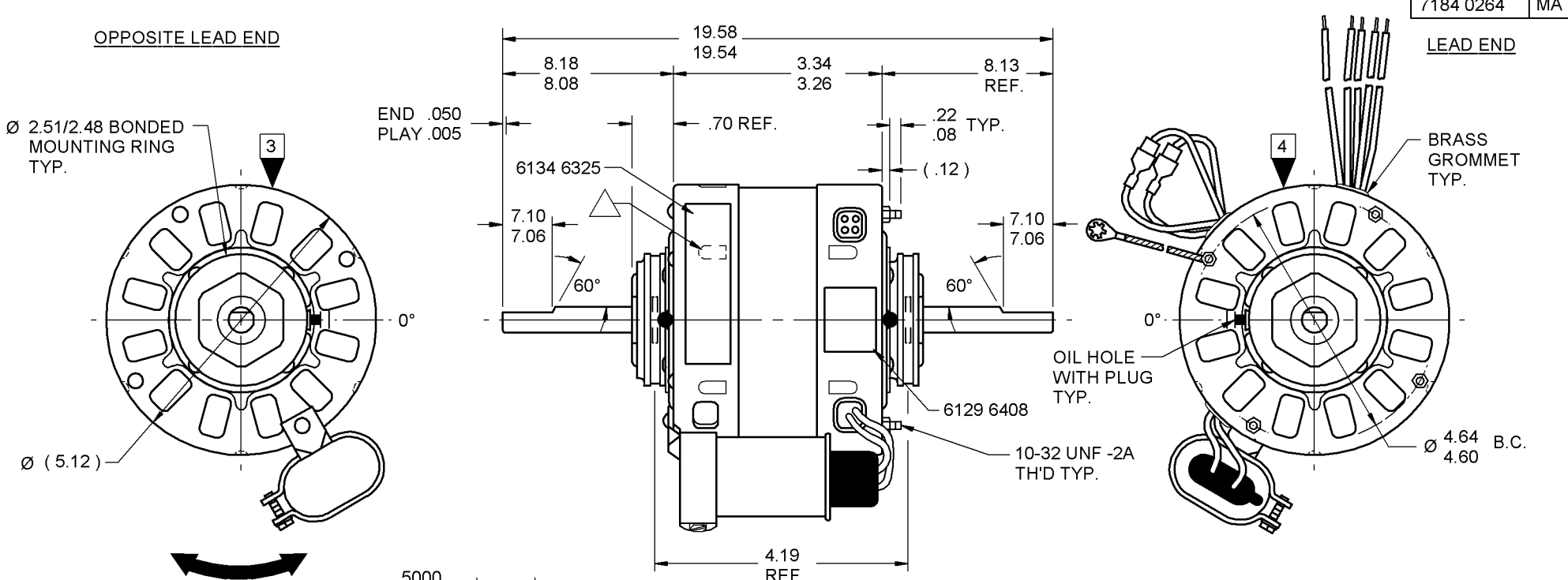

LEAD DATA: 18 GA. 2/64" INS. 105° C THERMO. WHITE, BLACK, ORANGE, BLUE AND RED LINE LEADS 32.00"/30.00" LONG WITH .56"/.44" STRIPS. BROWN AND BRN/WHT CAP LEADS 5.00"/3.00" LONG WITH 1/4" FLAG TERMINALS.

REV. LEAD DATA: 18 GA. 2/64" INS. 105° C THERMO. 2-YELLOW AND 2-PURPLE 8.00"/6.00" LONG WITH 1/4" PRE-INSULATED Q.C. TERMINALS.

GROUND DATA: 18 GA. 2/64" INS. 105° C THERMO. GRN/YEL 7.00"/6.00" LONG WITH A #10 SERRATED RING TERMINAL.

6129 6408

7184 0264= MADE IN U.S.A.  
7184 0264R = ASSEMBLED IN MEXICO

**FASCO** FASCO INDUSTRIES, INC. MOTOR DIVISION MODEL D221

V. 120 HZ 60 PH 1 AO ROT →

HP 1/6-1/8-1/10-1/12 INS CL B CAP 5 MFD 370 VAC

AMP 3.2-1.7-1.3-1.1 TYPE U184B1 NO. 7184-0264

RPM 1550 (4 SPD) 40° C AMB THERMALLY PROTECTED

SAFETY WARNING: THIS MOTOR MUST BE GROUNDED IN ACCORDANCE WITH LOCAL OR NATIONAL ELECTRICAL CODES TO PREVENT POSSIBLE INJURY DUE TO ELECTRICAL SHOCK

DATE/BAR CODE AREA PER 8882 6003

6134 6325,R REV. 3

SPECIAL INSTRUCTIONS: FLATS TO BE PARALLEL WITHIN ±20°. SHAFT IS BONDERIZED.

△ LANCE MUST BE COMPLETELY COVERED BY NAMEPLATE. OPPOSITE LEAD END MOUNTING RING ASSEMBLED BACKWARDS. PAMPHLET PACKED WITH MOTOR.

MOTORS PACKED MAX. PER SKID: PALLET PACK, 60 CARTON PACK, TRAY PACK.

CUSTOMER: FASCO DISTRIBUTING CO.

PART NUMBER: D221

APPLICATION: DIST. SALES

FINISH COLOR: GRAY

MOTOR WEIGHT: LBS.

ENVIRONMENT: DRY

INSULATION CLASS: B

MOTOR TYPE: P.S.C.

MOTOR NUMBER: 7184 0264 R

REV. 6

B	LA	FR	A	S	C	E	B	A
00	84	11	V	04	AR	8	8	0

LOCATE EDGE OF NAMEPLATE .05 FROM EDGE OF OPP. LEAD END COVER TO READ RIGHT FROM LEAD END OF MOTOR CENTER AT 20° CWLE.

SIZE 3.50 X 1.00