

61299409

STAMP ROTATION ARROW ON WELD PLATE PER OUTLINE ABOVE

61305568

SAFETY WARNING
This motor must be grounded in accordance with local or national electrical codes to prevent possible injury due to electrical shock

AVERTISSEMENT DE SÉCURITÉ
Ce moteur doit être fondée sur conformément à la réglementation locale ou national électrique codes pour prévenir d'éventuelles blessures en raison de choc électrique

LABEL TO READ RIGHT FROM FRONT END

00464072

00464209

FASCO Fasco Industries, Inc. Motor Division

Assembled In Mexico

No. 71212012 TYPE U21 T.P. AO

115/230 V 60 Hz

1.7 A 3000 RPM

Model D214

LR36496

1/20 HP

Max Amb: 40°C

Connection Diagram

115 V 230 V

Blu — Line Blu — Line

Red — Line Red — Line

Wht — Line Wht — Line

Blk — Line Blk — Line

Yel — Line Yel — Line

NOTE:
1. NO PACKAGING TAPE OVER CARTON LABEL.

CUSTOMER:	FDC	APPLICATION:	COUNTER SALES
CUSTOMER PN:	D214	MOTOR WEIGHT:	4 3/4 LBS.
		ENVIRONMENT:	DRY
MOTOR TYPE		REFERENCE SAMPLE	
SHADED POLE			
B	LA	FR	A
00	21	28	T
S			
07			
C	E	B	A
BT	9	3	0
TYPICAL PERFORMANCE AT 115 VOLTS 60 HZ			
IDLE		LOADED	
MOTOR SPEED	RPM	AMP	WATT
115 V	3500	1.17	74
230 V	3500	.59	74
IN OZ		IN OZ	
17	17	17	17
RPM		RPM	
3000	3000	3000	3000
AMP		AMP	
1.53	1.53	.76	.76
WATT		WATT	
121	121	121	121
IN OZ		IN OZ	
5.7	5.7	5.7	5.7
AMP		AMP	
1.91	1.91	.95	.95
WATT		WATT	
143	143	143	143
IN OZ		IN OZ	
18	18	18	18

DRAWING REVISION BL	REVISION BY PLA	DATE 3/12/2015	TOLERANCES UNLESS OTHERWISE SPECIFIED: DEC. INCH mm ANGLE	DRAWN BY PLA	DATE 3/12/2015	DESCRIPTION MOTOR ASSY
ECO-0071336	APPROVED BY JMG	DATE 3/12/2015	.X ±0.1 [±2.5] .XX ±0.01 [±0.25] .XXX ±0.005 [±0.127] .XXXX ±0.0005 [±0.0127]	APPROVED BY JMG	DATE 3/12/2015	DESCRIPTION MOTOR ASSY
ECO DESCRIPTION REDRAWN ON SOLID WORKS			MACHINED SURFACES: 125/3.2 INCH/mm	THIRD ANGLE PROJECTION	SIZE C	DRAWING NUMBER 71212012
COPYRIGHT REGAL BELOIT AMERICA, INC. ALL RIGHTS RESERVED. PROPRIETARY AND CONFIDENTIAL INFORMATION - THIS DOCUMENT IS THE PROPERTY OF REGAL BELOIT AMERICA, INC. (OWNER) AND CONTAINS OWNER'S PROPRIETARY INFORMATION. ANY PERSON, CORPORATION OR OTHER FIRM RECEIVING IT IS DEEMED, BY RECEIVING IT, TO AGREE THAT IT, AND/OR ANY PART OF IT, SHALL NOT BE DISCLOSED TO ANY PERSON, CORPORATION OR OTHER ENTITY, DUPLICATED, AND/OR USED, EXCEPT AS EXPRESSLY APPROVED IN WRITING IN ADVANCE BY OWNER. THIS DOCUMENT SHALL BE RETURNED TO OWNER UPON REQUEST. IT MAY BE SUBJECT TO CERTAIN RESTRICTIONS UNDER APPLICABLE EXPORT CONTROL LAWS AND REGULATIONS.			REMOVE BURRS & BREAK SHARP EDGES: .003/.015 [0.076/.381] X 45° CORNER FILLETS: R.02 [51]	PROCESS/FINISH BLACK	SHEET 1 OF 2	

- NOTES:
1. ALL SPACINGS THRU AIR BETWEEN WIRE AND METAL MUST BE AT LEAST: .094 [2.388].
 2. SEE ROTATING ASSY DRAWING FOR WASHER SET-UP.

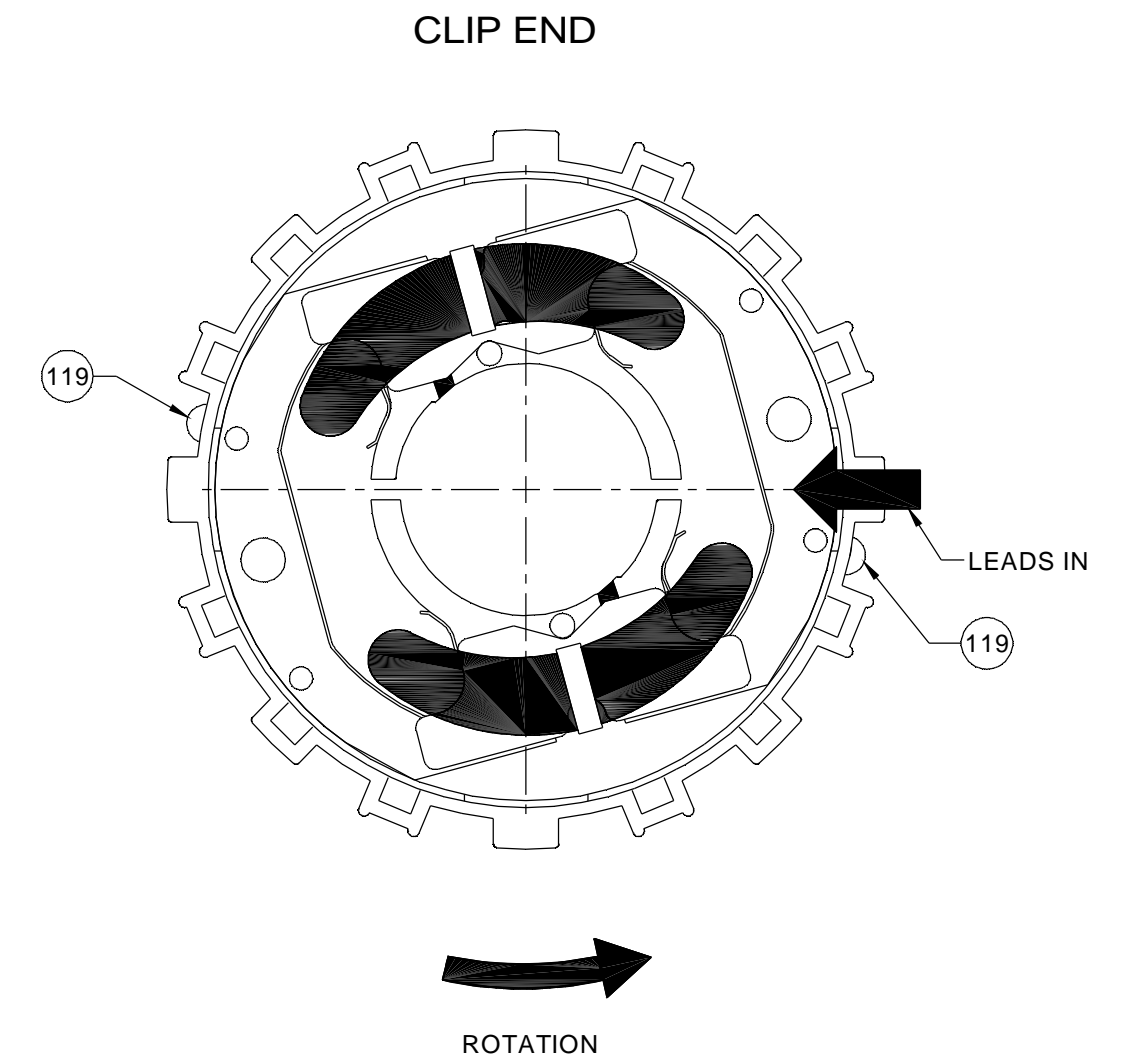
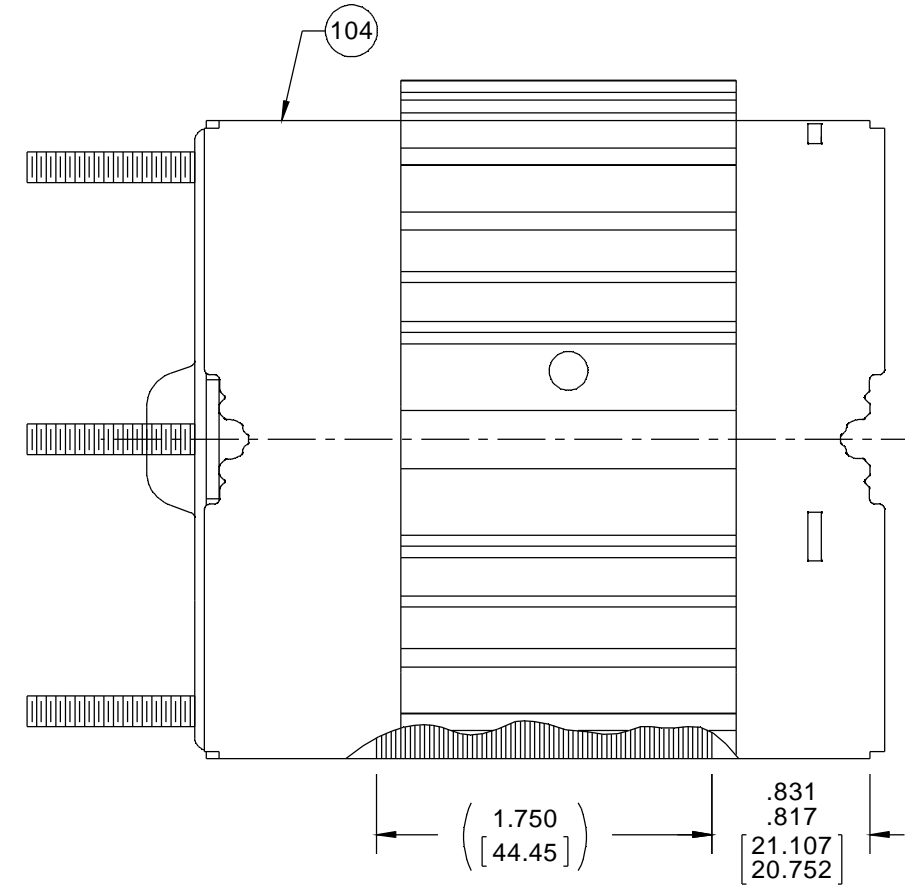

BLAST COOLED SPECIFICATIONS

1. FAN MUST TRACK WITHIN .035 [.889] AND HAVE .10 [2.54] MIN. CLEARANCE TO BEARING BOSS AFTER PRESS ON OPERATION.
2. ASSEMBLE COOLING CASE PER PROCESS STANDARD.
3. DIMENSION OVER ENDPLATES TO BE 3.67/3.63 [93.22/92.20].
4. DRILL PILOT HOLE WITH A #37 DRILL .300/.275 [7.620/6.985] DEEP AT CENTER OF DRILL AND PIN COOLING BAND SECURELY TO STATOR AND MAIN FRAME ASSEMBLY, (2) PLACES, 180° APART.

MEXICO PACKING SPECIFICATIONS

1. PACK 1 PER CONTAINER, 144 MAX. PER PALLET, PACKING ASSY.: 87854000, 24 CARTONS PER LAYER, 6 LAYERS PER PALLET, P.S. 88834200 AND P.S. 88834408.
2. CARTON LABELS MUST ALL FACE ONE DIRECTION TOWARD THE OPEN END OF THE PALLET. SEE P.S. 88834408.

DRAWING REVISION BL	REVISION BY PLA	DATE 3/12/2015	TOLERANCES UNLESS OTHERWISE SPECIFIED: DEC. INCH mm ANGLE .X ±0.1 [±2.5] ±0.5° .XX ±0.01 [±0.25] .XXX ±0.005 [±0.127] .XXXX ±0.0005 [±0.0127]	DRAWN BY PLA	Regal Beloit America, Inc.	
ECO ECO-0071336	APPROVED BY JMG	DATE 3/12/2015	DATE 3/12/2015	APPROVED BY JMG		
ECO DESCRIPTION REDRAWN ON SOLID WORKS			REMOVE BURRS & BREAK SHARP EDGES: .003/.015 [.076/.381] X 45° CORNER FILLETS: R.02 [.51] MACHINED SURFACES: 125/ mm 3.2/ INCH mm 3.2/ mm SHOWN IN [BRACKETS]	DATE 3/12/2015	DESCRIPTION MOTOR ASSY	
<small>COPYRIGHT REGAL BELOIT AMERICA, INC. ALL RIGHTS RESERVED. PROPRIETARY AND CONFIDENTIAL INFORMATION- THIS DOCUMENT IS THE PROPERTY OF REGAL BELOIT AMERICA, INC. ('OWNER') AND CONTAINS OWNER'S PROPRIETARY INFORMATION. ANY PERSON, CORPORATION OR OTHER FIRM RECEIVING IT IS DEEMED, BY RECEIVING IT, TO AGREE THAT IT, AND/OR ANY PART OF IT, SHALL NOT BE DISCLOSED TO ANY PERSON, CORPORATION OR OTHER ENTITY, DUPLICATED, AND/OR USED, EXCEPT AS EXPRESSLY APPROVED IN WRITING IN ADVANCE BY OWNER. THIS DOCUMENT SHALL BE RETURNED TO OWNER UPON REQUEST. IT MAY BE SUBJECT TO CERTAIN RESTRICTIONS UNDER APPLICABLE EXPORT CONTROL LAWS AND REGULATIONS.</small>			REFERENCE	MATERIAL	PROCESS/FINISH BLACK	
			THIRD ANGLE PROJECTION	SIZE C	DRAWING NUMBER 71212012	SHEET 2 OF 2