

10	REVISED NAMEPLATE LABEL	SD 2-20-08	11	REVISED LEAD MATERIAL AND PICTORIALLY REMOVED BARCODE FROM N/P LABEL	SD 3-5-10	12	ADDED CARTON LABEL NOTES	4005689 MLM 06/07/12	STANDARD TOLERANCES: ANGULAR +/- 1 DEGREE 2 PLACE DECIMAL +/- .01 3 PLACE DECIMAL +/- .005
----	-------------------------	------------	----	--	-----------	----	--------------------------	-------------------------	---

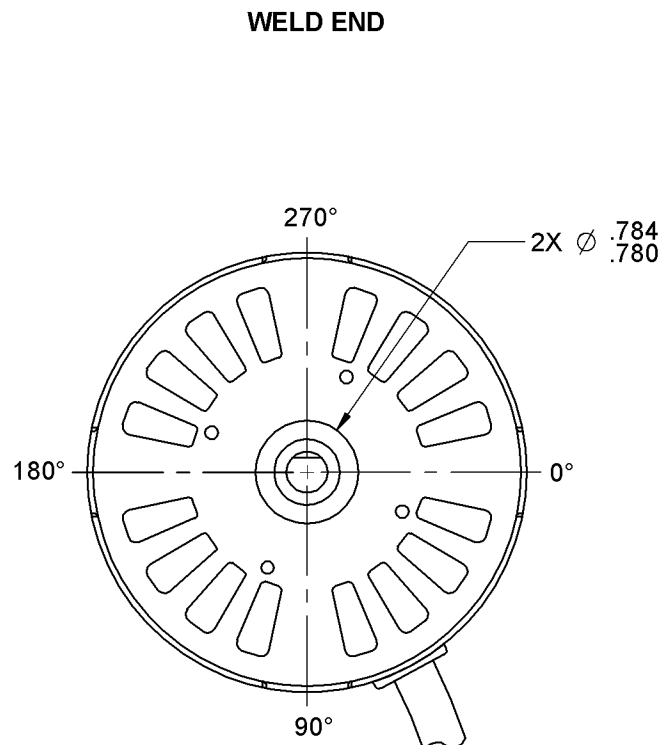

ROTATION

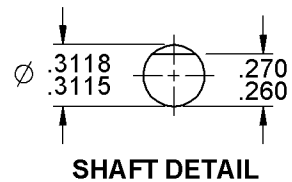

LEAD MATERIAL
18 GA. 2/64 INS. 105°C.
3 CONDUCTOR SJTO
27.00/25.00" W/RIP 6.25/5.75"
WHITE W/STRIP .56/.44"
BLACK & GRN/YEL
W/RING TERM.
8902-0157, AMP #350436-2

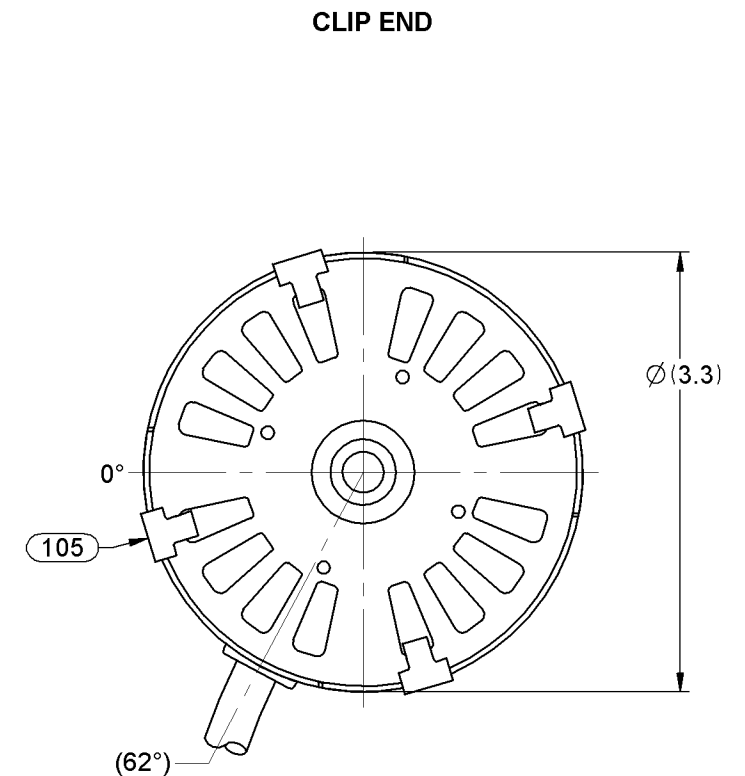
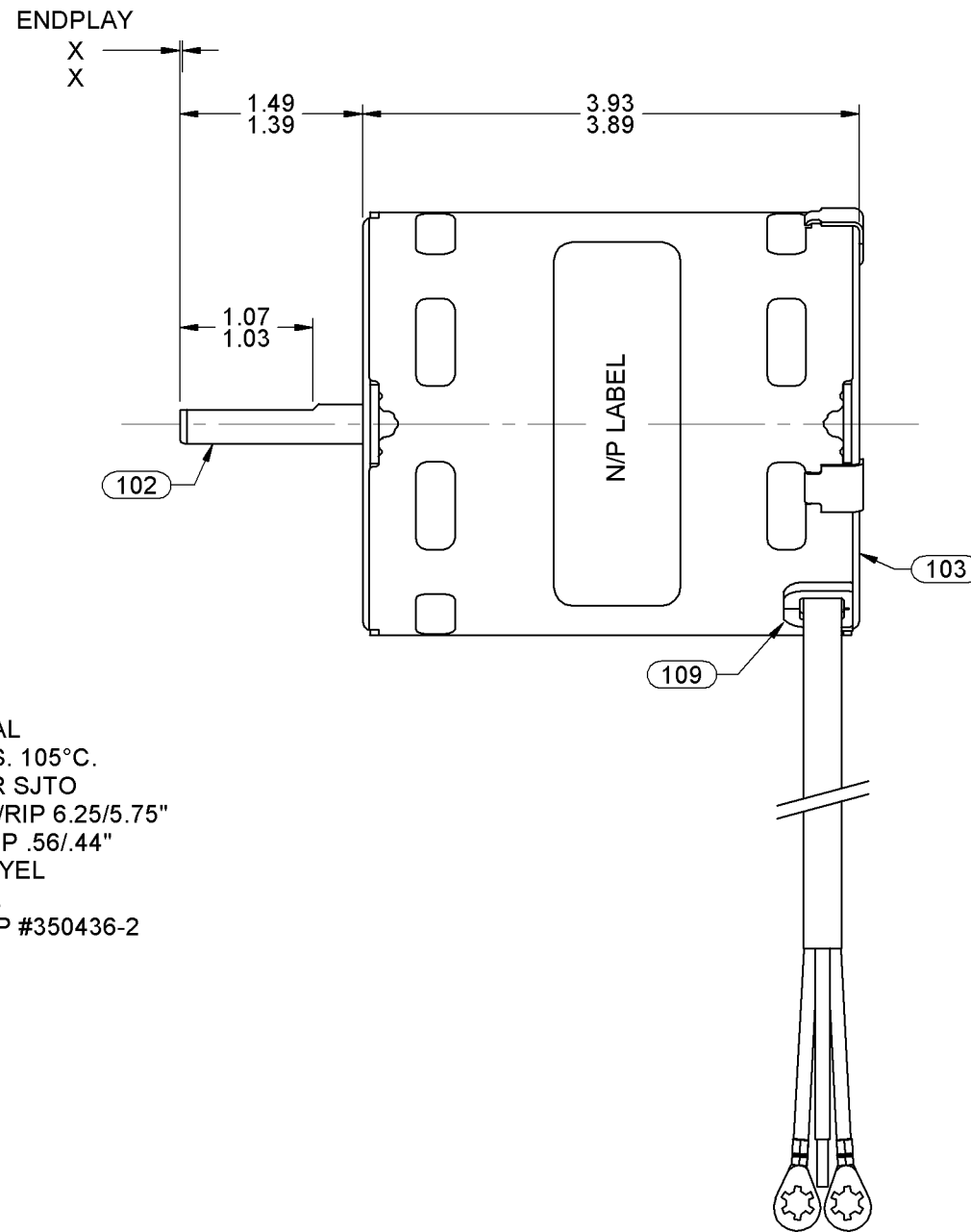

0046 4072

0046 4282

FASCO	Fasco Industries, Inc. Motor Division	SP	RU	C	SAFETY WARNING
Assembled in Mexico					<p>This Motor Must Be Grounded in Accordance With Local Or National Electrical Codes To Prevent Possible Injury Due To Electrical Shock</p>
No. 71638189	Type U63B1	T.P.	AO		
115 V	60 Hz	Class B	1/10 HP		
3.2 A	1550 RPM		Max Amb: 40° C		
Model D1107	Sealed Ball Brg				

6129 9553

- NOTES:**
1. PACK 216 MAX. MOTORS PER PALLET.
 2. NO PACKAGING TAPE OVER CARTON LABEL.

FRONT SHAFT POSITION	* TYPICAL PERFORMANCE AT 115 VOLTS 60 Hz.											CUSTOMER: FASCO DIST.	FASCO FASCO MOTORS GROUP AC MOTOR/BLOWER DIVISION
HORIZONTAL UP DOWN	MOTOR SPEED	IDLE			LOADED			LOCKED			BREAK	PART NUMBER: D1107	
		R.P.M.	AMP.	WATT	IN.OZ.	R.P.M.	AMP.	WATT	IN.OZ.	AMP.	WATT	IN.OZ.	APPLICATION: COUNTER SALES
		1775	3.02	157	80.8	1550	3.65	271	25.3	5.35	378	82.4	MOTOR WEIGHT: 4.81 LBS.
CUSTOMER APPROVAL:													ENVIRONMENT: DRY
SIGNED:													FINISH COLOR: BLACK
DATE:													DRAWN BY: S. DALTON
													DATE DRAWN: 12-13-2001
													MOTOR TYPE
													SHADED POLE
													DRAWING NUMBER
													7163 8189
													REV. 12
		B	LA	FR	A	S	C	E	B	A			
		00	63	30	V	08	DY	5	0	0			