

NOTES:

1. INSPECTION TEST FIXTURE REQUIRED.
2. SHIP (1) PC. 377 GASKET IN EACH CONTAINER.
3. PACK 1 PER CONTAINER, 36 MAX. PER PALLET, PACKING ASSY.: 87854916, 12 CONTAINERS PER LAYER, 3 LAYERS PER PALLET, P.S. 88834200 AND P.S. 88834408.
4. CARTON LABELS MUST ALL FACE ONE DIRECTION TOWARD THE OPEN END OF THE PALLET. SEE P.S. 88834408.
5. NO PACKAGING TAPE OVER CARTON LABEL.

APPLICATION	DISTRIBUTING								
	B	LA	FR	A	S	C	E	B	A
	PF	21	30	F	05	DK	5	3	0
	THERMALLY PROTECTED CLASS "B" INSULATION 416 S.S. SHAFT								
	CUSTOMER FASCO DISTRIBUTING CO.								
	CUSTOMER PART NO. A243								

GROUND LEAD  
18 GA., 125°C, 2/64 INSUL.  
X-LINKED POLY., GRN/YEL  
10.50/9.50 IN. LONG  
89039251 RING TERM.  
AMP 60700-2

LEAD MATERIAL  
18 GA., 125°C, 2/64 INSUL.  
X-LINKED POLY., (2) BLACK

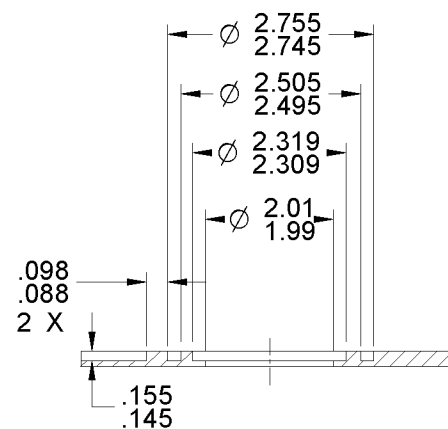
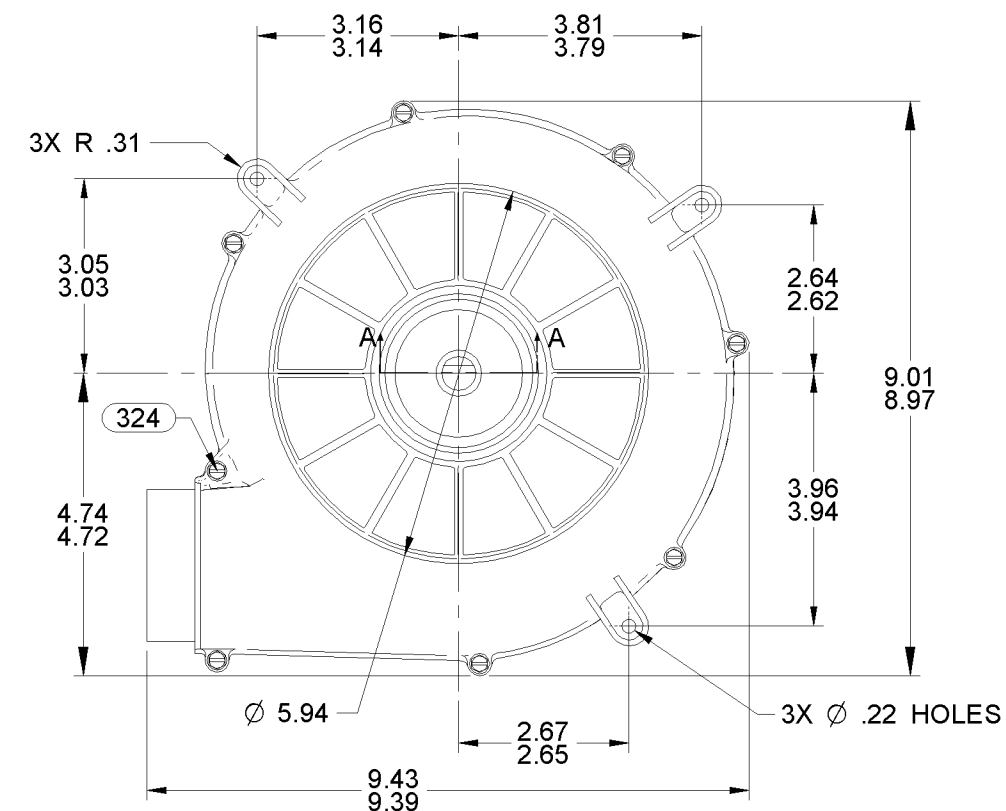
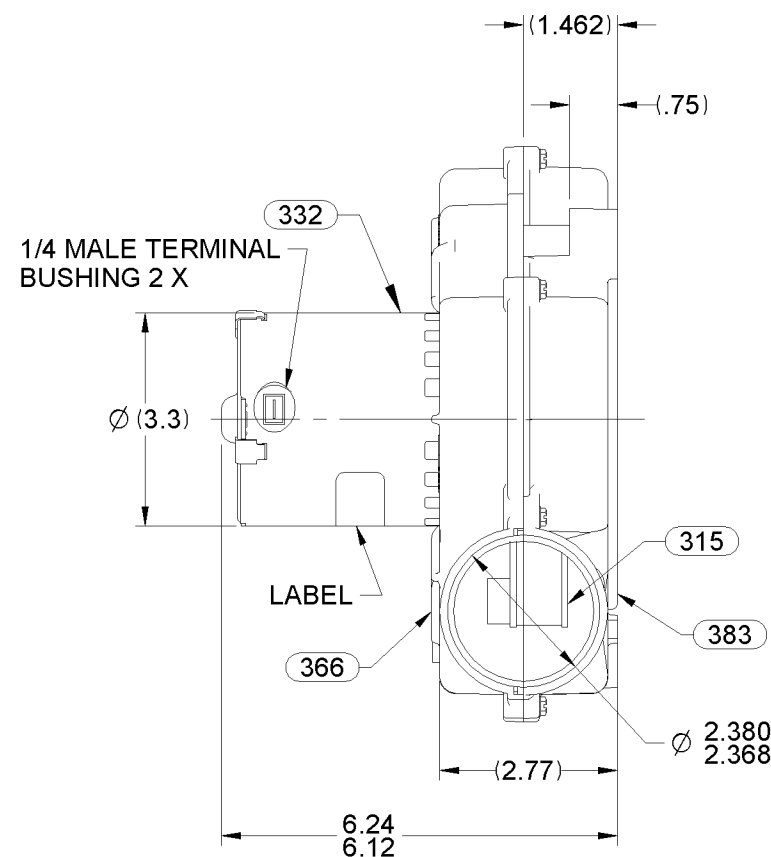
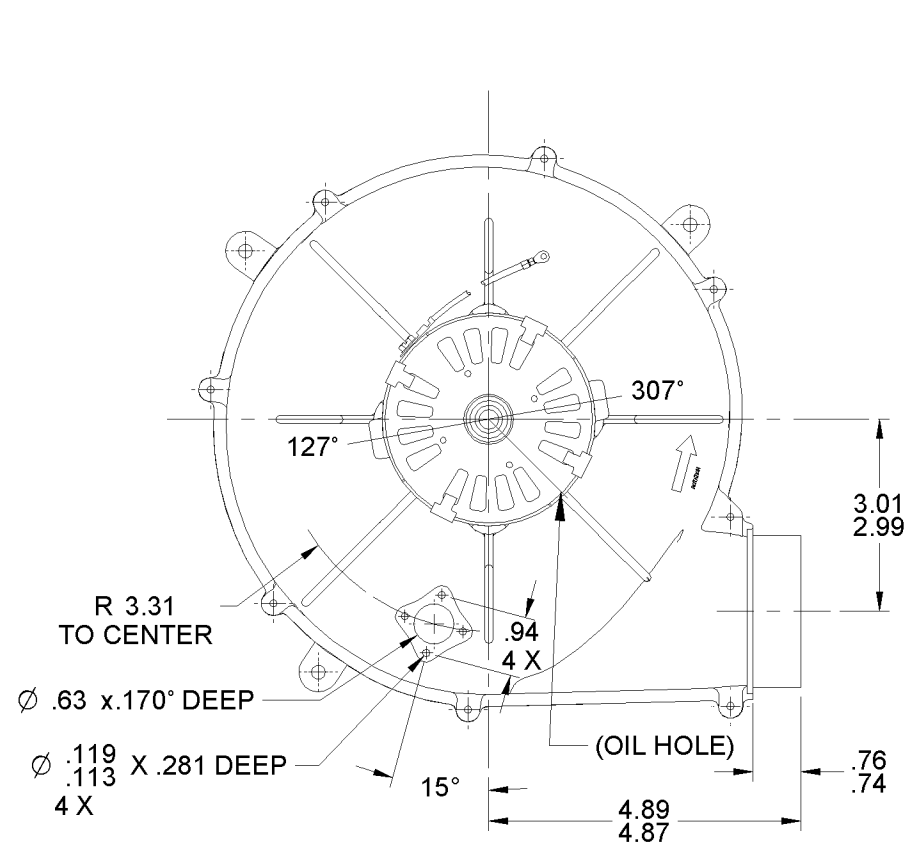

INLET DETAIL A-A

TYPICAL PERFORMANCE TEST DATA WITH A 1.25 IN. DIA. INLET RESTRICTOR				UNLESS OTHERWISE SPECIFIED DIMENSIONS ARE IN INCHES TOLERANCES ARE:		
AT 115 VOLTS 60 HZ.				FRACTIONS ± 1/16	DECIMALS .XX ± .01 .XXX ± .005	ANGLES ± 1°

ECO. NO.	REV.	DATE	APPROVAL	MAX.	R.P.M.	WATTS	AMPS
4001202	03	02/23/11	MLM/ KSA	MAX.	3396	105	1.42
4002716	04	07/21/2011	SDM/PLA	MIN.	3340	98	1.34
4007713	05	12/19/2012	PLA/SDM				

BLOWER WEIGHT	4 1/2 LBS.	END PLAY	.030/.010
---------------	------------	----------	-----------

APPROVALS	DATE
DRAWN BGP	09/17/2004
CHECKED JMH	09/17/2004
FINISH COLOR	BLACK

**FASCO** FASCO MOTORS GROUP  
AC MOTOR/BLOWER DIVISION

CONFIDENTIAL: DO NOT DUPLICATE OR DISCLOSE TO THIRD PARTIES WITHOUT WRITTEN PERMISSION OF FASCO MOTORS GROUP, AC MOTOR/BLOWER DIVISION.

TITLE		
BLOWER ASSEMBLY		
SIZE	DWG. NO.	REV.
B	7021 11708	05
DO NOT SCALE DRAWING		SHEET 1 OF 2