

THERMALLY PROTECTED  
CLASS "B" INSULATION  
416 SS SHAFT  
SEALED BALL BEARING

APPLICATION:	HIGH EFFICIENCY BLOWER	B	LA	FR	A	S	C	E	B	A
CUSTOMER:	FASCO DIST.	PB	62	30	V	03	CN	5	0	C
CUSTOMER PN:	A142B									

NOTES:

- LAY PC 391 (ROPE SEALANT) IN CHANNEL PROVIDED IN MOUNTING SHELL.
- ASSEMBLE INLET SHELL TO MOUNTING SHELL ASSEMBLY AND SECURE WITH (7) PC 324 SCREWS. TRIM EXCESS ROPE SEALANT FROM FACE OF BLOWER EXHAUST.
- STATIC TAP HOLE TO BE FREE OF FLASH.
- REPLACE PAPER TUBES OVER TERMINALS AFTER TESTING.
- PACK 1 PER CONTAINER, 12 CONTAINERS PER LAYER, 4 LAYERS PER PALLET, 48 MAX. PER PALLET, PACKING ASSY. 87854916, PER 88834200 AND 88834408.
- INSPECTION TEST FIXTURING IS REQUIRED.
- CARTON LABELS MUST ALL FACE ONE DIRECTION TOWARD THE OPEN END OF THE PALLET. SEE 88834408.
- NO PACKING TAPE OVER CARTON LABEL.
- CAPACITOR: 4MFD/370 VAC.

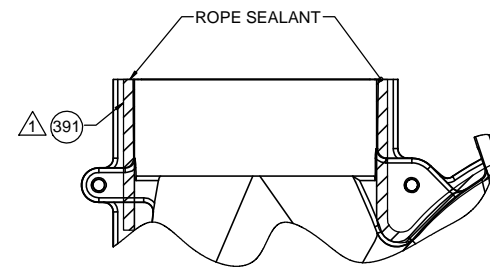

LEAD MATERIAL  
18 GA. 125°C, 4/64 INSUL.  
EPDM, (2) BLACK,  
33.00/31.00 [838.20/787.40]  
W/ PIN TERMS  
AMP 350538-1  
CAPACITOR LEAD  
(2) BROWN  
7.00/5.00 [177.80/127.0]  
FFLAG TERMINAL  
AMP 42742-2

GROUND LEAD  
18 GA. 125°C, 2/64 INSUL.  
X-LINKED POLY. GRN/YEL.  
7.00/5.00 [177.80/127.00]  
W/ RING TERM.  
AMP 60700-2

Connection Diagram

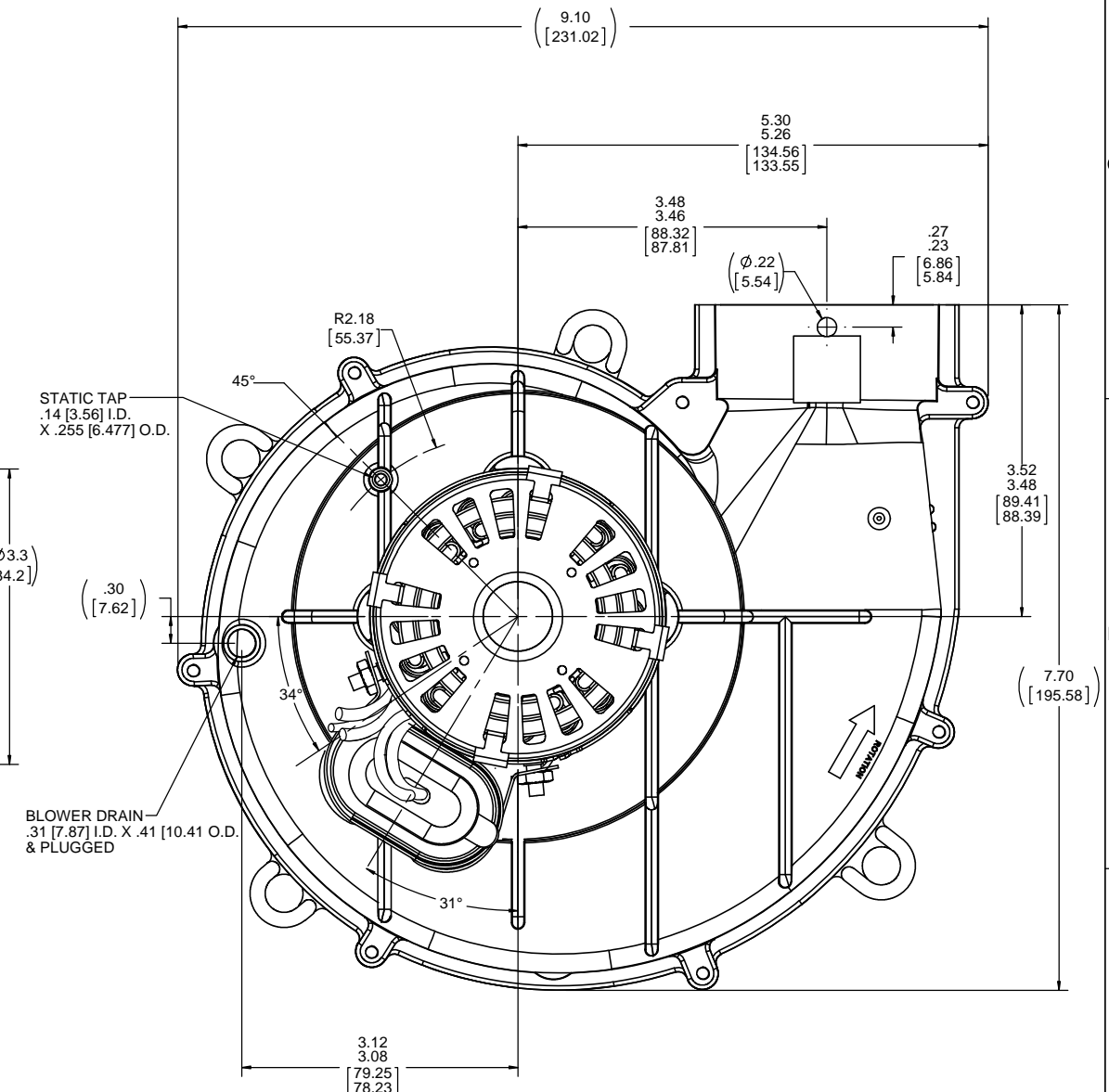
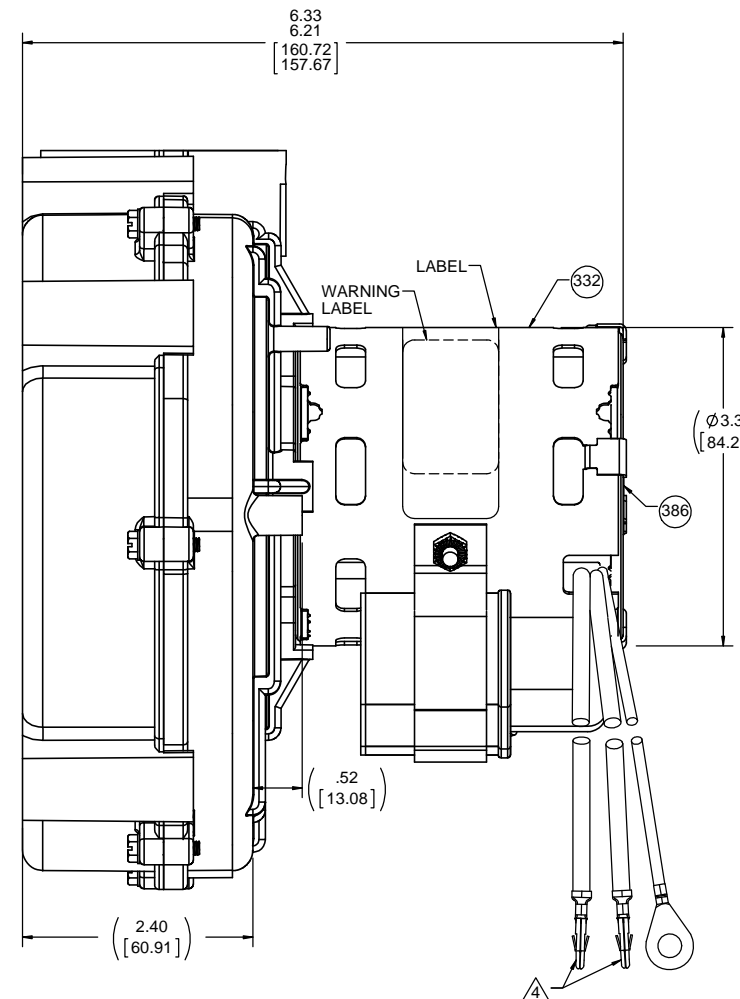
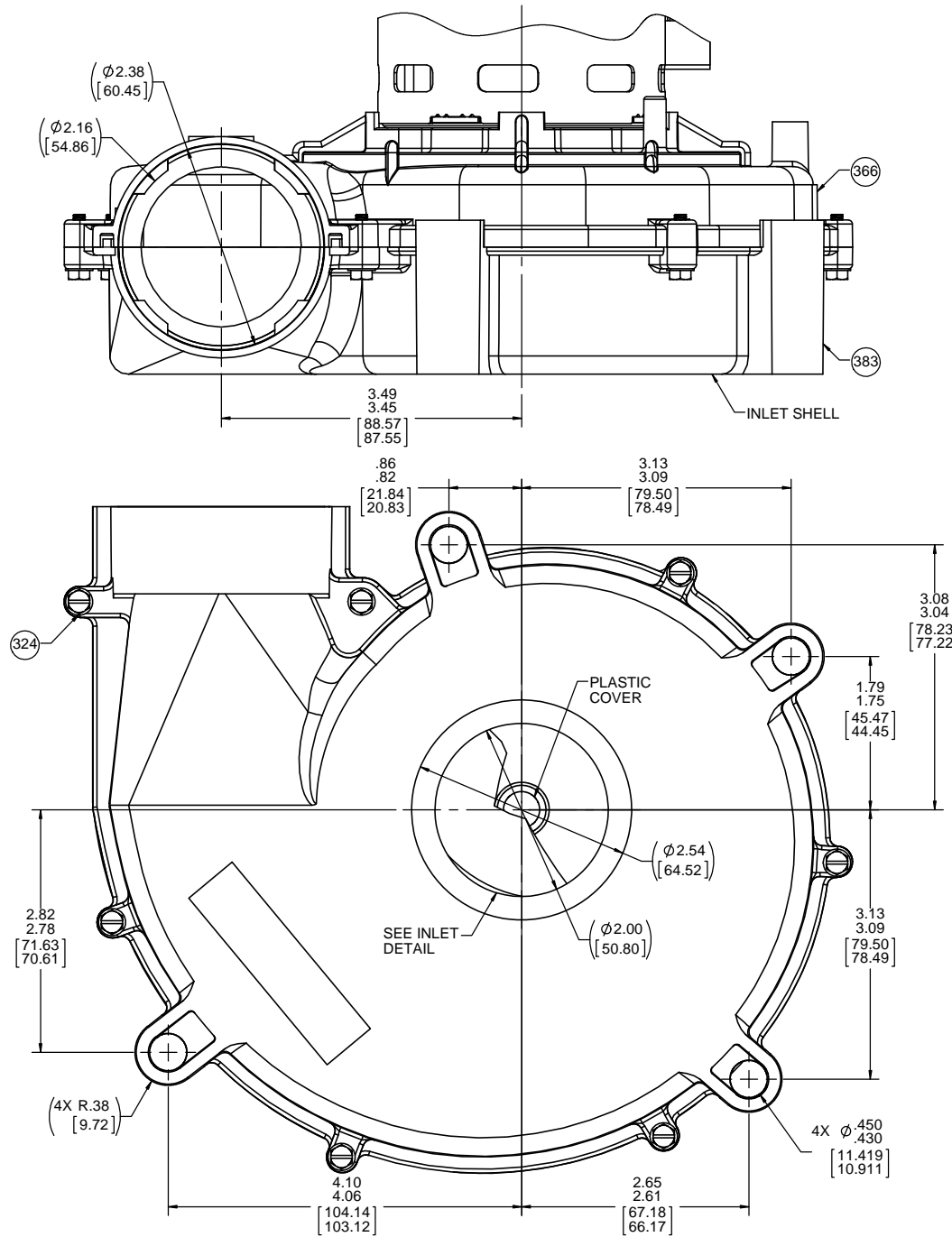
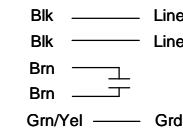

TYPICAL PERFORMANCE TEST DATA	
TEST WITH INLET RESTRICTED TO 1 1/4". TEST COMPLETE	
BLOWER AT 115V, B5 60 Hz WITH ENTERING AIR AT 70° ± 5°F	
A) BLOWER RPM TO READ 3420 RPM ± 20.	
B) TOTAL NEGATIVE PRESSURE (INCHES W.C.) TO READ 2.20 + 0.1/-0.2	
BLOWER WEIGHT	ENDPLAY
6 LBS.	.XX/XX

DRAWING REVISION	REVISION BY	DATE	TOLERANCES UNLESS OTHERWISE SPECIFIED:	DRAWN BY
AB	SED	6/5/2017	DEC. INCH. mm ANGLE	MLS
ECO-0124252	APPROVED BY	DATE	X ±0.1 [±2.5]	DATE
	PLA	6/5/2017	XX ±0.01 [±0.25]	3/15/2017
ECO DESCRIPTION			XXX ±0.005 [±0.127]	APPROVED BY
CORRECTED TOLERANCE FOR PRESSURE READING			XXXX ±0.0005 [±0.0127]	SED
REMOVE BURRS & BREAK SHARP EDGES: .003 Ø15 [Ø76.381] X 45°			DATE	3/15/2017
CORNER FILLETS: R.02 [51]			REFERENCE	
MACHINED SURFACES: 125			MATERIAL	Regal Beloit America, Inc.
mm SHOWN IN [BRACKETS]			PROCESS/FINISH	FLAT BLACK
THIRD ANGLE PROJECTION			SIZE	DRAWING NUMBER
			D	70626860
			SHEET	1 OF 2

NOTES:

1. LINE UP HOUSING HALVES WITH (3) PILOTS, SECURE WITH (7) PC 324 SCREWS. TORQUE SCREWS TO 7 IN./LBS. MAX. NO AIR GAPS ALLOWED BETWEEN HOUSING HALVES. NOTE: PLASTIC STRIPS AT TORQUE SETTINGS ABOVE 7 IN. LBS.
2. OIL SLINGER MUST BE LOCATED ON SHAFT AS SHOWN BELOW.
3. BEFORE ASSEMBLING IMPELLER TO SHAFT, PRESS PC 399 ROPE SEALANT AGAINST EXPOSED FACE OF NUTS TO PROTECT FROM CORROSIVES.
4. WHEN EQUIPPED WITH WATER SEAL, EVERY 20TH BLOWER IS TO BE CHECKED FOR WATER LEAKAGE. IF LEAKERS ARE DISCOVERED CONTACT ENGINEERING. (USE 1/3 PARTS MR. BUBBLE WITH 2/3 PARTS WATER FOR LEAK TEST).
5. BEFORE ASSEMBLY OF PC 394 END CAP, ASSEMBLE TORSION SPRING TO IMPELLER. PRESS IMPELLER ASSY. ON SHAFT AND LOCATE AS SHOWN BELOW.
6. ALL UNITS MUST BE TESTED WHERE EQUIPPED WITH STATIC TAP, FOR STATIC VACUUM TO THE STANDARDS LISTED ON BLOWER TOP COPY.
7. AFTER PRESSING ON IMPELLER ADD PC 386 ADHESIVE DISK OVER SHAFT HOLE ON BACK END.

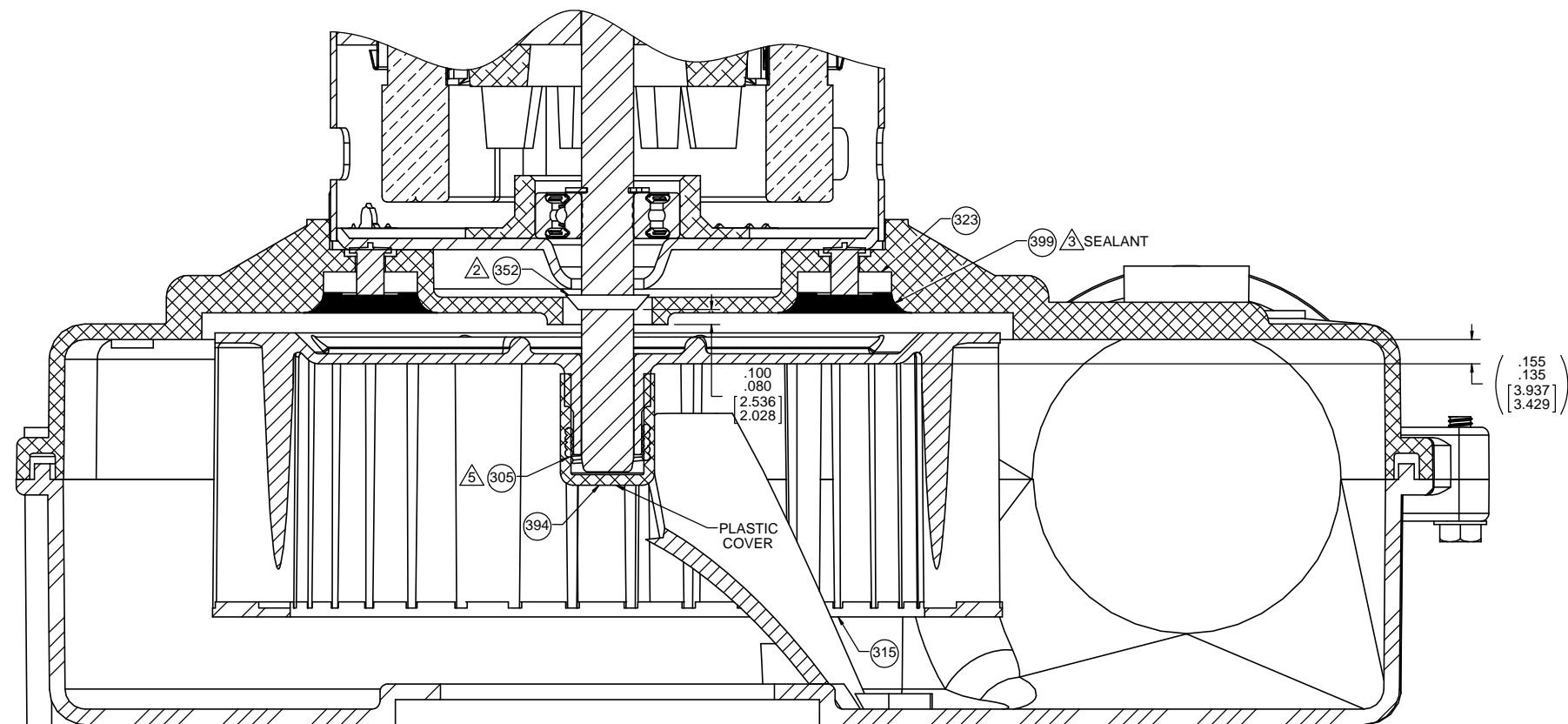

DRAWING REVISION		REVISION BY	DATE	TOLERANCES UNLESS OTHERWISE SPECIFIED:		DRAWN BY		Regal Beloit America, Inc.	
AB		SED	6/5/2017	DEC.	INCH	mm	ANGLE	MLS	
ECO-0124252		APPROVED BY	DATE	X	±0.1	[±2.5]	±1°	DATE	
		PLA	6/5/2017	.XX	±0.01	[±0.25]		3/15/2017	
ECO DESCRIPTION				.XXX	±0.005	[±0.127]		APPROVED BY	
CORRECTED TOLERANCE FOR PRESSURE READING				XXXX	±0.0005	[±0.0127]		SED	
				REMOVE BURRS & BREAK SHARP EDGES: 0.03/015 [076/381] X 45°				DATE	
				CORNER FILLETS: R.02 [51]				3/15/2017	
				MACHINED SURFACES: 125/√mm 32/√INCH				REFERENCE	
				mm SHOWN IN [BRACKETS]				THIRD ANGLE PROJECTION	
								MATERIAL	
								PROCESS/FINISH	
								FLAT BLACK	
								SIZE	
								DRAWING NUMBER	
								70626860	
								SHEET	
								2 OF 2	