

- NOTES:
- NO STA-LOC REQUIRED ON IMPELLER.
 - INSPECTION TEST FIXTURING IS REQUIRED.
 - STATIC TAP READING IS -1.4 MINIMUM CORRECTED TO STANDARD AIR (0.075 LB/FT³) WITH A 1 5/16 INLET RESTRICTOR.
 - APPLY GREEN DOT STICKER TO UMBRELLA FAN FOR VISUAL AID.
 - PACK 1 PER CONTAINER, 36 MAX PER PALLET, PACKING ASSY. 87854752, 9 CONTAINERS PER LAYER, 4 LAYERS PER PALLET, PER 88834200.
 - CARTON LABELS MUST ALL FACE ONE DIRECTION TOWARD THE OPEN END OF THE PALLET. SEE 88834408.
 - NO PACKAGING TAPE OVER CARTON LABEL.

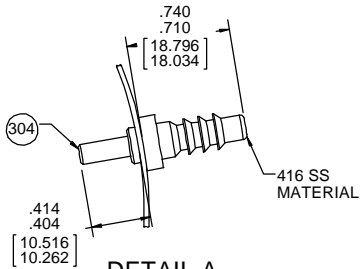

DETAIL A

THERMALLY PROTECTED
CLASS "B" INSULATION
SEALED BALL BEARING
416 SS SHAFT

APPLICATION:		B	LA	FR	A	S	C	E	B	A
CUSTOMER:	FASCO DIST.	HS	58	48	X	17	AX	5	0	0
CUSTOMER PN:	A126									

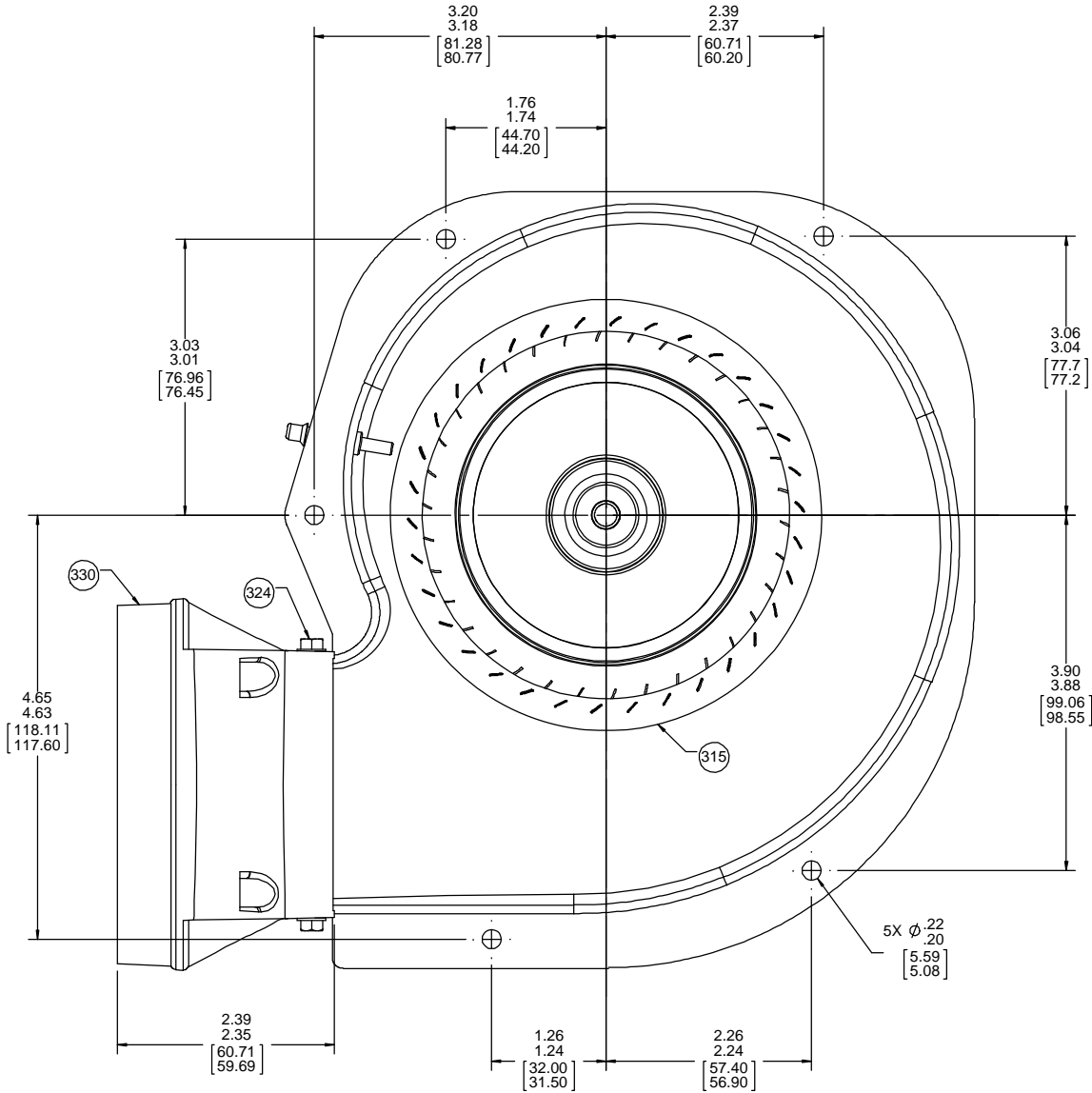
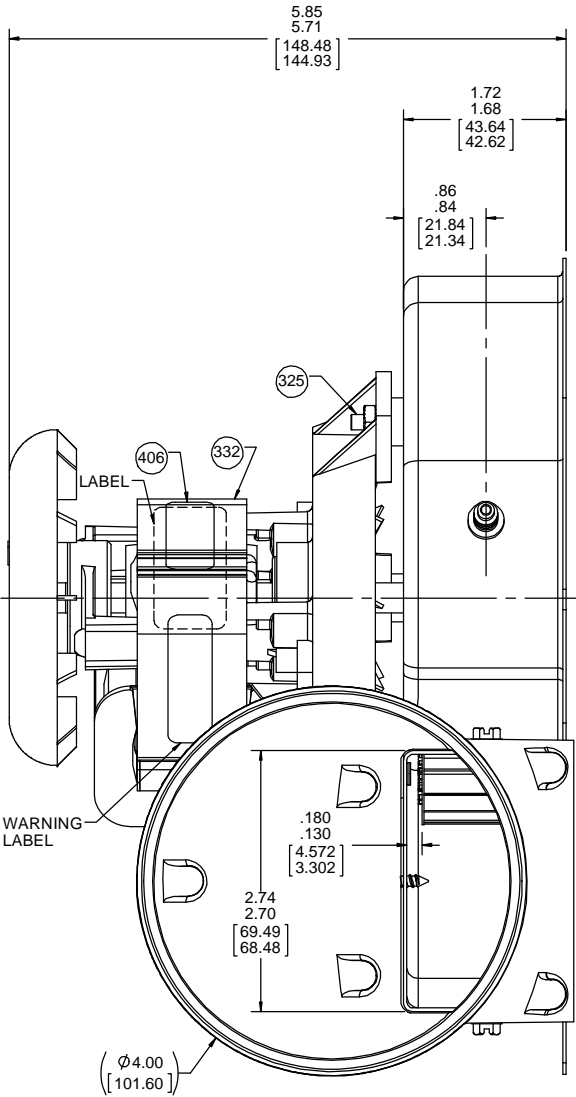
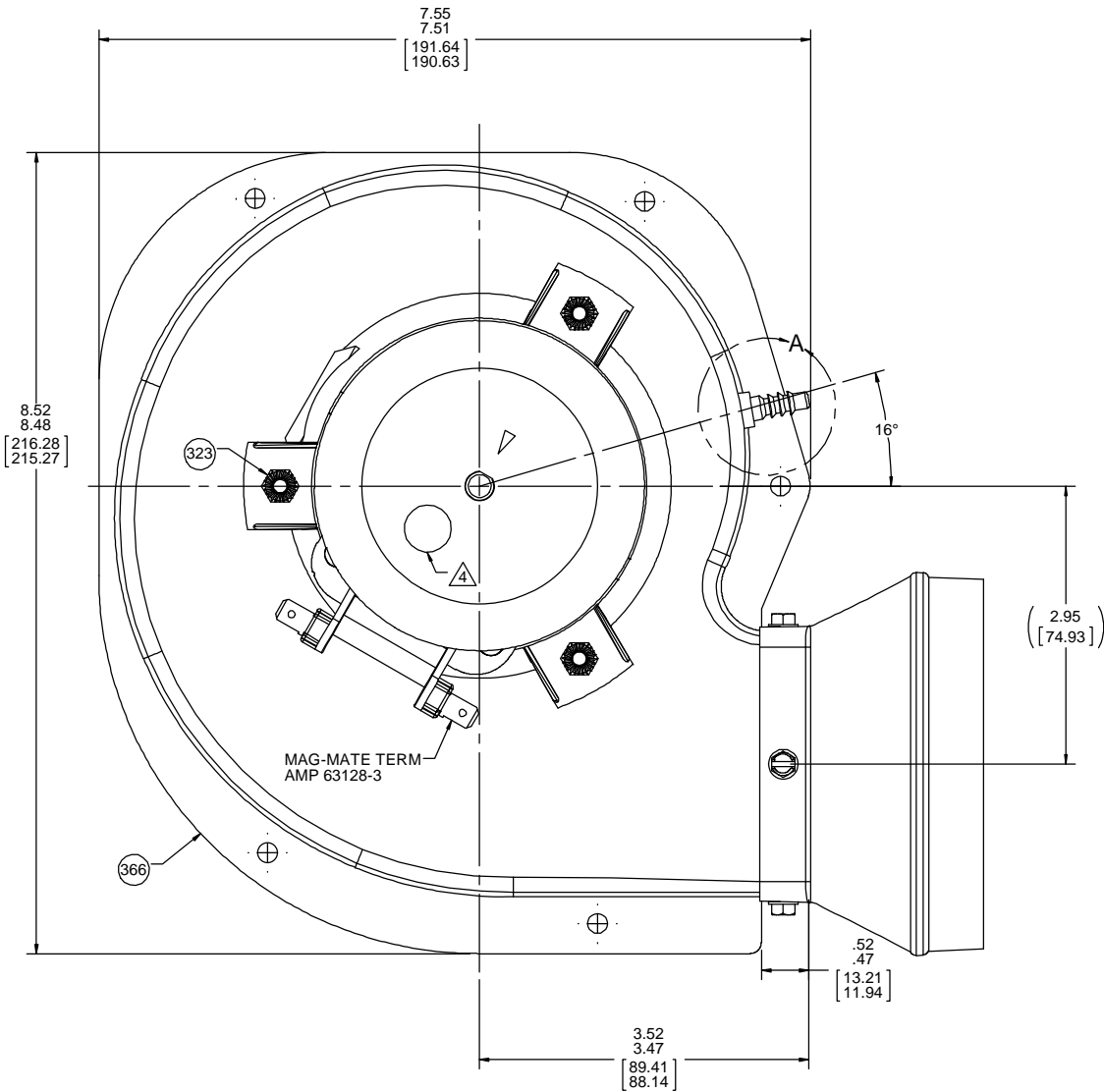

61304322

US PATENT:
6314894, 6318358, 6468034
6494152, 6595146, 6895874
6902373, 6908281, 6929448

APPLY TO MOTOR

TYPICAL PERFORMANCE TEST DATA WITH A 1 5/16 INLET RESTRICTOR			
AT 115 VOLTS 60 Hz			
	RPM	WATTS	AMPS
	3250	83	1.60
BLOWER WEIGHT 4 1/2 LBS.			ENDPLAY .XX/.XX

DRAWING REVISION AA	REVISION BY MLS	DATE 12/14/2017	TOLERANCES UNLESS OTHERWISE SPECIFIED: DEC. INCH mm ANGLE X ±0.1 #2.5 .XX ±0.01 #0.25 .XXX ±0.005 #0.127 XXXX ±0.0005 #0.0127	DRAWN BY MLS	Regal Beloit America, Inc.	
ECO-0135768	APPROVED BY JMG	DATE 12/14/2017	APPROVED BY JMG	DATE 12/14/2017		
ECO DESCRIPTION CHANGED EXHAUST ADAPTER, EFFECTIVE 1/29/2018			REFERENCE		DESCRIPTION OUTLINE BLOWER ASSY	
PROPRIETARY AND CONFIDENTIAL INFORMATION - THIS DOCUMENT IS THE PROPERTY OF REGAL BELOIT AMERICA, INC. COMPANY AND CONTAINS OWNERS PROPRIETARY INFORMATION. ANY PERSON, CORPORATION OR OTHER FIRM RECEIVING IT IS DEEMED, BY RECEIVING IT, TO AGREE THAT IT, AND/OR ANY PART OF IT, SHALL NOT BE DISCLOSED TO ANY PERSON, CORPORATION OR OTHER ENTITY, DUPLICATED, AND/OR USED, EXCEPT AS EXPRESSLY APPROVED IN WRITING IN ADVANCE BY OWNER. THIS DOCUMENT SHALL BE RETURNED TO OWNER UPON REQUEST. IT MAY BE SUBJECT TO CERTAIN RESTRICTIONS UNDER APPLICABLE EXPORT CONTROL LAWS AND REGULATIONS.			THIRD ANGLE PROJECTION		MATERIAL	PROCESS/FINISH NATURAL
mm SHOWN IN [BRACKETS]			SIZE D		DRAWING NUMBER 70581400	SHEET 1 OF 1