

NOTES:

1. INSPECTION TEST FIXTURING IS REQUIRED.
2. STATIC TAP READING IS TO BE -1.56 MINIMUM CORRECTED TO STANDARD AIR ( 0.075 LB/FT<sup>3</sup> ) WITH A 1.25" INLET RESTRICTOR.
3. PACK 1 PER CONTAINER, 36 MAX. PER PALLET, PACKING ASSY. 8785 4916, 12 CONTAINERS PER LAYER, 3 LAYERS PER PALLET, P.S. 8883 4200.
4. CARTON LABELS MUST ALL FACE ONE DIRECTION TOWARD THE OPEN END OF THE PALLET. SEE P.S. 8883 4408.
5. NO PACKING TAPE OVER CARTON LABEL.

APPLICATION	GAS FURNACE							B	LA	FR	A	S	C	E	B	A	
	THERMALLY PROTECTED CLASS "B" INSULATION 416 S.S. SHAFT							PF	21	30	F	06	FR	5	3	0	
CUSTOMER	FASCO DIST.																
CUSTOMER PART NO.	A124																

LEAD MATERIAL  
 18 GA. 125°C 4/64 INSUL.  
 X-LINKED POLY. (2) BLACK  
 14.00/12.00 IN. LONG  
 SOCKET TERM. 8903-6006  
 AMP #350537-1

GROUND LEAD MATERIAL  
 18 GA. 125°C 2/64 INSUL.  
 X-LINKED POLY. GRN/YEL  
 16.00/14.00 IN. LONG  
 RING TERM. 8903-9009  
 AMP #40955

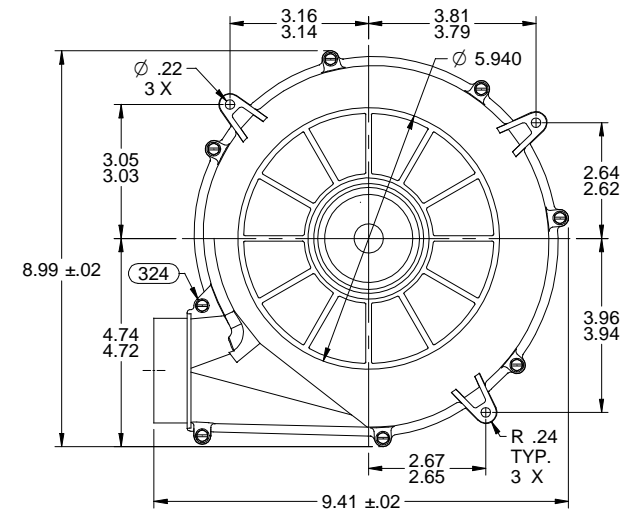
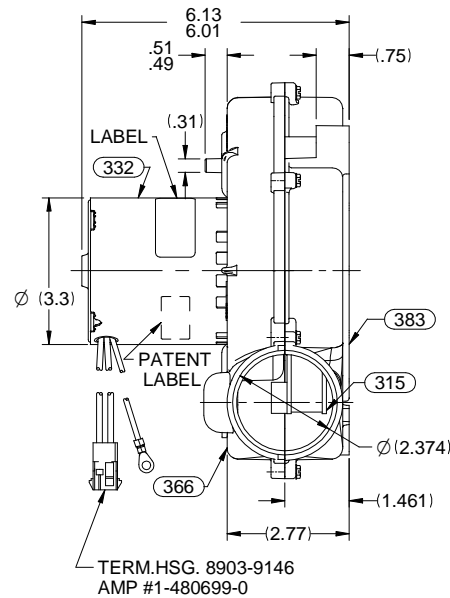
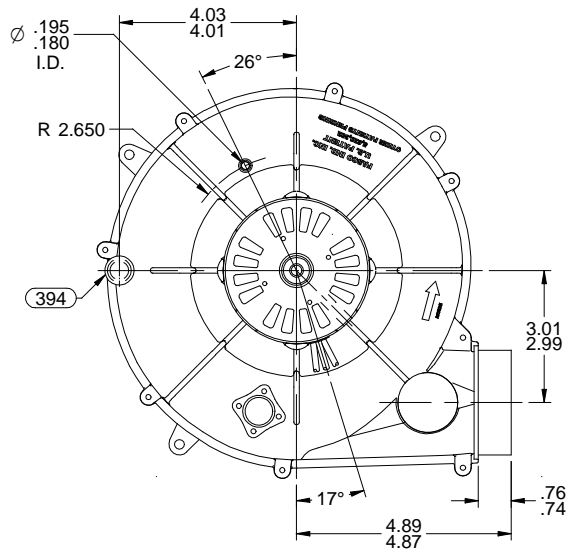

TYPICAL PERFORMANCE TEST DATA WITH A 1.25" INLET RESTRICTOR

AT 115 VOLTS 60 HZ.

UNLESS OTHERWISE SPECIFIED DIMENSIONS ARE IN INCHES TOLERANCES ARE:  
 FRACTIONS ± 1/16 DECIMALS .XX ± .01 ANGLES ± 1°  
 .XXX ± .005

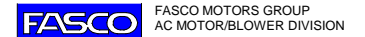

ECO. NO.	REV.	DATE	APPROVAL	R.P.M.	WATTS	AMPS	APPROVALS	DATE
C440053	04	09/03/2010	BGP/SDM	3374	128	1.73	DRAWN PLA	07/22/2005
0054271	05	7/22/2014	BGP/PLA				CHECKED BGP	07/22/2005
0061102	06	9/30/2014	BGP/MLH					
				BLOWER WEIGHT 4 3/4 LBS.			END PLAY .030/.010	FINISH COLOR BLACK

CONFIDENTIAL: DO NOT DUPLICATE OR DISCLOSE TO THIRD PARTIES WITHOUT WRITTEN PERMISSION OF FASCO MOTORS GROUP, AC MOTOR/BLOWER DIVISION.	
TITLE <b>BLOWER ASSEMBLY</b>	
SIZE <b>B</b>	DWG. NO. 7021 11847
DO NOT SCALE DRAWING	SHEET 1 OF 2
REV. 06	