

NAMEPLATE DATA	
MODEL: P56AJ07A01	
CUST PN: H661ES	
HP: 1.5	SF: 1.15
ROT: RCW	
RPM: 3450	
TYPE: SC	CODE: L
FORM:	FRAME: K56J
VOLTS: 230/460	
AMPS: 4.0/2.0	
MAX AMPS: -	
SF AMPS: 4.4/2.2	
PH: 3	HZ: 60
INS: B	AMB: 40°C
DUTY: CONT	
ENCLOSURE: TEFC	

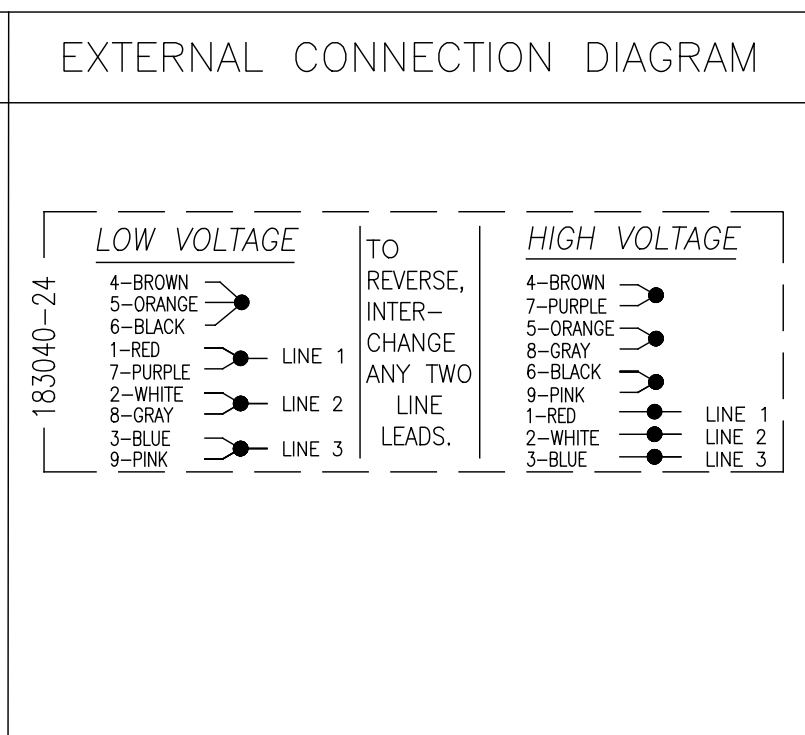

- NOTES
- 1. PILOT DIAMETER IS CONCENTRIC WITH SHAFT CENTERLINE WITHIN .004 T.I.R.
 - 2. FACE OF MOUNTING FLANGE IS PERPENDICULAR TO SHAFT CENTERLINE WITHIN .004 T.I.R.
 - 3. SHAFT RUNOUT NOT TO EXCEED .002 T.I.R.
 - 4. FOR THREADED SHAFT EXT. MATING PARTS SHOULD BE RELIEVED ONE THREAD TO CLEAR FILLET.
 - 5. FOR THREADER SHAFT EXT. ECCENTRICITY OF THREADED PORTION OF SHAFT IS HELD WITHIN .004 TOTAL GAGE READING WITH THE INDICATOR ON O.D. OF GROUND RING AS SHOWN. THE GAGE BEING STATIONARY WITH RESPECT TO THE ROTOR.
 - 6. END PLAY NOT TO EXCEED .010 MEASURED WITH NO THRUST
 - 7. ALL DIMENSIONS SHOWN IN PARENTHESIS ARE REFERENCE DIMENSIONS.

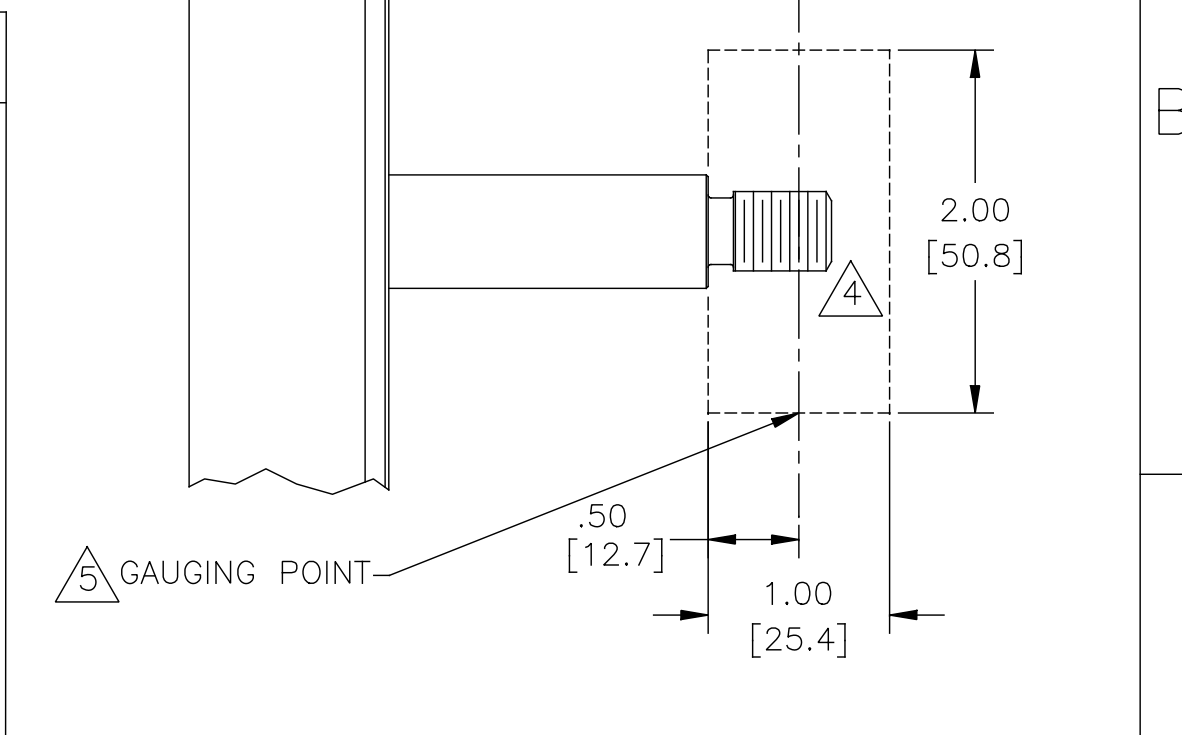

PERFORMANCE CURVE	APPROVED SAMPLE		
SS0098312			
UL COMPONENT	CSA		
FILE#	CCN#	FILE#	GUIDE#
E44549	PRGY2	LR4642	4211-01
CUSTOMER	REGAL DISTRIBUTION		

DRAWING REVISION	REVISION BY	DATE	TOLERANCES UNLESS OTHERWISE SPECIFIED	DRAWN BY:
B	P.ROJAS	03-28-2017	DEC. INCH mm ANGLE	L. ALMARAZ
ECO	APPROVED BY	DATE	.X ±0.1 [±2.5] ±0.5°	DATE:
ECO-0120488	P.ROJAS	03-28-2017	.XX ±0.02 [±0.51]	04/08/2016
SEE ECO			.XXX ±0.005 [±0.127]	APPROVED BY:
			.XXXX ±0.0005 [±0.0127]	D. WENDLING
			REMOVE BURRS & BREAK SHARP EDGES .003/.015 [0.076/.381]	DATE:
			CORNER FILLETS .02 [.51]	04/08/2016
			MACHINED SURFACES 125/32 INCH/mm	REFERENCE
			mm SHOWN IN [BRACKETS]	

REGAL™	Regal Beloit America, Inc.
DESCRIPTION MODEL-CFHP-56FR OUTLINE	
MATERIAL	PROCESS/FINISH
SIZE DWG NO	
C	H661ES
THIRD ANGLE PROJECTION	SHEET 1