

NOTES:
 1. ALL DIMENSIONS SHOWN IN PARENTHESIS ARE REFERENCE DIMENSIONS. ALL OTHER DIMENSIONS ARE TOLERANCED PER THE FOLLOWING CHART UNLESS OTHERWISE SPECIFIED.

"OVERALL" DIMENSION = ±.055[1.397]
 SHAFT EXTENSION = ±.034[.864]
 LEAD LENGTHS = ±1.00[25.40]
 EXTENDED THRU-BOLTS = ±.050[1.270]
 ANGULAR DIMENSIONS = ±2°

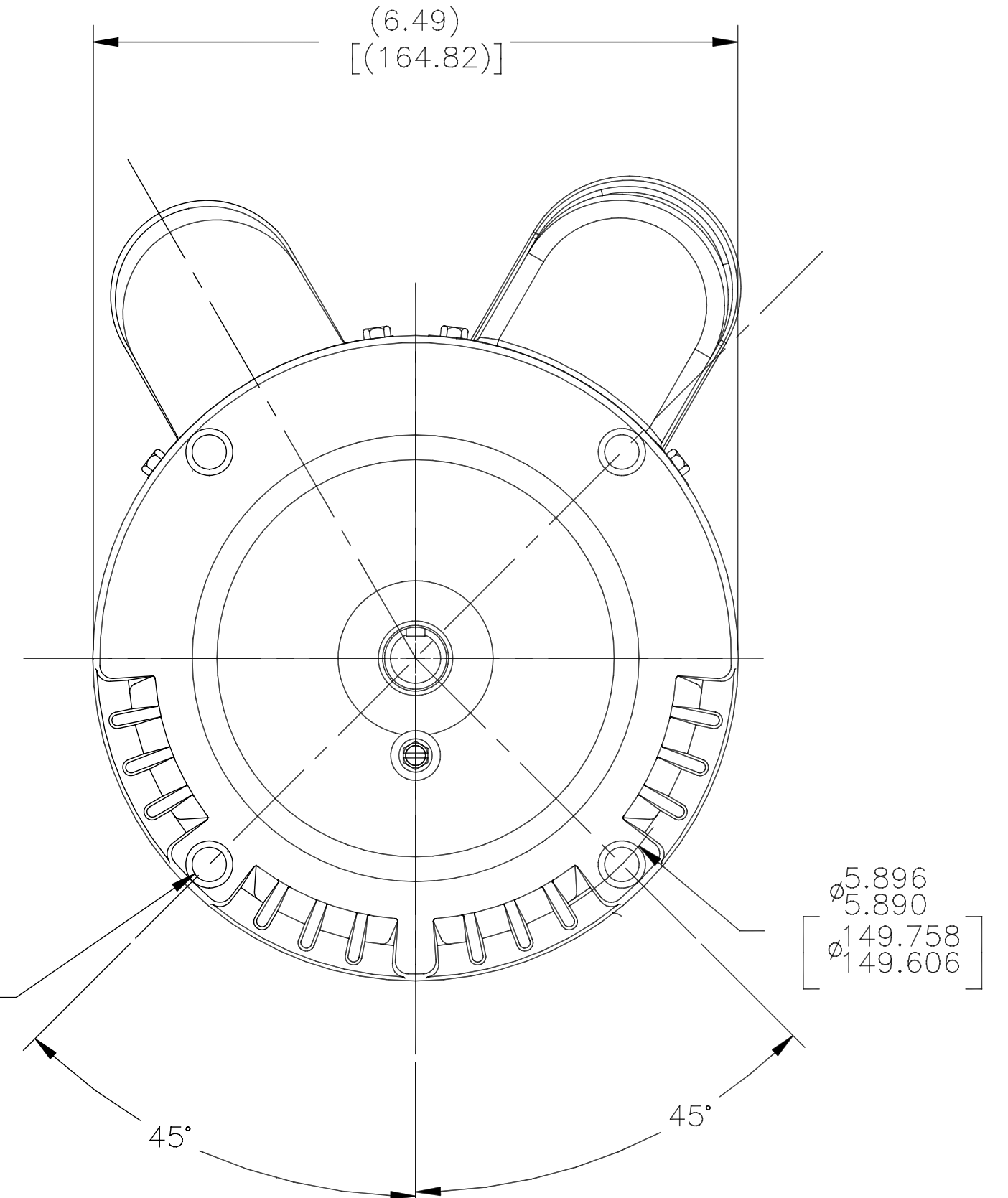
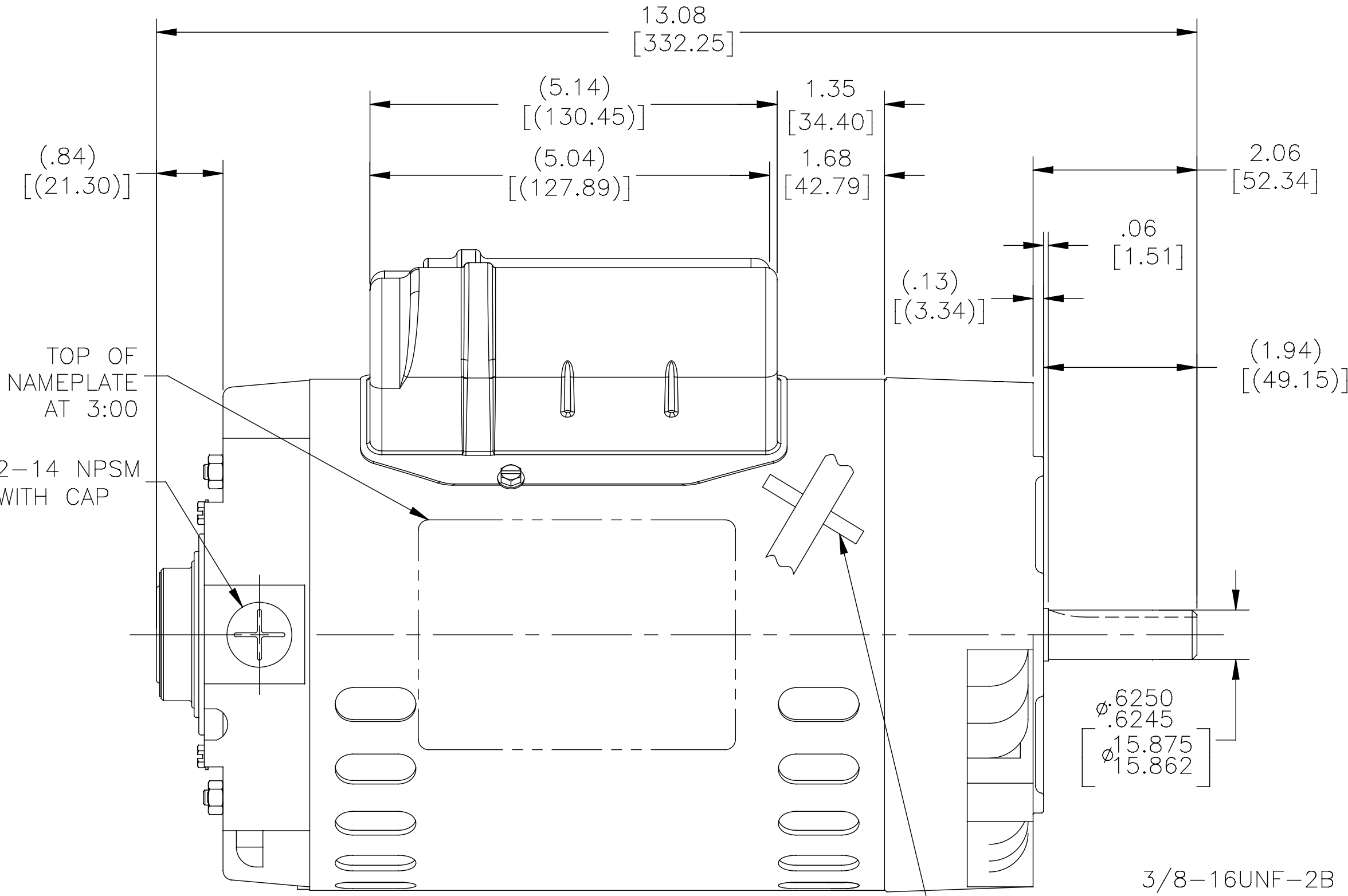
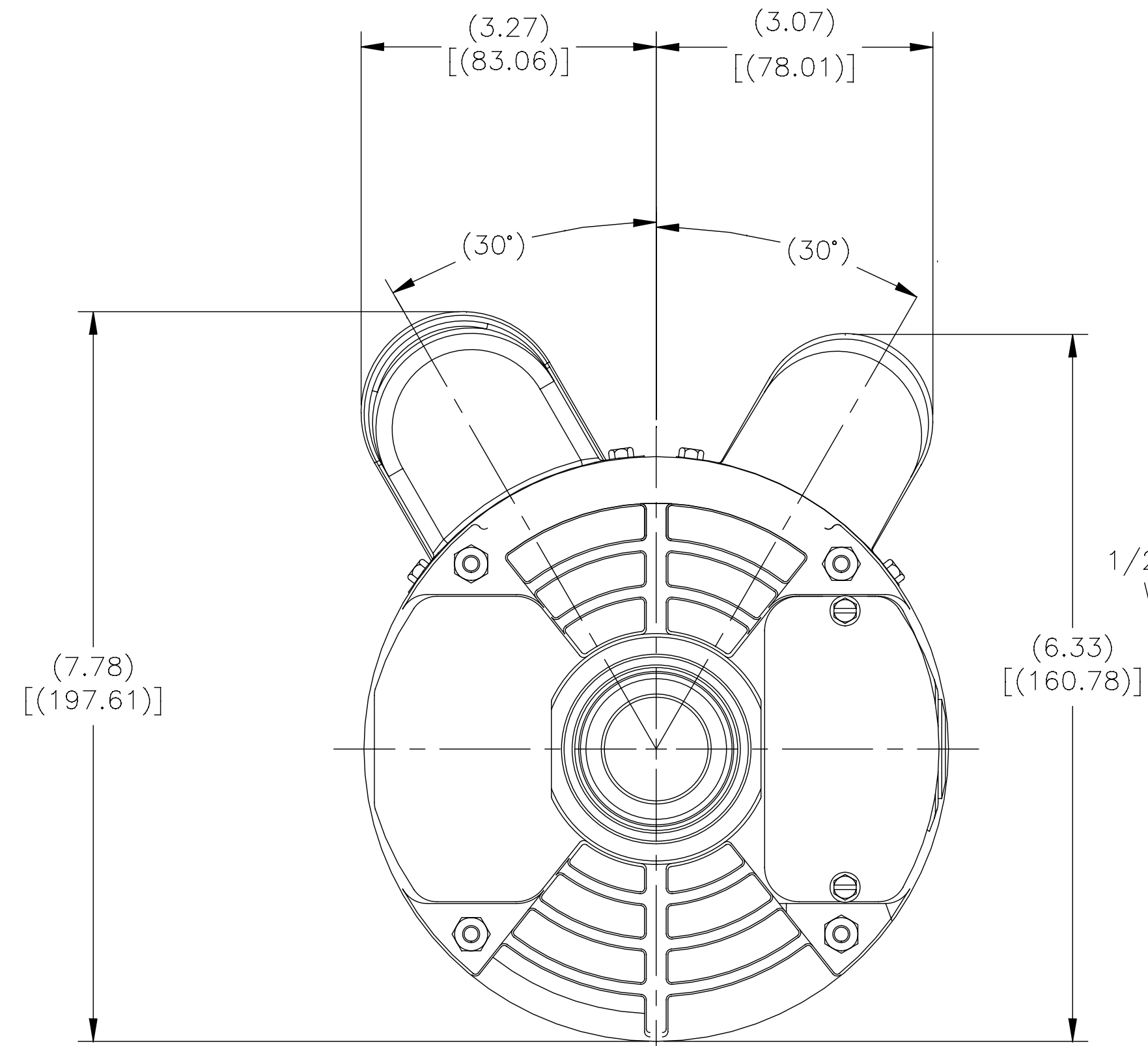

3/8-16UNF-2B
 .56 MIN. FULL THD. 4 HOLES

3/16 X 3/16 X 1.38[35.05] LONG KEY (TAP IT ON THE MF BEFORE SHIP)

DRAWING REVISION C	REVISION BY X.JIAN	DATE 06-25-2015	TOLERANCES UNLESS OTHERWISE SPECIFIED DEC: INCH mm ANGLE	DRAWN BY H.ZHANG	
ECD ECO-0079651	APPROVED BY H.ZHANG	DATE 06-25-2015	.XX ±0.02 [±0.51] .XXX ±0.005 [±0.127] .XXXX ±0.0005 [±0.0127]	DATE 10-20-2014	
EEO DESCRIPTION SFE ECO			REMOVE BURRS & BREAK SHARP EDGES .003/0.015 [0.076/0.381]	APPROVED BY H.ZHANG	DESCRIPTION MODEL-CFHP-56FR OUTLINE
COPYRIGHT REGAL BELOIT AMERICA, INC. ALL RIGHTS RESERVED. REGAL BELOIT AMERICA, INC. (PARENT) AND COMPANY ARE PROPRIETARY INFORMATION. NO REPRODUCTION OR OTHER USE IS PERMITTED WITHOUT THE WRITTEN PERMISSION OF REGAL BELOIT AMERICA, INC. THIS DOCUMENT IS UNCONTROLLED COPY. IT IS THE USER'S RESPONSIBILITY TO OBTAIN THE LATEST EDITION OF THIS DOCUMENT. REGAL BELOIT AMERICA, INC. IS NOT RESPONSIBLE FOR ANY DAMAGE TO PROPERTY OR PERSONS ARISING FROM THE USE OF THIS DOCUMENT.			CORNER FILLETS .02 [51]	DATE 10-20-2014	
			MACHINED SURFACES: INCH: √ mm: √	REFERENCE	MATERIAL
			mm SHOWN IN [BRACKETS]	THIRD ANGLE PROJECTION	PROCESS/FINISH
				SIZE (DWG NO)	SHEET
				D C445ES	1