

DETAIL OF GROUND SCREW INSTALLATION UNDER COVER OF FRONT END FRAME

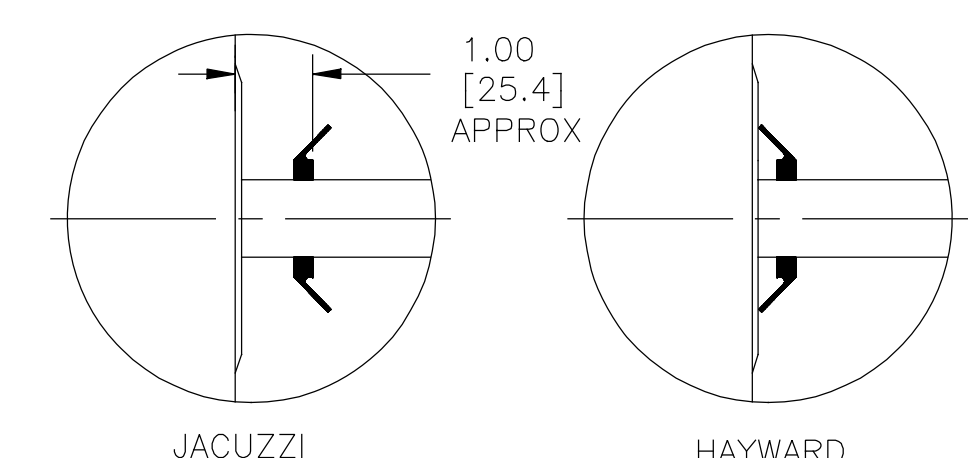

OPTIONAL SLINGER DETAIL

OPTIONAL SLINGER 11020806 ,WHEN REQ'D, MOUNT FLUSH AGAINST END FRAME HUB WITH OUTSIDE DIAMETER TOWARD END FRAME FOR HAYWARD. FOR JACUZZI, MOUNT AWAY FROM END FRAME, APPROX. 1.00[25.4] FROM END FRAME OR HALFWAY DOWN SHAFT.

| NAMEPLATE DATA   |  | EXTERNAL CONNECTION DIAGRAM | NOTES   |
|--|--|-----------------------------|---|
| MODEL: 177781<br>CUST PN: BN36<br>HP: - SF: -<br>ROT: CCWPE<br>RPM: 3450/1725<br>TYPE: SPM CODE: A<br>FORM: - FRAME: R48Y<br>VOLTS: 115<br>AMPS: 8.8/2.6<br>MAX AMPS: -<br>SF AMPS: -<br>PH: 1 HZ: 60<br>INS: B AMB: 40°C<br>DUTY: CONT<br>ENCLOSURE: ODP<br>THERMALLY-PROTECTED |  | 178887-24<br>               | 1. THE BOTTOM TWO THRU BOLTS IN SHAFT END END FRAME ARE TO BE PARALELL TO BASE WITHIN (.060)[(1.52)].<br>2. LEAD END FRAME TO BE ORIENTED TO DRIVE END FRAME TO WITHIN ±2°.<br>3. ALL DIMENSIONS SHOWN IN PARENTHESIS ARE REFERENCE DIMENSIONS. |

| PERFORMANCE CURVE | APPROVED SAMPLE |        |         |
|-------------------|-----------------|--------|---------|
| 17118811          | -               |        |         |
| UL COMPONENT      | CSA             |        |         |
| FILE#             | CCN#            | FILE#  | GUIDE#  |
| E14663            | XEWR2           | LR4642 | 4211-01 |
| CUSTOMER          | DISTRIBUTION    |        |         |

| DRAWING REVISION | REVISION BY  | DATE       | TOLERANCES UNLESS OTHERWISE SPECIFIED                   |
|------------------|--------------|------------|---|
| G                | G. RODRIGUEZ | 04-26-2019 | DEC. INCH mm ANGLE                                      |
| ECO              | APPROVED BY  | DATE       | .XX ±0.1 [±2.5] ±0.5°                                   |
| ECO-0165900      | G. RODRIGUEZ | 04-26-2019 | .XX ±0.02 [±0.51]                                       |
| ECO DESCRIPTION  |              |            | .XXX ±0.005 [±0.127]                                    |
| SEE ECO          |              |            | .XXXX ±0.0005 [±0.0127]                                 |
|                  |              |            | REMOVE BURRS & BREAK SHARP EDGES .003/.015 [0.076/.381] |
|                  |              |            | CORNER FILLETS .02 [.51]                                |
|                  |              |            | MACHINED SURFACES 125/3.2                               |
|                  |              |            | mm SHOWN IN [BRACKETS]                                  |

| DRAWN BY:              | DATE:       | DESCRIPTION | MATERIAL | PROCESS/FINISH |
|------------------------|-------------|-------------|----------|----------------|
| T.REYES                | 08-16-2010  | OUTLINE     |          |                |
| APPROVED BY:           | DATE:       | REFERENCE   |          |                |
| S.JIMENEZ              | 08-16-2010  |             |          |                |
| THIRD ANGLE PROJECTION | SIZE DWG NO |             |          |                |
|                        | C           | BN36        |          |                |
|                        |             |             |          | SHEET 1        |