

RPM-AC FINNED FRAME VARIABLE SPEED ALTERNATING CURRENT MOTOR UFL & FL2890

617531-025

ENCLOSURE: TOTALLY ENCLOSED
MOUNTING: FOOT
DRIVE METHOD: COUPLED OR BELTED

COOLING: BLOWER COOLED
ACCESSORIES: ENCODER

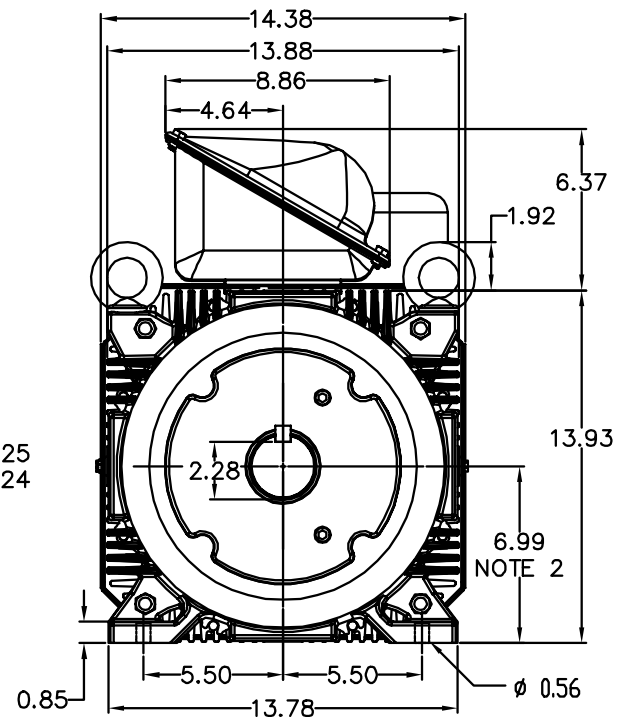
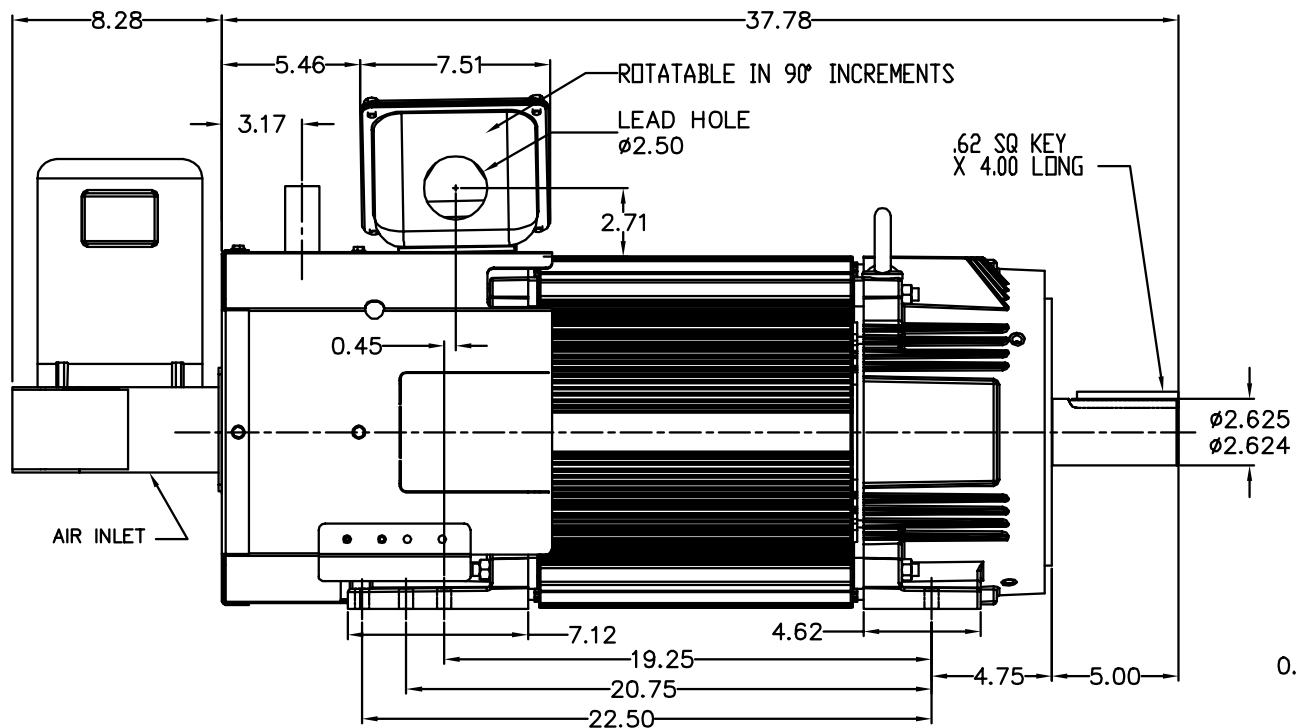

NOTE 1: O.D.E. C-FACE & TACHOMETER MOUNTING
1/2-13 TAP, 1.00 DEEP, ON A Ø 7.25 B.C.
FACE RUNDOUT AND ECCENTRICITY 0.004 MAX. T.I.R.

NOTE 2: SHAFT HEIGHT WILL NOT BE EXCEEDED
SHIMS UP TO 0.03 INCHES IN THICKNESS ARE USUALLY
REQUIRED FOR COUPLED OR GEARED MACHINES

TERMINAL BOX MAY BE LOCATED F1 OR F2 IF SPECIFIED
160 AMP STEEL TERMINAL BOX SHOWN

DIMENSIONS ARE IN INCHES
MOTOR WEIGHT: 890 LBS. (MAY VARY 15%)

CUSTOMER IS RESPONSIBLE FOR DETERMINING THAT THIS PRODUCT WILL PERFORM SUITABLY IN THE INTENDED APPLICATION.

REV. DESC: CHANGE FAN COVER FROM 708535-10B TO -10C		
REV. LTR: F	VERSION: 06	TDR: 000001083672
FILE: \RGG\00017\591	REVISED: 08:33:26 09/11/2018	BY: RGGWT
MTL: -		

BALDOR - RELIANCE®

DIM SHT,FL2890Z,TEA0-BC,TACH,STD.SHAFT EXT,RMM BLWR

SH 1 of 1

617531-025