

# DUTY MASTER ALTERNATING CURRENT MOTORS

## SQUIRREL-CAGE INDUCTION

ENCLOSURE: TOTALLY ENCLOSED

MOUNTING: FOOT, F-1

GL449TS/449TS FRAME MOUNTING

COOLING: FAN COOLED

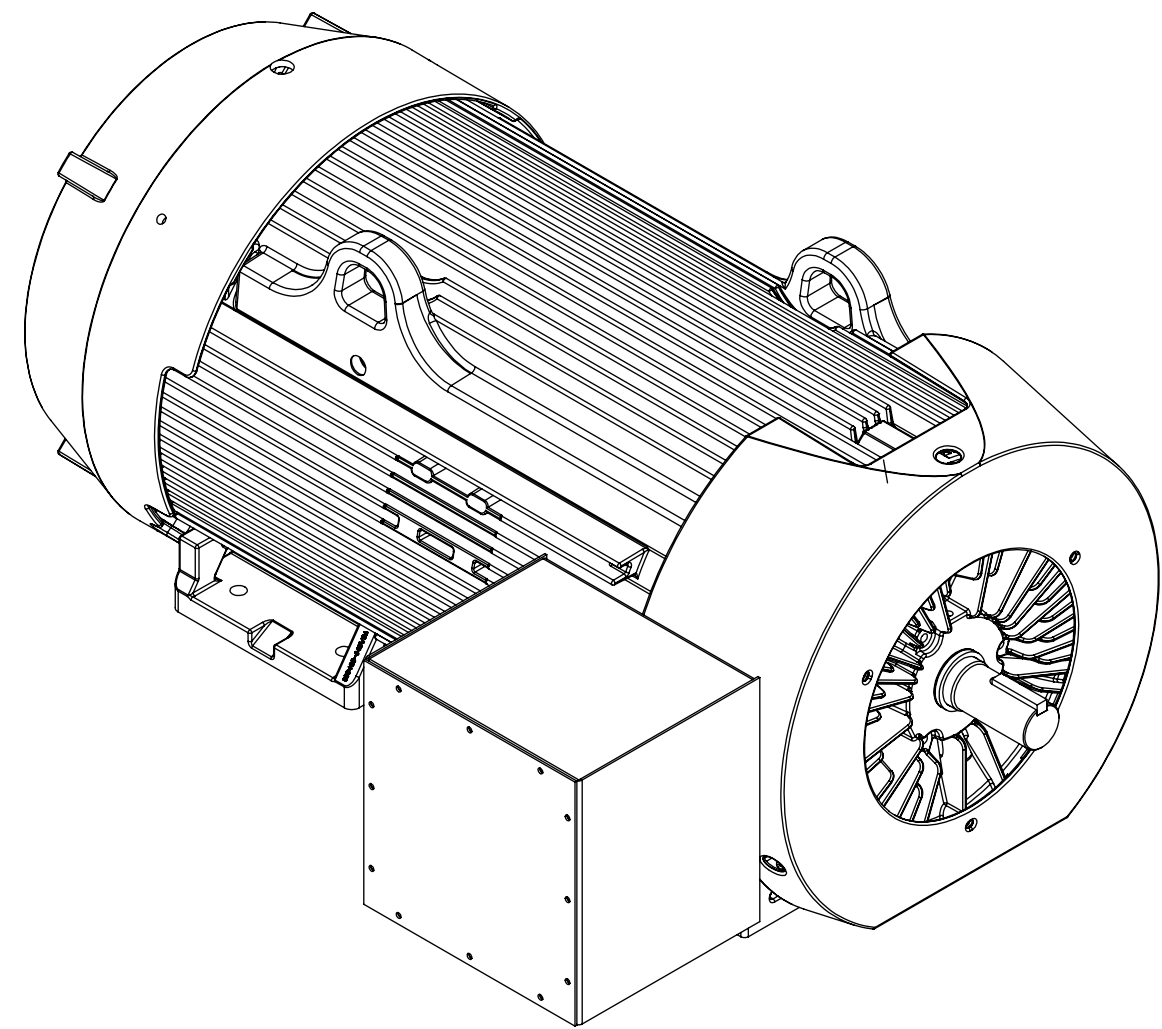
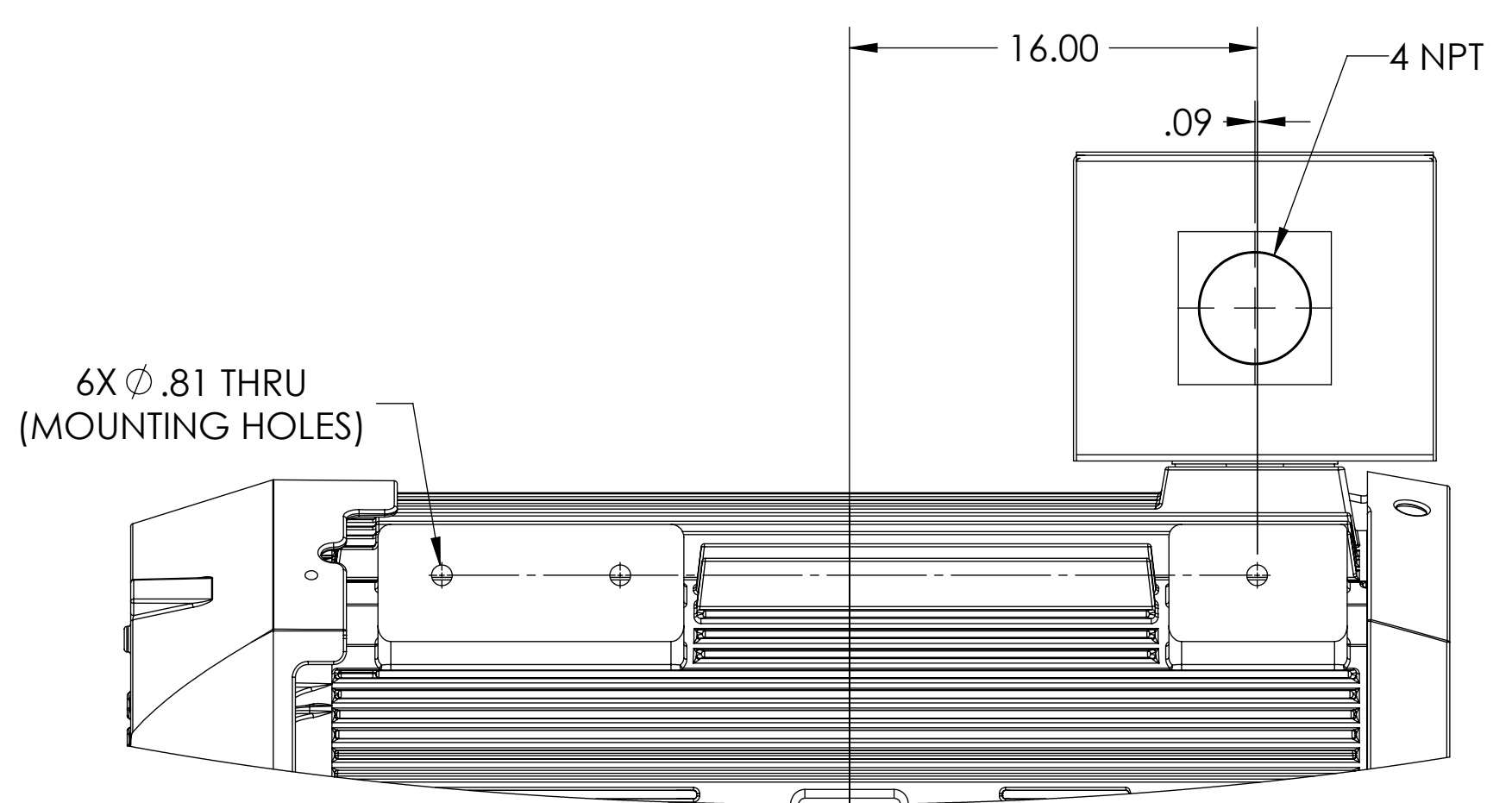
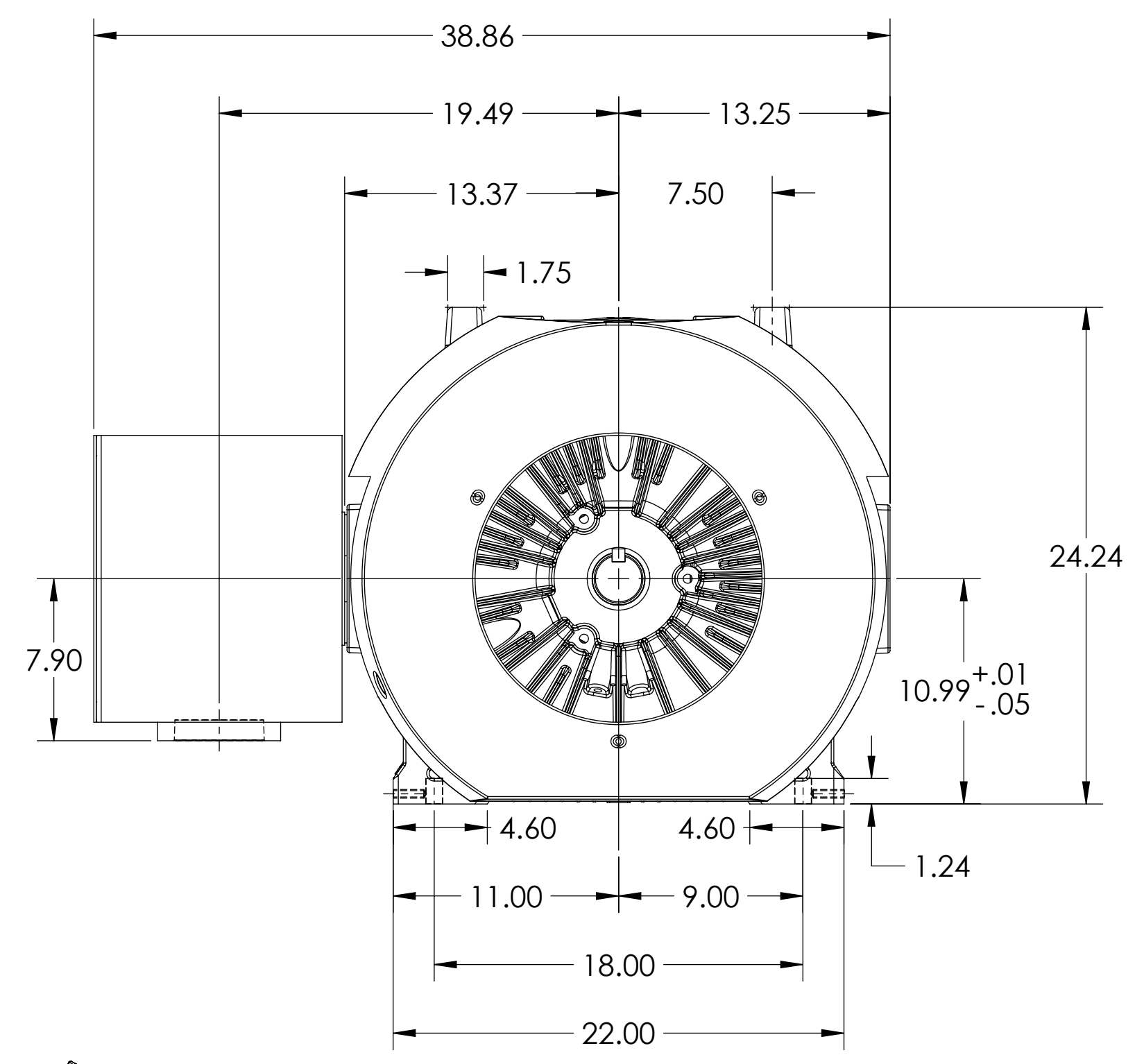
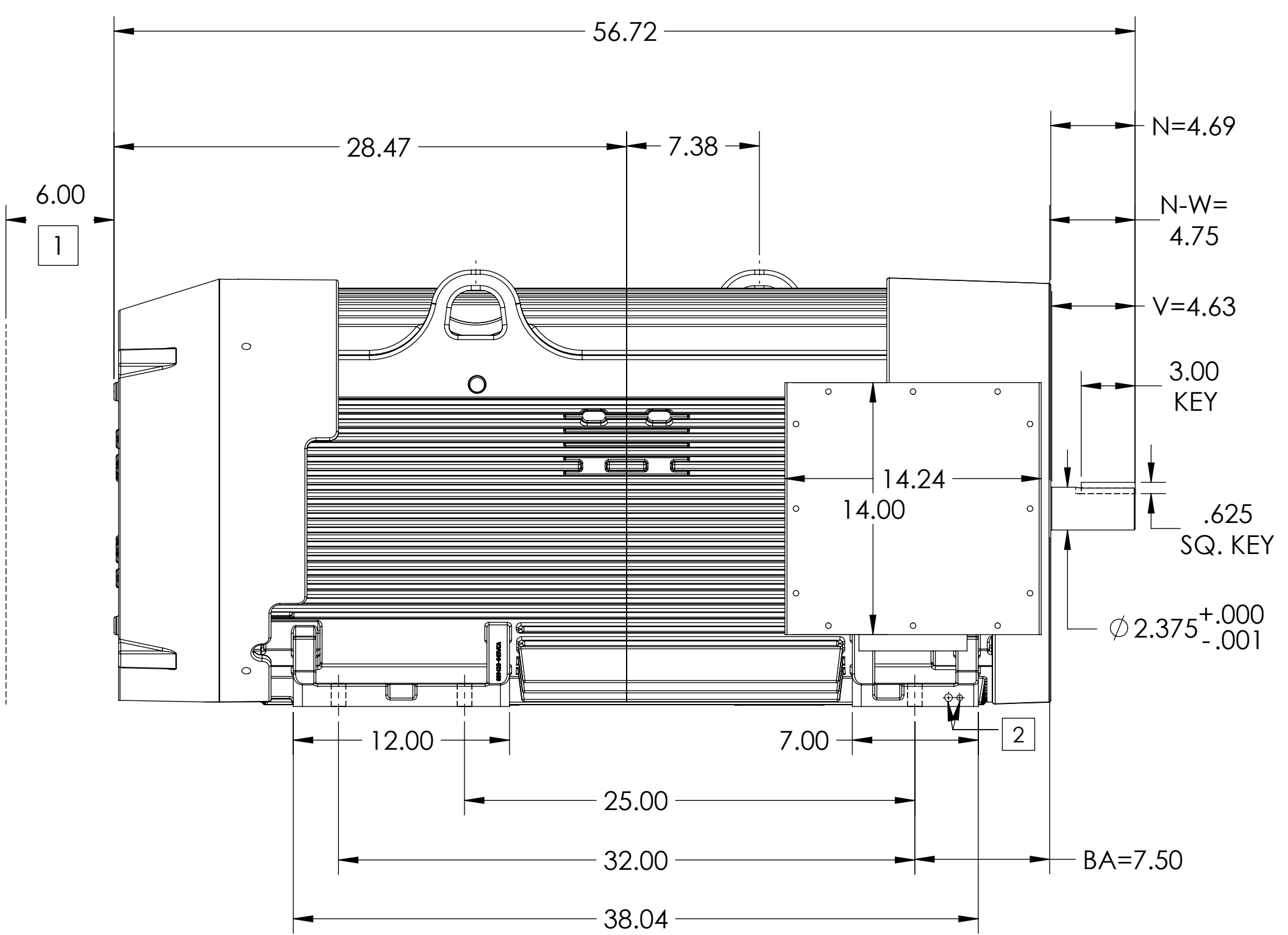

- 1 OBSTRUCTION MUST NO ENCROACH ON AIR INLET.
- 2 (1) 3/8-16 & (1) 1/2-13 GROUNDING TAPS (BOTH SIDES).

IF MOUNTING CLEARANCE DETAILS ARE REQUIRED, CONSULT FACTORY.  
 MAX PERMISSIBLE SHAFT RUNOUT WHEN MEASURED AT END OF STANDARD SHAFT EXTENSION IS .003" T.I.R.

DIMENSIONS ARE IN INCHES.  
 CUSTOMER IS RESPONSIBLE FOR DETERMINING THAT MOTOR PERFORMANCE IS SUITABLE IN THE APPLICATION.

REV. DESC: ADDING AIR DEFLECTOR	VERSION: 01	REVISED: 03:37:24 12/11/2017	TDR: 000001053899
MODEL NO. 617435-427			
BY: USJEDIL			

**BALDOR**

GL449/449TS F1 TEFC FT SIDE MNT 14X14X12 STEEL BOX W/ 4" NPT