

DUTY MASTER ALTERNATING CURRENT MOTORS
SQUIRREL-CAGE INDUCTION

617431-807

ENCLOSURE: UNDERWRITERS LISTED

MOUNTING: FOOT, F-1

G405T/G404T FRAME MOUNTING HOLES

COOLING: FAN COOLED

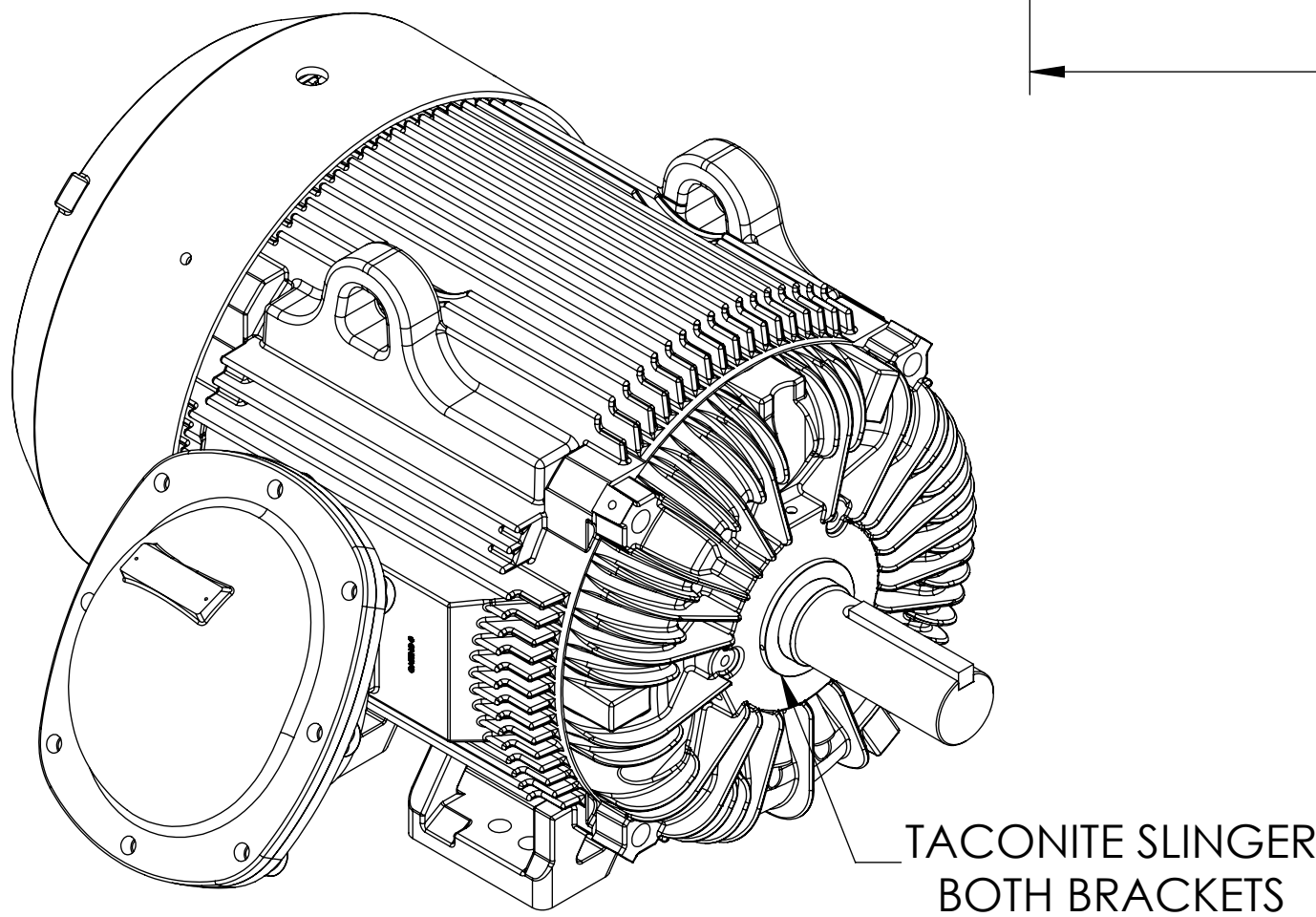
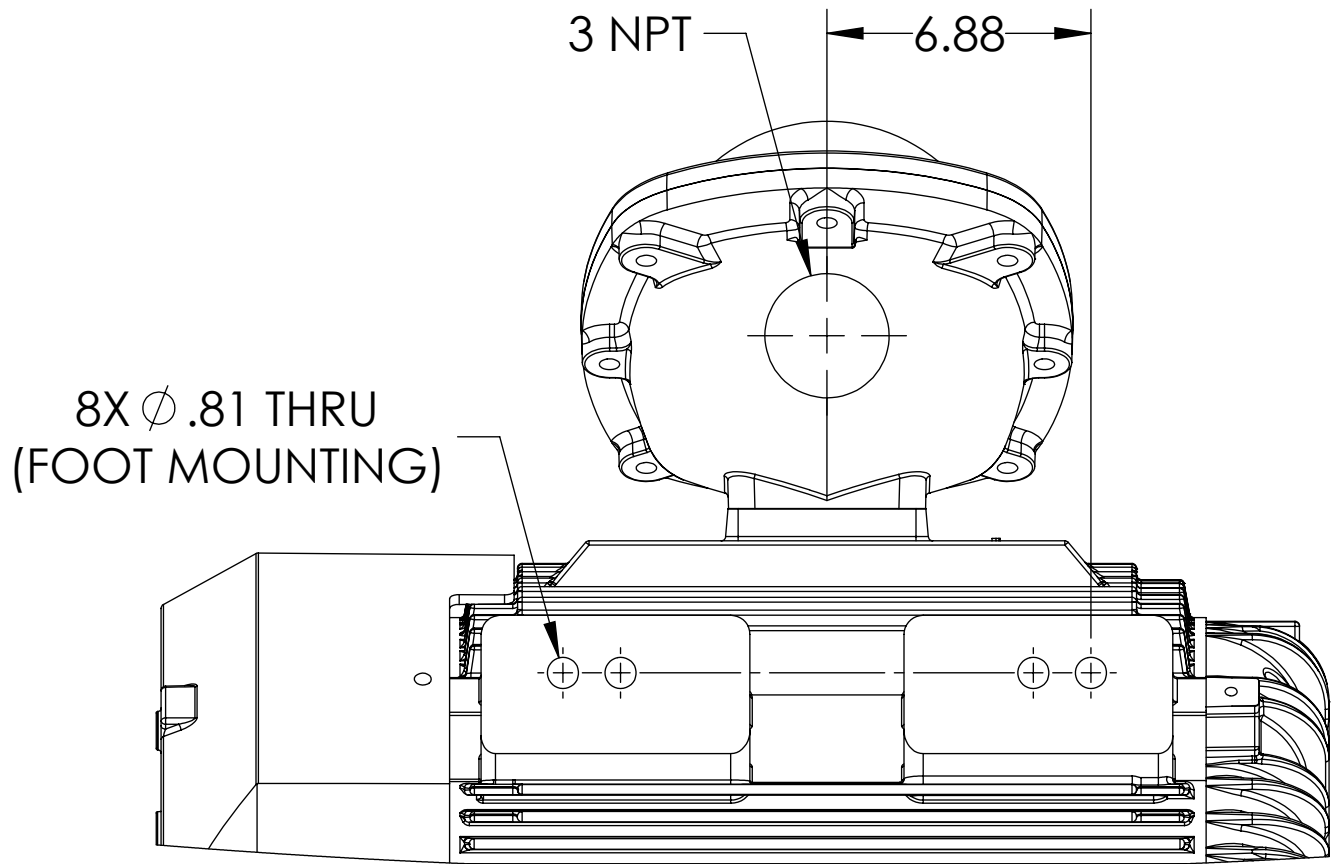
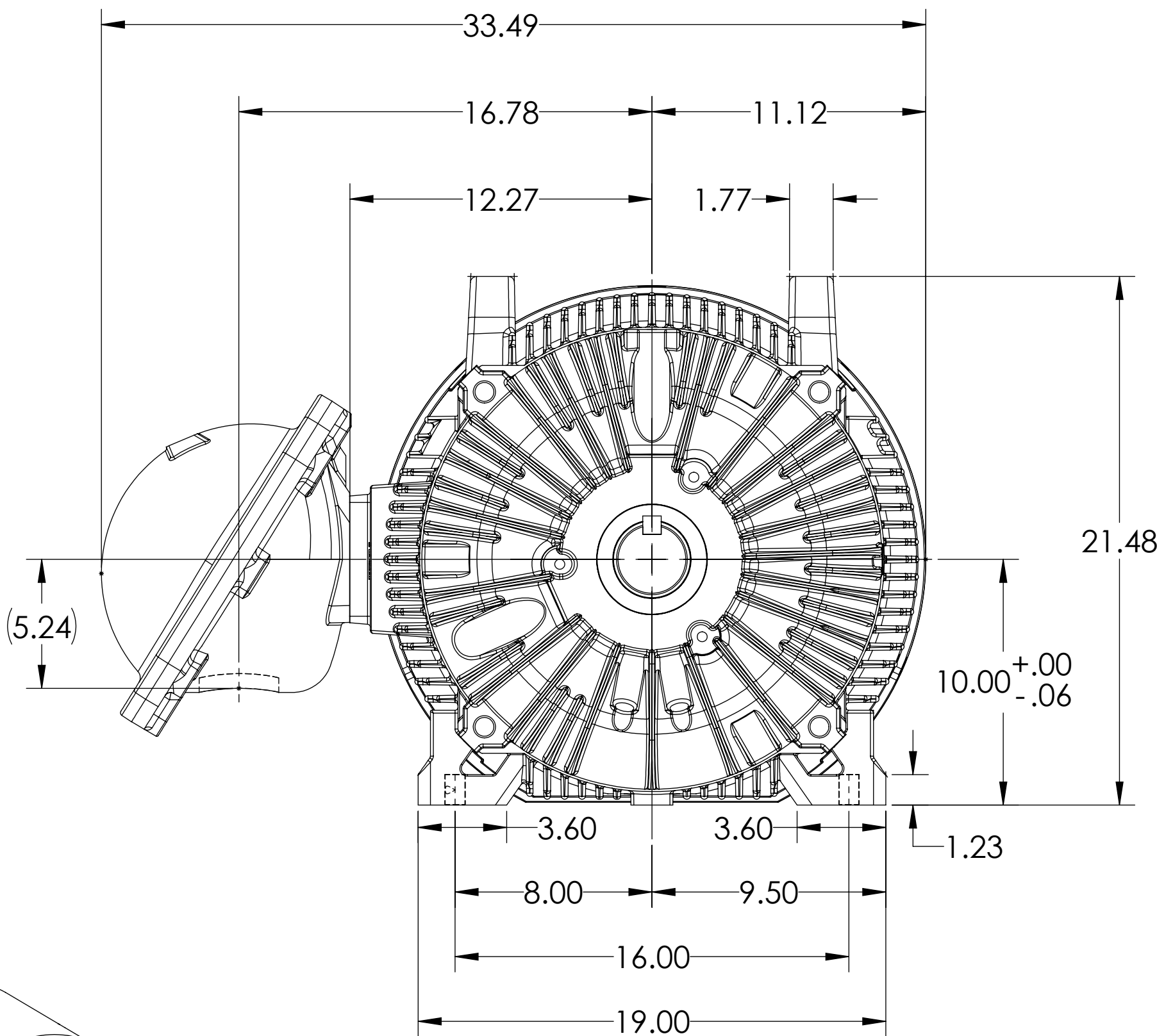
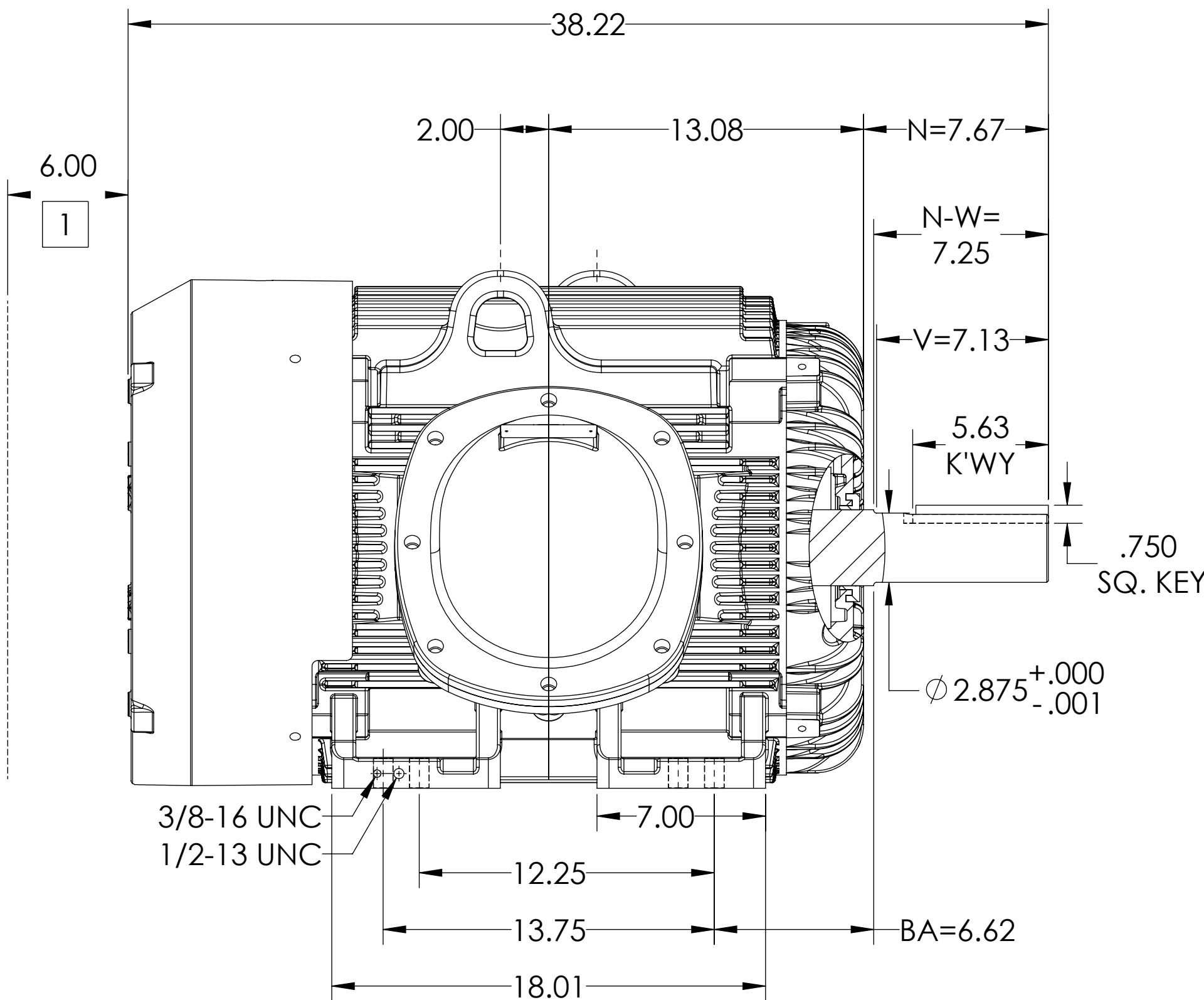

1 OBSTRUCTION MUST NOT ENCROACH ON AIR INLET.

IF MOUNTING CLEARANCE DETAILS ARE REQUIRED, CONSULT FACTORY.
WEIGHT (LBS): 1400, MOTOR WEIGHTS MAY VARY BY 15% DEPENDING ON RATING.
MAX PERMISSIBLE SHAFT RUNOUT WHEN MEASURED AT END OF STANDARD SHAFT EXTENSION IS .003" T.I.R.

DIMENSIONS ARE IN INCHES.
CUSTOMER IS RESPONSIBLE FOR DETERMINING THAT MOTOR PERFORMANCE IS SUITABLE IN THE APPLICATION.

REV. DESC: UPDATE DS QUALITY			
REV: A	VERSION: 01	REVISED: 09:46:17 10/12/2017	TDR: 000001044865
MODEL NO. 617431-807			REF:
BY: USJEDIL		Material:	C

BALDOR

G405T/404T XP TEFC F1 FOOT CAST IRON BOX/TACONITE SLINGERS

SHEET NUMBER
1 OF 1

617431-807

617431-807