

# HERBERT

## ***MC Precision Vice Mc Sub-table Series CIM. FMS. FA Best Choice***



TAIWAN EXCELLENCE





**5**  
**QUICK-CHANGE**



**7**  
**QUICK-CHANGE**  
BLS-2520



**9**  
**HMG type**  
HMG-6025/6040/6050/6063  
HMG-9025/9040/9050/9063



**13**  
**HMG type**  
HMG-xxxx-FV



**14**  
**HMG type**  
HMG-xxxx-xS



**15**  
**MB type**  
MB-100AB/130AB  
/160AB/200AB



**17**  
**TMV type**  
TMV-100/130/160



**19**  
**MBT type**  
MBT-160



**21**  
**VSP type**  
VSP-200G/250G



**23**  
**VSP type**  
VSP-160L/200L



**25**  
**VSP type**  
VSP-100/130/160/200



**27**  
**VCP type**  
VCP-200G/250G/160L/200L



**29**  
**VCP type**  
VCP-100/130/160/200



**31**  
**VIP type**  
VIP-100/130/160/200



**33**  
**VIP type**  
VIP-160S



**34**  
**MPV type**  
MPV-160S



**35**  
**MPV type**  
MPV-100A/130A/160A/200A



**37**  
**MHV type**  
MHV-100A/130A/160A/200A



**39**  
**MB type**  
MB-100A/130A/160A/200A



**41**  
**VSC type**  
VSC-100/130/160/200



**43**  
**MLD type**  
MLD-100A/160A



**45**  
**MLD type**  
MLD-100/160



**47**  
**MVS type**  
MVS-115



**49**  
**HNSP type**  
HNSP-100/130/160/200



**51**  
**MVS type**  
MVS-130/160/180/200





53

**MPV-L** type  
MPV-160L/200L



55

MC UNIVERSAL ANGLE-FIXED  
AND POWERFUL-TYPE  
ONE-UNIT VERTICAL PRECISION VICE



57

MC MECHANICAL-TYPE  
PRECISION VICE



59

MC MECHANICAL-TYPE  
PRECISION VICE



61

MC UNIVERSAL ANGLE-FIXED AND  
POWERFUL-TYPE TWO-AND  
FOUR-UNIT VERTICAL  
PRECISION VICE WITH  
FOUR VERTICAL  
CLAMPING BARRELS



63

**MPV** type  
MPV-160LL/200LL



64

**MPV** type  
MPV-100A/130A/160A/200A



64

**HTC** type



65

**HBC** type  
HBC-170



66

**HS** type  
HS-100/125/150/200



67

**HN** type  
HN-100/150



68

**V** type  
V6/V688/V690/V810



69

**VS** type  
VS-130



69

**HT** type  
HT-150



69

**BT** type  
BT-100/150/200



70

MC SUB-TABLE SERIES



71

MC SUB-TABLE SERIES



72

MC UNIVERSAL BLOCKS SERIES  
(4 FACE TYPE-T-SLOTS)



73

MC DOUBLE SIDED  
TOOLING COLUMN



74

MC ANGLE PLATE



75

SPECIAL APPLICATION JAW PLATES  
(VSP/VCP)



78

SPECIAL APPLICATION JAW PLATES  
(MPV/VIP)



### PRECISION INSPECTION

#### TYPE SPECIFICATION

**HMG**  
**VSP**  
**VCP**  
**VIP**  
**MPV**  
**MHV**  
**MB**  
**VSC**  
**MVS**  
**HNSP**

According to JIS 0 grade inspection specification but more strictly. All 100% inspected.

#### INSPECTION METHOD

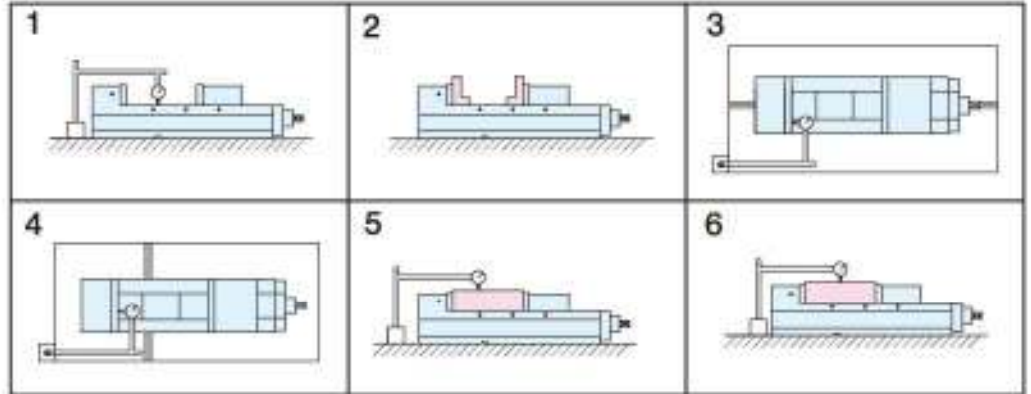

#### PRECISION SPECIFICATIONS.

No.	Item (100mm)	JIS grade 0	Standard
1	Sliding surface of vice jaw parallel to bottom of vice body.	0.015	0.010
2	Vice jaw square to sliding surface of vice jaw.	0.030	0.015
3	Sliding surface of vice jaw square to T slot of vice bottom.	0.015	0.015
4	Sliding surface of vice jaw parallel to T slot of vice bottom.	0.015	0.015
5	After test block clamped tightly, top of test block parallel to bottom of vice.	0.020	0.015
6	After test block clamped tightly, lift degree of test block.	0.030	0.015





### PARTICULAR POWERFUL PRESSURE-INCREASING PRINCIPLE



PATENT NUMBER 112490  
184869  
GERMANY 201125447  
CHINE ZL01231630X

Make a comparison between powerful and other hydraulic after one hour of operation.

#### Features:

1. Pressure-increasing principle is based on enlarged principle of the machine to clamp the workpiece. (Clamping force is more than those of other hydraulic vices.)
2. Clamping force can be adjusted according to your need (See above chart.)
3. Because other oil pressure vices have the defects of oil leaking and oil-seal wear, our vices can avoid the above-mentioned defects and keep stable clamping force. (as right chart).
4. Unstable temperature will affect the processing accuracy if you use a traditional hydraulic vice.
5. If you want to get high pressure, you can rotate two circles on our powerful vice instead of rotating five circles on the handle of other hydraulic vices, so you can save processing time.

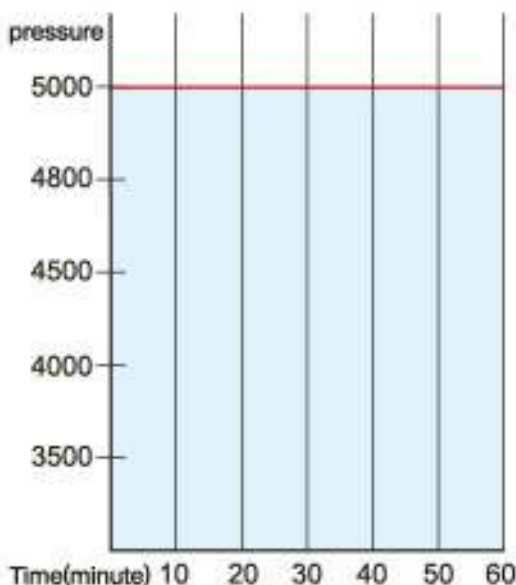

Powerful pressure structure

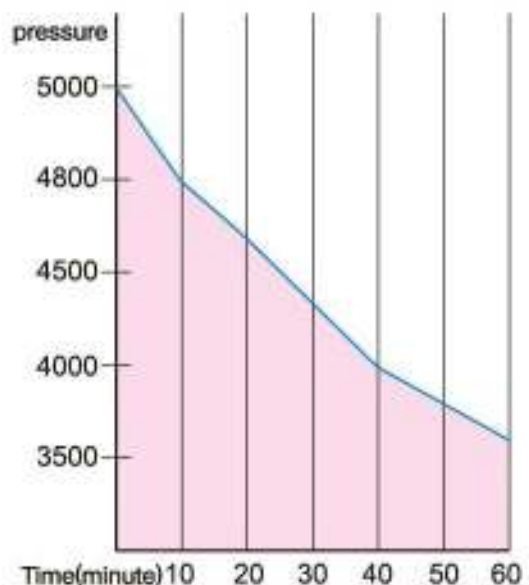

Other hydraulic structure

**PATENT NUMBER**  
**M358693**



**MODEL:** BLS-300  
BLS-400  
BLS-500  
BLS-630  
BLS-800

**Standard Accessories**

HP-BLSx1, HM-BLSx2, BLS25x2

**Features:**

This positioning unit is suitable for quick mold or fixture exchange on CNC horizontal or vertical machines. (Shortening loading time)  
Repeatability can be retained within  $\pm 0.01\text{mm}$ .  
Positioning and locking in an action.



**MODEL:** BLS-400x150x500  
BLS-500x200x600  
BLS-630x250x700  
BLS-800x300x800

**Standard Accessories**

BCB-BLSx1, BLS25x2, HM-BLSx2





## BALL LOCK SYSTEM



**MODELE: BLS-25**

**HP-BLS**

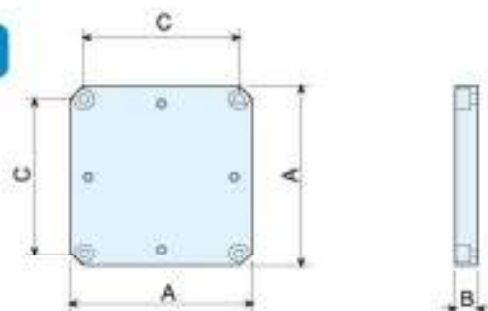

MODEL	A	B	C
HP-300x300x40-BLS	300	40	240
HP-400x400x40-BLS	400	40	320
HP-500x500x45-BLS	500	45	400
HP-630x600x50-BLS	630	50	500
HP-680x630x50-BLS	800	50	500

**HM-BLS**

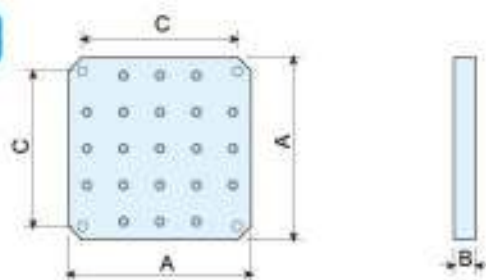

MODEL	A	B	C
HM-300x300x25-BLS	300	25	240
HM-400x400x25-BLS	400	25	320
HM-500x500x30-BLS	500	30	400
HM-630x600x30-BLS	630	30	500
HM-680x630x30-BLS	800	30	500

**BCB-BLS**

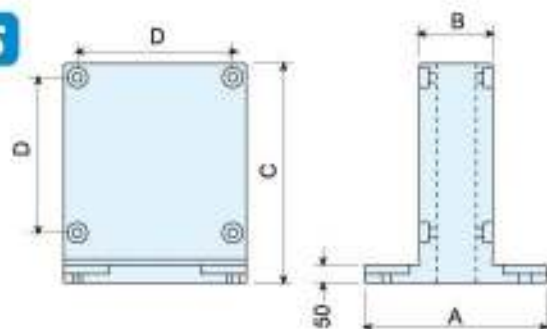

MODEL	A	B	C
BCB-400x150x500-BLS	400	150	500
BCB-500x200x600-BLS	500	200	600
BCB-630x250x700-BLS	630	250	700
BCB-800x300x800-BLS	800	300	800

- The comparison of time taken to lock a fixture with or without this quick-change positioning unit:  
 It takes about 30 seconds to mount the fixture in Fig. A.  
 It takes about 5 minutes 30 seconds to mount the fixture in Fig. B.



Fig. A



Fig. B

ISO-9001:2008

PATENT NUMBER M358693

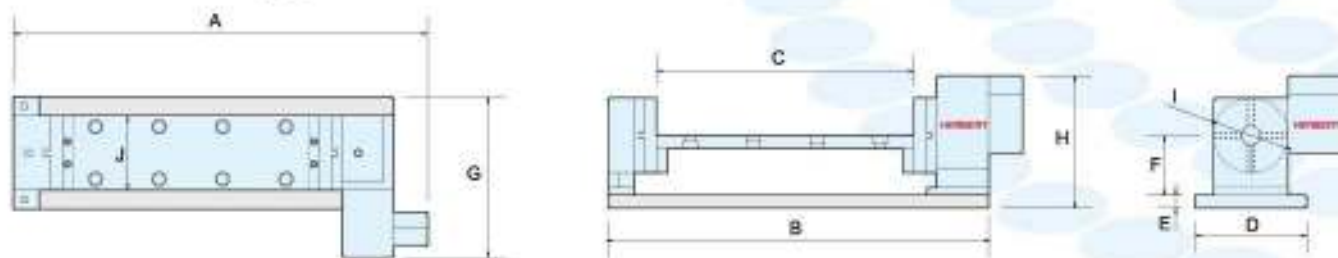
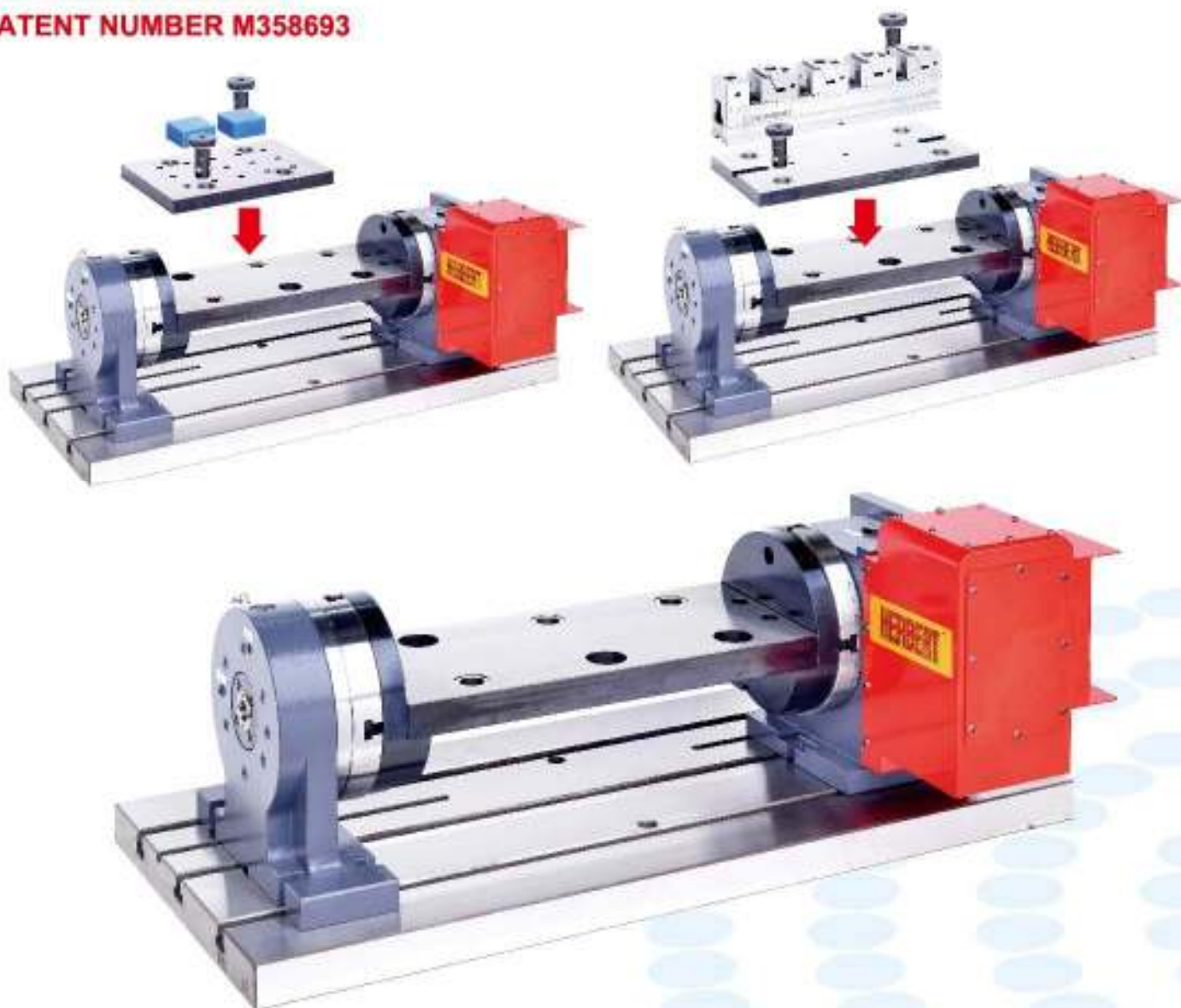

MODEL	A	B	C	D	E	F	G	H	I	J
BLS-2520	650	570	310	300	40	160	430	355	160	200
BLS-4020	840	720	460	300	40	160	430	355	160	200
BLS-5020	900	820	560	300	45	160	430	355	160	200
BLS-6320	1030	950	690	300	50	160	430	355	160	200
BLS-2530	650	570	310	400	40	210	480	405	160	300
BLS-4030	840	720	460	400	40	210	480	405	160	300
BLS-5030	900	820	560	400	45	210	480	405	160	300
BLS-6330	1030	950	690	400	50	210	480	405	160	300



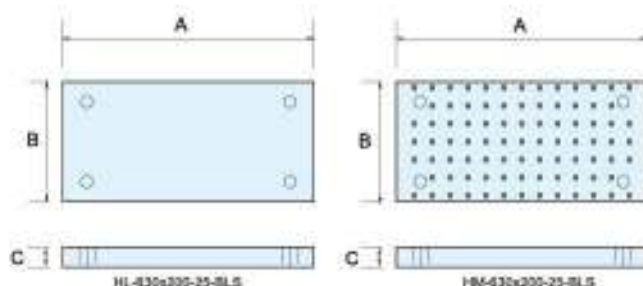

MODEL	A	B	C
HL-250x200-25-BLS	250	200	25
HL-400x200-25-BLS	400	200	25
HL-500x200-25-BLS	500	200	25
HL-630x200-25-BLS	630	200	25
HM-250x200-25-BLS	250	200	25
HM-400x200-25-BLS	400	200	25
HM-500x200-25-BLS	500	200	25
HM-630x200-25-BLS	630	200	25

MODEL	A	B	C
HL-250x300-25-BLS	250	300	25
HL-400x300-25-BLS	400	300	25
HL-500x300-25-BLS	500	300	25
HL-630x300-25-BLS	630	300	25
HM-250x300-25-BLS	250	300	25
HM-400x300-25-BLS	400	300	25
HM-500x300-25-BLS	500	300	25
HM-630x300-25-BLS	630	300	25



### Features:

This positioning unit is suitable for quick mold or fixture exchange on CNC horizontal or vertical machines. (Shortening loading time)  
 Repeatability can be retained within  $\pm 0.01\text{mm}$ .  
 Positioning and locking in an action.

# HERBERT

# MULTIGRIP VISE

# 'LOCK-TIGHT' MACHINE VISES

PATENT NUMBER 311528

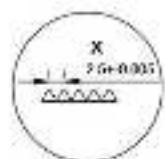
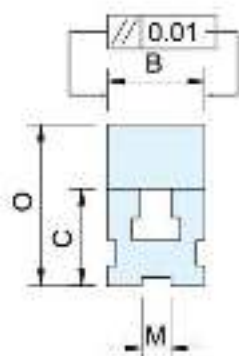

Material 100% tool steel  
Heat treated HER 55 & ground

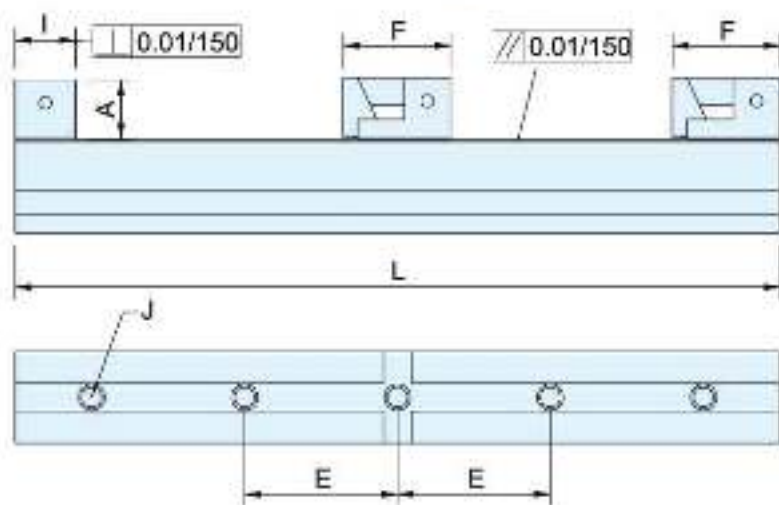

MODEL	A	B	C	E	F	I	J	L	M	O	G.W.
HMG-6025	40	60	60	100	70	60	M12	250	18	100	9kg
HMG-6040	40	60	60	100	70	60	M12	400	18	100	14kg
HMG-6050	40	60	60	100	70	60	M12	500	18	100	16kg
HMG-6063	40	60	60	100	70	60	M12	630	18	100	20kg

MODEL	A	B	C	E	F	I	J	L	M	O	G.W.
HMG-9025	45	90	70	100	80	70	M16	250	18	115	18kg
HMG-9040	45	90	70	100	80	70	M16	400	18	115	25kg
HMG-9050	45	90	70	100	80	70	M16	500	18	115	29kg
HMG-9063	45	90	70	100	80	70	M16	630	18	115	38kg



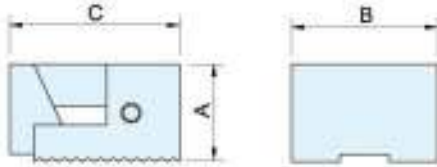

MODEL	A	B	C	G.W.
HMG-60A	40	60	70	1.4kg
HMG-90A	45	90	80	2.9kg

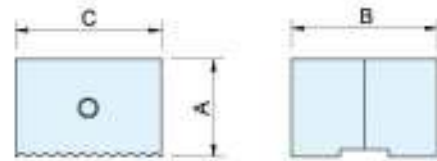

MODEL	A	B	C	G.W.
HMG-60B	40	60	60	1.4kg
HMG-90B	45	90	70	2.9kg

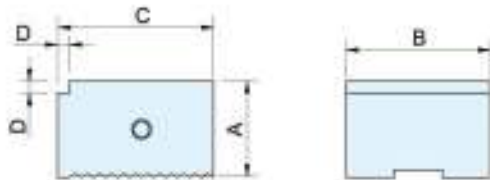

MODEL	A	B	C	D	G.W.
HMG-60C	40	60	42	5	1.5kg
HMG-90C	45	90	60	5	3.1kg

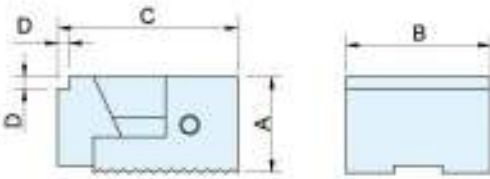

MODEL	A	B	C	D	G.W.
HMG-60D	40	60	70	5	1.5kg
HMG-90D	45	90	80	5	3.1kg

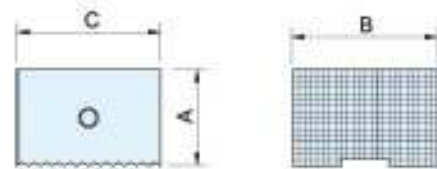

MODEL	A	B	C	G.W.
HMG-60E	40	60	50	1.4kg
HMG-90E	45	90	60	2.9kg



MODEL	A	B	C	G.W.
HMG-60F	40	60	70	1.4kg
HMG-90F	45	90	80	2.9kg

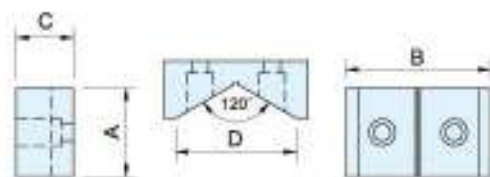

MODEL	A	B	C	D	G.W.
HMG-60J3	40	60	24	50	0.3kg
HMG-90J3	45	90	33	80	0.8kg

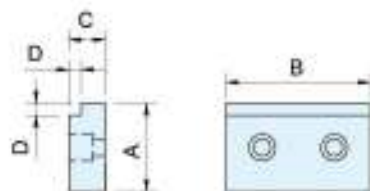

MODEL	A	B	C	D	G.W.
HMG-60J6	40	60	15	5	0.5kg
HMG-90J6	45	90	15	5	0.9kg

## Opening Capacity

	1	1 2	1 2 3	1 2 3 4
HMG-6025	120	25		
HMG-6040	270	100	43	15
HMG-6050	370	150	76	40
HMG-6063	500	215	120	73
HMG-9025	99			
HMG-9040	249	84	29	
HMG-9050	349	134	62	26
HMG-9063	479	199	106	59

## Example (For Horizontal Machine)

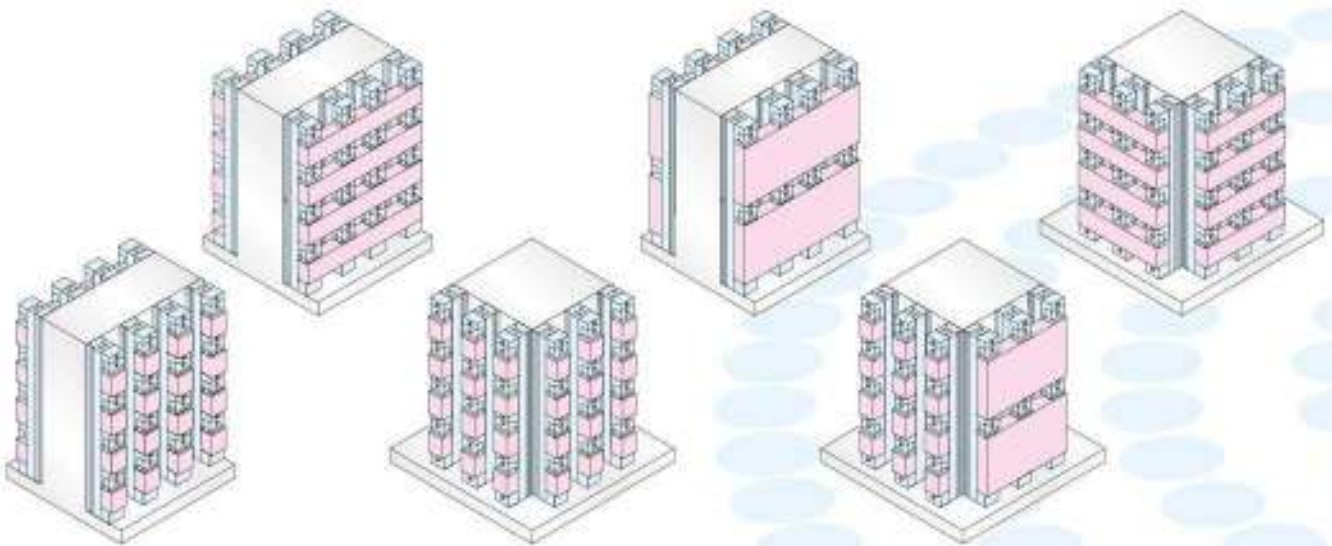

## Example (For Vertical Machine)

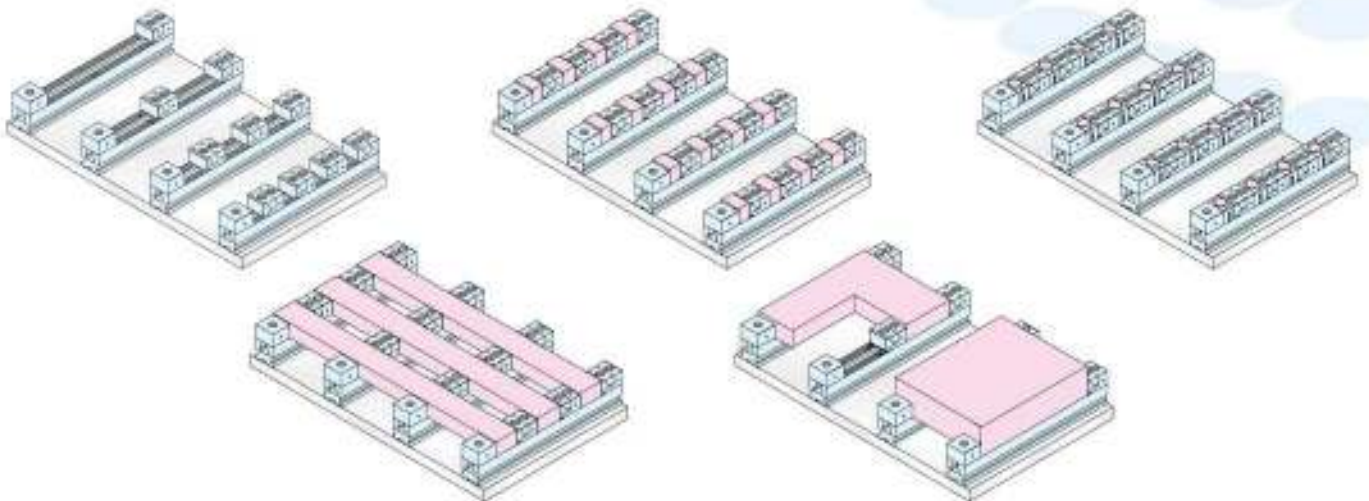



PATENT NUMBER 311528

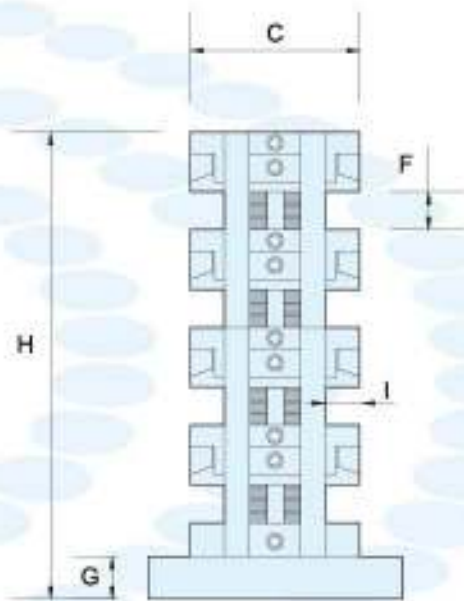
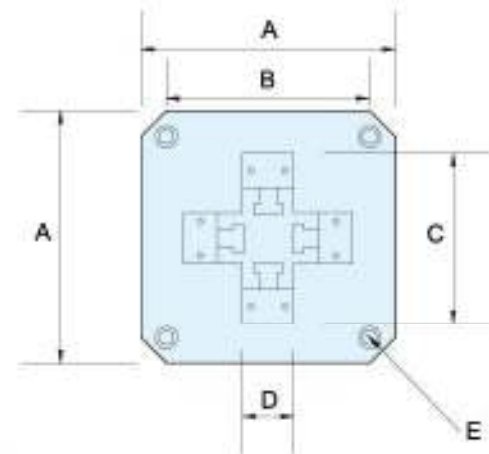

MODEL	A	B	C	D	E	F	G	H	I
HMG-6025-4V	300	240	200	60	M16	25	30	280	40
HMG-6040-4V	300	240	200	60	M16	43	30	430	40
HMG-6050-4V	300	240	200	60	M16	40	30	530	40
HMG-6063-4V	300	240	200	60	M16	73	30	660	40
HMG-9025-4V	300	240	320	90	M16	99	35	285	45
HMG-9040-4V	300	240	320	90	M16	29	35	435	45
HMG-9050-4V	300	240	320	90	M16	26	35	535	45
HMG-9063-4V	300	240	320	90	M16	59	35	665	45

# HERBERT

# MULTIGRIP VISE

PATENT NUMBER 311528

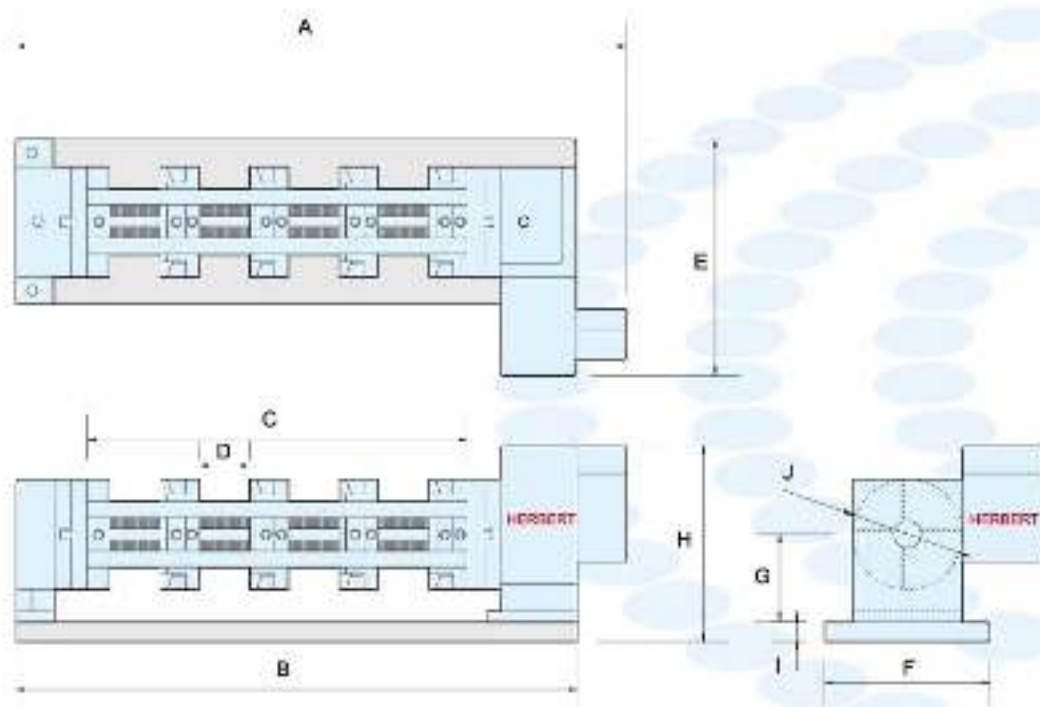
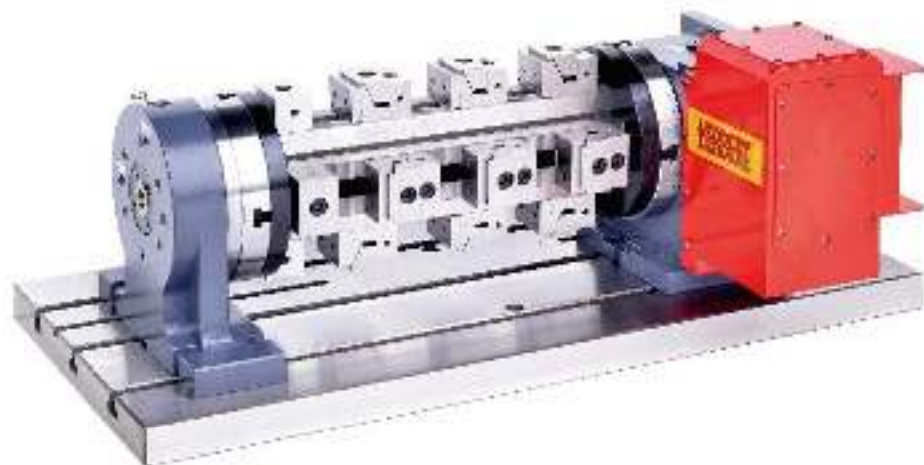

MODEL	A	B	C	D	E	F	G	H	I	J
HMG-6025-FV	650	570	250	25	430	200	160	355	25	200
HMG-6040-FV	840	720	400	43	430	200	160	355	25	200
HMG-6050-FV	900	820	500	40	430	200	160	355	25	200
HMG-6063-FV	1030	950	630	73	430	200	160	355	25	200
HMG-9025-FV	650	570	250	99	430	200	160	355	25	200
HMG-9040-FV	840	720	400	29	430	200	160	355	25	200
HMG-9050-FV	900	820	500	26	430	200	160	355	25	200
HMG-9063-FV	1030	950	630	59	430	200	160	355	25	200

# 'LOCK-TIGHT' MACHINE VISES



## MC PNEUMATIC QUICK VISE

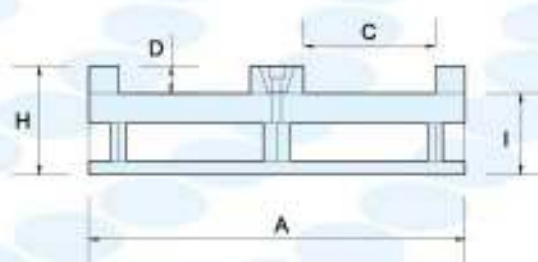
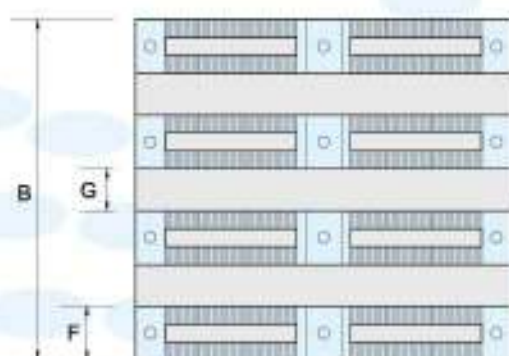

MODEL	A	B	C	D	E	F	G	H	I
HMG-9040-2S	400	250	100	50	160	90	70	181	136
HMG-9040-3S	400	410	150	50	160	90	70	181	136
HMG-9040-4S	400	570	215	50	160	90	70	181	136
HMG-9050-2S	500	250	100	50	160	90	70	181	136
HMG-9050-3S	500	410	150	50	160	90	70	181	136
HMG-9050-4S	500	570	215	50	160	90	70	181	136
HMG-9063-2S	630	250	100	50	160	90	70	181	136
HMG-9063-3S	630	410	150	50	160	90	70	181	136
HMG-9063-4S	630	570	215	50	160	90	70	181	136



# HERBERT



Big opening



Paralleling



Prevent lifting

## MC MECHANICAL-TYPE PRECISION VICE

**CORNER** Most kindly design to considered every tiny point.



Chip cover adopted, preventing chips falling into causing bad motion.

Double opening than those of same grade vice. Can easy clamp longer work piece.

Max. opening capacity 300 mm.



The jaw more deeper than those of same grade vice. Can clamping higher workpiece correctly.



Bend force,

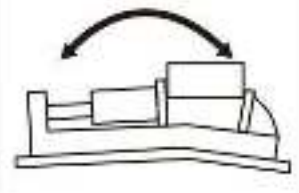

**High** strength. **High** accuracy.

Perpendicular rib structure with strain of vice. It could hardly

'LOCK-TIGHT' MACHINE VISES



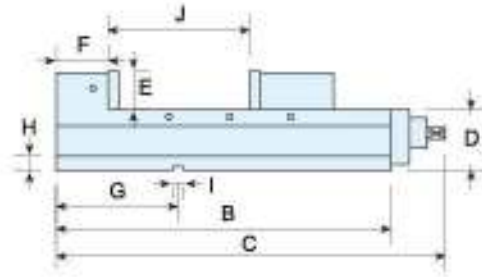
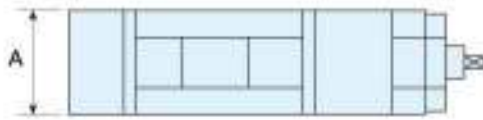

## Four clamping way for choice

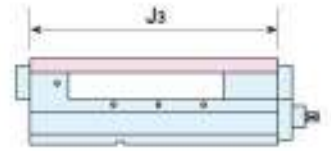
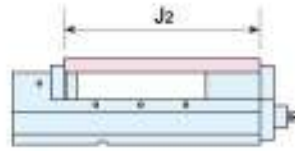
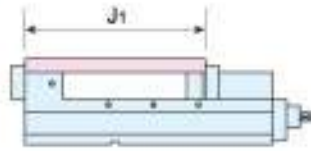
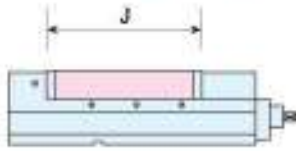

MODEL	A	B	C	D	E	F	G	H	I	J	J <sub>1</sub>	J <sub>2</sub>	J <sub>3</sub>	N.W.	G.W.	POWER
MB-100AB	100	400	445	85	45	80	110	23	18	200	230	260	340	27kg	30kg	-
MB-130AB	130	450	495	95	50	85	135	23	18	240	285	320	405	40kg	43kg	-
MB-160AB	160	550	595	100	60	103	200	23	18	300	380	400	500	58kg	61kg	-
MB-200AB	200	600	645	110	65	108	220	23	18	340	438	470	578	87kg	99kg	-

## PATENT NUMBER 256258



This unit had prevent lifting structure, when clamping in down direction power also acting, so the workpiece and movable parts lift very small, furthermore, the body and solid jaw is a combination structure, it does not tilt.



The whole Swivel Base are made by Stainless Steel, with harden treatment, durable and high accurate.

### Standard Accessories

1. Handle-1 set
2. Guide key-2pcs
3. Screw-M6x10Lx2pcs
4. Chip cover
5. Vise locked block-4pcs

### Optional Accessories

1. Special application jaw plates
2. Vise positioner
3. Swivel Base
4. Opening jaw plates
5. Sleeve spanner

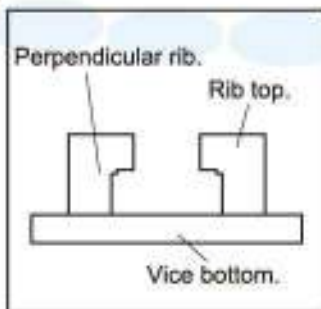

Ductile cast iron spring.



Microphotograph for ductile cast iron



The common contact face and slide face of movable parts both with good wear resistance of treat treatment (over HRC45°)

which has great resistance to bending due to clamping to bring bend.

Ductile cast iron is fit to produce rigid precision items, which have three times strength than same grade vise due to used ductile cast iron.



# HERBERT

**NEW**

**SPECIAL PURPOSE VISES:  
VISES FOR 5-SIDE MACHINING & TURNING CENTERS**

**CORNER** Most kindly design to considered every tiny point.



**High** strength. **High** accuracy.

'LOCK-TIGHT' MACHINE VISES



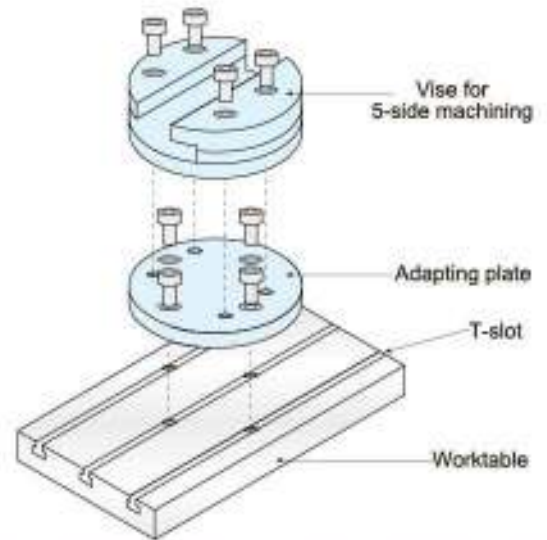
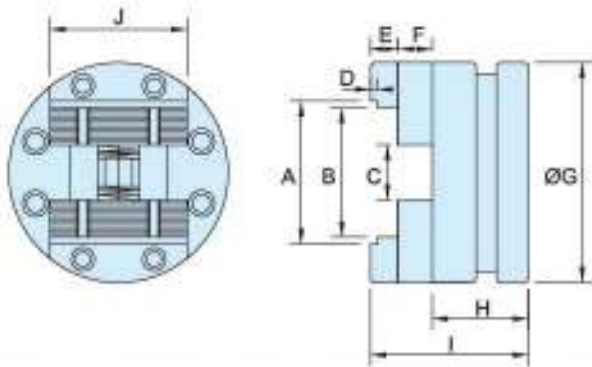

MODEL	A	B	C	D	E	F	G	H	I	J
TMV-100	105	95	40	5	20	25	160	70	115	100
TMV-130	135	125	50	5	20	25	210	80	125	130
TMV-160	165	155	60	5	25	25	250	90	140	160

**PATENT NUMBER 372760**

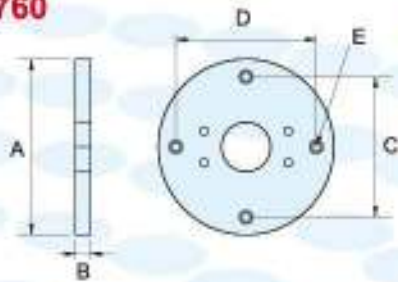

MODEL	A	B	C	D	E
TMV-102	240	22	100	100	M12
TMV-132	250	22	100	100	M12
TMV-162	250	22	100	100	M12



**A good solution for clamping on both turning centres and 5-axis milling machines.**

- For quick & easy work piece clamping on turning centres or for 5-axis machining on machine centres. Round-shaped style occupies less space and reduces interference.
- Available are different styles of vise jaws for different machining needs. The TMV vises come with different jaw width of 100mm, 130mm, 160mm and 200mm.



# HERBERT



Powerful



Prevent lifting

## MC UNIVERSAL POWER TILTING VICE

**CORNER** Most kindly design to considered every tiny point.

The jaw more deeper than those of same grade vice.. Can clamping higher work piece correctly.

New development patented, oil-free powerful mechanical boost system, which gives greater clamping and never collapsing pressure.

Double opening than those of same grade vice. Can easy clamp longer work piece.

Chip cover adopted, preventing chips falling into causing bad motion.



### FEATURES:

- The vice different form conventional vice, than can be adjusted angle of workpiece directly, perpendicular direction adjustable angle from 0X to 50X, which can read process angles accurately.

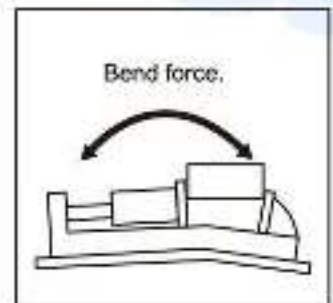

**High strength. High accuracy.**

- Perpendicular rib structure with strain of vise. It could hardly

'LOCK-TIGHT' MACHINE VISES



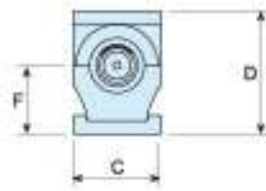
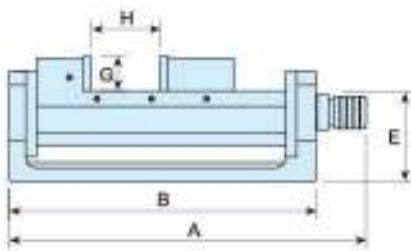

## Tow clamping way for choice

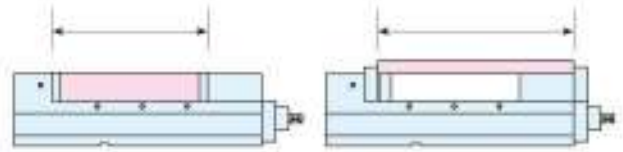

MODEL	A	B	C	D	E	F	G	H	adjustable angle	N.W.	G.W.	POWER
MBT-160	645	550	160	225	165	126	63	200	0°-50°	75kg	80kg	5500kgf

**PATENT NUMBER**  
 184869 201150 249761  
 256258  
**GERMANY** 201125447  
**CHINA** ZL01231630X



This unit had prevent lifting structure, when clamping in down direction power also acting, so the workpiece and movable parts lift very small, furthermore, the body and solid jaw is a combination structure, it does not tilt.

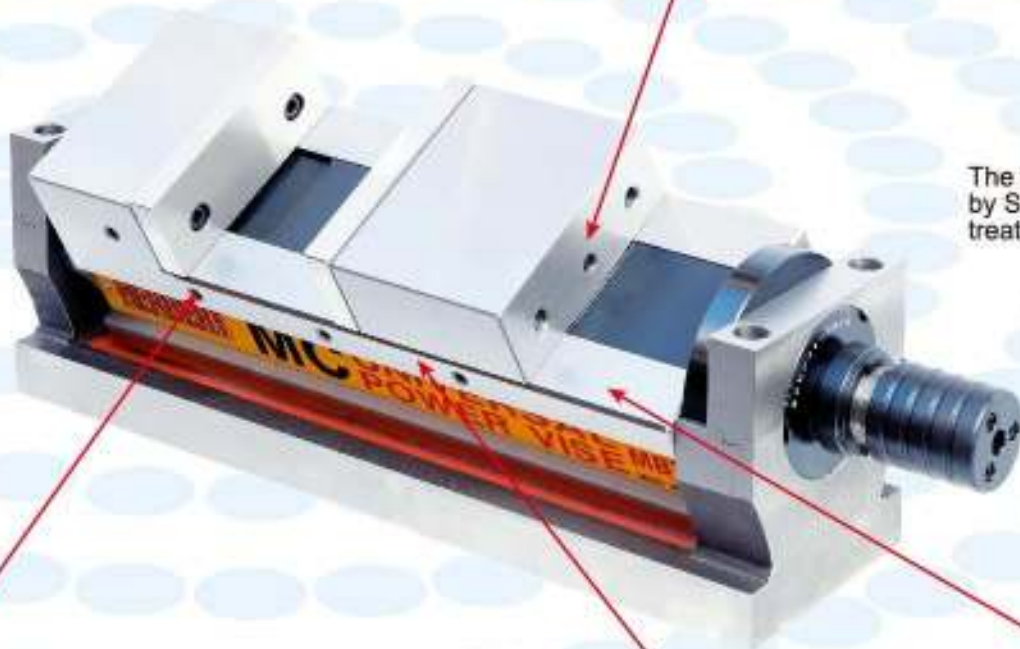

The whole Swivel Base are made by Stainless Steel, with harden treatment, durable and high accurate.

### Standard Accessories

- 1.Handle-1 set
- 2.Guide key-2pcs
- 3.Screw-M6x10Lx2pcs
- 4.Chip cover
- 5.Vise locked block-4pcs

### Optional Accessories

- 1.Special application jaw plates
- 2.Vise positioner
- 3.Swivel Base
- 4.Opening jaw plates
- 5.Sleeve spanner

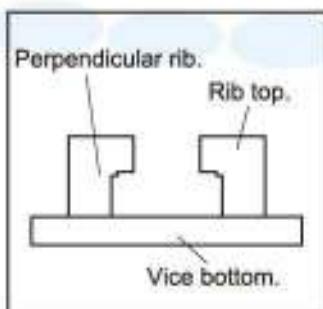

Ductile cast iron spring.



Microphotograph for ductile cast iron



which has great resistance to bending due to clamping to bring bend.

Ductile cast iron is fit to produce rigid precision items, which have three times strength than same grade vise due to used ductile cast iron.

The common contact face and slide face of movable parts both with good wear resistance of treat treatment (over HRC45°)



# HERBERT



Powerful

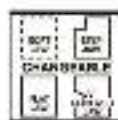

Change



Paralleling



Prevent lifting

## SUPER LONG OPEN TYPE VISE

**CORNER** Most kindly design to considered every tiny point.



Chip cover adopted, preventing chips falling into causing bed motion.

Double opening than those of same grade vise. Can easy clamp longer work piece.

Max. opening capacity 450 mm.



New development patented, oil-free powerful mechanical boost system, which gives greater clamping and never collapsing pressure.

### PRESSURE POSITION SYSTEM



0	DIRECT
1	1000kgf
2	2000kgf
3	3000kgf
4	4000kgf
5	5000kgf

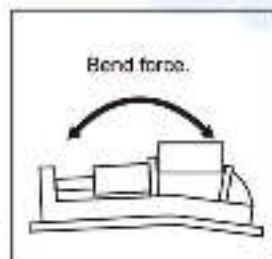

**High strength. High accuracy.**

Perpendicular rib structure of strain of vise. It could hardly

'LOCK-TIGHT' MACHINE VISES



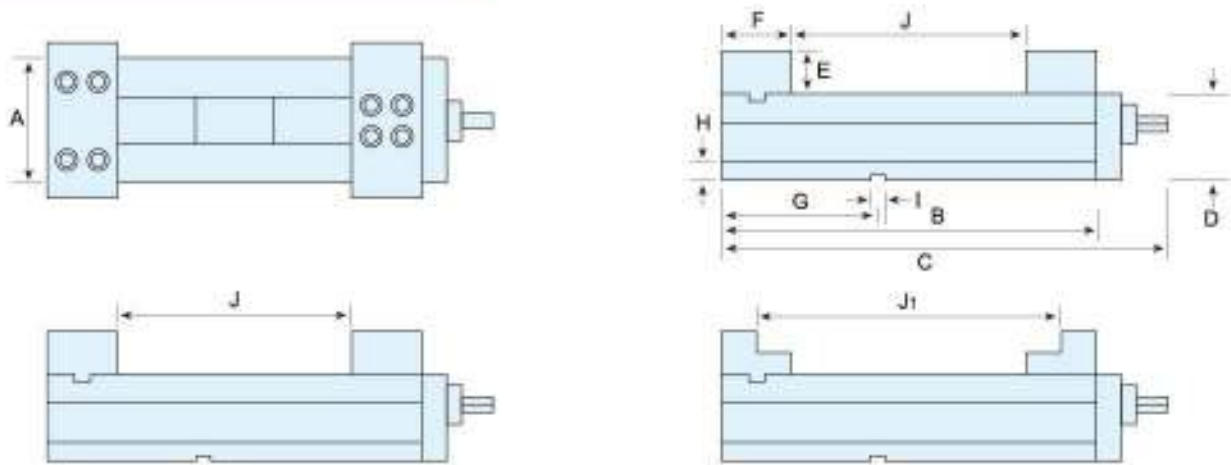

MODEL	A	B	C	D	E	F	G	H	I	J	J <sub>1</sub>	N.W.	G.W.	POWER
VSP-200G	200	590	715	110	55	85	150	23	18	400	480	70kg	75kg	5000kgf
VSP-250G	250	665	790	120	60	100	220	23	18	450	550	120kg	128kg	5000kgf

**PATENT NUMBER**  
 184869 201150 249761  
 256286 249762 300156  
 GERMANY 201125447  
 CHINA ZL01231630X

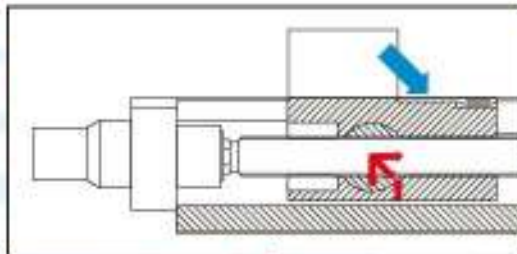

This unit had prevent lifting structure, when clamping in down direction power also acting, so the workpiece and movable parts lift very small, furthermore, the body and solid jaw is a combination structure, it does not tilt.

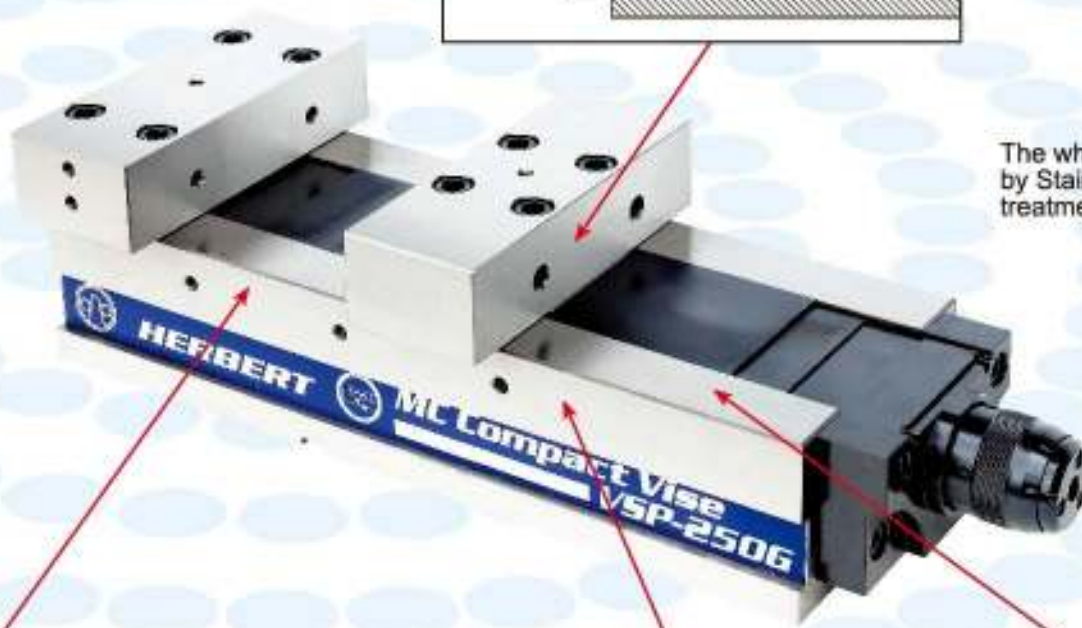

The whole Swivel Base are made by Stainless Steel, with harden treatment, durable and high accurate.

### Standard Accessories

- 1.Handle-1 set
- 2.Guide key-2pcs
- 3.Screw-M6x10Lx2pcs
- 4.Chip cover
- 5.Vise locked block-4pcs

### Optional Accessories

- 1.Special application jaw plates
- 2.Vise positioner
- 3.Swivel Base
- 4.Opening jaw plates
- 5.Sleeve spanner

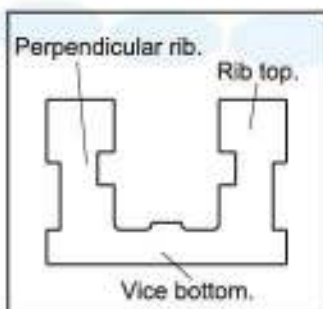

which has great resistance to bending due to clamping to bring bend.



Ductile cast iron spring.



Microphotograph for ductile cast iron

Ductile cast iron is fit to produce rigid precision items, which have three times strengthen than same grade vise due to used ductile cast iron.

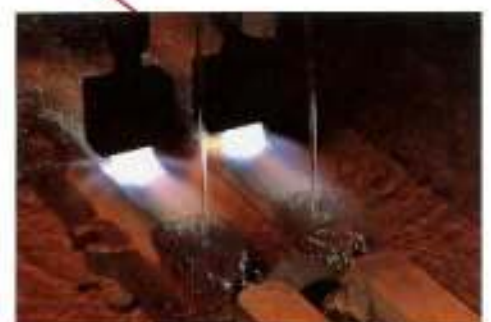

The common contact face and slide face of movable parts both with good wear resistance of treat treatment (over HRC45°)



# HERBERT



Powerful



Change



Paralleling



Prevent lifting

## SUPER LONG OPEN TYPE VISE

**CORNER** Most kindly design to considered every tiny point.



Chip cover adopted, preventing chips falling into causing bed motion.

Double opening than those of same grade vise. Can easy clamp longer work piece.

Max. opening capacity 450 mm.

New development patented, oil-free powerful mechanical boost system, which gives greater clamping and never collapsing pressure.



### PRESSURE POSITION SYSTEM



0	DIRECT
1	1000kgf
2	2000kgf
3	3000kgf
4	4000kgf
5	5000kgf

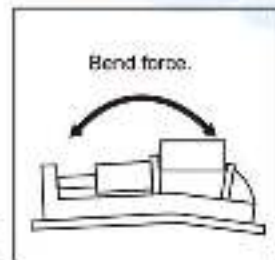

**High strength. High accuracy.**

Perpendicular rib structure of strain of vise. It could hardly

'LOCK-TIGHT' MACHINE VISES



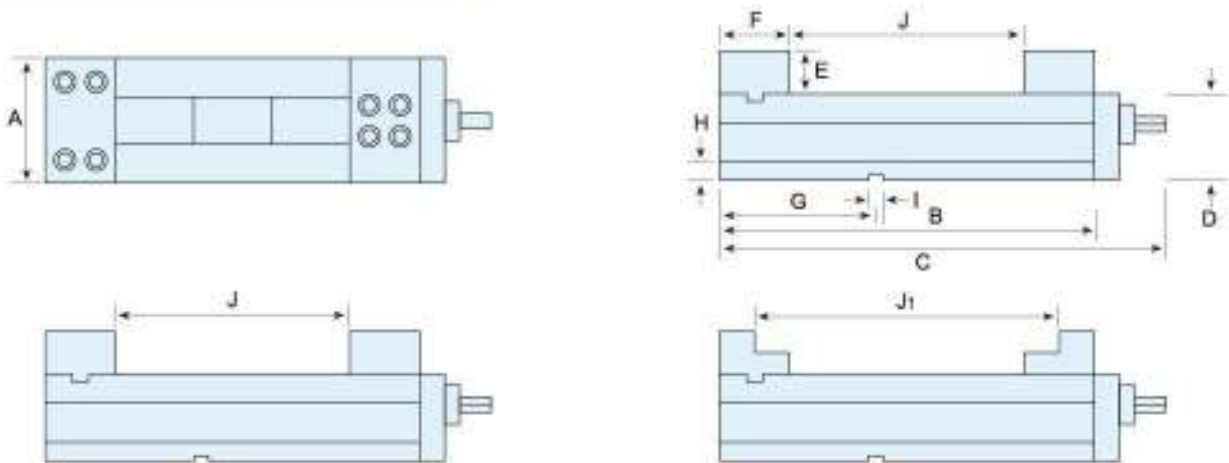

MODEL	A	B	C	D	E	F	G	H	I	J	J <sub>1</sub>	N.W.	G.W.	POWER
VSP-160L	160	590	715	110	55	85	150	23	18	400	480	69kg	72kg	5000kgf
VSP-200L	200	665	790	120	60	100	220	23	18	450	550	115kg	120kg	5000kgf

**PATENT NUMBER**  
 184869 201150 249761  
 256286 249762 300156  
 GERMANY 201125447  
 CHINA ZL01231630X

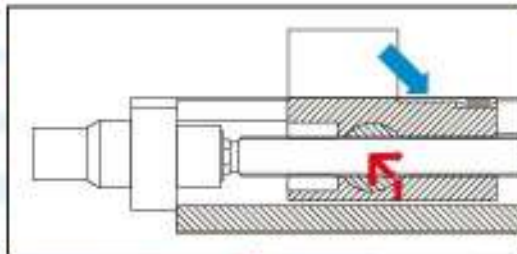

This unit had prevent lifting structure, when clamping in down direction power also acting, so the workpiece and movable parts lift very small, furthermore, the body and solid jaw is a combination structure, it does not tilt.



The whole Swivel Base are made by Stainless Steel, with harden treatment, durable and high accurate.

### Standard Accessories

- 1.Handle-1 set
- 2.Guide key-2pcs
- 3.Screw-M6x10Lx2pcs
- 4.Chip cover
- 5.Vise locked block-4pcs

### Optional Accessories

- 1.Special application jaw plates
- 2.Vise positioner
- 3.Swivel Base
- 4.Opening jaw plates
- 5.Sleeve spanner

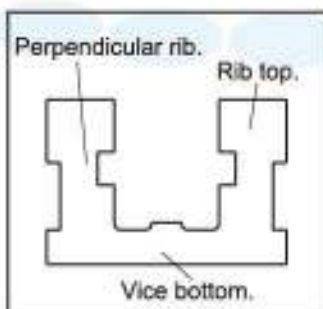

which has great resistance to bending due to clamping to bring bend.



Ductile cast iron spring.



Microphotograph for ductile cast iron

Ductile cast iron is fit to produce rigid precision items, which have three times strengthen than same grade vise due to used ductile cast iron.



The common contact face and slide face of movable parts both with good wear resistance of treat treatment (over HRC45°)



# HERBERT



Powerful

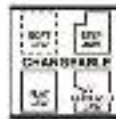

Change



Paralleling



Prevent lifting

## SUPER OPEN TYPE VISE

**CORNER** Most kindly design to considered every tiny point.

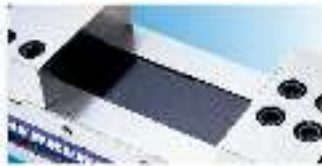

Chip cover adopted, preventing chips falling into causing bad motion.



Double opening than those of same grade vise. Can easy clamp longer work piece.



Max. opening capacity 300 mm.



New development patented, oil-free powerful mechanical boost system, which gives greater clamping and never collapsing pressure.

### PRESSURE POSITION SYSTEM



0	DIRECT
1	1000kgf
2	2000kgf
3	3000kgf
4	4000kgf
5	5000kgf

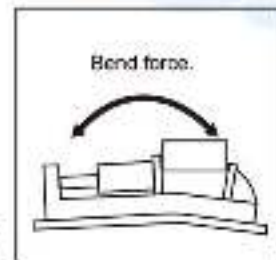

**High strength. High accuracy.**

Perpendicular rib structure of strain of vise. It could hardly

'LOCK-TIGHT' MACHINE VISES



# ISO-9001:2008

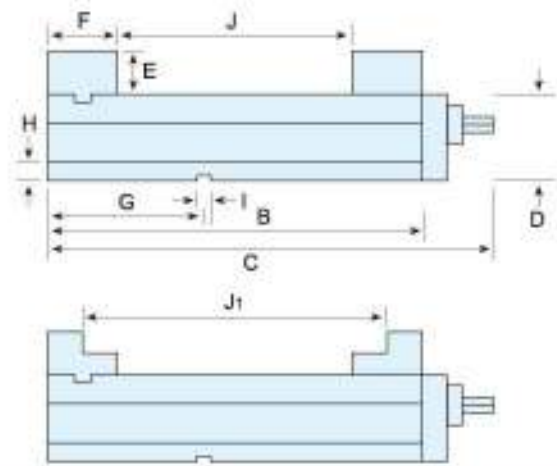
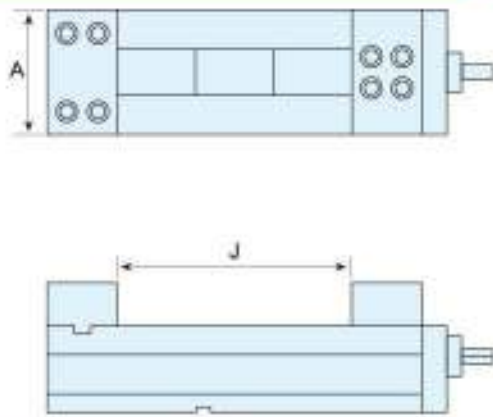

MODEL	A	B	C	D	E	F	G	H	I	J	J <sub>1</sub>	N.W.	G.W.	POWER
VSP-100	100	310	435	95	45	70	110	23	18	140	200	27kg	30kg	4000kgf
VSP-130	130	410	535	100	50	80	135	23	18	230	315	45kg	48kg	4000kgf
VSP-160	160	490	615	110	55	85	150	23	18	300	385	60kg	62kg	5000kgf
VSP-200	200	565	690	120	60	100	220	23	18	350	450	100kg	105kg	5000kgf

**PATENT NUMBER**  
**184869 201150 249761**  
**256286 249762 300156**  
**GERMANY 201125447**  
**CHINA ZL01231630X**

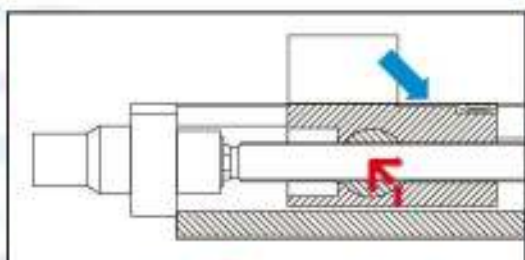

This unit had prevent lifting structure, when clamping in down direction power also acting, so the workpiece and movable parts lift very small, furthermore, the body and solid jaw is a combination structure, it does not tilt.



The whole Swivel Base are made by Stainless Steel, with harden treatment, durable and high accurate.

### Standard Accessories

- 1.Handle-1 set
- 2.Guide key-2pcs
- 3.Screw-M6x10Lx2pcs
- 4.Chip cover
- 5.Vise locked block-4pcs

### Optional Accessories

- 1.Special application jaw plates
- 2.Vise positioner
- 3.Swivel Base
- 4.Opening jaw plates
- 5.Sleeve spanner

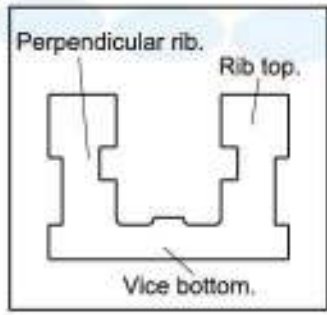

which has great resistance to bending due to clamping to bring bend.



Ductile cast iron spring.



Microphotograph for ductile cast iron

Ductile cast iron is fit to produce rigid precision items, which have three times strength than same grade vise due to used ductile cast iron.



The common contact face and slide face of movable parts both with good wear resistance of treat treatment (over HRC45°)

# HERBERT



Change



Paralleling



Prevent lifting

## MC MECHANICAL-TYPE PRECISION VICE

**CORNER** Most kindly design to considered every tiny point.



Chip cover adopted, preventing chips falling into causing bed motion.

Double opening than those of same grade vice. Can easy clamp longer work pieces.

Max. opening capacity 450 mm.

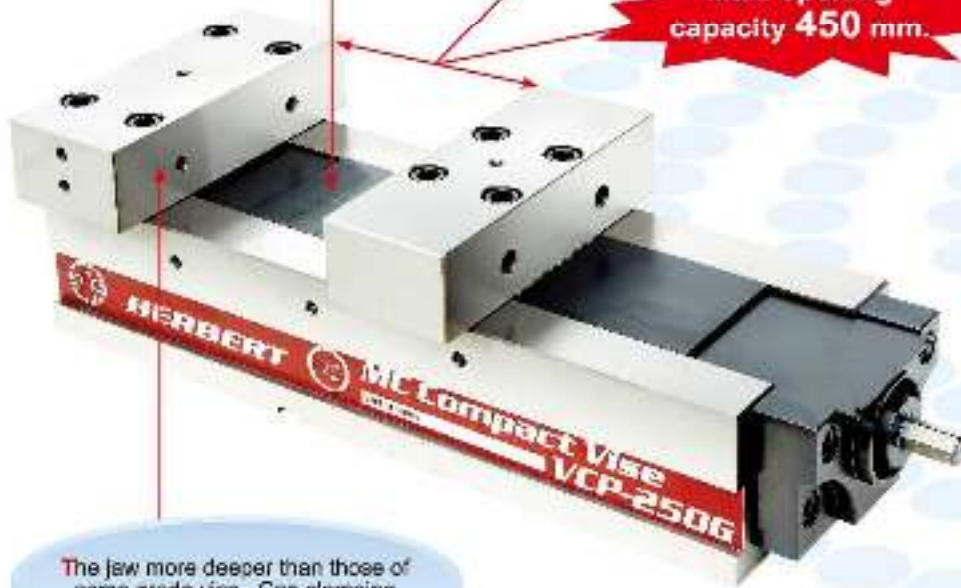

The jaw more deeper than those of same grade vice. Can clamping higher work pieces correctly.

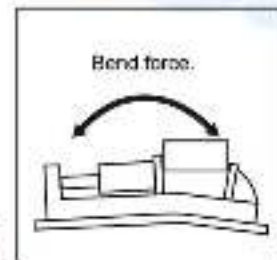

**High** strength. **High** accuracy.

Perpendicular rib structure of strain of vice. It could hardly

'LOCK-TIGHT' MACHINE VISES



# ISO-9001:2008

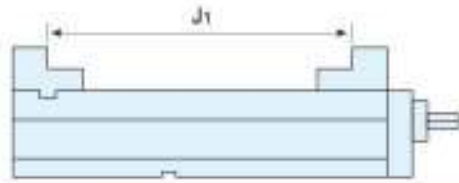
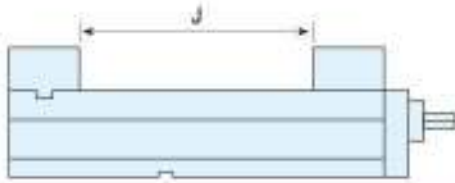
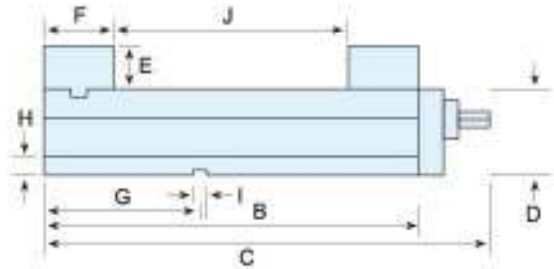
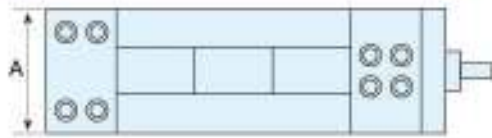

MODEL	A	B	C	D	E	F	G	H	I	J	J <sub>1</sub>	N.W.	G.W.	POWER
VCP-200G	200	590	680	110	55	85	150	23	18	400	485	68kg	73kg	-
VCP-250G	250	665	755	120	60	100	220	23	18	450	550	110kg	126kg	-
VCP-160L	160	590	680	110	55	85	150	23	18	400	485	66kg	71kg	-
VCP-200L	200	665	755	120	60	100	220	23	18	450	550	110kg	117kg	-

**PATENT NUMBER**  
249762  
256286

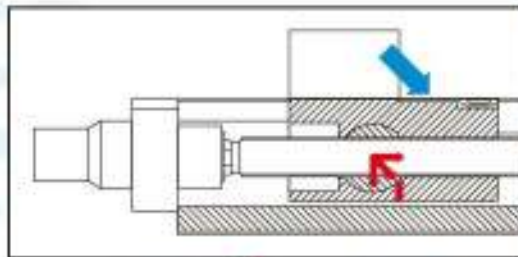

This unit had prevent lifting structure, when clamping in down direction power also acting, so the workpiece and movable parts lift very small, furthermore, the body and solid jaw is a combination structure, it does not tilt.



The whole Swivel Base are made by Stainless Steel, with harden treatment, durable and high accurate.

### Standard Accessories

1. Handle-1 set
  2. Guide key-2pcs
  3. Screw-M6x10Lx2pcs
  4. Chip cover
  5. Vise locked block-4pcs
1. Special application jaw plates
  2. Vise positioner
  3. Swivel Base
  4. Opening jaw plates
  5. Sleeve spanner

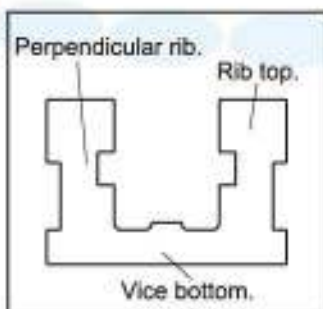

Ductile cast iron spring.



Microphotograph for ductile cast iron



which has great resistance to bending due to clamping to bring bend.

Ductile cast iron is fit to produce rigid precision items, which have three times strength than same grade vise due to used ductile cast iron.

The common contact face and slide face of movable parts both with good wear resistance of treat treatment (over HRC45°)



# ISO-9001:2008

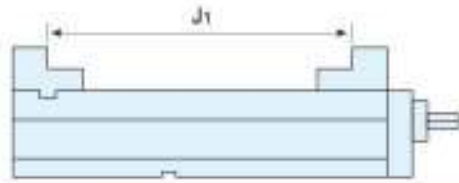
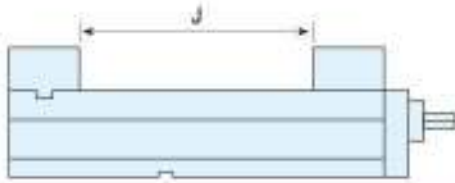
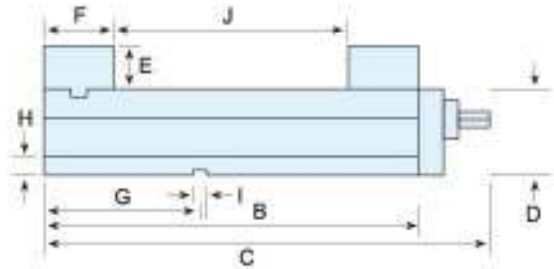
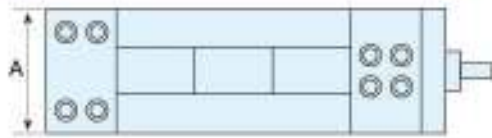

MODEL	A	B	C	D	E	F	G	H	I	J	J <sub>1</sub>	N.W.	G.W.	POWER
VCP-200G	200	590	680	110	55	85	150	23	18	400	485	68kg	73kg	-
VCP-250G	250	665	755	120	60	100	220	23	18	450	550	110kg	126kg	-
VCP-160L	160	590	680	110	55	85	150	23	18	400	485	66kg	71kg	-
VCP-200L	200	665	755	120	60	100	220	23	18	450	550	110kg	117kg	-

**PATENT NUMBER**  
249762  
256286

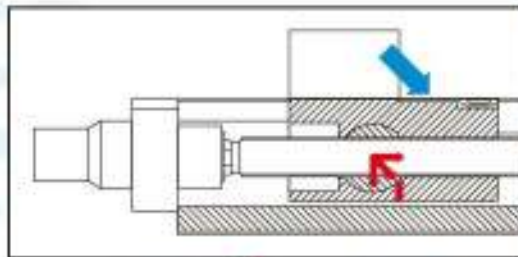

This unit had prevent lifting structure, when clamping in down direction power also acting, so the workpiece and movable parts lift very small, furthermore, the body and solid jaw is a combination structure, it does not tilt.



The whole Swivel Base are made by Stainless Steel, with harden treatment, durable and high accurate.

### Standard Accessories

1. Handle-1 set
  2. Guide key-2pcs
  3. Screw-M6x10Lx2pcs
  4. Chip cover
  5. Vise locked block-4pcs
- 
1. Special application jaw plates
  2. Vise positioner
  3. Swivel Base
  4. Opening jaw plates
  5. Sleeve spanner

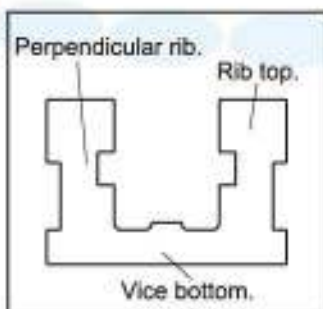

Ductile cast iron spring.



Microphotograph for ductile cast iron



which has great resistance to bending due to clamping to bring bend.

Ductile cast iron is fit to produce rigid precision items, which have three times strength than same grade vise due to used ductile cast iron.

The common contact face and slide face of movable parts both with good wear resistance of treat treatment (over HRC45°)



# ISO-9001:2008

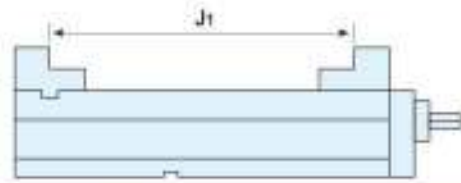
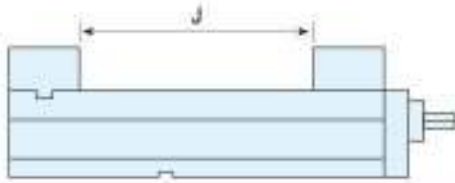
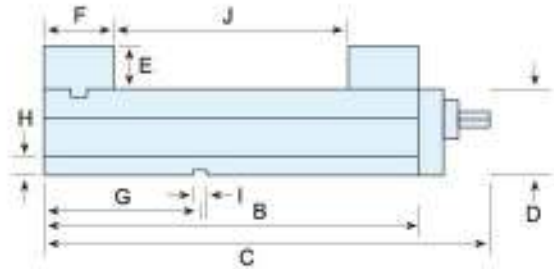

MODEL	A	B	C	D	E	F	G	H	I	J	J <sub>1</sub>	N.W.	G.W.	POWER
VCP-100	100	310	400	95	45	70	110	23	18	150	225	25kg	28kg	-
VCP-130	130	410	500	100	50	80	135	23	18	250	330	43kg	46kg	-
VCP-160	160	490	580	110	55	85	150	23	18	300	385	57kg	60kg	-
VCP-200	200	565	655	120	60	100	220	23	18	350	450	97kg	100kg	-

**PATENT NUMBER**  
249762  
256286

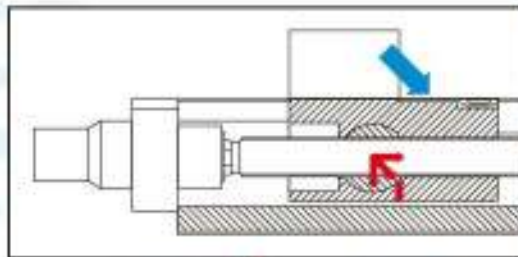

This unit had prevent lifting structure, when clamping in down direction power also acting, so the workpiece and movable parts lift very small, furthermore, the body and solid jaw is a combination structure, it does not tilt.



The whole Swivel Base are made by Stainless Steel, with harden treatment, durable and high accurate.

### Standard Accessories

1. Handle-1 set
  2. Guide key-2pcs
  3. Screw-M6x10Lx2pcs
  4. Chip cover
  5. Vise locked block-4pcs
1. Special application jaw plates
  2. Vise positioner
  3. Swivel Base
  4. Opening jaw plates
  5. Sleeve spanner

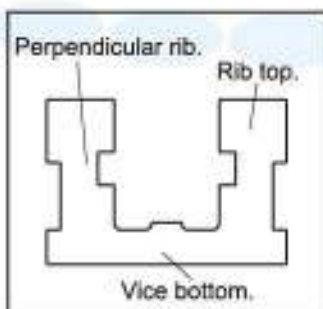

Ductile cast iron spring.



Microphotograph for ductile cast iron



which has great resistance to bending due to clamping to bring bend.

Ductile cast iron is fit to produce rigid precision items, which have three times strength than same grade vise due to used ductile cast iron.

The common contact face and slide face of movable parts both with good wear resistance of treat treatment (over HRC45°)



# HERBERT



Powerful



Big opening



Paralleling



Prevent lifting

## SUPER OPEN TYPE VISE

**CORNER** Most kindly design to considered every tiny point.

### PRESSURE POSITION SYSTEM

New development patented, oil-free powerful mechanical boost system, which gives greater clamping and never collapsing pressure.



0	DIRECT
1	1000kgf
2	2000kgf
3	3000kgf
4	4000kgf
5	5000kgf

Chip cover adopted, preventing chips falling into causing bad motion.

Max. opening capacity 300 mm.

Double opening than those of same grade vice. Can easy clamp longer work piece.

The jaw more deeper than those of same grade vice.. Can clamping higher work piece correctly.

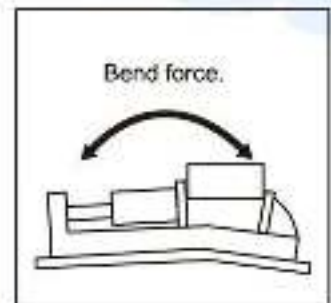

**High strength. High accuracy.**

Perpendicular rib structure with strain of vise. It could hardly

# 'LOCK-TIGHT' MACHINE VISES



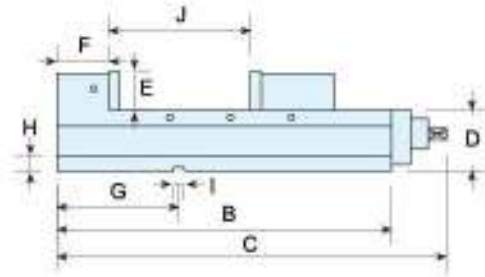

## Four clamping way for choice

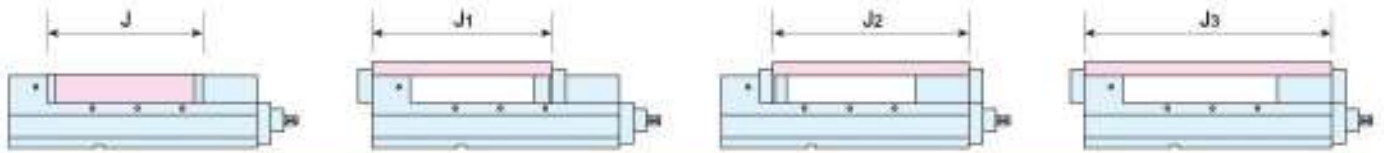

MODEL	A	B	C	D	E	F	G	H	I	J	J <sub>1</sub>	J <sub>2</sub>	J <sub>3</sub>	N.W.	G.W.	POWER
VIP-100	100	400	530	85	45	80	110	23	18	200	230	260	340	32kg	35kg	4000kgf
VIP-130	130	450	580	95	50	85	135	23	18	240	285	320	405	45kg	48kg	4500kgf
VIP-160	160	550	680	100	60	103	200	23	18	300	380	400	500	63kg	66kg	5000kgf
VIP-200	200	600	730	110	60	108	220	23	18	340	438	470	578	92kg	104kg	5500kgf

**PATENT NUMBER**  
**184869 201150**  
**249761 256258 300156**  
**GERMANY 201125447**  
**CHINA ZL01231630X**



This unit had prevent lifting structure, when clamping in down direction power also acting, so the workpiece and movable parts lift very small, furthermore, the body and solid jaw is a combination structure, it does not tilt.



The whole Swivel Base are made by Stainless Steel, with harden treatment, durable and high accurate.

### Standard Accessories

- 1.Handle-1 set
- 2.Guide key-2pcs
- 3.Screw-M6x10Lx2pcs
- 4.Chip cover
- 5.Vise locked block-4pcs

### Optional Accessories

- 1.Special application jaw plates
- 2.Vise positioner
- 3.Swivel Base
- 4.Opening jaw plates
- 5.Sleeve spanner

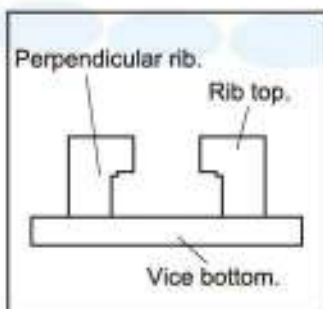

Ductile cast iron spring.



Microphotograph for ductile cast iron



which has great resistance to bending due to clamping to bring bend.

Ductile cast iron is fit to produce rigid precision items, which have three times strength than same grade vise due to used ductile cast iron.

The common contact face and slide face of movable parts both with good wear resistance of treat treatment (over HRC45°)



# HERBERT



Powerful



Big opening



Paralleling



Prevent lifting

## SUPER OPEN TYPE VISE

**CORNER** Most kindly design to considered every tiny point.



Double opening than those of same grade vica. Can easy clamp longer work piece.

### PRESSURE POSITION SYSTEM

New development patented, oil-free powerful mechanical boost system. which gives greater clamping and never collapsing pressrue.

Chip cover adopted, preventing chips falling into causing bad motion.

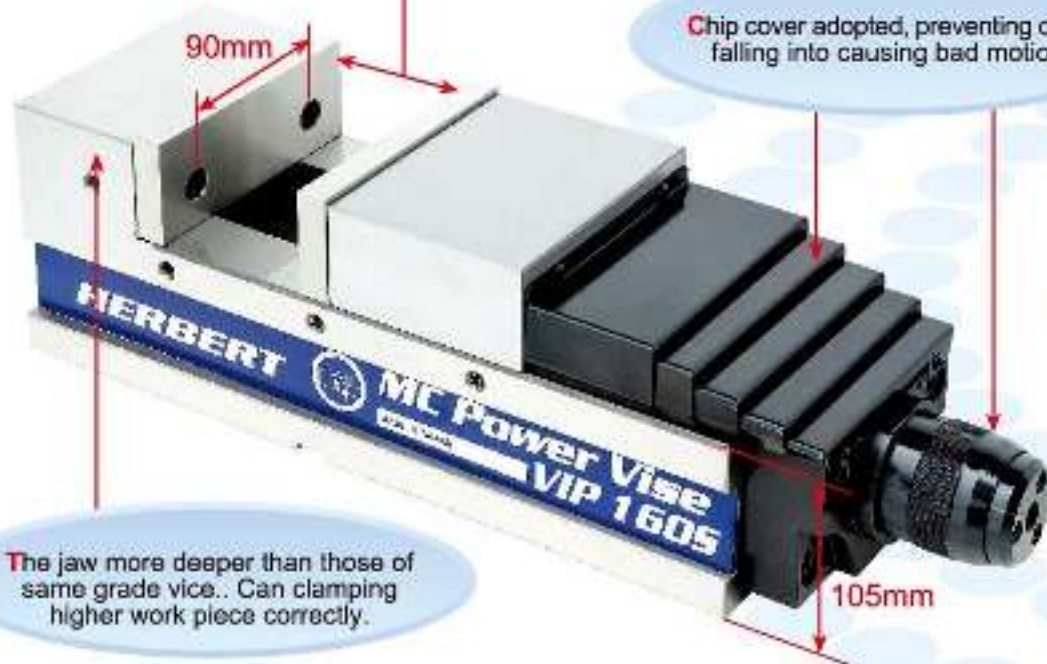

The jaw more deeper than those of same grade vica.. Can clamping higher work piece correctly.



0	DIRECT
1	1000kgf
2	2000kgf
3	3000kgf
4	4000kgf
5	5000kgf

Bend force.

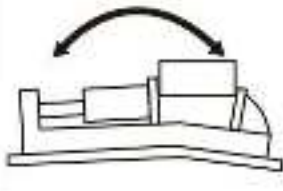

**High** strength. **High** accuracy.

Perpendicular rib structure w strain of vise. It could hardly

# 'LOCK-TIGHT' MACHINE VISES



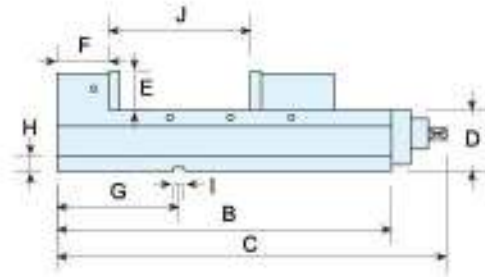

### Four clamping way for choice

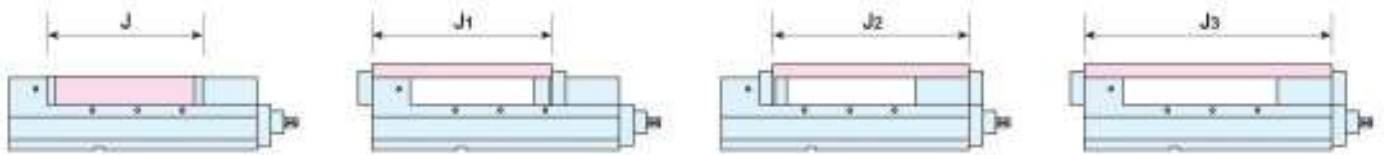

MODEL	A	B	C	D	E	F	G	H	I	J	J <sub>1</sub>	J <sub>2</sub>	J <sub>3</sub>	N.W.	G.W.	POWER
VIP-160S	160	495	620	105	55	85	150	23	18	240	325	395	470	57kg	59kg	5500kgf
MPV-160S	160	495	630	105	55	85	150	23	18	240	325	395	470	57kg	59kg	5000kgf

**PATENT NUMBER**  
 184869 201150  
 249761 256258 300156  
 GERMANY 201125447  
 CHINA ZL01231630X



This unit had prevent lifting structure, when clamping in down direction power also acting, so the workpiece and movable parts lift very small, furthermore, the body and solid jaw is a combination structure, it does not tilt.



The whole Swivel Base are made by Stainless Steel, with harden treatment, durable and high accurate.

### Standard Accessories

1. Handle-1 set
2. Guide key-2pcs
3. Screw-M6x10Lx2pcs
4. Chip cover
5. Vise locked block-4pcs

### Optional Accessories

1. Special application jaw plates
2. Vise positioner
3. Swivel Base
4. Opening jaw plates
5. Sleeve spanner

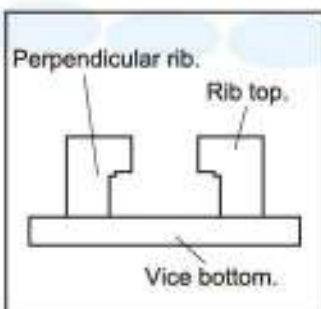

Ductile cast iron spring.



Microphotograph for ductile cast iron



The common contact face and slide face of movable parts both with good wear resistance of treat treatment (over HRC45°)

Ductile cast iron is fit to produce rigid precision items, which have three times strength than same grade vise due to used ductile cast iron.

which has great resistance to bending due to clamping to bring bend.



# HERBERT



Powerful



Big opening



Paralleling



Prevent lifting

## MC UNIVERSAL POWERFUL-TYPE PRECISION VICE

**CORNER** Most kindly design to considered every tiny point.

New development patented, oil-free powerful mechanical boost system, which gives greater clamping and never collapsing pressure.

Chip cover adopted, preventing chips falling into causing bad motion.

Max. opening capacity 300 mm.

Double opening than those of same grade vice. Can easy clamp longer work piece.

The jaw more deeper than those of same grade vice. Can clamping higher work piece correctly.

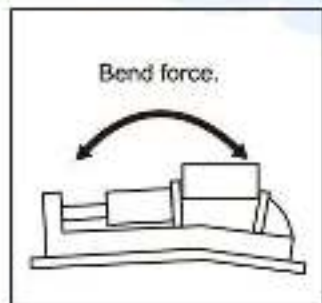

**High strength. High accuracy.**

Perpendicular rib structure with strain of vice. It could hardly

# 'LOCK-TIGHT' MACHINE VISES



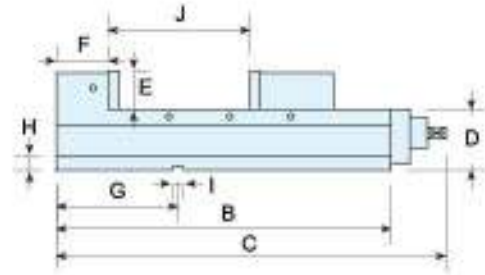

## Four clamping way for choice

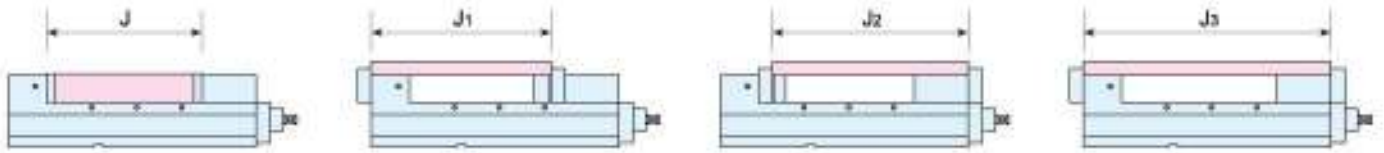

MODEL	A	B	C	D	E	F	G	H	I	J	J <sub>1</sub>	J <sub>2</sub>	J <sub>3</sub>	N.W.	G.W.	POWER
MPV-100A	100	400	530	85	45	80	110	23	18	200	230	260	340	32kg	35kg	4000kgf
MPV-130A	130	450	580	95	50	85	135	23	18	240	285	320	405	45kg	48kg	4500kgf
MPV-160A	160	550	680	100	60	103	200	23	18	300	380	400	500	63kg	66kg	5000kgf
MPV-200A	200	600	730	110	60	108	220	23	18	340	438	470	578	92kg	104kg	5500kgf

**PATENT NUMBER**  
 184869 201150  
 249761 256258  
**GERMANY 201125447**  
**CHINA ZL01231630X**



This unit had prevent lifting structure, when clamping in down direction power also acting, so the workpiece and movable parts lift very small, furthermore, the body and solid jaw is a combination structure, it does not tilt.



The whole Swivel Base are made by Stainless Steel, with harden treatment, durable and high accurate.

### Standard Accessories

- 1.Handle-1 set
- 2.Guide key-2pcs
- 3.Screw-M6x10Lx2pcs
- 4.Chip cover
- 5.Vise locked block-4pcs

### Optional Accessories

- 1.Special application jaw plates
- 2.Vise positioner
- 3.Swivel Base
- 4.Opening jaw plates
- 5.Sleeve spanner

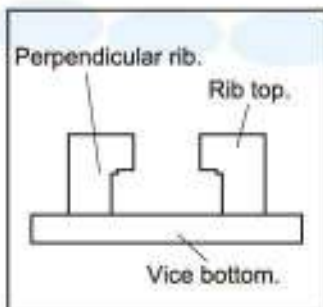

Ductile cast iron spring.



Microphotograph for ductile cast iron



which has great resistance to bending due to clamping to bring bend.

Ductile cast iron is fit to produce rigid precision items, which have three times strength than same grade vise due to used ductile cast iron.

The common contact face and slide face of movable parts both with good wear resistance of treat treatment (over HRC45°)



# HERBERT



Hydraulic

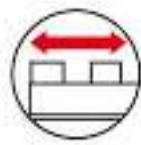

Big opening



Paralleling



Prevent lifting

## MC HYDRAULIC-TYPE PRECISION VICE

**CORNER** Most kindly design to considered every tiny point.

Non-trouble hydraulic pump of new development patented which gives greater clamping force easily.

Combine concave with convex is low pressure. Convex and concave are separated then become high pressure.

Chip cover adopted, preventing chips falling into causing bad motion.

Double opening than those of same grade vice. Can easy clamp longer work piece.

The jaw more deeper than those of same grade vice.. Can clamping higher work piece correctly.

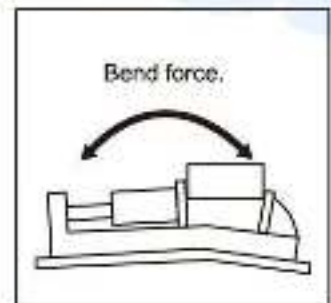

**High** strength. **High** accuracy.

Perpendicular rib structure w strain of vice. It could hardly

'LOCK-TIGHT' MACHINE VISES



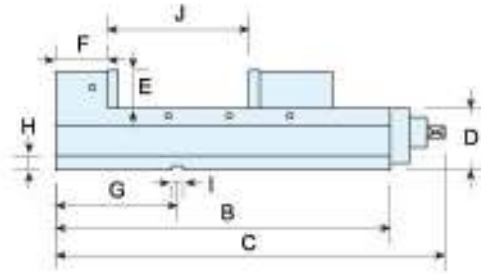

## Four clamping way for choice

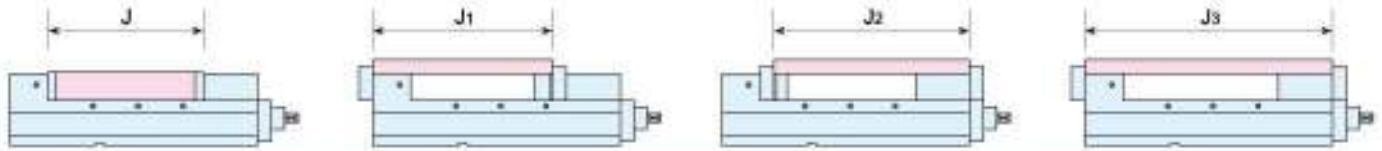

MODEL	A	B	C	D	E	F	G	H	I	J	J <sub>1</sub>	J <sub>2</sub>	J <sub>3</sub>	N.W.	G.W.	POWER
MHV-100A	100	400	540	85	45	80	110	23	18	150	230	260	340	32kg	35kg	4000kgf
MHV-130A	130	450	590	95	50	85	135	23	18	200	285	320	405	45kg	48kg	4500kgf
MHV-160A	160	550	690	100	60	103	200	23	18	265	380	400	500	63kg	66kg	5000kgf
MHV-200A	200	600	740	110	65	108	220	23	18	300	438	470	578	92kg	104kg	5500kgf

## PATENT NUMBER 256258



This unit had prevent lifting structure, when clamping in down direction power also acting, so the workpiece and movable parts lift very small, furthermore, the body and solid jaw is a combination structure, it does not tilt.



The whole Swivel Base are made by Stainless Steel, with harden treatment, durable and high accurate.

### Standard Accessories

- 1.Handle-1 set
- 2.Guide key-2pcs
- 3.Screw-M6x10Lx2pcs
- 4.Chip cover
- 5.Vise locked block-4pcs

### Optional Accessories

- 1.Special application jaw plates
- 2.Vise positioner
- 3.Swivel Base
- 4.Opening jaw plates
- 5.Sleeve spanner

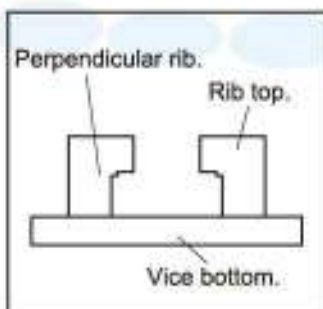

Ductile cast iron spring.



Microphotograph for ductile cast iron



which has great resistance to bending due to clamping to bring bend.

Ductile cast iron is fit to produce rigid precision items, which have three times strength than same grade vise due to used ductile cast iron.

The common contact face and slide face of movable parts both with good wear resistance of treat treatment (over HRC45°)



# HERBERT



Big opening



Paralleling



Prevent lifting

## MC MECHANICAL-TYPE PRECISION VICE

**CORNER** Most kindly design to considered every tiny point.

Chip cover adopted, preventing chips falling into causing bad motion.

Max. opening capacity 300 mm.

Double opening than those of same grade vice. Can easy clamp longer work piece.

The jaw more deeper than those of same grade vice. Can clamping higher workpiece correctly.

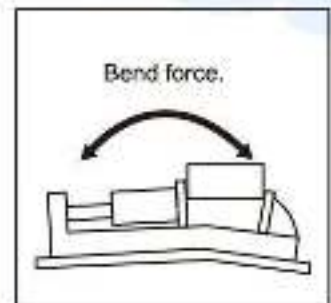

**High strength. High accuracy.**

Perpendicular rib structure with strain of vice. It could hardly

# 'LOCK-TIGHT' MACHINE VISES



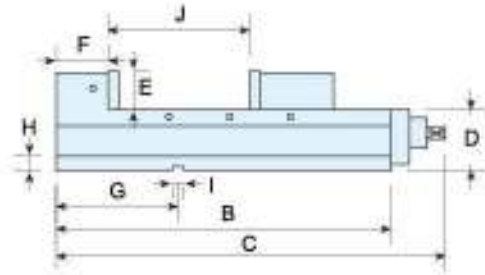
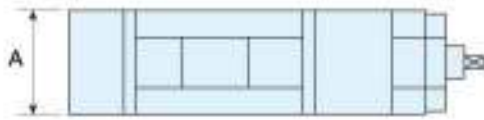

## Four clamping way for choice

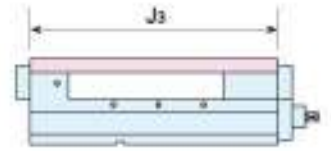
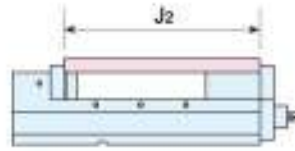
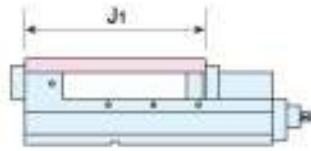
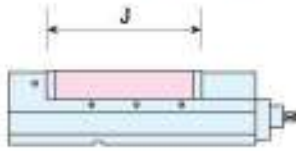

MODEL	A	B	C	D	E	F	G	H	I	J	J <sub>1</sub>	J <sub>2</sub>	J <sub>3</sub>	N.W.	G.W.	POWER
MB-100A	100	400	490	85	45	80	110	23	18	200	230	260	340	27kg	30kg	-
MB-130A	130	450	540	95	50	85	135	23	18	240	285	320	405	40kg	43kg	-
MB-160A	160	550	640	100	60	103	200	23	18	300	380	400	500	58kg	61kg	-
MB-200A	200	600	690	110	65	108	220	23	18	340	438	470	578	87kg	99kg	-

## PATENT NUMBER 256258



This unit had prevent lifting structure, when clamping in down direction power also acting, so the workpiece and movable parts lift very small, furthermore, the body and solid jaw is a combination structure, it does not tilt.



The whole Swivel Base are made by Stainless Steel, with harden treatment, durable and high accurate.

### Standard Accessories

1. Handle-1 set
2. Guide key-2pcs
3. Screw-M6x10Lx2pcs
4. Chip cover
5. Vise locked block-4pcs

### Optional Accessories

1. Special application jaw plates
2. Vise positioner
3. Swivel Base
4. Opening jaw plates
5. Sleeve spanner

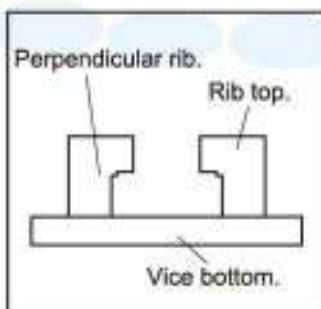

Ductile cast iron spring.



Microphotograph for ductile cast iron

which has great resistance to bending due to clamping to bring bend.

Ductile cast iron is fit to produce rigid precision items, which have three times strength than same grade vise due to used ductile cast iron.



The common contact face and slide face of movable parts both with good wear resistance of treat treatment (over HRC45°)



# HERBERT



Big opening



Paralleling



Prevent lifting

## MC DOUBLE-CLAMPING PRECISION VICE

**CORNER** Most kindly design to considered every tiny point.



Double opening than those of same grade vice. Can easy clamp longer work piece.

The jaw more deeper than those of same grade vice. Can clamping higher workpiece correctly.



New development double-clamp mechanism, can process two different size workpiece at same time, one unit treated as two units.

- Holding work-piece firmly in single and multiple setup.
- Double self-centering function.
- Each self-centering clearance within  $\pm 0.010\text{mm}$

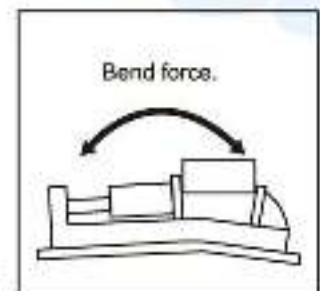

● Perpendicular rib structure w/ strain of vice. It could hardly c

**High** strength. **High** accuracy.

'LOCK-TIGHT' MACHINE VISES



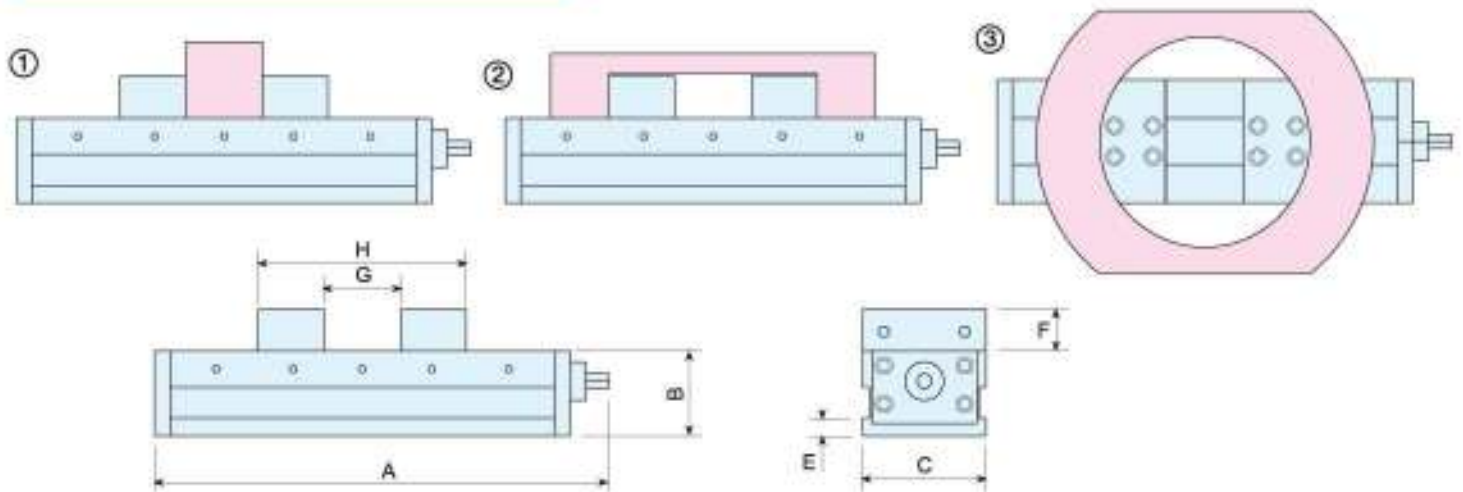

MODEL	A	B	C	D	E	F	G	H	N.W.
VSC-100	410	135	101	95	23	40	60-170	220-305	30kg
VSC-130	510	150	130	100	23	50	60-250	220-405	40kg
VSC-160	590	165	160	110	23	55	60-320	230-485	60kg
VSC-200	665	180	200	120	23	60	60-365	260-560	100kg

### PATENT NUMBER 256258

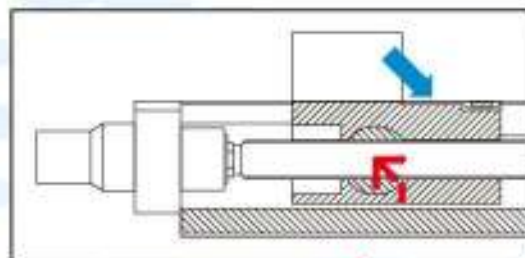

This unit had prevent lifting structure, when clamping in down direction power also acting, so the workpiece and movable parts lift very small, furthermore, the body and solid jaw is a combination structure, it does not tilt.



The whole Swivel Base are made by Stainless Steel, with harden treatment, durable and high accurate.

### Standard Accessories

1. Handle-1 set
2. Guide key-2pcs
3. Screw-M6x10Lx2pcs
4. Vise locked block-4pcs

### Optional Accessories

1. Special application jaw plates
2. Vise positioner
3. Swivel Base
4. Opening jaw plates

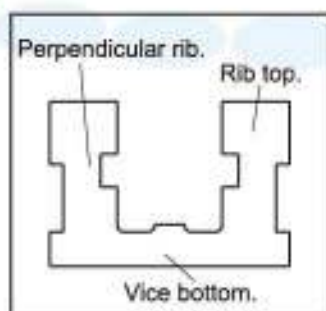

Ductile cast iron spring.



Microphotograph for ductile cast iron



The common contact face and slide face of movable parts both with good wear resistance of treat treatment (over HRC45°)

which has great resistance to bending due to clamping to bring bend.

Ductile cast iron is fit to produce rigid precision items, which have three times strength than same grade vise due to used ductile cast iron.



# HERBERT



Big opening



Paralleling



Prevent lifting

## MC 2 IN 1 DOUBLE LOCK & ANGLOCK MACHINE VISE

**CORNER** Most kindly design to considered every tiny point.

Double opening than those of same grade vice. Can easy clamp longer work piece.

The jaw more deeper than those of same grade vice. Can clamping higher workpiece correctly.

New development double-clamp mechanism, can process two different size workpiece at same time, one unit treated as two units.

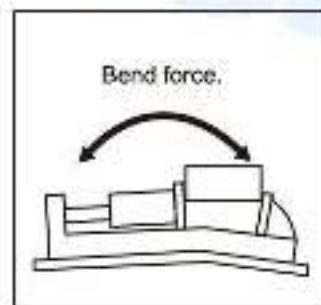

**High strength. High accuracy.**

Perpendicular rib structure with strain of vise. It could hardly

# 'LOCK-TIGHT' MACHINE VISES



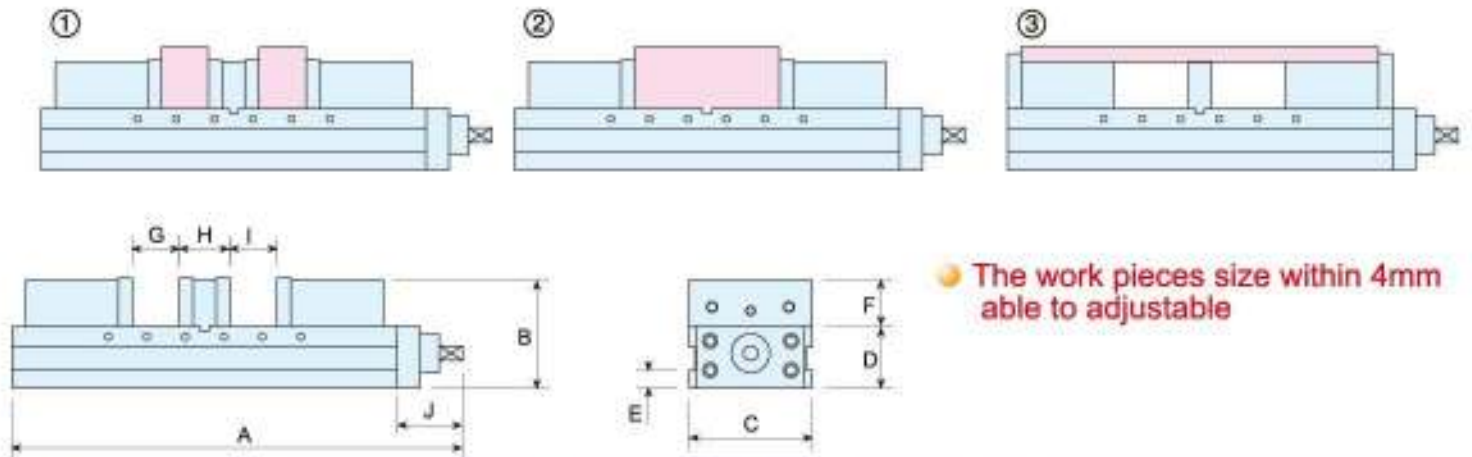

The work pieces size within 4mm able to adjustable

MODEL	A	B	C	D	E	F	G	H	I	J	WEIGHT
MLD-100A	470	105	100	65	23	40	55	60	55	70	25kg
MLD-160A	580	145	160	90	23	60	75	66	75	80	50kg

This unit had prevent lifting structure, when clamping in down direction power also acting, so the workpiece and movable parts lift very small, furthermore, the body and solid jaw is a combination structure, it does not tilt.



The whole Swivel Base are made by Stainless Steel, with harden treatment, durable and high accurate.

### Standard Accessories

1. Handle-1 set
2. Guide key-2pcs
3. Screw-M6x10Lx2pcs
4. Vise locked block-4pcs

### Optional Accessories

1. Special application jaw plates
2. Vise positioner
3. Swivel Base
4. Opening jaw plates

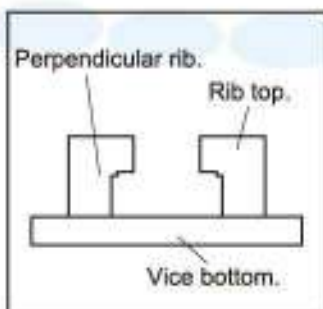

Ductile cast iron spring.



Microphotograph for ductile cast iron

which has great resistance to bending due to clamping to bring bend.

Ductile cast iron is fit to produce rigid precision items, which have three times strength than same grade vise due to used ductile cast iron.



The common contact face and slide face of movable parts both with good wear resistance of treat treatment (over HRC45°)



# HERBERT

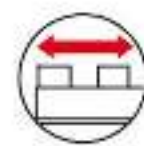

Big opening



Paralleling



Prevent lifting

## MC DOUBLE-CLAMPING PRECISION VICE

**CORNER** Most kindly design to considered every tiny point.

Double opening than those of same grade vice. Can easy clamp longer work piece.

The jaw more deeper than those of same grade vice. Can clamping higher workpiece correctly.

New development double-clamp mechanism, can process two different size workpiece at same time, one unit treated as two units.

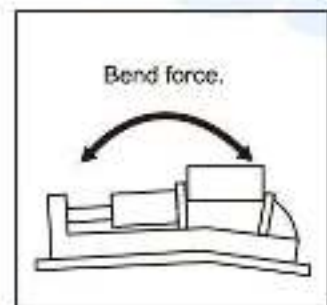

**High** strength. **High** accuracy.

Perpendicular rib structure with strain of vice. It could hardly

'LOCK-TIGHT' MACHINE VISES



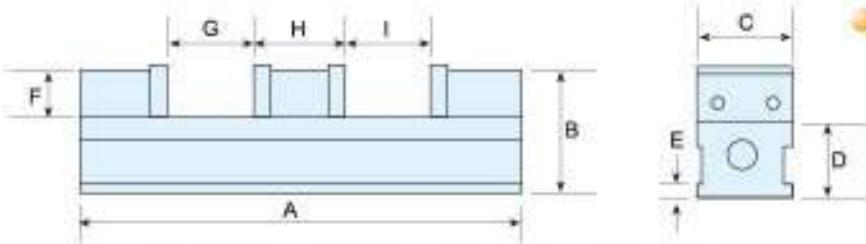
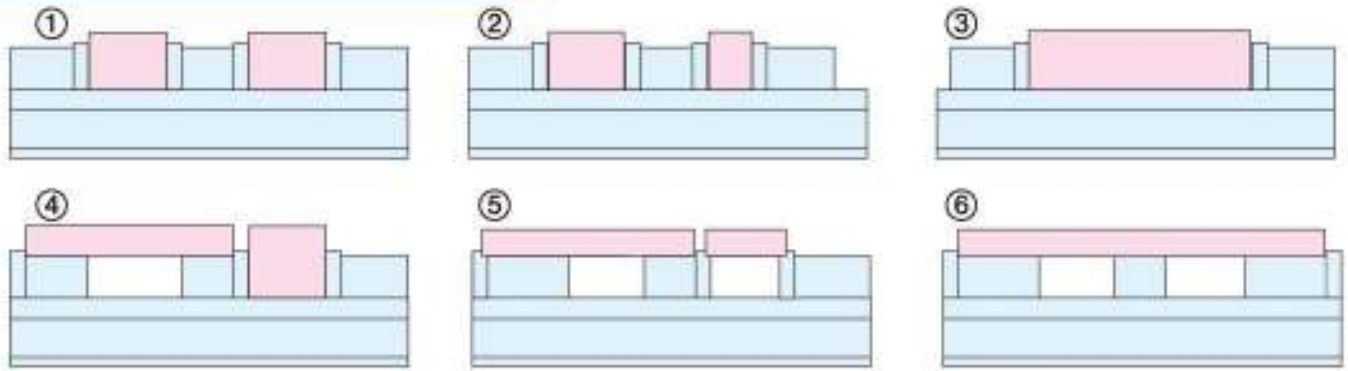

The work pieces size within 75mm able to adjustable

This unit had prevent lifting structure, when clamping in down direction power also acting, so the workpiece and movable parts lift very small, furthermore, the body and solid jaw is a combination structure, it does not tilt.

MODEL	A	B	C	D	E	F	G	H	I	WEIGHT
MLD-100	400	105	100	65	23	40	55	60	55	25kg
MLD-160	500	145	160	90	23	60	75	66	75	50kg



The whole Swivel Base are made by Stainless Steel, with harden treatment, durable and high accurate.

### Standard Accessories

1. Handle-1 set
2. Guide key-2pcs
3. Screw-M6x10Lx2pcs
4. Vise locked block-4pcs

### Optional Accessories

1. Special application jaw plates
2. Vise positioner
3. Swivel Base
4. Opening jaw plates

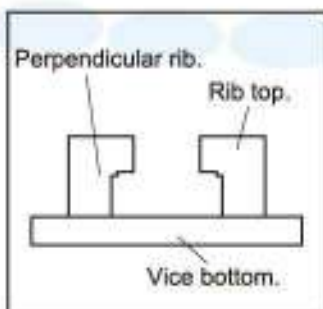

Ductile cast iron spring.



Microphotograph for ductile cast iron



The common contact face and slide face of movable parts both with good wear resistance of treat treatment (over HRC45°)

Ductile cast iron is fit to produce rigid precision items, which have three times strength than same grade vise due to used ductile cast iron.

which has great resistance to bending due to clamping to bring bend.



# HERBERT



Powerful



Big opening



Paralleling



Prevent lifting

## MC PNEUMATIC QUICK VISE

**CORNER** Most kindly design to considered every tiny point.

The greatest safety distance of biting:  
The switch is only 1.5 seconds, and the safety distance of biting can be up to 8mm.  
We design the hand wheel safety line in addition for anyone to distinguish the biting safety distance of tools from exceeding the limit easily by eyes.

Hymanization design of the hand wheel: One can turn the hand wheel directly to drive upper cover without using any knob or handhold so as to assist biting action.



The principle of this vise is the reciprocating air pressure motor (Patent structure) R&D by ourselves. It achieves the property of automatically biting by means of continuously increasing the pressure to push the oil way. The property is second to none domestically and even surpasses foreign brands.

- Most compact pneumatic mechanism design. No oil, just joint with the air supply will do.
- Easy and simple ON-OFF switch control for pneumatic operation. The optional electric control for automatic and FMS system is available.
- Most suitable for mass production and to be used on machine centers, milling machines. Drilling machines and special purpose machines.

**High** strength. **High** accuracy.

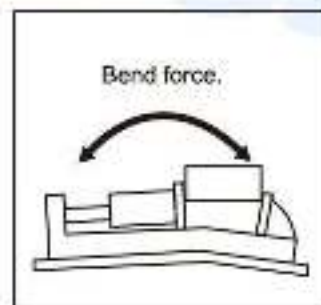

- Perpendicular rib structure with strain of vise. It could hardly

'LOCK-TIGHT' MACHINE VISES



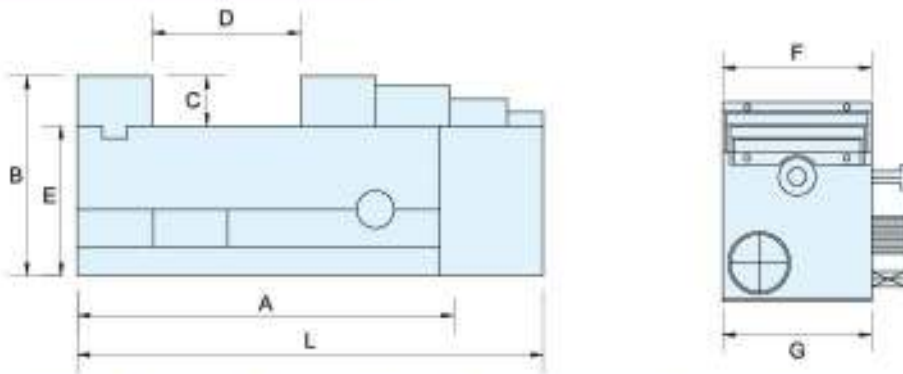

MODEL	A	B	C	D	E	F	G	L	POWER	TRAVEL
MVS-115	300	160	40	115	120	120	120	375	2200kgf	0-3mm



● This unit had prevent lifting structure, when clamping in down direction power also acting, so the workpiece and movable parts lift very small, furthermore, the body and solid jaw is a combination structure, it does not tilt.

### AIR PRESSURE CHART

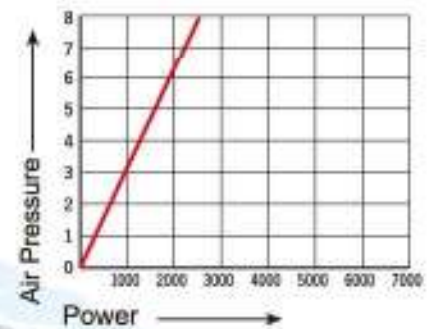

**PATENT NUMBER**  
**308823**



### Standard Accessories

1. Handle-1 set
2. Guide key-2pcs
3. Screw-M6x10Lx2pcs
4. Chip cover
5. Vise locked block-4pcs

### Optional Accessories

1. Special application jaw plates
2. Vise positioner
3. Swivel Base
4. Opening jaw plates

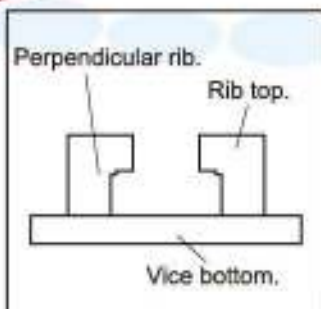

Ductile cast iron spring.



Microphotograph for ductile cast iron

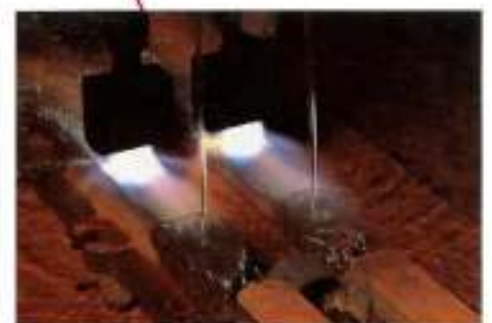

which has great resistance to bending due to clamping to bring bend.

● Ductile cast iron is fit to produce rigid precision items, which have three times strength than same grade vise due to used ductile cast iron.

● The common contact face and slide face of movable parts both with good wear resistance of treat treatment (over HRC45°)



# HERBERT



Hydraulic



Change



Paralleling



Prevent lifting

## MC PRECISION SUPER HI-PRESSURE RAPID VICE

**CORNER** Most kindly design to considered every tiny point.



Chip cover adopted, preventing chips falling into causing bad motion.

Double opening than those of same grade vice. Can easy clamp longer work piece.

Max. opening capacity 300 mm.

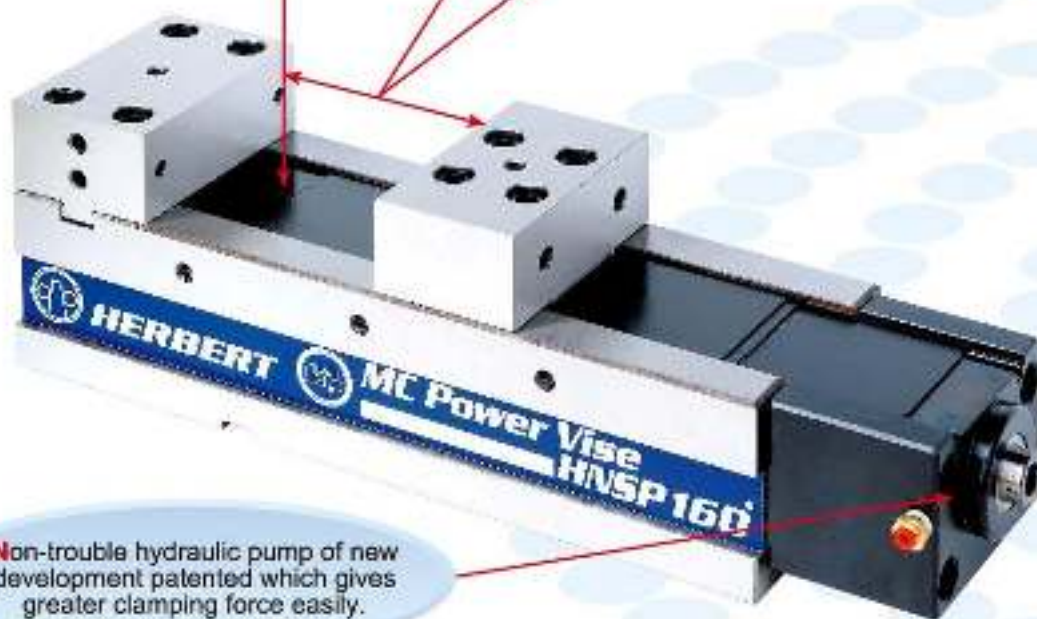

Non-trouble hydraulic pump of new development patented which gives greater clamping force easily.



MODEL
HNSP-100A
HNSP-130A
HNSP-160A
HNSP-200A
Travel 0-6

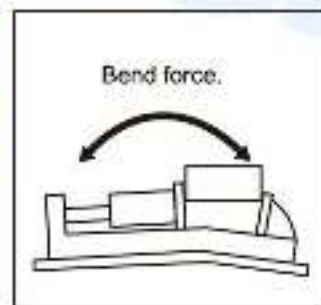

**High** strength. **High** accuracy.

Perpendicular rib structure with strain of vice. It could hardly

'LOCK-TIGHT' MACHINE VISES



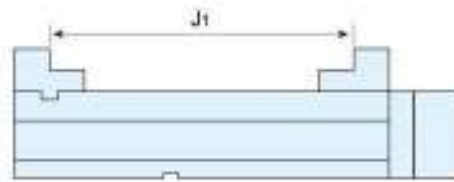
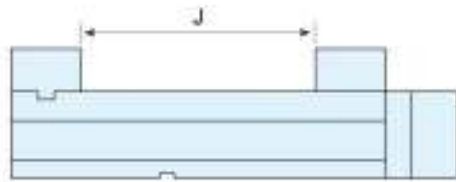
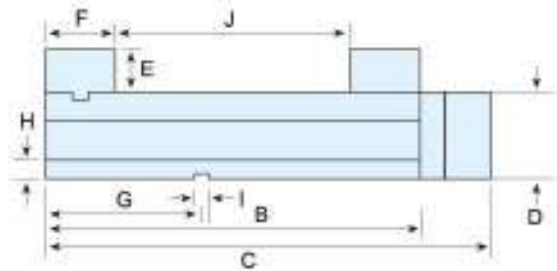
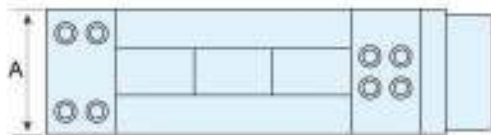

MODEL	A	B	C	D	E	F	G	H	I	J	J <sub>1</sub>	TRAVEL	N.W.	G.W.	POWER
HNSP-100	100	310	410	95	45	70	110	23	18	140	200	0-6	27kg	30kg	1800kgf
HNSP-130	130	410	510	100	50	80	135	23	18	230	315	0-6	45kg	48kg	2800kgf
HNSP-160	160	490	590	110	55	85	150	23	18	300	385	0-6	60kg	62kg	3000kgf
HNSP-200	200	565	665	120	60	100	220	23	18	350	450	0-6	100kg	105kg	3000kgf

**PATENT NUMBER**  
**256258**  
**311528**

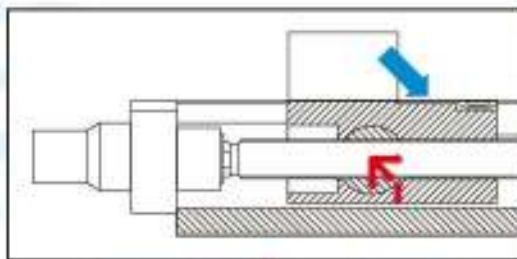

This unit had prevent lifting structure, when clamping in down direction power also acting, so the workpiece and movable parts lift very small, furthermore, the body and solid jaw is a combination structure, it does not tilt.

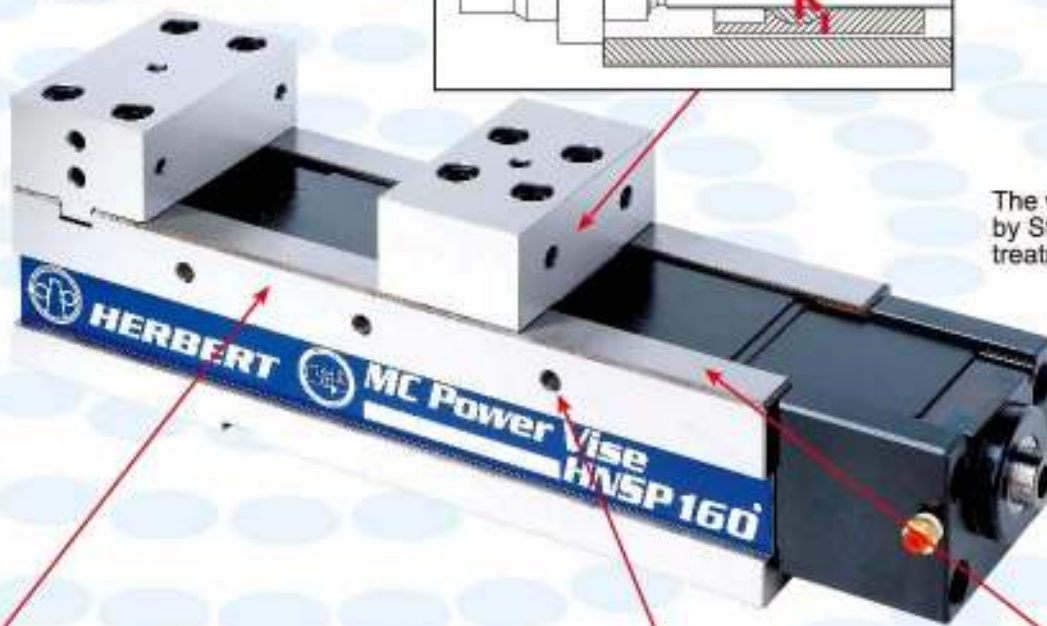

The whole Swivel Base are made by Stainless Steel, with harden treatment, durable and high accurate.

### Standard Accessories

1. Handle-1 set
2. Guide key-2pcs
3. Screw-M6x10Lx2pcs
4. Chip cover
5. Vise locked block-4pcs

### Optional Accessories

1. Special application jaw plates
2. Vise positioner
3. Swivel Base
4. Opening jaw plates
5. Sleeve spanner

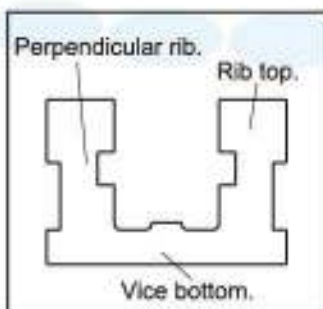

which has great resistance to bending due to clamping to bring bend.



Ductile cast iron spring.



Microphotograph for ductile cast iron

Ductile cast iron is fit to produce rigid precision items, which have three times strength than same grade vise due to used ductile cast iron.



The common contact face and slide face of movable parts both with good wear resistance of treat treatment (over HRC45°)



# HERBERT



Air Pressure



Big opening



Paralleling



Prevent lifting

## PNEUMATIC MC PRECISION ANGLE-FIXED VICE

**CORNER** Most kindly design to considered every tiny point.

**The greatest safety distance of biting:**  
The switch is only 1.5 seconds, and the safety distance of biting can be up to 8mm. We design the hand wheel safety line in addition for anyone to distinguish the biting safety distance of tools from exceeding the limit easily by eyes.

**Double opening than those of same grade vice.** Can clamping longer work piece easier.

**Hymanization design of the hand wheel:** One can turn the hand wheel directly to drive upper cover without using any knob or handhold so as to assist biting action.

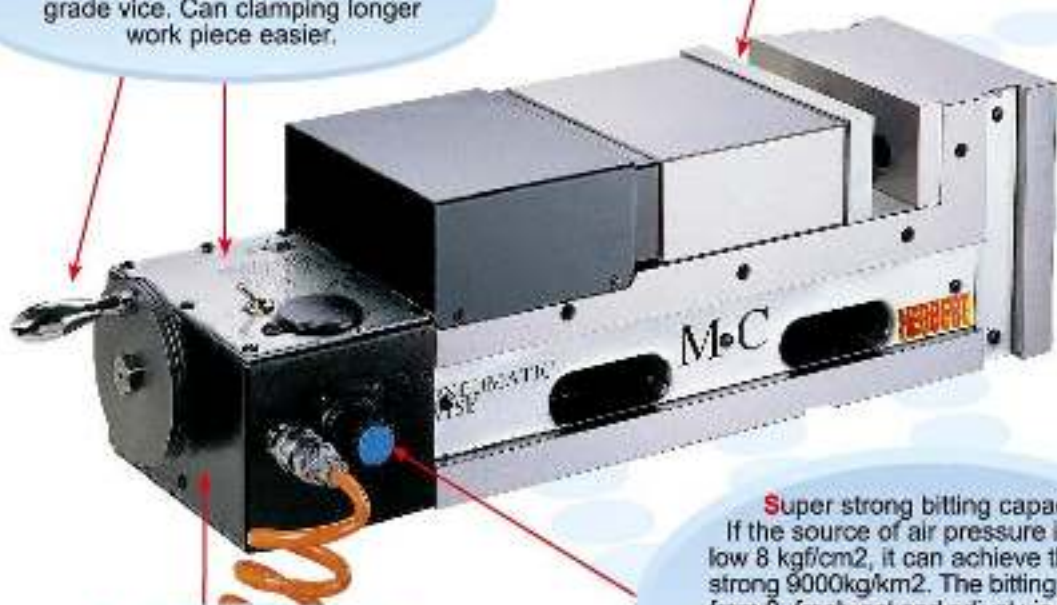

**The principle of this vise is the reciprocating air pressure motor (Patent structure) R&D by ourselves.** It achieves the property of automatically biting by means of continuously increasing the pressure to push the oil way. The property is second to none domestically and even surpasses foreign brands.

**Super strong biting capacity:**  
If the source of air pressure is under low 8 kgf/cm<sup>2</sup>, it can achieve the super strong 9000kg/km<sup>2</sup>. The biting capacity from 0—freely set and adjust via pressure regulator.

**Automatically seeking the highest source.** When the pressure regulator sets the will not of order because the source.



Bend force.

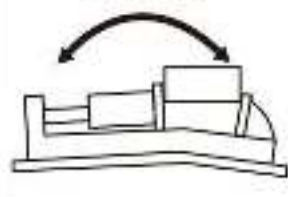

**High strength. High accuracy.**

Perpendicular rib structure with strain of vice. It could hardly

'LOCK-TIGHT' MACHINE VISES



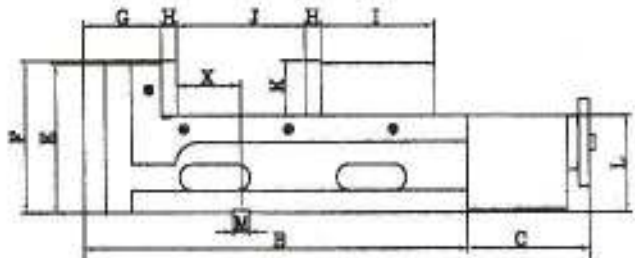
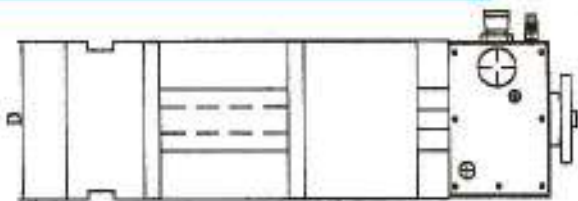

MODEL	A	B	C	D	E	F	G	H	I	J	K	L	M	X	GRIPPING FORCE	N.W.	G.W.
MVS-130	520	380	140	130	157	160	85	15	110	0-150	55	105	18	45	6000kgf	42kg	48kg
MVS-160	540	400	140	160	157	160	87	15	120	0-160	55	105	18	45	6000kgf	47kg	58kg
MVS-180	600	460	140	180	170	173	90	18	130	0-200	63	110	18	72	9000kgf	65kg	72kg
MVS-200	610	470	140	200	170	173	90	18	140	0-200	63	110	18	72	9000kgf	70kg	80kg



This unit had prevent lifting structure, when clamping in down direction power also acting, so the workpiece and movable parts lift very small, furthermore, the body and solid jaw is a combination structure, it does not tilt.

## AIR PRESSURE CHART

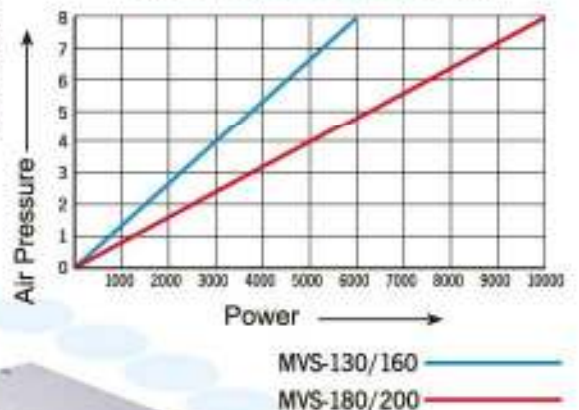

Chip cover adopted preventing chips falling into causing bad motion.

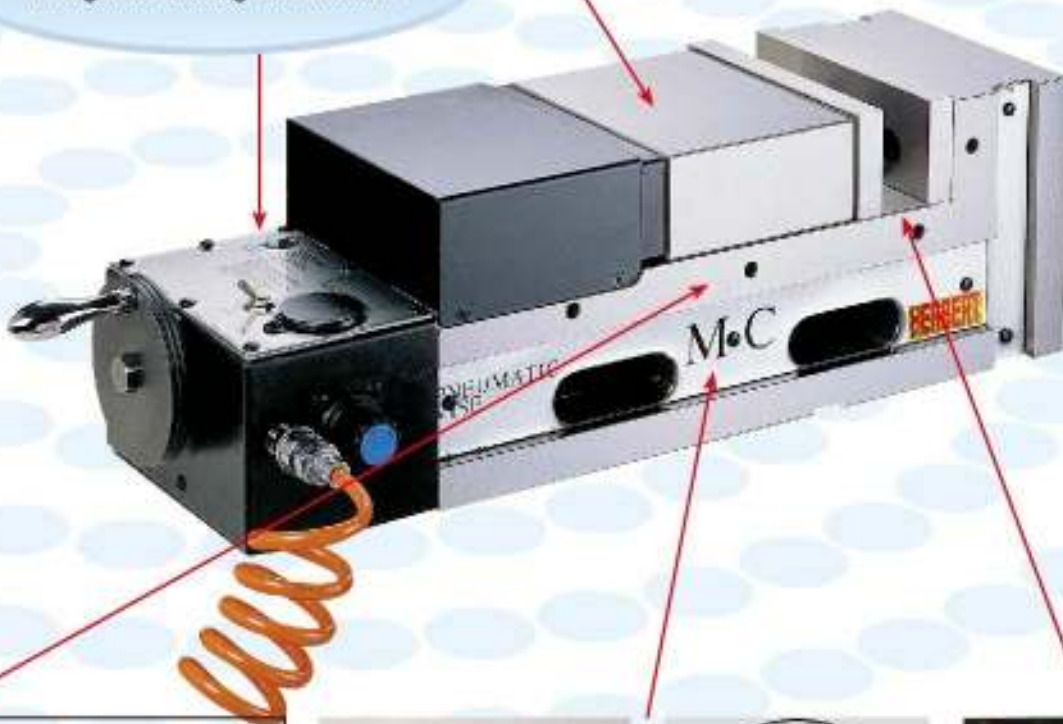

### Standard Accessories

1. Handle-1 set
2. Guide key-2pcs
3. Screw-M6x10Lx2pcs
4. Chip cover
5. Vise locked block-4pcs

### Optional Accessories

1. Special application jaw plates
2. Vise positioner
3. Swivel Base
4. Opening jaw plates

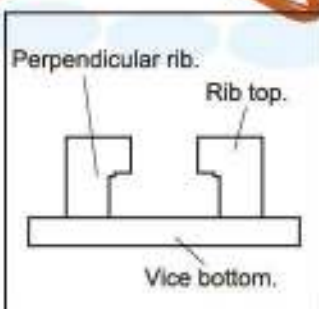

Ductile cast iron spring.



Microphotograph for ductile cast iron



which has great resistance to bending due to clamping to bring bend.

Ductile cast iron is fit to produce rigid precision items, which have three times strength than same grade vise due to used ductile cast iron.

The common contact face and slide face of movable parts both with good wear resistance of treat treatment (over HRC45°)



# HERBERT



Powerful



Big opening



Paralleling



Prevent lifting

## MC UNIVERSAL POWERFUL-TYPE PRECISION VICE

**CORNER** Most kindly design to considered every tiny point.

Double opening than those of same grade vice. Can easy clamp longer work piece.

New development patented, oil-free powerful mechanical boost system. which gives greater clamping and never collapsing pressrue.

Max. opening capacity 500 mm.

Take off the jaws and chip cover to enable the maximum open of 500mm



Chip cover adopted, preventing chips falling into causing bad motion.

The jaw more deeper than those of same grade vice.. Can clamping higher work piece correctly.

Bend force.

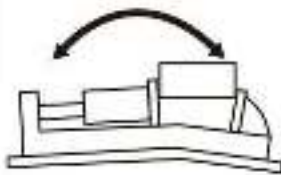

**High** strength. **High** accuracy.

Perpendicular rib structure with strain of vice. It could hardly



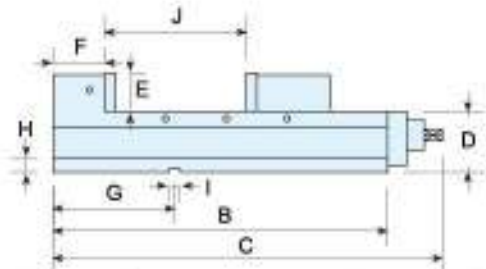
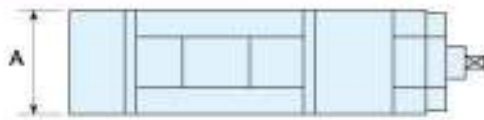

### Four clamping way for choice

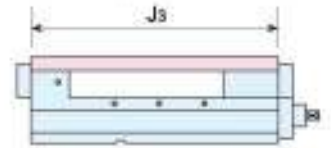
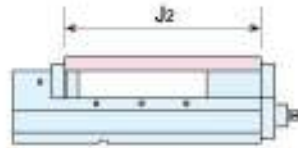
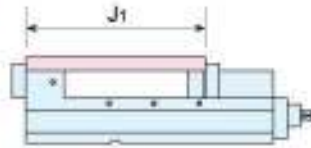
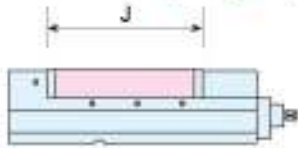

MODEL	A	B	C	D	E	F	G	H	I	J	J <sub>1</sub>	J <sub>2</sub>	J <sub>3</sub>	N.W.	G.W.	POWER
MPV-160LS	160	725	860	105	60	103	100	23	18	500	580	620	720	80kg	91kg	4400kgf
MPV-200LS	200	835	970	110	60	108	220	23	18	600	690	730	830	100kg	115kg	5500kgf

MODEL	A	B	C	D	E	F	G	H	I	J	J <sub>1</sub>	J <sub>2</sub>	J <sub>3</sub>	N.W.	G.W.	POWER
MPV-160L	160	1000	1130	105	60	103	100	23	18	750	850	890	1000	90kg	108kg	4400kgf
MPV-200L	200	1100	1230	110	60	108	220	23	18	840	940	990	1100	130kg	145kg	5500kgf

**PATENT NUMBER**  
201150 249761

**Max. opening capacity 750 mm.**

This unit had prevent lifting structure, when clamping in down direction power also acting, so the workpiece and movable parts lift very small, furthermore, the body and solid jaw is a combination structure, it does not tilt.

The whole Swivel Base are made by Stainless Steel, with harden treatment, durable and high accurate.



Take off the jaws and chip cover to enable the maximum open of 700mm

### Standard Accessories

- 1.Handle-1 set
- 2.Guide key-2pcs
- 3.Screw-M6x10Lx2pcs
- 4.Chip cover
- 5.Vise locked block-8pcs

### Optional Accessories

- 1.Special application jaw plates
- 2.Vise positioner
- 3.Swivel Base
- 4.Opening jaw plates
- 5.Sleeve spanner

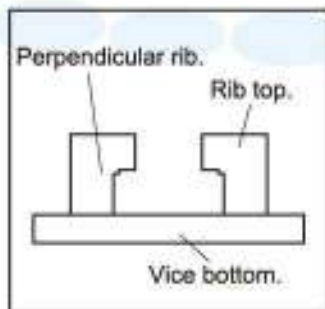

Ductile cast iron spring.



Microphotograph for ductile cast iron



which has great resistance to bending due to clamping to bring bend.

Ductile cast iron is fit to produce rigid precision items, which have three times strength than same grade vise due to used ductile cast iron.

The common contact face and slide face of movable parts both with good wear resistance of treat treatment (over HRC45°)



# HERBERT



Powerful



Big opening



Paralleling



Prevent lifting

## MC UNIVERSAL ANGLE-FIXED AND POWERFUL-TYPE ONE-UNIT VERTICAL PRECISION VICE

**CORNER** Most kindly design to considered every tiny point.

**Note :** If opening 300mm need dismantle chip cover.

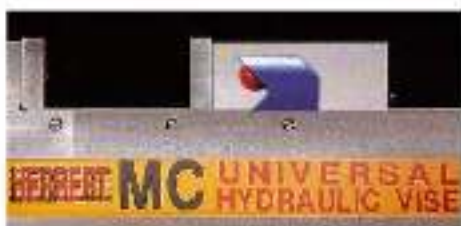

- This unit had prevent lifting structure, when clamping in down direction power also acting, so the workpiece and movable parts lift very small, furthermore, the body and solid jaw is a combination structure, it does not tilt.



- The common contact face and slide face of movable parts both with good wear resistance of treat heatment (over HRC45°)



Microphotograph for ductile cast iron



Ductile cast iron spring.

- Ductile cast iron is fit to produce rigid precision items, which have three times strengthen than same grade vise due to used ductile cast iron.
- Perpendicular rib structure which has great resistance to bending strain of vise. It could hardly due to clamping to bring bend.

**High** strength. **High** accuracy.

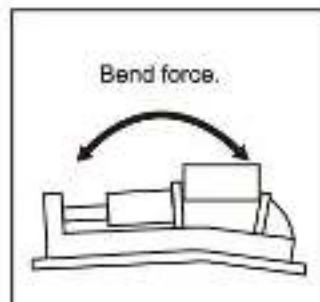
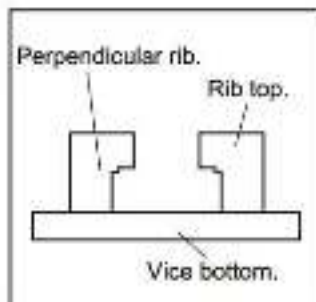

'LOCK-TIGHT' MACHINE VISES



**POWERFUL**



**MPV**

**HYDRAULIC**



**MHV**

**MECHANICAL**



**MB**

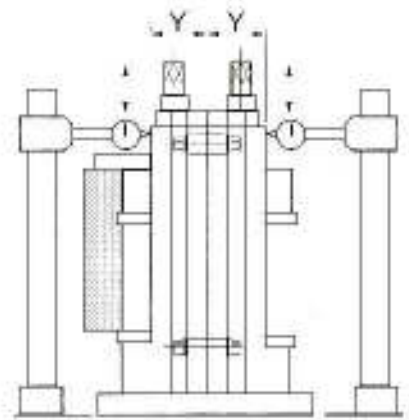
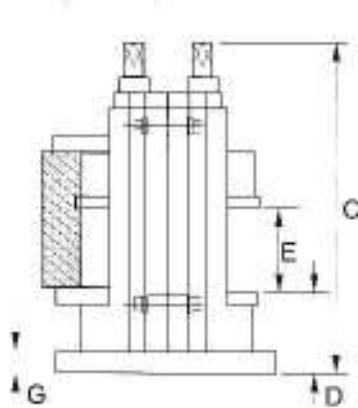
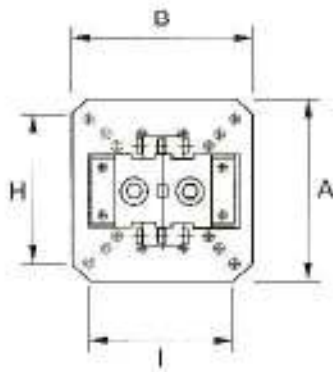

NO	TEST ITEM	GURARANTEED	REMARK
1	Both vise jaw plate parallel within 0.02mm	0.020mm	-
2	Vise "Y" omension with 0.020mm	0.020mm	-
3	Vise on bottom of vise bed square within 0.010mm/100mm	0.010/100mm	-

MODEL	A	B	C	D	E	F	G	H	I	POWER
MB-100 2V	300	300	530	120	150	45	40	200	200	-
MB-130 2V	300	300	580	125	200	50	40	200	200	-
MB-160 2V	400	400	680	143	280	60	40	320	320	-
MB-200 2V	400	400	730	148	300	70	40	320	320	-
MHV-100 2V	300	300	570	120	145	45	40	200	200	4000kgf
MHV-130 2V	300	300	620	125	190	50	40	200	200	4500kgf
MHV-160 2V	400	400	720	143	265	60	40	320	320	5000kgf
MHV-200 2V	400	400	770	148	300	70	40	320	320	5500kgf
MPV-100 2V	300	300	570	120	150	45	40	200	200	4000kgf
MPV-130 2V	300	300	620	125	200	50	40	200	200	4500kgf
MPV-160 2V	400	400	720	143	280	60	40	320	320	5000kgf
MPV-200 2V	400	400	770	148	300	70	40	320	320	5500kgf



# HERBERT



Powerful



Big opening



Paralleling



Prevent lifting

## MC MECHANICAL-TYPE PRECISION VICE

**CORNER** Most kindly design to considered every tiny point.

Note : If opening 300mm need dismantle chip cover.



- This unit had prevent lifting structure, when clamping in down direction power also acting, so the workpiece and movable parts lift very small, furthermore, the body and solid jaw is a combination structure, it does not tilt.



- The common contact face and slide face of movable parts both with good wear resistance of treat heatment (over HRC45°)



Microphotograph for ductile cast iron



Ductile cast iron spring.

- Ductile cast iron is fit to produce rigid precision items, which have three times strengthen than same grade vise due to used ductile cast iron.

**High** strength. **High** accuracy.

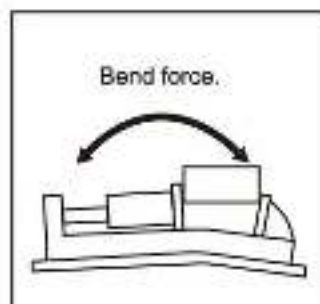
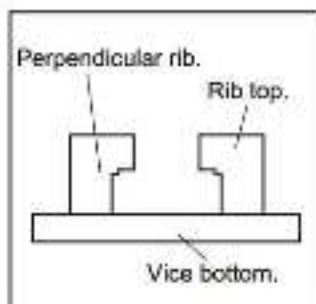

- Perpendicular rib structure which has great resistance to bending strain of vise. It could hardly due to clamping to bring bend.

# 'LOCK-TIGHT' MACHINE VISES



## POWERFUL



**MPV**

## HYDRAULIC



**MHV**

## MECHANICAL



**MB**

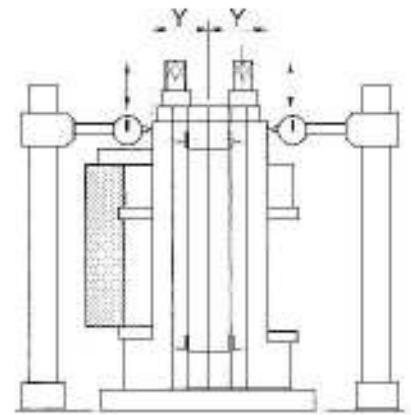
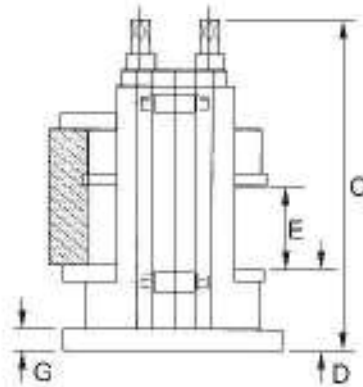
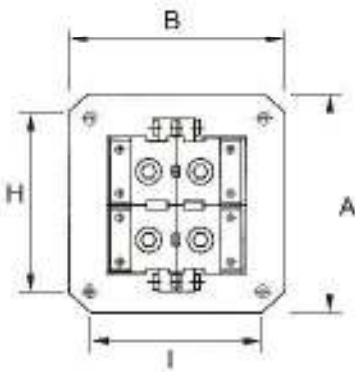

NO	TEST ITEM	GURARANTEED	REMARK
1	Both vise jaw plate parallel within 0.02mm	0.020mm	-
2	Vise "Y" omension with 0.020mm	0.020mm	-
3	Vise on bottom of vise bed square within 0.010mm/100mm	0.010/100mm	-

MODEL	A	B	C	D	E	F	G	H	I	POWER
MB-100 4V	400	400	530	120	150	45	40	320	320	-
MB-130 4V	400	400	580	125	200	50	40	320	320	-
MB-160 4V	500	500	680	143	280	60	40	400	400	-
MB-200 4V	500	500	730	148	300	70	40	400	400	-
MHV-100 4V	400	400	570	120	145	45	40	320	320	4000kgf
MHV-130 4V	400	400	620	125	190	50	40	320	320	4500kgf
MHV-160 4V	500	500	720	143	265	60	40	400	400	5000kgf
MHV-200 4V	500	500	770	148	300	70	40	400	400	5500kgf
MPV-100 4V	400	400	570	120	150	45	40	320	320	4000kgf
MPV-130 4V	400	400	620	125	200	50	40	320	320	4500kgf
MPV-160 4V	500	500	720	143	280	60	40	400	400	5000kgf
MPV-200 4V	500	500	770	148	300	70	40	400	400	5500kgf



# HERBERT



Powerful



Big opening



Paralleling



Prevent lifting

## MC MECHANICAL-TYPE PRECISION VICE

**CORNER** Most kindly design to considered every tiny point.

Note : If opening 300mm need dismantle chip cover.



- This unit had prevent lifting structure, when clamping in down direction power also acting, so the workpiece and movable parts lift very small, furthermore, the body and solid jaw is a combination structure, it does not tilt.



- The common contact face and slide face of movable parts both with good wear resistance of treat heatment (over HRC45°)



Microphotograph for ductile cast iron



Ductile cast iron spring.

- Ductile cast iron is fit to produce rigid precision items, which have three times strengthen than same grade vise due to used ductile cast iron.
- Perpendicular rib structure which has great resistance to bending strain of vise. It could hardly due to clamping to bring bend.

High strength. High accuracy.

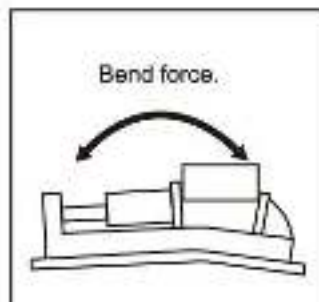
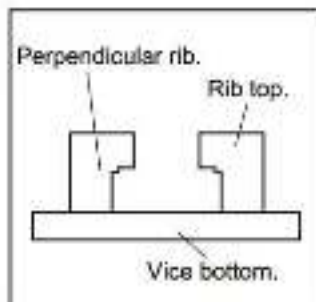

# 'LOCK-TIGHT' MACHINE VISES



## POWERFUL



**MPV**

## HYDRAULIC



**MHV**

## MECHANICAL



**MB**

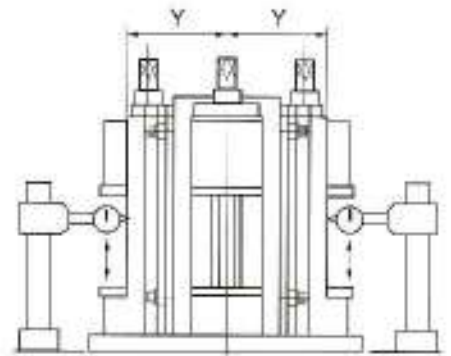
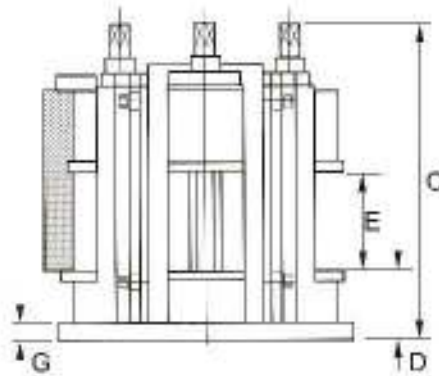
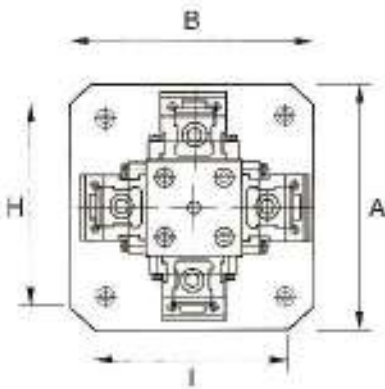

NO	TEST ITEM	GURARANTEED	REMARK
1	Both vise jaw plate parallel within 0.02mm	0.020mm	-
2	Vise "Y" omension with 0.020mm	0.020mm	-
3	Vise on bottom of vise bed square within 0.010mm/100mm	0.010/100mm	-

MODEL	A	B	C	D	E	F	G	H	I	POWER
MB-100 4VL	450	450	530	120	150	45	40	320	320	-
MB-130 4VL	500	500	580	125	200	50	40	400	400	-
MB-160 4VL	500	500	680	143	280	60	40	400	400	-
MB-200 4VL	600	600	730	148	300	70	40	500	500	-
MHV-100 4VL	450	450	570	120	145	45	40	320	320	4000kgf
MHV-130 4VL	500	500	620	125	190	50	40	400	400	4500kgf
MHV-160 4VL	500	500	720	143	265	60	40	400	400	5000kgf
MHV-200 4VL	600	600	770	148	300	70	40	500	500	5500kgf
MPV-100 4VL	450	450	570	120	150	45	40	320	320	4000kgf
MPV-130 4VL	500	500	620	125	200	50	40	400	400	4500kgf
MPV-160 4VL	500	500	720	143	280	60	40	400	400	5000kgf
MPV-200 4VL	600	600	770	148	300	70	40	500	500	5500kgf



# HERBERT



Powerful



Big opening



Paralleling



Prevent lifting

## MC UNIVERSAL ANGLE-FIXED AND POWERFUL-TYPE TWO-AND FOUR-UNIT VERTICAL PRECISION VICE WITH FOUR VERTICAL CLAMPING BARRELS

**CORNER** Most kindly design to considered every tiny point.



- This unit had prevent lifting structure, when clamping in down direction power also acting, so the workpiece and movable parts lift very small, furthermore, the body and solid jaw is a combination structure, it does not tilt.

**High strength. High accuracy.**

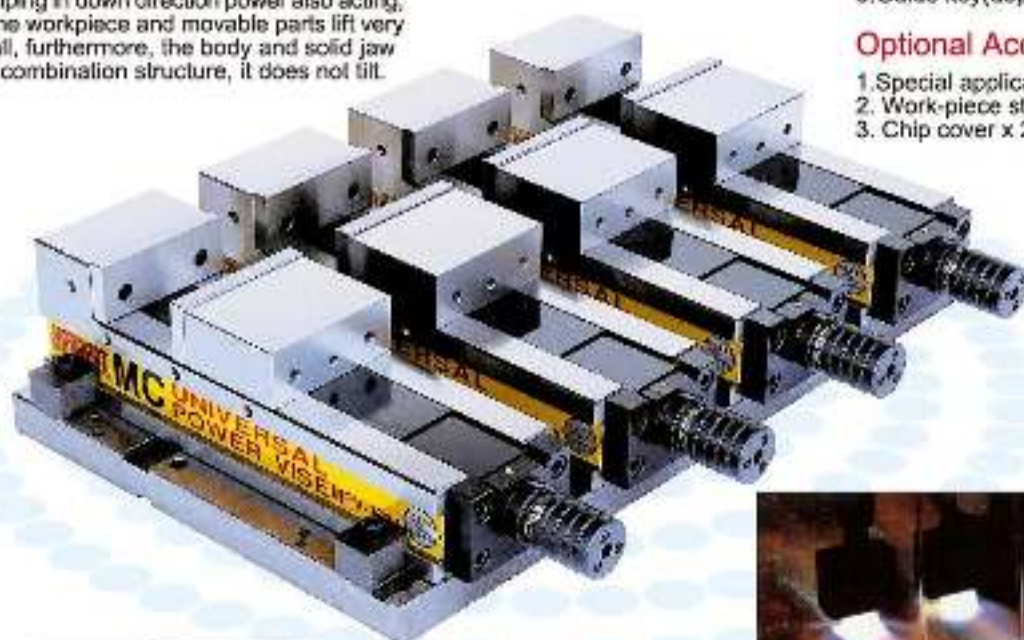

### Standard Accessories

1. Handle x 2, 3, 4 set
2. Sub plate x 1pc
3. Guide key (depends on vises)

### Optional Accessories

1. Special application jaw plates
2. Work-piece stopper
3. Chip cover x 2, 3, 4 sets



- The common contact face and slide face of movable parts both with good wear resistance of treat treatment (over HRC45°)



Microphotograph for ductile cast iron



Ductile cast iron spring.

- Ductile cast iron is fit to produce rigid precision items, which have three times strength than same grade vise due to used ductile cast iron.
- Perpendicular rib structure which has great resistance to bending strain of vise. It could hardly due to clamping to bring bend.

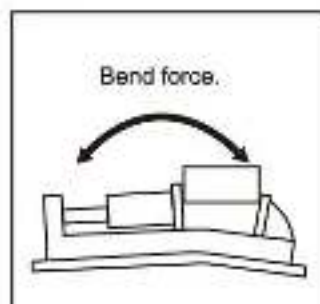
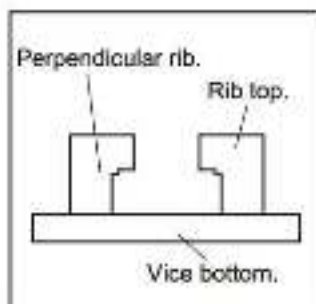

# 'LOCK-TIGHT' MACHINE VISES



**POWERFUL**



**MPV**

**HYDRAULIC**



**MHV**

**MECHANICAL**



**MB**

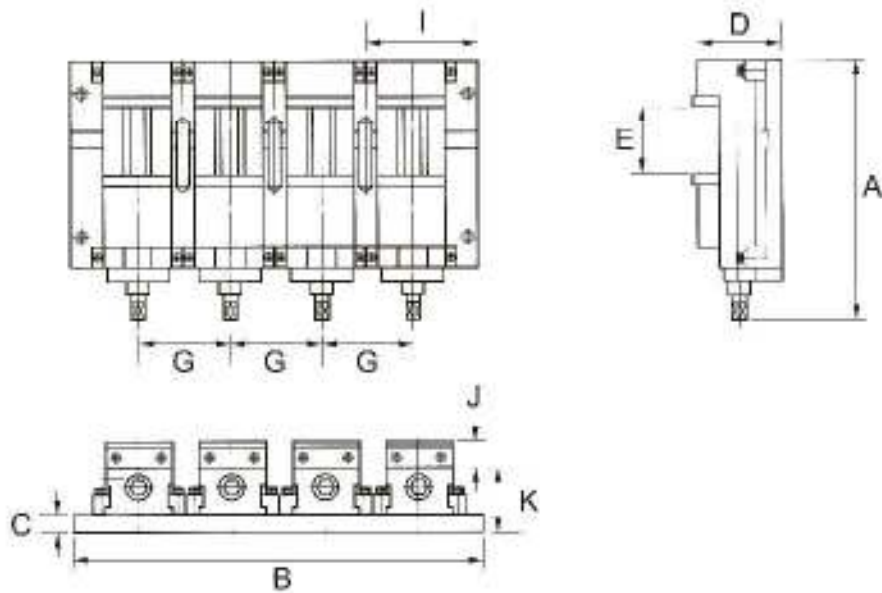

NO	TEST ITEM	GURARANTEED	REMARK
1	Both vise jaw plate parallel within 0.02mm	0.020mm	-
2	Vise "Y" omension with 0.020mm	0.020mm	-
3	Vise on bottom of vise bed square within 0.010mm/100mm	0.010/100mm	-

MODEL	A	B	C	D	E	F	G	H	I	J	K	POWER
MPV-100 2S	530	500	30	165	150	500	300	250	250	45	120	4000kgf
MPV-100 3S	530	500	30	165	150	500	150	200	200	45	120	4000kgf
MPV-100 4S	530	650	35	165	150	500	150	200	200	45	125	4000kgf
MPV-130 2S	580	600	35	175	200	550	360	250	250	50	125	4500kgf
MPV-130 3S	580	600	35	175	200	550	180	230	230	50	125	4500kgf
MPV-130 4S	580	750	40	175	200	550	180	230	230	50	130	4500kgf
MPV-160 2S	680	720	45	205	280	650	440	250	250	60	145	5000kgf
MPV-160 3S	680	720	45	205	280	650	220	260	260	60	145	5000kgf
MPV-160 4S	680	900	45	205	280	650	220	260	260	60	145	5000kgf
MPV-200 2S	730	750	50	225	300	700	450	250	250	70	155	5500kgf
MPV-200 3S	730	900	50	225	300	700	300	300	300	70	155	5500kgf
MPV-200 4S	730	1200	50	225	300	700	300	300	300	70	155	5500kgf





Powerful



Prevent lifting

Double opening than conventional vice. There are three travel clamping range which can be adjusted according to the size, and clamp the longer workpiece easily

The jaw more deeper than of same grade vice. Can clamping higher workpiece correctly.

Non-trouble hydraulic pump of new development patented which gives greater clamping force easily.

**JAW HEIGHT  
0-Limit**



● Ductile cast iron spring.



The whole Swivel Base are made by Stainless Steel, with harden treatment, durable and high accurate.

**Standard Accessories**

1. Handle-1 set

**Optional Accessories**

- 1. Special application jaw plates
- 2. Vise positioner
- 3. Swivel Base

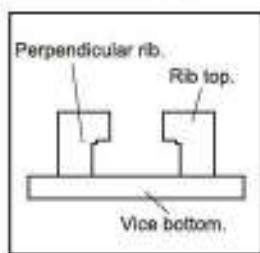
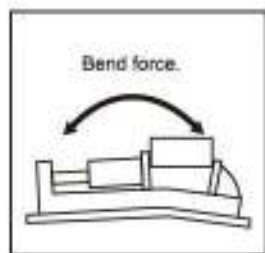

● Heat treatment (over HRC45°).



● This unit had prevent lifting structure.

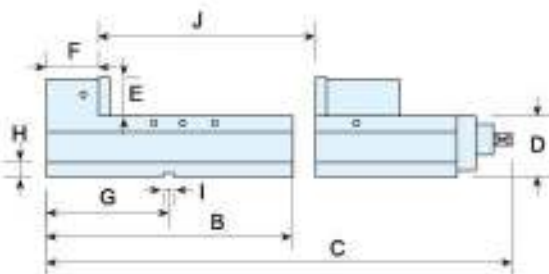

MODEL	A	B	C	D	E	F	G	H	I	J	N.W.	POWER
MPV-160LL	160	203	478	100	60	103	100	23	18	150-Limit	50kg	4400kgf
MPV-200LL	200	208	488	110	60	108	100	23	18	150-Limit	70kg	5500kgf
MB-160LL	160	203	433	100	60	103	100	23	18	150-Limit	50kg	-
MB-200LL	200	208	443	110	60	108	100	23	18	150-Limit	70kg	-





Powerful

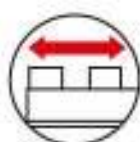

Big opening



Paralleling



Prevent lifting

## FREE WLE. CLAMPING STYLE POWE VICE



### Features:

The jaw more deeper than of same grade vice.  
Can clamping higher workpiece correctly.

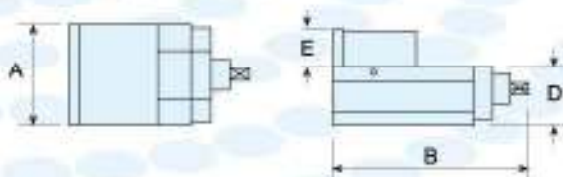

MODEL	A	B	D	E	N.W.	POWER
MPV-100LA	100	255	85	45	18kg	4000kgf
MPV-130LA	130	265	95	50	20kg	4500kgf
MPV-160LA	160	275	100	60	25kg	5000kgf
MPV-200LA	200	280	110	60	45kg	5500kgf
MB-100LA	100	215	85	45	18kg	-
MB-130LA	130	220	95	50	20kg	-
MB-160LA	160	230	100	60	25kg	-
MB-200LA	200	255	110	60	45kg	-

## FIXTURE FOR VISE ELEVABOO HYDRXULIC QUICK-CBANGE BIGB PNCISION VISE

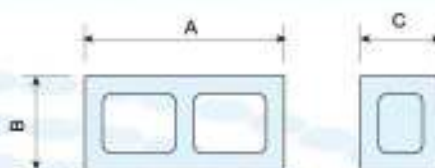

### Features:

Spheroid graphite cast iron FCD-60kgs/mm.  
Fine grinding both two side 0010mm/500mm  
anneal processing.

MODEL	A	B	C
HTC-300x400x200	400	300	200
HTC-300x450x250	450	300	250
HTC-300x550x300	550	300	300
HTC-350x650x350	650	350	350







Powerful



Prevent lifting

Double opening than conventional vice. There are three travel clamping range which can be adjusted according to the size, and clamp the longer workpiece easily

The jaw more deeper than of same grade vice. Can clamping higher workpiece correctly.

Non-trouble hydraulic pump of new development patented which gives greater clamping force easily.

**JAW HEIGHT  
63mm**

**JAW WIDTH  
170mm**

The whole Swivel Base are made by Stainless Steel, with harden treatment, durable and high accurate.

**Standard Accessories**

1.Handle-1 set

**Optional Accessories**

- 1.Special application jaw plates
- 2.Vise positioner
- 3.Swivel Base



● Ductile cast iron spring.

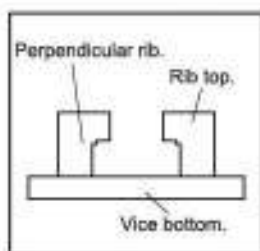
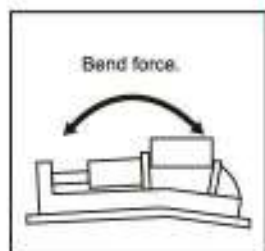

● Heat treatment (over HRC45°).



● This unit had prevent lifting structure,

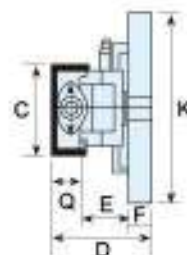
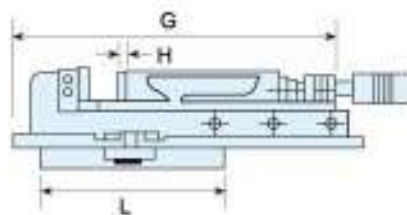
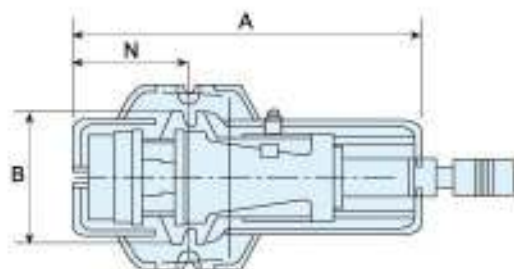

MODEL	A	B	C	D	E	F	G	H	I	J	K	L	STROKE OPENING			Q	Body weight	Base weight	POWER
													N	O	P				
HBC-170	620	240	170	183	80	39	500-1050	18	220	300	340	320	0-100	98-200	195-300	64	58kg	15kg	4000kg





Hydraulic

ISO-9001:2008

Vice jaw had manufactured by alloy steel which treated harden process and precision ground.

Vice body had manufactured by high ductile cast iron, which has resistance of bending and tilting when clamping, the slide face treated harden process and precision ground.

Patented new device hydraulic cylinder, provided steady clamping force to resist vibration and tremble, Convenience for maintain also handling.

The whole Swivel Base are made by Stainless Steel, with harden treatment, durable and high accurate.

**Standard Accessories**

1. Handle-1 set

**Optional Accessories**

1. Special application jaw plates

2. Vice positioner

3. Swivel Base



Patented new device hydraulic cylinder

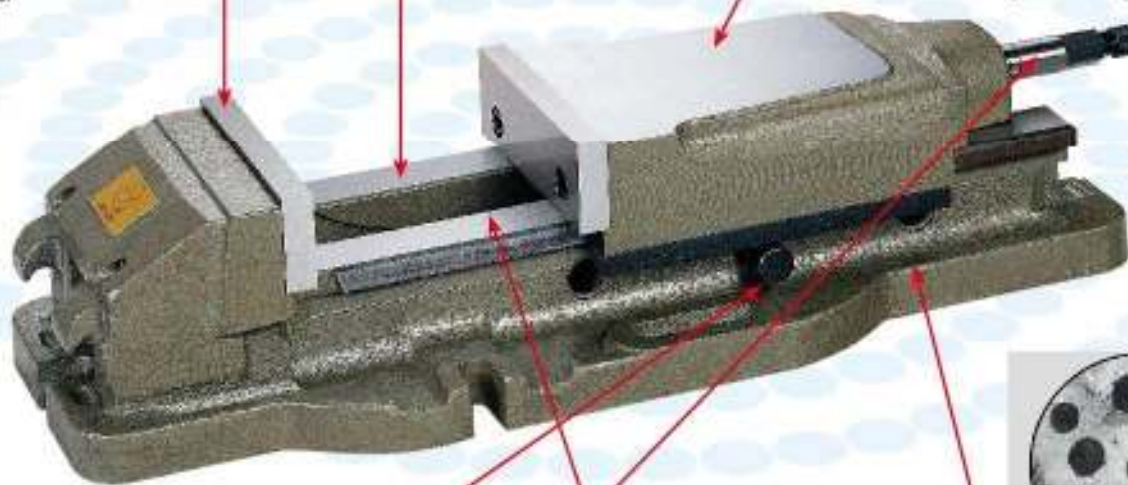

There are three travel clamping ranges, which can be adjusted according to the size of the workpiece. When adjust to third hole that clamping length bigger than conventional vice.

Hydraulic clamping force can be free adjusted from the graduation of hydraulic bar, and will be magnify clamping force by propeller to produce unrivaled clamping force.



Heat treatment (over HRC45°).



Material: ductile iron FCD-60.

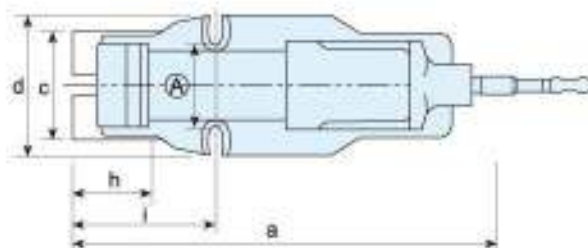
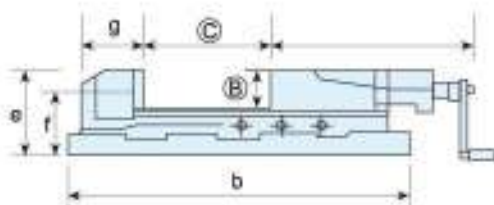

MODEL	(A)	(B)	(C)	a	b	c	d	e	f	g	h	i	POWER	Body weight	Base weight
HS-100	100	36	170	525	430	130	160	94	60	78	100	155	2500kg	16kg	6kg
HS-125	125	46	220	670	540	165	185	118	72	97	117	185	3500kg	32kg	10kg
HS-150	150	51	300	800	620	200	240	133	82	116	125	247	4400kg	54kg	16kg
HS-200	200	62	300	900	700	240	280	162	100	160	165	266	5500kg	95kg	30kg





Hydraulic

ISO-9001:2008

The vice different from conventional vice, than can be adjusted angle of workpiece directly, perpendicular direction adjustable angle from 0 X to 50 X, which can read process angle accurately.

The whole Swivel Base are made by Stainless Steel, with harden treatment, durable and high accurate.

**Standard Accessories**

1.Handle-1 set

**Optional Accessories**

1.Special application jaw plates

2.Vise positioner

3.Swivel Base



Patented new device hydraulic cylinder

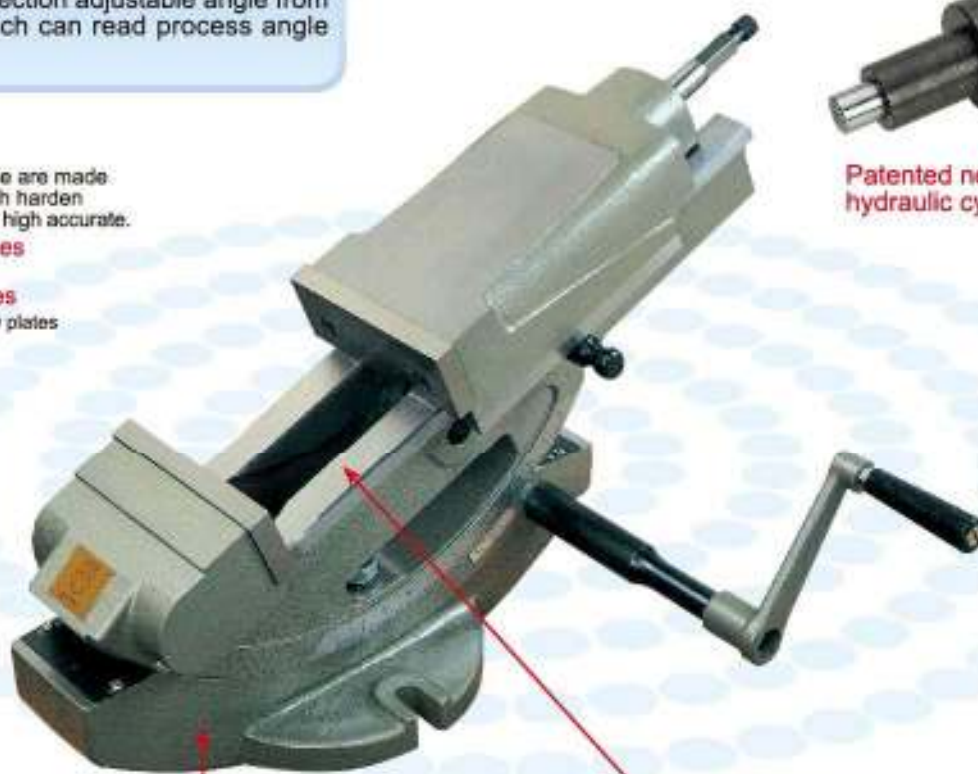

● Material: ductile iron FCD-60.

● Heat treatment (over HRC45°).

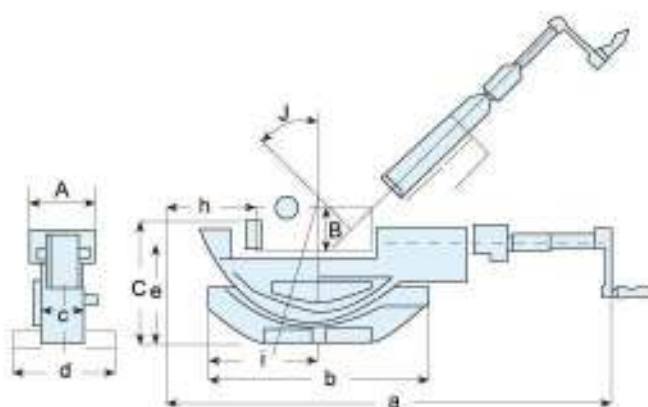

MODEL	A	B	C	a	b	c	d	e	h	i	J	Body weight	Base weight	POWER
HN-100	100	36	170	525	330	65	162	177	90	172	50	24kg	6kg	2540kgf
HN-150	154	53	300	801	415	95	242	237	121	241	50	68kg	14kg	4400kgf



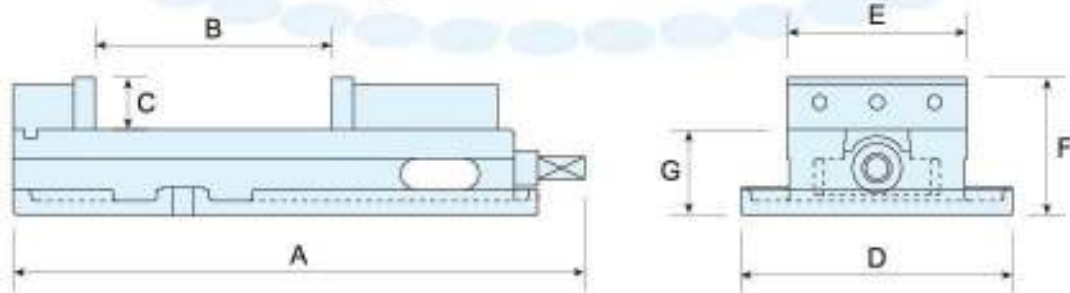

### Four clamping way for choice

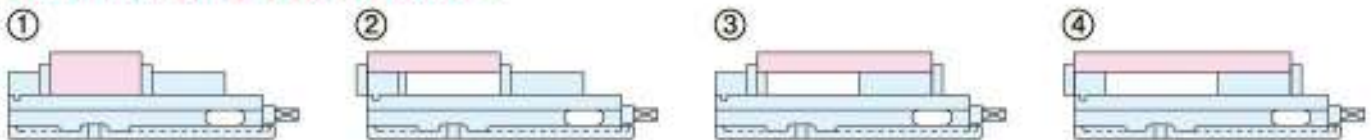

### FEATURES:

- Extra capacity 9" jaw opening.
- Lock down clamping design. Down clamping jaw design provides approx. 1/2 Lb. downward clamping force for every 1 Lb. horizontal clamping pressure.
- Oversized rigid and hardened main lead screw design allows , for higher torque loads and clamping force. Combination of angular thrust bearings and precision roller bearings for true alignment with high torque loads.
- Jaw plate accepts a variety of popular shaped replacement Jaws.
- High accuracy of parallelism (From top of bed jaw ways to bottom of bed base): \*0.0004" per 4".
- Parallelism and perpendicularity of vise jaws: \*0.002"
- Base of vise precision cast from fine grained stress relieved FC30 cast iron with induction hardening (Rc50+) then precision ground jaw ways for long term trouble free accuracy. Jaws manufactured from high frequency steel alloys then induction hardened for added strength, hardness and durability.
- Coolant trough cast into base. Lugs cast into base for claming to machine tool table and/or 360 degree swivel base (Optional Ccessory).

MODEL	A	B	C	D	E	F	G	WG
V6	536	185	48	232	150	121	73	35kg
V688	510	223	44	232	151	117	73	39kg
V690	520	228	44	232	151	117	73	39kg
V810	615	254	55	292	202	139	84	66kg



## TOOL MAKER VISE



### Features:

1. The body is made of steel with high rigidity.
2. Special big clamp opening structure designs, not only for rapid positioning of workpiece clamps & the largest opening which also develops the max. clamping force.

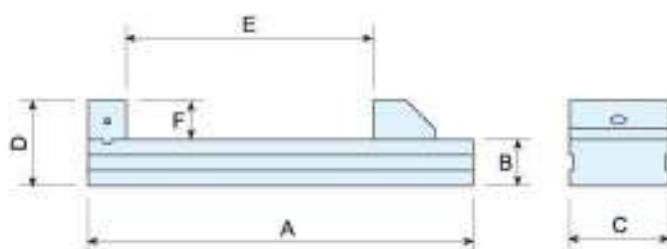

MODEL	A	B	C	D	E	F
VS-130	500	60	130	110	350	50

## PRECISION FIXED ANGLE VICE

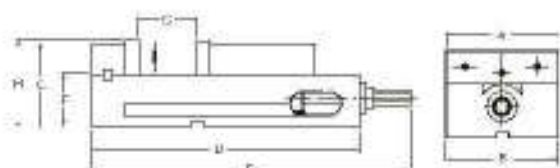
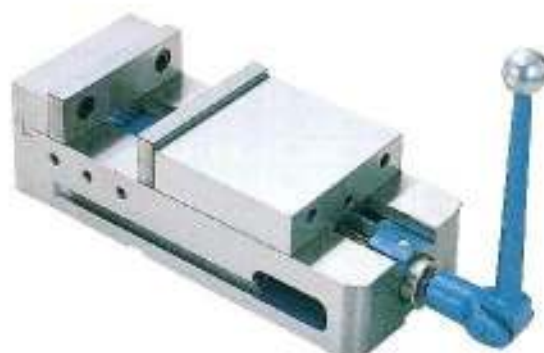

MODEL	A	B	C	D	E	F	G	H	I
HT/150	154	157	145	365	430	73	111	117	44

## FIXED ANGLE VICE

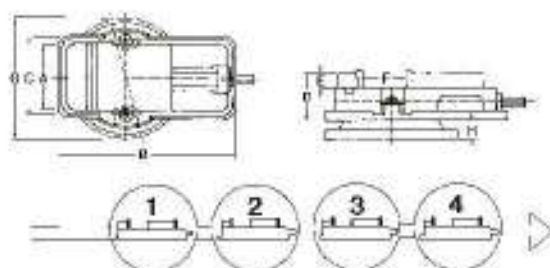

MODEL	A	B	C	D	E	F	G	H
BT/100	102	325	180	90	30	110	235	32
BT/150	150	420	240	117	44	150	300	42
BT/200	204	545	300	152	65	200	375	45





**HT**



**HC**

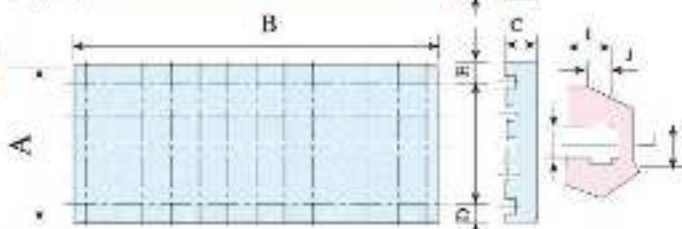

**HH**

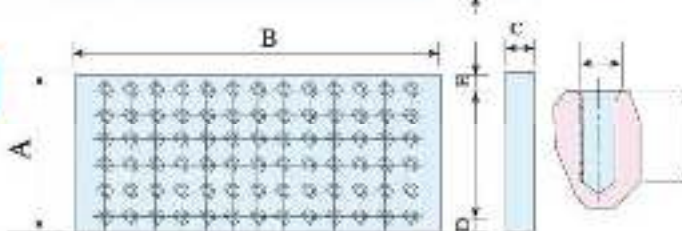

**Features:**

Spheroid graphite cast iron FCD-60kgs/mm.  
Fine grinding both two side 0010mm/500mm  
anneal processing.

**Accept special size ord**

MODEL	A	B	C
HT300X600X70	300	600	70
HT350X800X75	350	800	75
HT400X950X75	400	950	75
HT410X900X75	410	900	75
HT450X900X75	450	900	75
HT500X1000X80	500	1000	80
HT510X850X75	510	850	75
HT510X1000X75	510	1000	75
HT510X1200X75	510	1200	75
HT510X1300X75	510	1300	75
HT550X1200X80	550	1200	80
HT600X1200X80	600	1200	80
HT600X1500X80	600	1500	80
HT650X1600X80	650	1600	80
HT650X1700X80	650	1700	80
HT700X1700X80	700	1700	80
HT800X2300X85	800	2300	85
HT850X2100X85	850	2100	85
HT850X2300X85	850	2300	85
HT900X2400X85	900	2400	85
HC300X600X70	300	600	70
HC350X800X75	350	800	75
HC400X950X75	400	950	75
HC410X900X75	410	900	75
HC450X900X75	450	900	75
HC500X1000X80	500	1000	80
HC510X850X75	510	850	75
HC510X1000X75	510	1000	75
HC510X1200X75	510	1200	75
HC510X1300X75	510	1300	75
HC550X1200X80	550	1200	80
HC600X1200X80	600	1200	80
HC600X1500X80	600	1500	80

MODEL	A	B	C
HC650X1600X80	650	1600	80
HC650X1700X80	650	1700	80
HC700X1700X80	700	1700	80
HC800X2300X85	800	2300	85
HC850X2100X85	850	2100	85
HC850X2300X85	850	2300	85
HC900X2400X85	900	2400	85
HH300X600X70	300	600	70
HH350X800X75	350	800	75
HH400X950X75	400	950	75
HH410X900X75	410	900	75
HH450X900X75	450	900	75
HH500X1000X80	500	1000	80
HH510X850X75	510	850	75
HH510X1000X75	510	1000	75
HH510X1200X75	510	1200	75
HH510X1300X75	510	1300	75
HH550X1200X80	550	1200	80
HH600X1200X80	600	1200	80
HH600X1500X80	600	1500	80
HH650X1600X80	650	1600	80
HH650X1700X80	650	1700	80
HH700X1700X80	700	1700	80
HH800X2300X85	800	2300	85
HH850X2100X85	850	2100	85
HH850X2300X85	850	2300	85
HH700X2400X85	700	2400	85
HH340X510X30	340	510	30
HH340X660X30	340	660	30
HH405X600X35	405	600	35
HH405X780X35	405	780	35
HH495X720X40	495	720	40
HH495X940X40	495	940	40





**Features:**

Spheroid graphite cast iron FCD-60kg/mm.  
 Fine grinding both two side 0010mm/500mm anneal processing.

**HP**

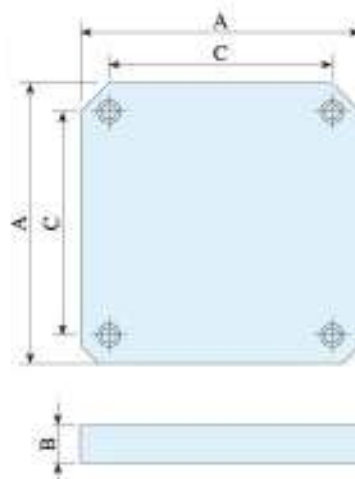

**HL**

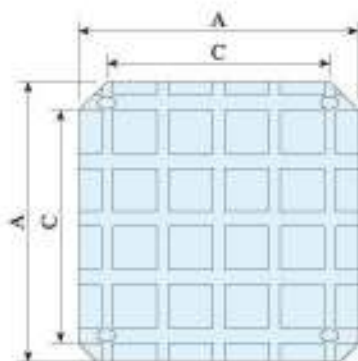

**HM**

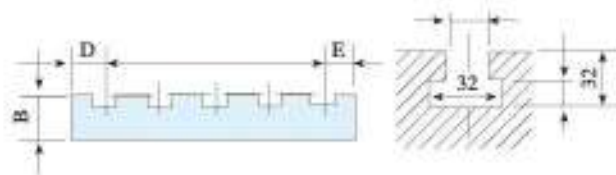
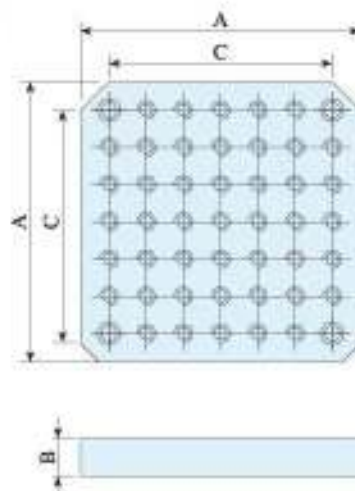

**Accept special size ord**

MODEL	A	B	C	D	E	F	G	MODEL	A	B	C	D	E	F	G
HP300X300X40	300	40	240					HM300X300X40	300	40	240				
HP400X400X40	400	40	320					HM400X400X40	400	40	320				
HP500X500X40	500	40	400					HM500X500X40	500	40	400				
HP600X600X45	600	45	500					HM600X600X45	600	45	500				
HP630X630X70	630	70	500					HM630X630X70	630	70	500				
HL400X400X70	400	70	320	40	40	80	18	HM400X400X70	400	70	320				
HL500X500X70	500	70	400	50	50	100	18	HM500X500X70	500	70	400				
HL630X630X70	630	70	500	65	65	65	18	HM630X630X70	630	70	500				
HL800X800X70	800	70	600	80	80	100	18	HM800X800X70	800	70	600				





**Features:**

1. MATERIAL:FC300
2. Heat-treatment-annealing.
3. Suitable for horizontal machine center.

**BJB**

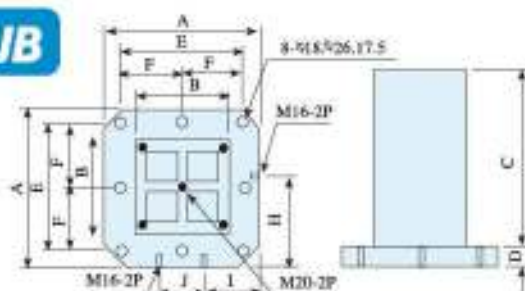

**HIB**

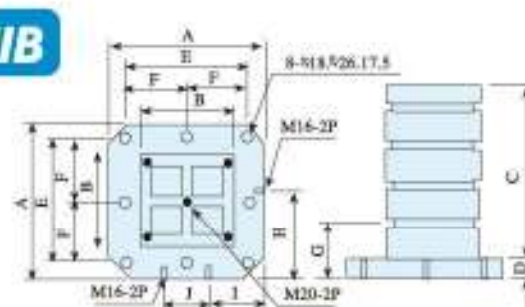

**HJC**

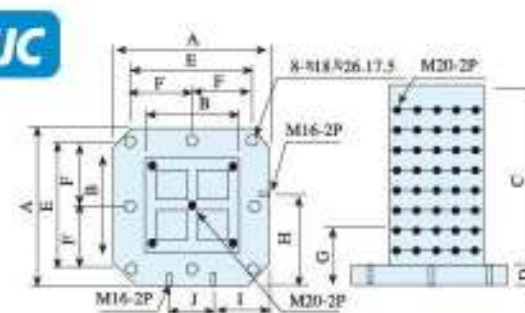

**Accept special size ord**

MODEL	A	B	C	D	E	F	G	H	I	J	K		
BJB500x300B	500	300	550	50	400	200		275	175	150			
BJB500x350B	500	350	500	50	400	200		275	175	150			
BJB630x350B	630	350	650	50	500	250		340	215	200			
BJB630x400B	630	400	650	50	500	250		340	215	200			
BJB630x500B	630	500	650	50	500	250		340	215	200			
BJB800x550B	800	550	800	50	640	320		425	265	270			
HIB500x300T	500	300	550	50	400	200	150	275	175	150	18	100X5	
HIB500x350T	500	350	500	50	400	200	150	275	175	150	18	100X5	
HIB630x350T	630	350	650	50	500	250	150	340	215	200	18	125X4	
HIB630x400T	630	400	650	50	500	250	150	340	215	200	18	125X5	
HIB630x500T	630	500	650	50	500	250	150	340	215	200	18	125X5	
HIB800x550T	800	550	800	50	640	320	150	425	265	270	18	150X5	
HJC500x300H	500	300	550	50	400	200	150	275	175	150	M16	100X5	
HJC500x350H	500	350	500	50	400	200	150	275	175	150	M16	100X5	
HJC630x350H	630	350	650	50	500	250	150	340	215	200	M16	100X4	
HJC630x400H	630	400	650	50	500	250	150	340	215	200	M16	100X6	
HJC630x500H	630	500	650	50	500	250	150	340	215	200	M16	100X6	
HJC800x550H	800	550	800	50	640	320	150	425	265	270	M16	100X7	





**Features:**

1. MATERIAL:FC300
2. Heat-treatment-annealing.
3. Suitable for horizontal machine center.

**BCB**

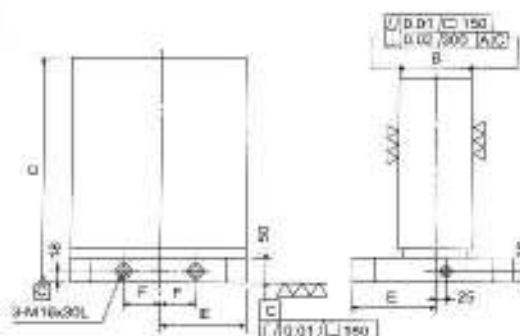

**HCB**

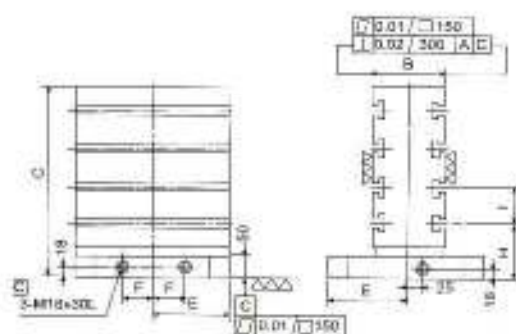

**CBC**

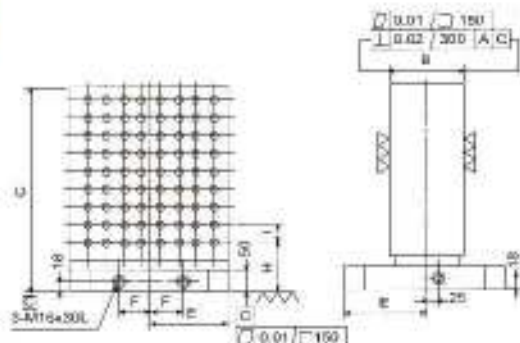

**Accept special size ord**

MODEL	A	B	C	D	E	F	G	H	I	J
BCB-400x150x500P	400	150	500	320	200	55	50			
BCB-500x200x600P	500	200	600	400	250	75	60			
BCB-630x250x700P	630	250	700	500	315	100	65			
BCB-800x300x800P	800	300	800	640	400	135	80			
HCB-400x150x500S	400	150	500	320	200	55	50	100	100x4	18
HCB-500x200x600S	500	200	600	400	250	75	60	100	100x5	18
HCB-630x250x700S	630	250	700	500	315	100	65	150	125x5	18
HCB-800x300x800S	800	300	800	640	400	135	80	150	150x5	18
CBC-400x150x500V	400	150	500	320	200	55	50	125	50	M16-7x8x2
CBC-500x200x600V	500	200	600	400	250	75	60	125	50	M16-9x10-2
CBC-630x250x700V	630	250	700	500	315	100	65	125	50	M16-11x12x2
CBC-800x300x800V	800	300	800	640	400	135	80	125	50	M16-15x14x2





**Features:**

1. MATERIAL:FC300
2. Heat-treatment-annealing.
3. Suitable for horizontal machine center.

**BIB**

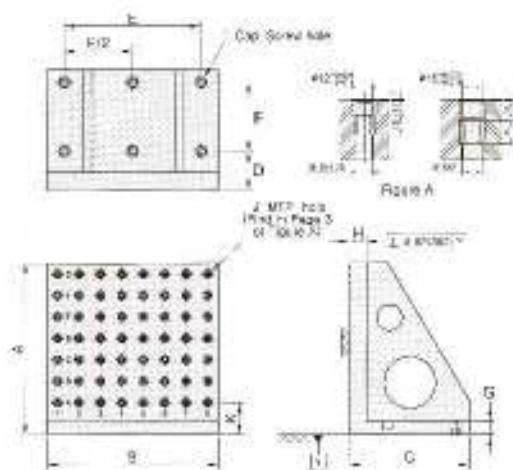

**BFB**

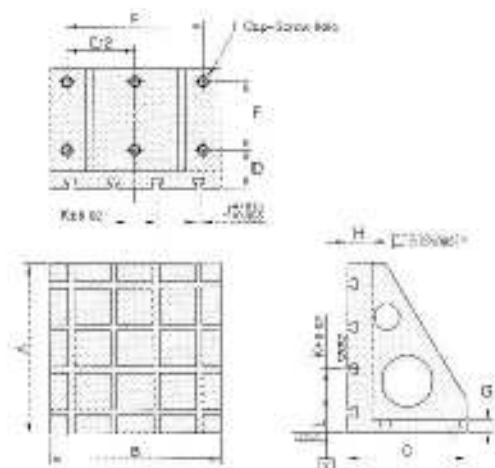

**Accept special size ord**

MODEL	A	B	C	D	E	F	G	H	I	J	K	L	W.G.
BIB300x300-12	300	300	220	90	250	100	30	40	Ø18	Ø12	M12	75	50
BIB400x400-12	400	400	280	90	320	160	30	40	Ø18	Ø12	M12	75	87
BIB500x500-12	500	500	345	90	400	200	35	50	Ø18	Ø12	M12	75	176
BIB630x630-12	630	630	435	100	500	250	40	50	Ø18	Ø12	M12	40	300
BIB800x800-12	800	800	525	115	640	320	45	50	Ø18	Ø12	M12	75	477
BIB300x300-16	300	300	220	90	250	100	30	40	Ø18	Ø16	M16	75	46
BIB400x400-16	400	400	280	90	320	160	30	40	Ø18	Ø16	M16	75	85
BIB500x500-16	500	500	345	90	400	200	35	50	Ø18	Ø16	M16	75	170
BIB630x630-16	630	630	435	100	500	250	40	50	Ø18	Ø16	M16	40	295
BIB800x800-16	800	800	525	115	640	320	45	50	Ø18	Ø16	M16	75	470
BFB300x300-14	300	300	220	90	250	100	30	60	Ø18	14	100	50	52
BFB400x400-14	400	400	300	90	320	160	30	60	Ø18	14	100	50	101
BFB500x500-14	500	500	350	90	400	200	35	60	Ø18	14	100	50	184
BFB630x630-14	630	630	450	100	500	250	40	65	Ø18	14	125	65	316
BFB800x800-14	800	800	550	115	640	320	45	75	Ø18	14	150	100	566
BFB300x300-18	300	300	220	90	250	100	30	60	Ø18	18	100	50	51
BFB400x400-18	400	400	300	90	320	160	30	60	Ø18	18	100	50	101
BFB500x500-18	500	500	350	90	400	200	35	60	Ø18	18	100	50	175
BFB630x630-18	630	630	450	100	500	250	40	65	Ø18	18	125	65	285
BFB800x800-18	800	800	550	115	640	320	45	75	Ø18	18	150	100	543





# SPECIAL APPLICATION JAW PLATES

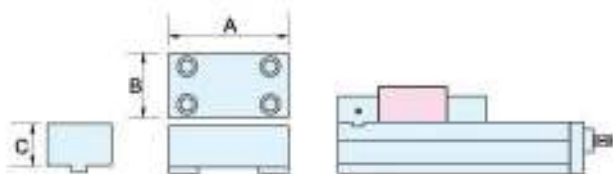

MODEL	A	B	C
VJ1-100	100	70	40
VJ1-130	128	75	50
VJ1-160	158	85	55
VJ1-200	198	100	60
VJ1-100-20	100	70	20
VJ1-130-20	128	75	20
VJ1-160-30	158	85	30
VJ1-200-30	198	100	30

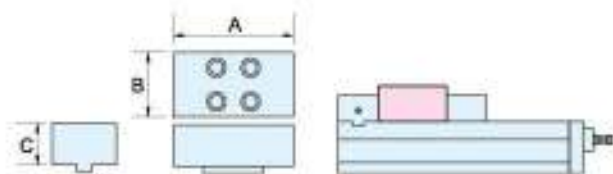

MODEL	A	B	C
VJ1-100A	100	70	40
VJ1-130A	128	75	50
VJ1-160A	158	85	55
VJ1-200A	198	100	60
VJ1-100A-20	100	70	20
VJ1-130A-20	128	75	20
VJ1-160A-30	158	85	30
VJ1-200A-30	198	100	30



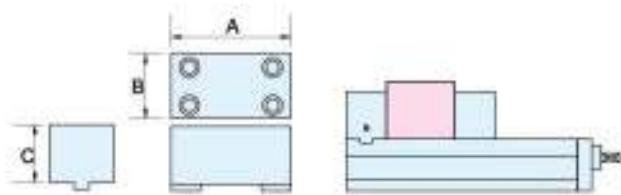

MODEL	A	B	C
VJ2-100	100	70	70
VJ2-130	128	75	75
VJ2-160	158	85	85
VJ2-200	198	100	100

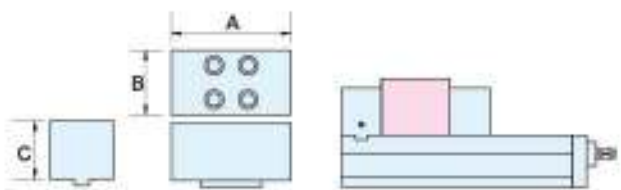

MODEL	A	B	C
VJ2-100A	100	70	70
VJ2-130A	128	75	75
VJ2-160A	158	85	85
VJ2-200A	198	100	100

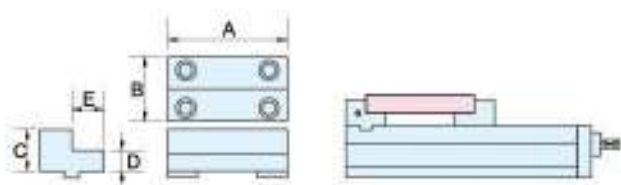

MODEL	A	B	C	D	E
VJ3-100	100	70	40	20	35
VJ3-130	128	80	50	25	37
VJ3-160	158	85	55	27	42
VJ3-200	198	100	60	30	50

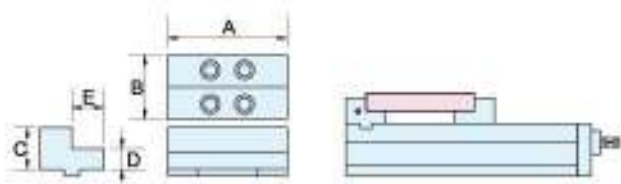

MODEL	A	B	C	D	E
VJ3-100A	100	70	40	20	35
VJ3-130A	128	80	50	25	37
VJ3-160A	158	85	55	27	42
VJ3-200A	198	100	60	30	50

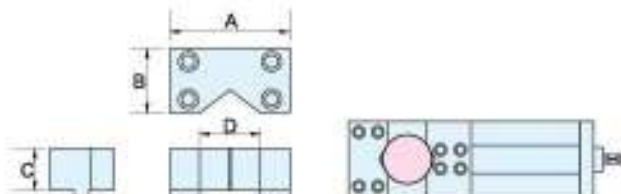

MODEL	A	B	C	D
VJ4-100	100	70	40	50
VJ4-130	128	75	50	60
VJ4-160	158	85	55	70
VJ4-200	198	100	60	80

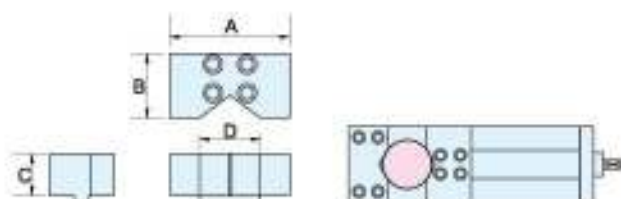

MODEL	A	B	C	D
VJ4-100A	100	70	40	50
VJ4-130A	128	75	50	60
VJ4-160A	158	85	55	70
VJ4-200A	198	100	60	80



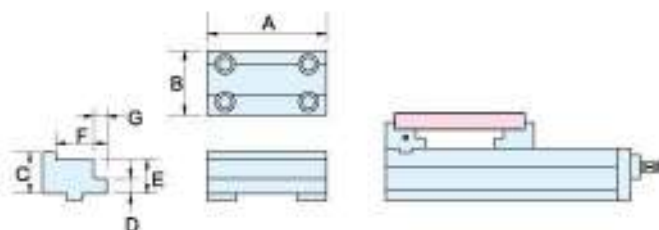

MODEL	A	B	C	D	E	F	G
VJ5-100	100	70	40	20	30	55	10
VJ5-130	128	75	50	20	40	60	10
VJ5-160	158	85	55	20	45	70	10
VJ5-200	198	100	60	20	50	85	10

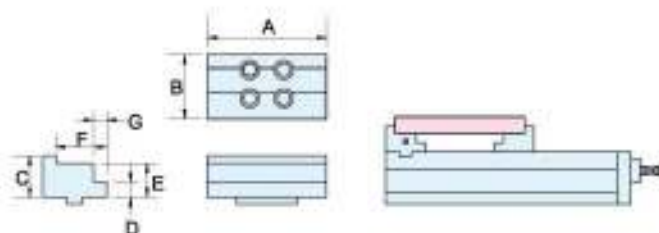

MODEL	A	B	C	D	E	F	G
VJ5-100A	100	70	40	20	30	55	10
VJ5-130A	128	75	50	20	40	60	10
VJ5-160A	158	85	55	20	45	70	10
VJ5-200A	198	100	60	20	50	85	10

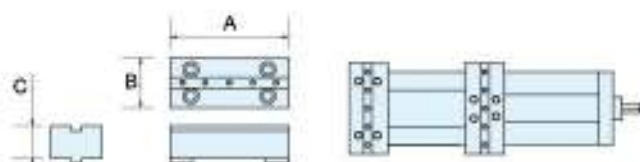

MODEL	A	B	C
VJ6-100	140	70	20
VJ6-130	170	75	20
VJ6-160	200	85	25
VJ6-200	240	100	25

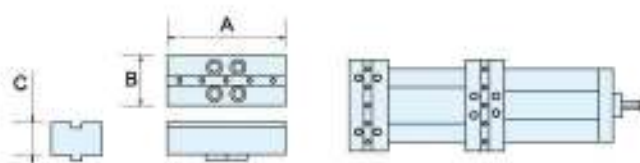

MODEL	A	B	C
VJ6-100A	140	70	20
VJ6-130A	170	75	20
VJ6-160A	200	85	25
VJ6-200A	240	100	25



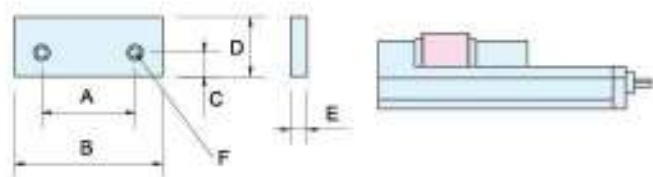

MODEL	A	B	C	D	E	F
J1-100	70	98	25	48	15	M8
J1-130	100	128	25	53	15	M8
J1-160	100	158	25	63	18	M10
J1-200	120	198	28	63	18	M12
J1-100-VSP	70	98	25	45	15	M8
J1-130-VSP	100	128	25	50	15	M8
J1-160-VSP	100	158	25	55	18	M10
J1-200-VSP	120	198	28	60	18	M12
J1-100-45	70	98	25	45	15	M8
J1-130-50	100	128	25	50	15	M8
J1-160-60	100	158	25	60	18	M10
J1-200-60	120	198	28	60	18	M12
J1-130-200	100	200	25	58	18	M8
J1-160-250	100	250	25	63	18	M10
J1-200-300	120	300	25	63	18	M12
J1-130-50A	100	128	25	53	50	M8
J1-160-55A	100	158	25	63	55	M10
J1-200-55A	120	198	28	63	55	M12

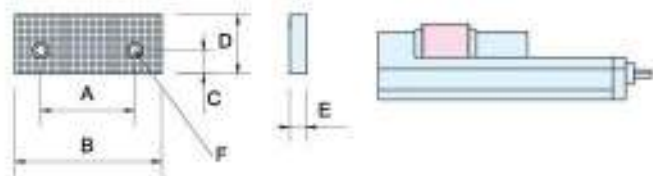

MODEL	A	B	C	D	E	F
J2-100	70	98	25	48	15	M8
J2-130	100	128	25	53	15	M8
J2-160	100	158	25	63	18	M10
J2-200	120	198	28	63	18	M12

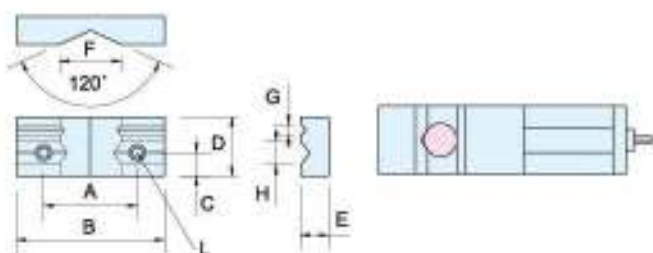

MODEL	A	B	C	D	E	F	G	H	L
J3-100	70	98	25	48	30	25		25	M8
J3-130	100	128	25	53	30	25	12	25	M8
J3-160	100	158	25	63	30	25	12	27	M10
J3-200	120	198	28	63	34	30	12	30	M12



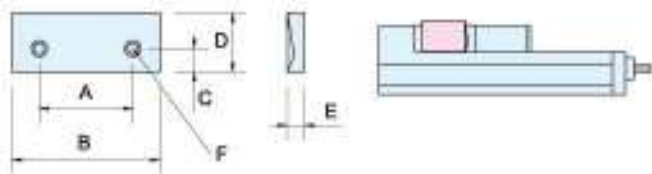

MODEL	A	B	C	D	E	F
J4-100	70	98	25	48	30	M8
J4-130	100	128	25	53	32	M8
J4-160	100	158	25	63	32	M10
J4-200	120	198	28	63	40	M12

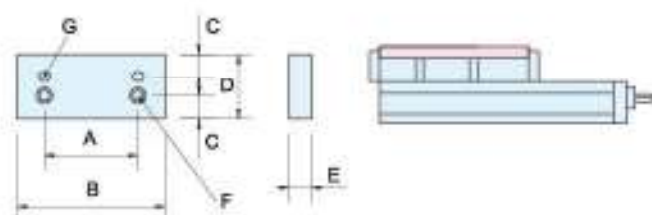

MODEL	A	B	C	D	E	F	G
J5-100	70	98	25	58	24	M8	M12
J5-130	100	128	25	63	24	M8	M12
J5-160	100	158	25	73	24	M10	M14
J5-200	120	198	28	77	24	M12	M16
J5-130-90	100	128	25	90	24	M8	M12
J5-130-100	100	128	25	100	24	M8	M12
J5-160-100	100	158	25	100	24	M10	M14
J5-160-110	100	158	25	110	24	M10	M14
J5-160-120	100	128	25	120	24	M10	M14
J5-200-100	120	198	28	100	24	M12	M16
J5-200-110	120	198	28	110	24	M12	M16
J5-200-120	120	198	28	120	24	M12	M16

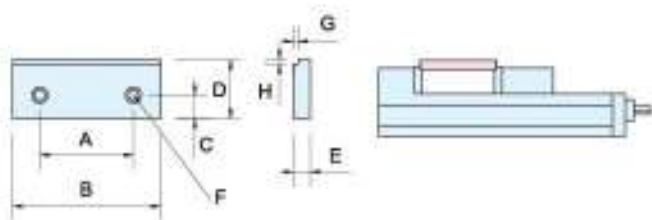

MODEL	A	B	C	D	E	F	G	H
J6-100	70	98	25	48	15	M8	5	5
J6-130	100	128	25	53	15	M8	5	5
J6-160	100	158	25	63	18	M10	5	5
J6-200	120	198	28	63	18	M12	5	5
J6-100-VSP	70	98	25	48	15	M8	5	5
J6-130-VSP	100	128	25	53	15	M8	5	5
J6-160-VSP	100	158	25	58	18	M10	5	5
J6-200-VSP	120	198	28	63	18	M12	5	5
J6-160-2x2	100	128	25	60	18	M10	2	2
J6-200-2x2	120	198	28	60	18	M12	2	2
J6-160-3x3	100	158	25	60	18	M10	3	3
J6-200-3x3	120	198	28	60	18	M12	3	3
J6-130-10x5	100	128	25	58	18	M8	5	10
J6-160-10x5	100	158	25	63	18	M10	5	10
J6-200-10x5	120	198	28	63	18	M12	5	10
J6-130-15x5	100	128	25	53	18	M8	5	15
J6-160-15x5	100	158	25	63	18	M10	5	15
J6-200-15x5	120	198	28	63	18	M12	5	15
J6-130-25x5	100	128	25	53	18	M8	5	25
J6-160-25x5	100	158	25	63	18	M10	5	25
J6-200-25x5	120	198	28	63	18	M12	5	25

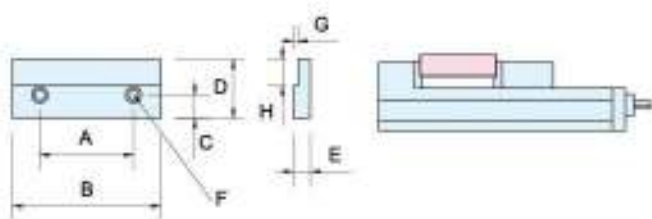



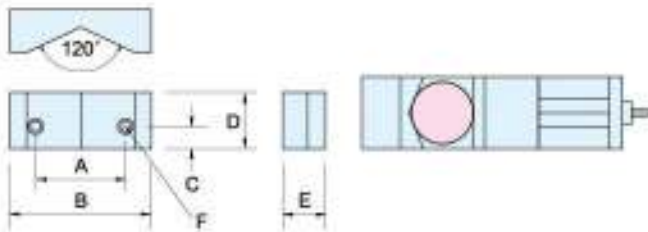

MODEL	A	B	C	D	E	F
J3-100-V	70	98	25	48	40	M8
J3-130-V	100	128	25	53	40	M8
J3-160-V	100	158	25	63	50	M10
J3-200-V	120	198	28	67	50	M12

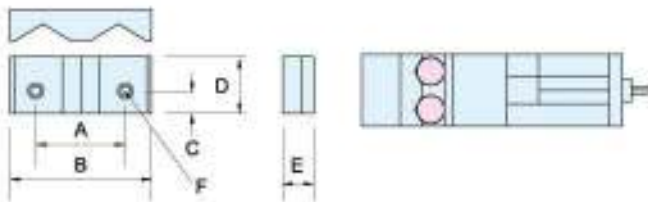

MODEL	A	B	C	D	E	F
J3-100-W	70	98	25	48	40	M8
J3-130-W	100	128	25	53	40	M8
J3-160-W	100	158	25	63	50	M10
J3-200-W	120	198	28	67	50	M12

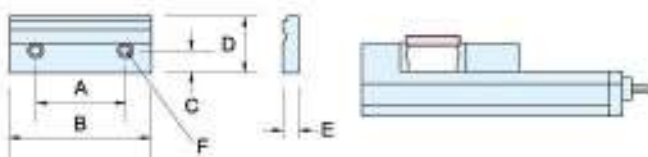

MODEL	A	B	C	D	E	F
J6-100-LV	70	98	25	48	15	M8
J6-130-LV	100	128	25	53	15	M8
J6-160-LV	100	158	25	63	18	M10
J6-200-LV	120	198	28	67	18	M12



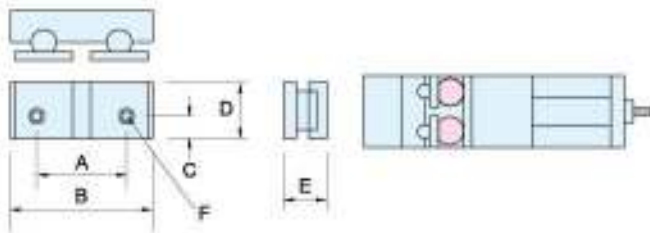

MODEL	A	B	C	D	E	F
J7-100	70	98	25	48	60	M8
J7-130	100	128	25	53	60	M8
J7-160	100	158	25	63	70	M10
J7-200	120	198	28	67	70	M12

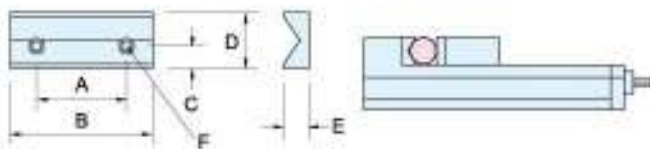

MODEL	A	B	C	D	E	F
J8-100	70	98	25	48	40	M8
J8-130	100	128	25	53	40	M8
J8-160	100	158	25	63	50	M10
J8-200	120	198	28	67	50	M12

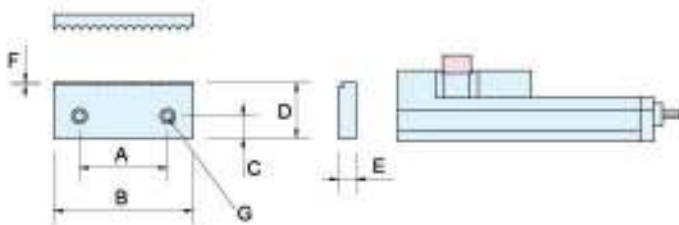

MODEL	A	B	C	D	E	F	G
J9-100	70	98	25	45	15	5	M8
J9-130	100	128	25	50	15	5	M8
J9-160	100	158	25	60	18	5	M10
J9-200	120	198	28	60	18	5	M12

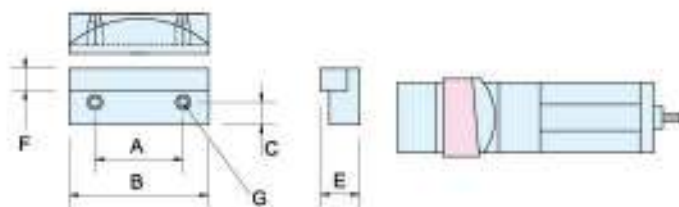

MODEL	A	B	C	D	E	F	G
J10-100	70	110	25	48	38	12	M8
J10-130	100	140	25	53	40	16	M8
J10-160	100	170	25	63	45	22	M10
J10-200	120	210	28	63	50	25	M12



Distributed in Australia by

**LIVETOOLS®**

**Machine Tool People.**  
[www.livetools.com.au](http://www.livetools.com.au)

E: [sales@livetools.com.au](mailto:sales@livetools.com.au)

P: 02 4017 0198

F: 02 4910 9018

115 Young Street

Carrington NSW 2294