



38" In Ground Post

Congratulations on the purchase of your Mail Boss® steel post. This post is constructed of tough 14 gauge galvanized powder coated steel and will mate perfectly with your Mail Boss® mailbox. Included with the Mail Boss® post are four 12 mm bolts for attachment to your Mail Boss® mailbox. There are a couple of scenarios where we suggest you deviate from the instructions below. If you live in a very cold climate and/or you use a spreader plate to mount multiple mailboxes, we recommend inserting a treated 4 x 4 piece of lumber inside your post. You can secure it with lag bolts or screws on two sides of the post. This will allow you to bury the post much deeper and secure it much better. In extremely cold climates we suggest you dig 3.5 feet deep or so. For even more stability you can drive lengths of rebar at an angle down and out from the hole before pouring the concrete.

This 38" post is made for walk up delivery only. The height of the incoming mail slot **WILL NOT WORK FOR DRIVE-UP DELIVERY**. If you receive drive-up delivery, you will need either a 38" in-ground post or a 27" post and a surface mount plate.

If you require assistance with assembly or part replacement, or for any other matter, contact the toll-free Epoch Design Service Center from anywhere in the Continental United States, Monday through Friday, 9 AM - 5 PM PST at **1-800-589-7990**. You may also email your request or comments to info@mailboss.com and a service representative will respond. Additional helpful hints and tips can be found on our website: www.mailboss.com.

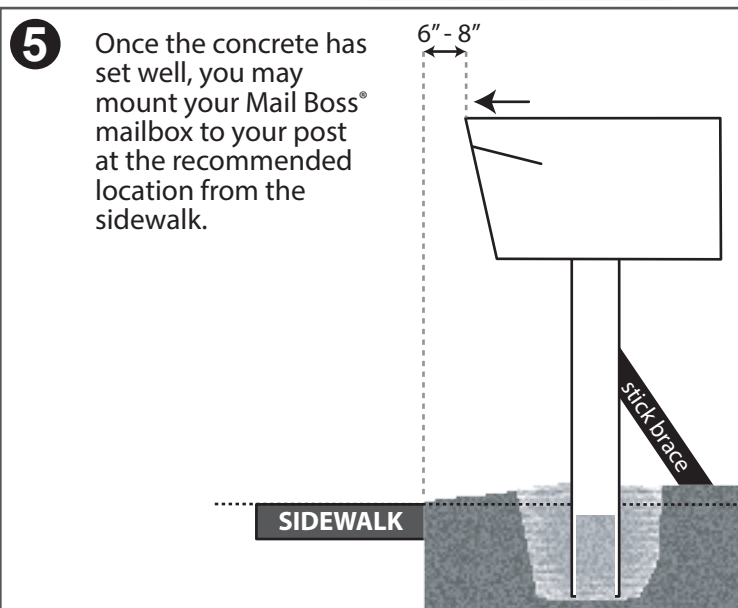
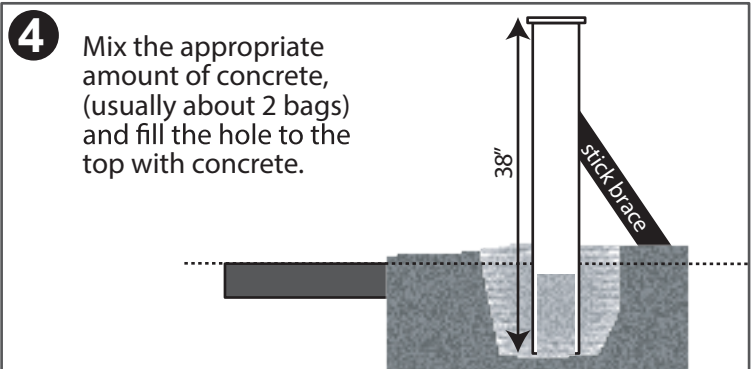
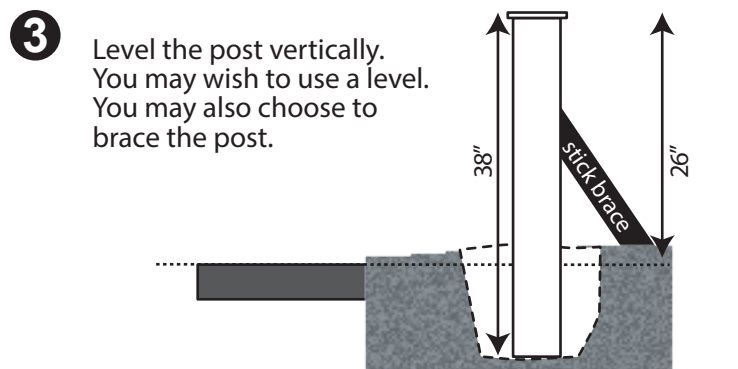
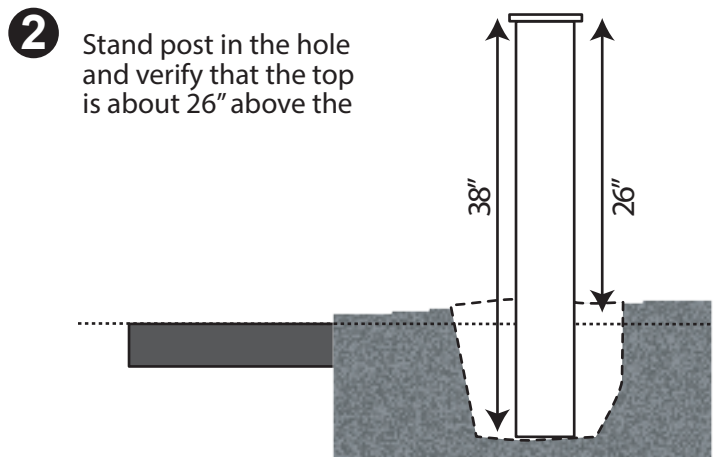
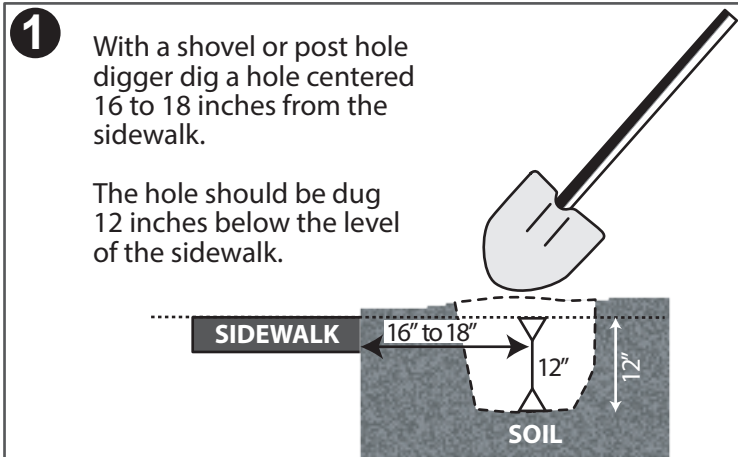

Accessory items and parts available: WWW.MAILBOSS.COM

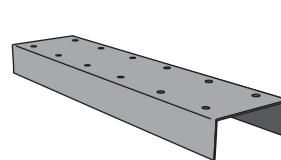

Spreader Bars
Allows Mounting Of Two,
Three Or Four Mailboxes
On One Post
Available In All Colors



Lock Dust Cover
Protects lock mechanism

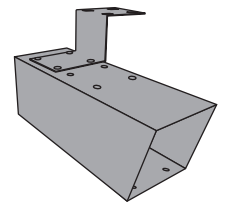

Newspaper Holder
Available In All Colors

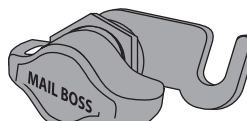

HASP Lock
Standard padlock
compatible



Flag

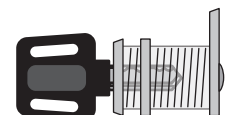

High-Security Lock
Additional Keys
and/or Lock

Have a question?... Need a part ASAP?...1-800-589-7990