

# TIGERGRIP | TG 28 - 55 SR4

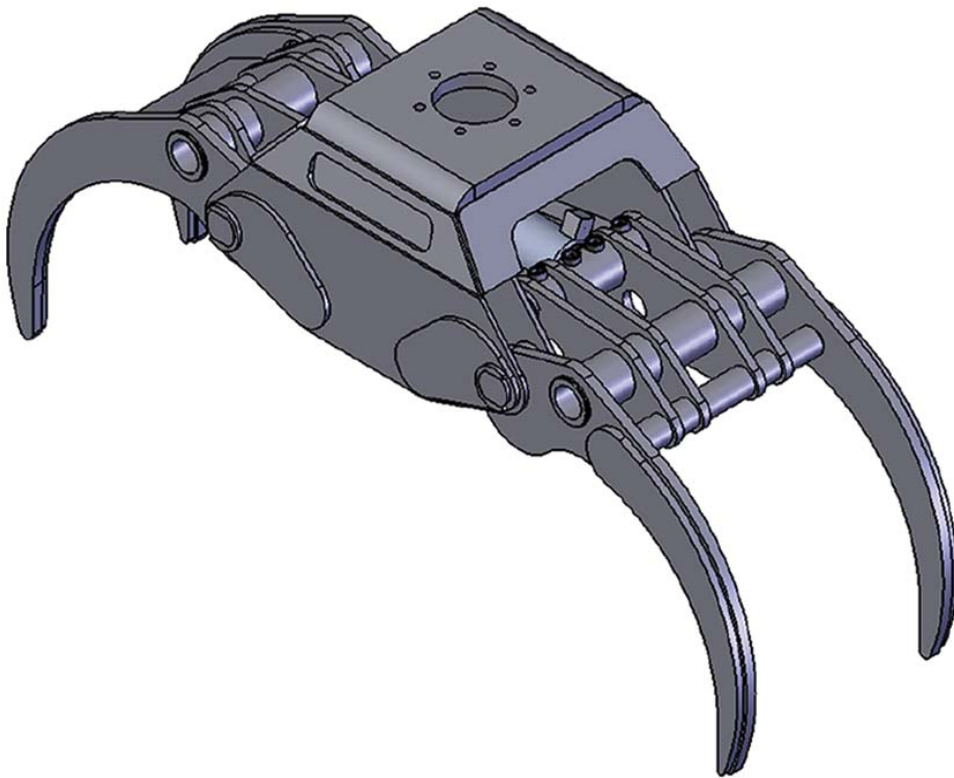

## KEY FEATURES

- Heavy duty
- Double guide bars
- Optimized roll in/roll out properties
- High pressure cylinder with double piston rod seals
- High tensile wear resistant steel (400 HB)
- Extra reinforced body for rigid mounting - Excavator design

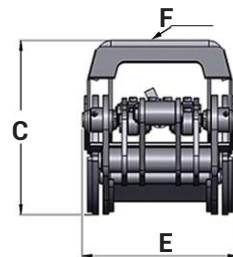
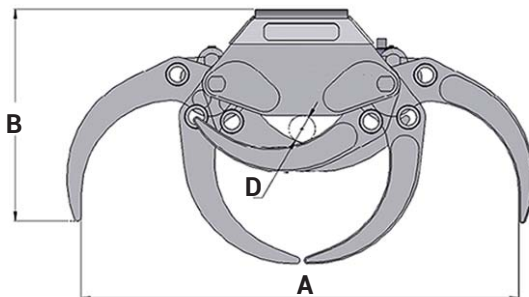

	TG 28 SR4	TG 35 SR4	TG 42 SR4	TG 55 SR4
<b>A</b>	1500	1890	1895	2450
<b>B</b>	735	763	925	1006
<b>C</b>	565	594	675	800
<b>D</b>	95	65	100	150
<b>E</b>	512	522	530	635
<b>F</b>	173/6	173/6	173/6	203/6

## MODEL SPECIFICATIONS



MODEL	Kg	m <sup>2</sup>	Bar	l/min	kN	tm	ton	ton	E			
TG 28 SR4	260	0,30	250	60	16,6	15	5	15	OK			
TG 35 SR4	330	0,38	250	60	17,6	15	7	15	OK			
TG 42 SR4	415	0,50	250	70	21,8	25	8	20	OK			
TG 55 SR4	760	0,65	250	90	25	30	10	30	X			

# INTERMERCATO

High performance lift and load attachments for Forestry, Transport, Construction and Recycling.

