

# SIGHT PUSHER™ FOR GLOCK\*



## USER GUIDE

# GLOCK SIGHT CHANGING MADE EASY.



**WARNING: TO AVOID DAMAGE, READ USER MANUAL AND REFER TO YOUR GUN MANUAL PRIOR TO USE.**

## 2-IN-1 TOOL™ FOR GLOCK\* ARMORER'S COMBINATION DISASSEMBLY & FRONT SIGHT TOOL



The integrated 2-in-1 Tool for Glock stores within the Easy Torque Handle and features a 3/16" Nut Driver for changing Glock front sights and a 3mm Armorer's Pin Punch for Glock disassembly and maintenance.

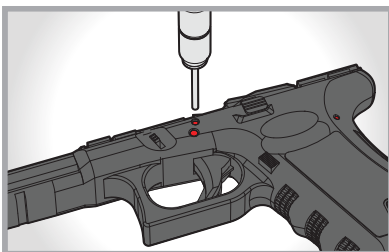

Easily remove pins to disassemble, clean, modify or maintain your Glock.

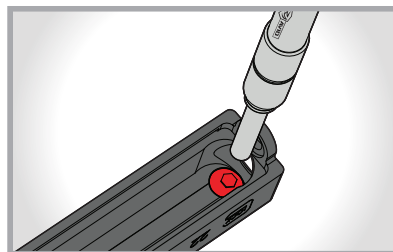

Precision-knurled driver can easily install or remove factory or aftermarket front sights.

## BEFORE YOU GET STARTED

**LUBRICATION:** Before each and every use, make sure to apply oil to bearing and thread surfaces. Lubrication is important to increase efficiency and reduce wear.

## CARE & MAINTENANCE

Store in a cool, dry location. Keep all threads and rotating interfaces oiled.

**WE RECOMMEND NOT EXCEEDING 100 INCH-LBS OF TORQUE**

## CONFIGURATION SPECS

Slide Locking Base orientation and shim usage for all Glock models.

		ORIENTATION	SHIMS
		Thin = 18.25mm	Small Shim 1mm
		Wide = 22.70mm	Large Shim 3.5mm
			Combined 4.5mm
FRAME SIZE	MODEL	ORIENTATION	SHIMS
Standard	Glock 17	Wide	Small
Standard	Glock 31	Wide	Small
Standard	Glock 22	Wide	Small
Standard	Glock 37	Wide	No Shim
Standard	Glock 21	Wide	No Shim
Standard	Glock 20	Wide	No Shim
Compact	Glock 44	Wide	Small
Compact	Glock 25	Wide	Small
Compact	Glock 19	Wide	Small
Compact	Glock 45	Wide	Small
Compact	Glock 32	Wide	Small
Compact	Glock 23	Wide	Small
Compact	Glock 38	Wide	No Shim
Subcompact	Glock 28	Wide	Small
Subcompact	Glock 26	Wide	Small
Subcompact	Glock 33	Wide	Small
Subcompact	Glock 27	Wide	No Shim
Subcompact	Glock 39	Wide	No Shim
Subcompact	Glock 30	Wide	No Shim
Subcompact	Glock 29	Wide	No Shim
Slimline	Glock 42	Thin	Combined
Slimline	Glock 43	Thin	Small
Slimline	Glock 48	Thin	Small
Slimline	Glock 36	Wide	No Shim
Competition	Glock 34	Wide	Small
Competition	Glock 35	Wide	Small
Competition	Glock 41	Wide	No Shim
Longslide	Glock 17L	Wide	Small
Longslide	Glock 24	Wide	Small
Longslide	Glock 40	Wide	No Shim

\*DISCLAIMER: This product is not manufactured, authorized, endorsed, or warranted by GLOCK. GLOCK does not warrant or represent that this product is compatible with GLOCK pistols. "GLOCK" is a federally registered trademark of GLOCK, Inc. and is one of many trademarks owned by GLOCK, Inc. and GLOCK Ges.m.b.H. New Revo Brand Group, LLC, d/b/a Real Avid is not affiliated in any manner with, or otherwise endorsed by, GLOCK, Inc. or GLOCK Ges.m.b.H.

# REMOVE OR INSTALL YOUR PRESS-FIT SIGHTS IN 3 EASY STEPS.

**TIP** Before removing your factory sight, place a small mark on the top of the slide just below and center of the notch/slot on the rear sight. This will provide you with a point of reference for centering your new rear sight during installation.

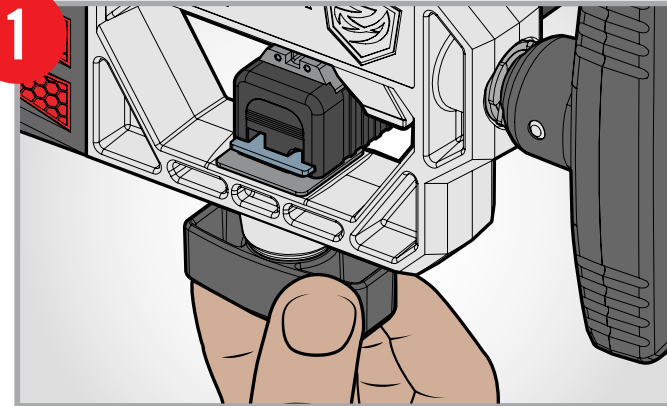

## REMOVAL

Configure correct orientation of Slide Locking Base and Press Block (See Configuration Specs). Loosen spring-loaded knob at bottom of sight pusher until knob can be pushed towards the sight pusher allowing clearance for Slide Locking Base to rotate 90° for proper orientation. If shim or shims are needed, add them at this time. Looking at the rear sight on Glock, determine if your sight is angled or at 90°.

## INSTALLATION

Install new sight into dovetail by hand. Check with manufacturer of sights for specs or special installation instructions before proceeding.

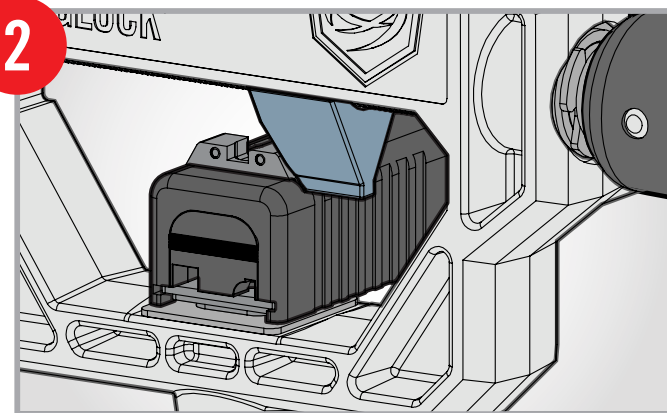

## REMOVAL

Once Slide Locking Base is in the correct orientation, slide rear of Glock slide onto locking base ensuring the sight is aligned with the Press Block & snugly tighten to hold pistol slide in place. This may take some small adjustments as you continually check height and alignment with the Press Block.

## INSTALLATION

Configure correct orientation of Press Block and slide rear of Glock slide onto locking base ensuring the sight is aligned with the Press Block & snugly tighten to hold pistol slide in place. Choose the angled or 90° side of the Press Block based on the design of the sights being installed.

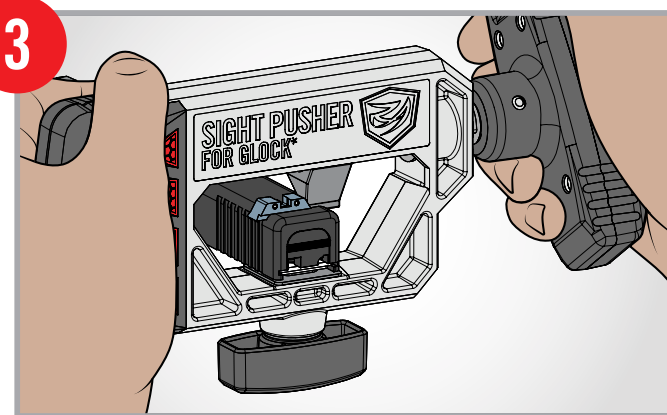

## REMOVAL

Turn Easy Torque Handle™ and push rear sight through dovetail. Glock sights are not press-fit sights. If you feel any binding in the Easy Torque Handle, stop pushing the sight and check to ensure proper alignment.

## INSTALLATION

Turn Easy Torque Handle and push rear sight into dovetail until centered in the slide. Glock sights are not press-fit sights. If you feel any binding in the Easy Torque Handle, stop pushing the sight and check to ensure proper alignment.

## WARRANTY

**LIMITED – 3 YEAR WARRANTY:** Sight Pusher™ for Glock\* is guaranteed free of defects in materials and workmanship for three years from date of original purchase. Real Avid will replace or repair any product that proves defective upon our inspection. Use of the Sight Pusher for Glock for anything other than its intended purpose is considered misuse and voids this warranty. For warranty service, send the product, proof of purchase with shipping paid, along with an explanation of the defect, as well as your name, address and phone number to the address below. This warranty excludes damage resulting from deliberate or accidental misuse. Warranty does not cover rust, stains or corrosion, or normal wear and tear. Repair or replacement is the exclusive remedy under this warranty. Real Avid, its partners and affiliates are not liable for incidental or consequential damage resulting from use. Some states do not allow exclusion or limitation of incidental or consequential damages; therefore, the above exclusions may not apply to you. This warranty gives you specific legal rights, and you may have other rights, which vary from state to state.



5480 NATHAN LANE NORTH, SUITE 120  
MINNEAPOLIS, MN 55442 | 800.286.0567

REALAVID.COM

© 2022 New Revo Brand Group, LLC.