



Trijicon

Q-LOC™ Technology

Mount Installation Instructions

- 1** Ensure the mounting knob(s) are loosened and able to be engaged.
- 2** Depress knob(s) and place mount on rail.
- 3** Release knob(s) to securely engage on rail.
 - » Spring loaded retention will guarantee 14-16 in./lbs. of pressure on rail without tightening.
- 4** Hand tighten knob(s), or mounts can be tightened to 44-66 in./lbs.

Illustration located on back of card

CAUTION:

Do not attempt to completely remove the knob. Doing so may damage the mount and void your warranty.

1

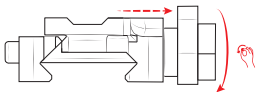

2

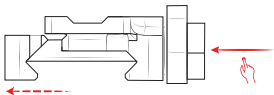

3

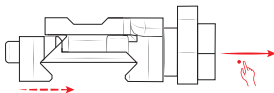

4

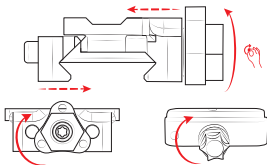

Side View of "Hex Knob"

Side View of "Acorn Knob"