

INSTALLATION CONTINUED

ATTACHING HEADSET TO THE HELMET

1 ATTACH RAIL ARM TO ARC RAIL

Rotate the rail arm shoe as shown and insert it into the bottom rear portion of the ARC Rail.

Push rail arm shoe up until the tab clicks into the desired rail slot. (Repeat steps 1 and 2 for other earcup).



Rail Arm Shoe

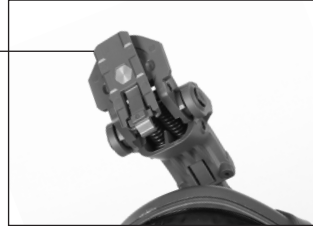

2 ROTATE EARCUP & ROUTE CABLE

Rotate the arm and earcup over the ear position and route cable through Cable Clip as shown. (Repeat for the other earcup).

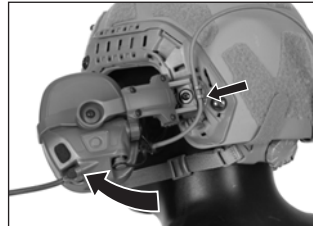

3 SECURE CABLE TO HELMET

Attach cable to helmet as shown using supplied hook and loop fasteners.

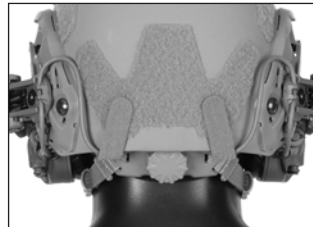

RAIL MOUNT KIT

FOR OPS-CORE AMP™ COMMUNICATION HEADSET



**Rail Arms and Cable Fasteners Only - AMP Headset and Helmet Not Included*

Connects AMP Headset to Ops-Core ARC Rails

COLOR

| | | | | | | | |
|---|---------|---|-------|---|---------------|---|------------|
|  | TAN 499 |  | BLACK |  | FOLIAGE GREEN |  | URBAN GRAY |
| 1000440-00 | | 1000440-01 | | 1000440-02 | | 1000440-04 | |

This product is covered by one or more patents.
For more information visit www.gentexcorp.com/patents

1000437-00

Copyright © 2018 Gentex Corporation. Ops-Core is a registered trademark of Gentex Corporation or its affiliates.

INTRODUCTION

ABOUT YOUR RAIL MOUNT KIT

The Rail Mount Kit is used to securely attach the AMP Headset to an Ops-Core helmet equipped with Ops-Core ARC Rails.

RAIL MOUNT KIT INCLUDES:

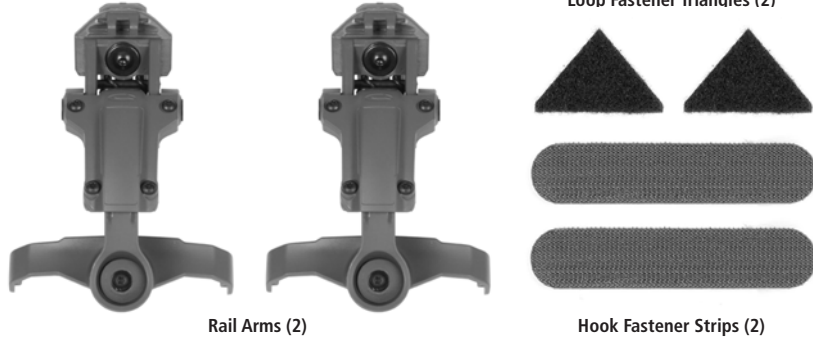

PRE-INSTALLATION

Before you can attach the rail arms to the AMP Headset earcups, they must first be removed from the headband.

1 UNFASTEN CABLE RETENTION

Unfasten the three loop fastener cable retention tabs on the headband to free the ear-to-ear cable and unfasten the cable management straps.



2 DETACH HEADBAND ARMS

Use your index finger to pull the headband arm towards you, which will free the earcup from the headband.

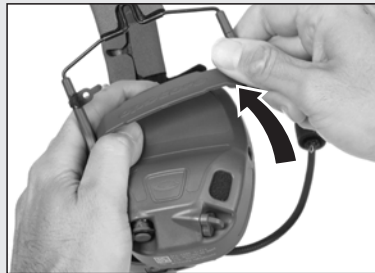

INSTALLATION

HOOK & LOOP FASTENER INSTALLATION

1 INSTALL LOOP FASTENER TRIANGLES

Remove the backer from the adhesive backed loop fastener triangles and install inside the rear lip of helmet as shown.

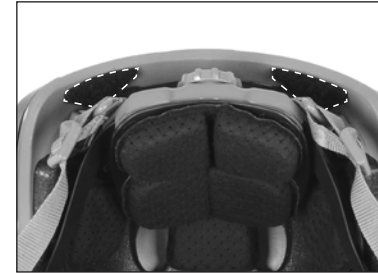

2 INSTALL LOOP FASTENER STRIPS

Install the two pieces of hook fastener strips as shown.



ATTACHING HEADSET TO RAIL ARMS

1 ALIGN RAIL ARM AND EARCUP

Align the rail arm with the earcup so that the rail arm strap swivel bulge is facing down / arrow marker on the inside of the strap is pointing up.

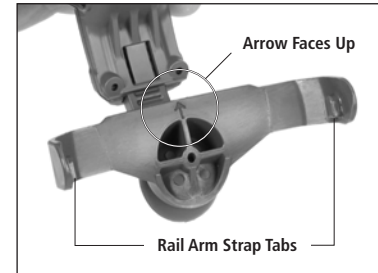

2 ATTACH RAIL ARM TO EARCUP

Insert one side of the rail arm strap tab into the hole on the side of the earcup and push down to snap in the opposite earcup strap tab into the hole on the other side of the earcup. (Repeat for the other earcup).

