



McCoy's

Leaders in Glass

DISTRIBUTION

Johannesburg - Bloemfontein - Port Elizabeth - Durban - Polokwane - Cape Town - Pretoria - Kimberly - Rustenburg - Nelspruit - Richards Bay - Express East Gauteng - Express West Gauteng - Express North Gauteng - East London

Standard McDoor Tri-glide door and side panels

Jamb Extensions of 15mm are available to complete a range size of 770mm to 1010mm for the Glide Door. i.e. GD 860 + one jamb extension of 15mm will permit a maximum width of 875mm. Two jamb extensions of 15mm will permit a maximum width of 890mm.

Will fit standard 900 x 900 shower tray.

1

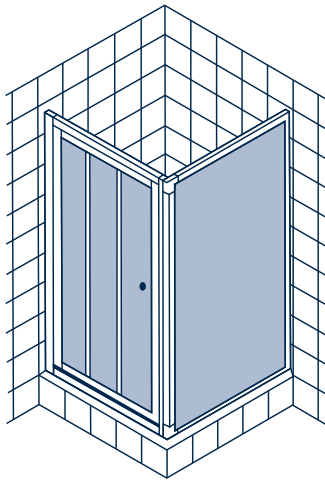

ASSEMBLY PREPARATIONS

1. Check shower enclosure for damage during transportation since we can accept no liability for parts which have been installed.
2. Tools required: Drill, masonry drill bit \varnothing 6mm, metal drill bit \varnothing 3mm, Phillips screwdriver, spirit level, tape measure and pencil.
3. Tiles and edges of the shower tub must be free of dirt and grease.
4. Look out for electricity cables and water pipes when drilling.

3

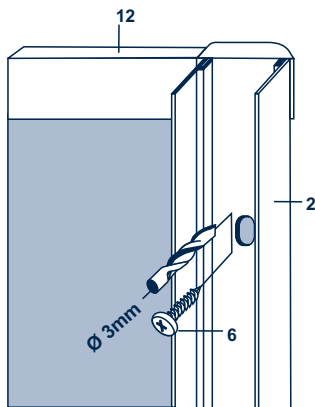

Drill 4 holes in wall compensating profile (Pos. 2) from the glide door frame as shown in sketch and screw to side panel (12) (left or right). ATTENTION: Determine the selected installation position of the side panel before further assembly. The side panel here is shown on the right.

2

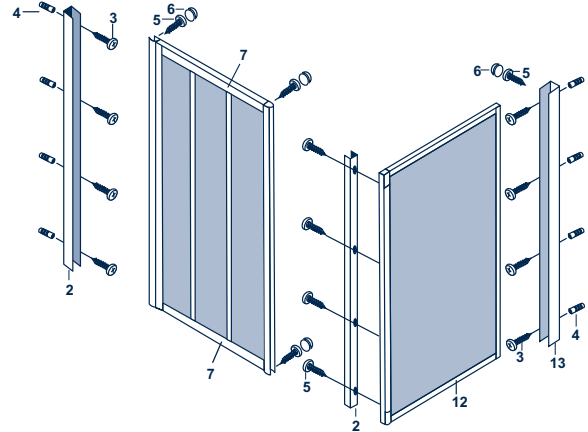

CONTENTS OF CORNER ENTRY PACKAGING

Pos. 1	Glidedoor	1pce
Pos. 2	Wall connecting profile	2pce
Pos. 3	Pan head tapping screw 4.2x38	8pce
Pos. 4	Dowel \varnothing 6mm	8pce
Pos. 5	Self tapping screws 3.9x9.5	6pce
Pos. 6	Caps for screws	6pce
Pos. 7	Head and cill frame covers	2pce

CONTENTS OF SIDE PANEL PACKAGING

Pos. 12	Side panel	1pce
Pos. 13	Wallconnectingprofile	1pce
Pos. 3	Pan head tapping screw 4.2x38 for SP from accessories GD	4pce
Pos. 4	Dowel \varnothing 6mm for SP from accessories GD	4pce
Pos. 5	Self tapping screws 3.9x9.5	6pce
Pos. 6	Caps for screws	2pce

4

Remove wall compensating pro files Pos. 2 from the glide door and Pos. 13 from the side panel, align as shown in sketch, mark and drill holes (\varnothing 6mm), insert dowels and screw to wall.

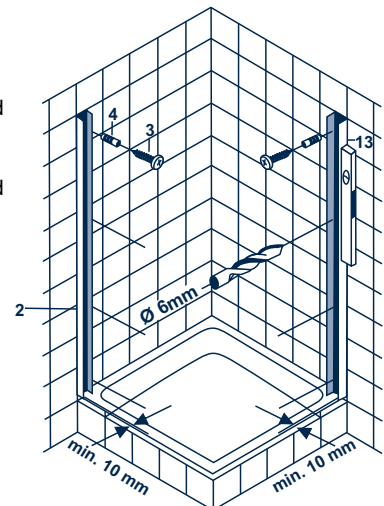



McCoy's

Leaders in Glass

DISTRIBUTION

Johannesburg - Bloemfontein - Port Elizabeth - Durban - Polokwane - Cape Town - Pretoria - Kimberly - Rustenburg - Nelspruit - Richards Bay - Express East Gauteng - Express West Gauteng - Express North Gauteng - East London

Standard McDoor Tri-glide door and side panels

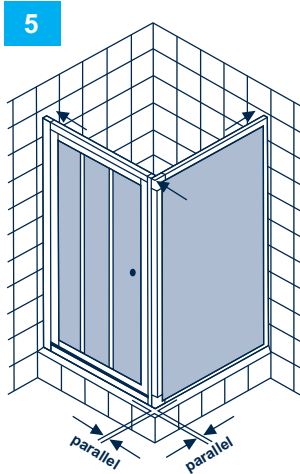

Push glide door (Pos. 1) and side panel (Pos. 12) onto doweled wall compensating profile (2 + 13), insert side panel and attached wall connecting profile (Pos. 2) refer item 3, into glide door jamb frame. Align shower enclosure parallel to the edge of the upstand and must be vertically square.

Note: Sliding leaves slide on the inside of the shower!

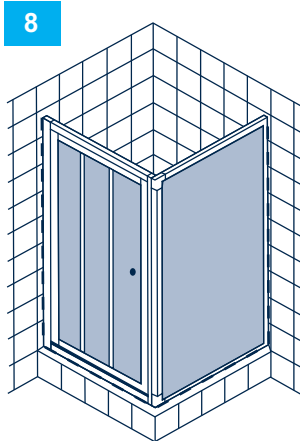

Seal all joints between the wall, upstand and profiles with an approved anti-fungus silicon sealant.

Leave the shower enclosure for 24 hours before using. Use only recommended cleaning agents (no abrasives or solvents) for cleaning purposes.

6 Ensure glide door frame is vertically plumb, then drill 2 holes inside in glide door side frame with wall compensating profile (Pos. 2), side panel with glide door side frame and side panel with connecting profile (Pos. 13) as shown in sketch and screw together, using 3.9 x 9.5 screws and fit caps over head of screws.

A = inside view

TO ACHIEVE CORRECT ALIGNMENT OF THE LEAVES THE FRAME MUST BE INSTALLED VERTICALLY PLUMB.

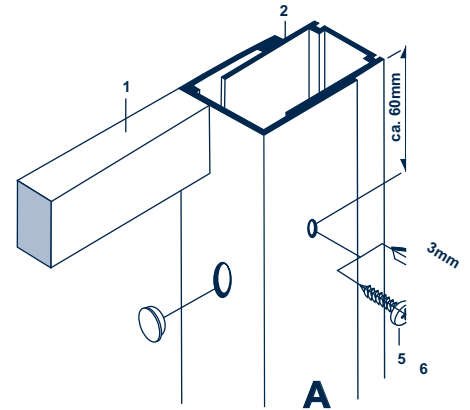

7 After glide frame is securely fixed into position, slide the fixed leaf hard against the frame and drill for 2 x 3.9 x 9.5 self tapping screws and screw fixed leaf to frame and fit cap over screw head. Clip top and bottom covers into position into the frame.

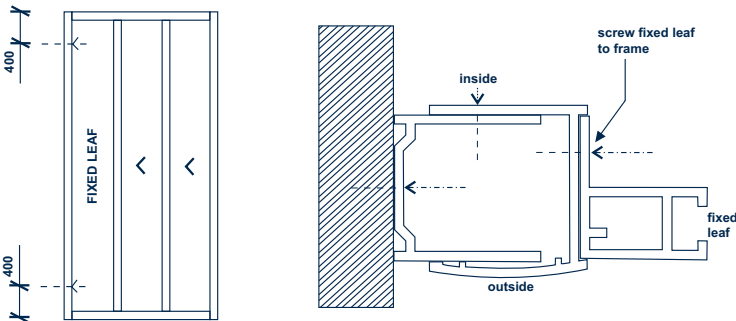

10 Installation in Alcoves

Installation into alcoves:

Remove both wall compensating channels (Pos. 2) from the glide door frame, align them vertically at a distance of 10mm minimum from the outside edge of the upstand, mark the holes for dowels, and drill with 6mm masonry drill bit. Screw the sliding leaf side compensating channel into place on the wall. Slide the side of the frame over the compensating channel fixed to wall only after sliding the unfixed compensating channel into the other side of the frame. Fix the second compensating channel to the wall through holes in that side frame, using 4.2 x 38mm screws (Pos. 3) Position frame centrally and vertically plumb onto the compensating channels and continue as Fig. 6 to 8 above.

