

SCH 30



62 lb Self-contained Ice Machine

Technical features

- Stainless steel bodywork
- Vertical pump
- Built-in cleaning system
- Easily accessible components
- Low power and water consumption
- Optimum ratio between ice production and bin capacity
- Reduced dimensions
- Double defrosting system
- Electronic PCB to create perfect cubes and help troubleshooting with alarm signals
- Scale Tap
- Bin Sensor Termic
- Easy Clean Spray system
- R290 Condenser



Internal bin capacity



18.7 lb of ice
430 cubes

Type of ice

Full Cubes

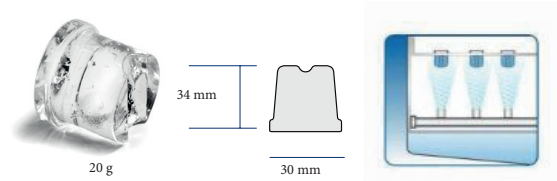

Voltage

115/60/1 Standard version

Machine dimensions

| | |
|---------------------------|-------------------|
| Exterior dimensions WxDxH | 15.2x20.2x29.5 in |
| Product Weight | 68.4 lb |
| Shipping Dimensions | 18.1x22.8x29.9 in |
| Shipping Weight (approx.) | 81.6 lb |

Technology and Certifications



FOOD SERVICE SOLUTIONS INC.
2-6599 Kitimat Road
Mississauga, ON
L5N 4J4
(800) 668-8765
e-mail: info@myfss.ca



SCH 30

SIMAG
by Scotsman

62 lb Self-contained Ice Machine

Accessories

- Scoop
- Hose set tubes
- Drain tube
- Legs
- Floor mount kit to be provided with the unit to be ordered as accessory (SCKITFLOORSCH30)

Warranty

- 3 years parts and labor costs
- 5 years warranty on compressor



SCH 30



62 lb Self-contained Ice Machine

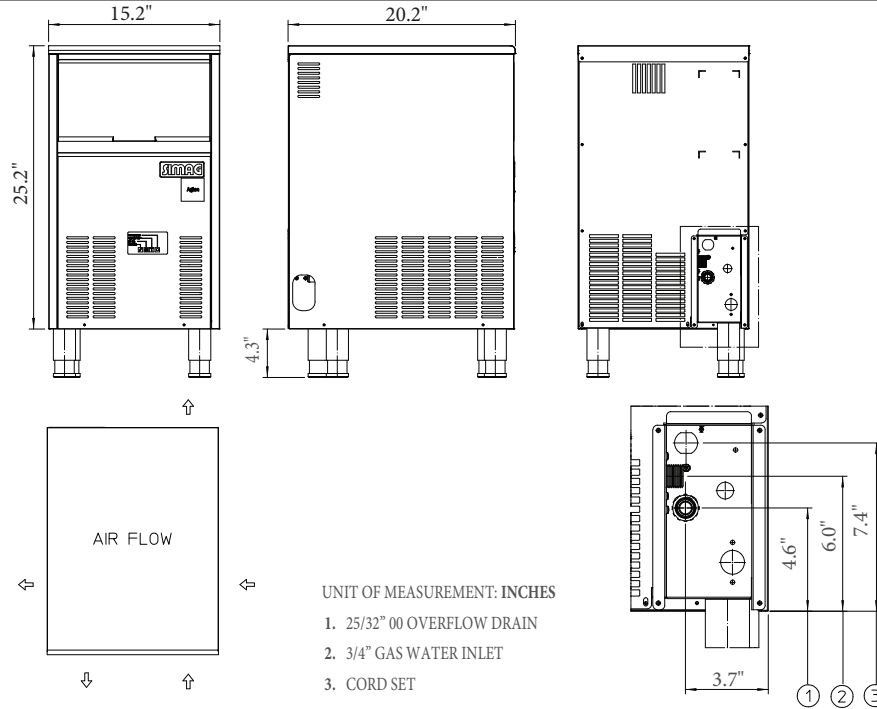

DRAINAGE PER GRAVITY

Operating Limits

| | Minimum | Maximum |
|--------------------|---------|---------|
| Air temperature | 50°F | 100°F |
| Water temperature | 40°F | 100°F |
| Water pressure | 1 bar | 5 bar |
| Electrical voltage | -10 % | +10 % |

Specifications and design are subject to change without notice

| Model | Voltage | Daily production lb | | Daily production kg | | Power input Watt (*) | Refrigerant | Fuse A | Consumptions (**) | | | |
|----------|----------|---------------------|--------------------|---------------------|--------------------|----------------------|-------------|--------|-------------------|---------------|------|--------------------|
| | | 21/10°C 70/50°F | 32/21°C 90/70°F | 21/10°C 70/50°F | 32/21°C 90/70°F | | | | kJ/kg | kWh/ 100lb | l/kg | Water gal/100lb |
| SCH 30 A | 115/60/1 | 62 | 45 | 28 | 62 | 360 | R290 | 10 | 1300 | 16.38 | 3.3 | 40 |

(*) Power Input: at 90°F Ambient Temperature

(**) Water Consumption: at 90°F Air and 70°F Water