



www.doyon.qc.ca • www.nu-vu.com

JA4 & JA4SC

JET-AIR OVEN

The JA series from Doyon is known worldwide for its unique JET AIR SYSTEM. The air moves in one direction, stops then moves the other way resulting in a bidirectional and gentle velocity air flow for exceptional baking results. This system will help you bake faster and more evenly without having to turn pans during baking time. The Jet Air fan system will save energy and labor costs.

Doyon's outstanding uniform steam injection system includes an electronic timer which will give you a precise mist everytime for a better quality product (crusty breads, bagels, french baguettes, etc.). This superior steam system will allow inexperienced employees to produce quality products with a minimum of training.



JA4 + Stand



JA4SC

STANDARD FEATURES

OVEN

- Countertop oven (JA4)
- Exclusive patented reversing fan system
- Outstanding steam injection system including an electronic timer
- Fan delay switch
- High production oven
- Compact space saving unit
- High production oven (4 pans)
- Full view heat reflective thermos glass doors
- Brightly lit
- Digital reminder timer
- Full view heat reflective thermal glass doors
- Fully insulated, completely sealed
- Digital temperature controllers and timers
- Temperature up to a maximum of 500°F
- Energy efficient electric heating (baking temperature reached in 15 minutes)
- Magnetic latches
- Door switch cut-off for fan blower
- Stainless steel inside and outside
- 3/4 HP motor
- 2 year parts 1 year labor limited warranty

OPTIONS

- Water softener: PLF240
- Perforated nickel plated pizza decks
- High temperature gasket for baking over 400°F (205°C)(JA4 Series)
- JA4 Stand on Casters (JA4B)

Experience our top-of-the-line ovens today!



5600 13th Street • Menominee, MI 49858 USA

Phone: 906-863-4401

E-mail: sales@nu-vu.com

Toll Free: 1-800-338-9886

www.doyon.qc.ca

Fax: 906-863-5889

www.nu-vu.com

OVERALL DIMENSIONS

JA4 32 1/2" W X 40" D X 31" H
(826 mm X 1015 mm X 787 mm)
JA4SC 32 1/2" W X 37" D X 71" H
(826 mm X 940 mm X 1805 mm)

OVEN INTERIOR DIMENSIONS

JA4 27 1/2" W X 20" D X 17 1/2" H
(699 mm X 508 mm X 445 mm)
JA4SC 27 1/2" W X 20" D X 17 1/2" H
(699 mm X 508 mm X 445 mm)

Shelf spacing 3 1/2" (89 mm)

ELECTRICAL SYSTEM

JA4 - JA4SC

3 phases:

120/208V - 22A - 8 kW - 4 wires - 60 Hz

1 phase:

120/240V - 34A - 8 kW - 3 wires - 60 Hz

220V - 32A - 7 kW - 2 wires - 50 Hz

Other voltages available

CAPACITY

Standard sheet pans 18" X 26" (46 cm X 66 cm): 4 pans
Four-strapped bread pans (up to 8 1/2" long): 16 loaves
9" (23 cm) pies: 24 pies

FINISH: Stainless steel

SHIPPING WEIGHT

425 lb (193 kg) approximately (JA4)

650 lb (295 kg) approximately (JA4SC)

JA4

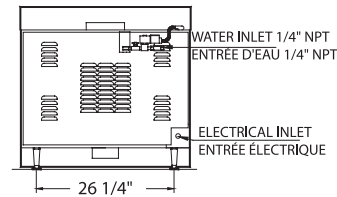
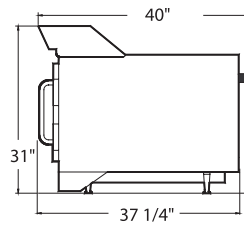
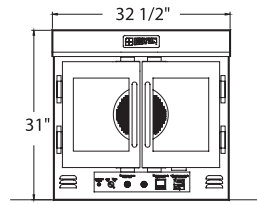

JA4SC

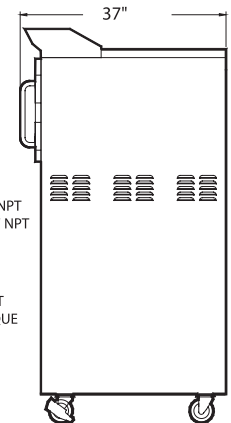
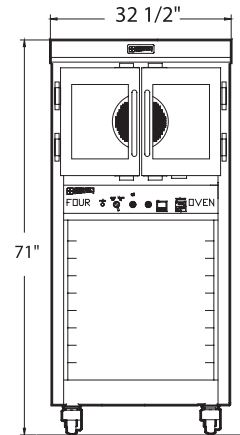

Electrical service connection and water inlet are located at the back of the unit.
Specifications and design are subject to change without notice.

JA4B

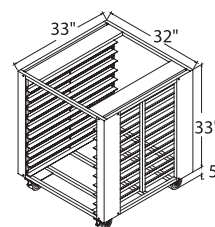

ELECTRICAL INLET
ENTRÉE ÉLECTRIQUE



WATER INLET 1/4" NPT
ENTRÉE D'EAU 1/4" NPT



5600 13th Street • Menominee, MI 49858 USA

Phone: 906-863-4401

E-mail: sales@nu-vu.com

Toll Free: 1-800-338-9886

www.doyon.qc.ca

Fax: 906-863-5889

www.nu-vu.com