

Iwatani Accessory Series BBQ Plate(Large)

Model:CB-P-Y3

For use only with Iwatani Cassette Feu Portable Butane Stove
Be sure to read this entire instruction manual before using this product. Retain this instruction manual for future reference.

INSTRUCTIONS

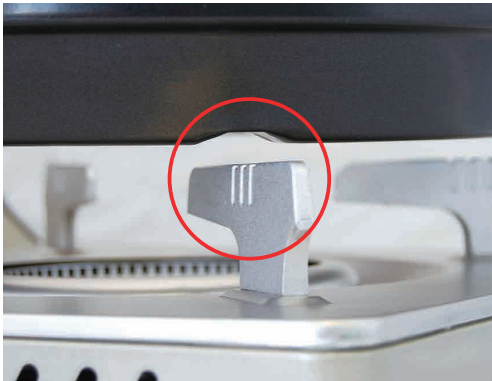

Place the Water Tray on to the stove. Make sure that the pan supports of the stove fit into the indentations on the Water Tray so that the flames are directed at the center of the Plate.



Be sure to fill the receptacle about two-thirds full with water (approximately 9oz/260ml).



When removing the Plate or adding water, use the handle included.

HOW TO USE THE HANDLE

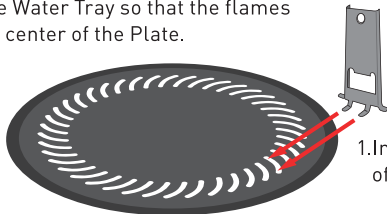

1. Insert in the direction of the arrows.

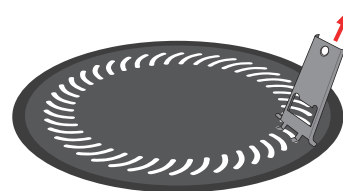

2. Make sure that the handle is completely inserted in the hole and lift.

WARNING

- Keep out of the reach of children.
- Even after use, the BBQ Plate contains very hot water, never leave the plate unattended.
- Do not use any other cooking appliances other than Iwatani Portable Butane stove.

CAUTION

- **Be sure to add water to the water tray when using this product.** Not doing so can damage the non-stick coating, or cause deformations to the BBQ plate. If the water level drops during use, refill with water to ensure that the water tray always has water in it.
- During and after cooking, **do not touch this product directly.** Doing so may cause burns or other injuries.
- Depending on the butane stove being used, **the BBQ Plate may slip.** Be careful when handling it.
- Use an oven mitt or similar protection when handling the BBQ Plate.

[OTHER CAUTIONS]

- Before using this product for the first time, warm it slightly and then rub salad oil onto the Plate's surface.
- Do not use metal or other abrasive utensils. Doing so can damage the non-stick coating and reduce normal performance. Be sure to use a wooden, silicone or other non-abrasive utensils.
- Use it only over medium or lower heat.
- This product is dish washer safe. Do not use metal scrubbers, abrasive cleaners or similar items as they will damage the non-stick surface. If you leave the product unwashed, the food will stick to the surface, and removing it may damage or remove the non-stick coating.
- After washing the product, carefully wipe off all moisture and store it safely.
- Please note that depending on the size of the butane stove, this product may not be usable.