



Rack Not Included

DIMENSIONS & SHIPPING WEIGHT

38 1/2" W X 56 1/2" D X 86" H x 52" Base Depth
(978 mm X 1435 mm X 2134 mm x 1321mm)
500 lb (227 kg)

ELECTRICAL SYSTEM

1 Phase (with Neutral):

208V - 35 A - 7.2 kW - 60 Hz - 2 wires + ground
240V - 31 A - 7.2 kW - 60 Hz - 2 wires + ground

DOOR OPENING DIMENSION

32 1/2" L x 73 1/2" H
(826mm x 1867mm)

FEATURES & BENEFITS

- Stainless Steel Construction—Aluminum Flush Floor Entry
- Ships in One Piece
- Left or Right Hinge Door (Must Specify)
- Full View Glass Door
- Angled Controls for Ease of Use
- Accommodates (1) Single Full-size Pan Rack
- Independent Heat, Humidity, & Timer Controls
- Manual Controls
- Auto Injection Moisture System (Requires Water Connection)
- No Drain Required
- One Year Labor & Two Year Parts Warranty

OPTIONS & ACCESSORIES

- Water Filter (PLF240)
- Stainless Steel Door (Suffix SD)
- Door Bumpers (Suffix DB)

STANDARD PRODUCT WARRANTY

One Year Labor and Two Year Parts

FINISH

Stainless Steel

WATER CONNECTION

1/4" NPT

RACK CAPACITY

2 Single / 1 Double

Capable Size—30 5/8" W x 73 3/4" H x 39" D

SHORT SPECIFICATION

Proofer, Electric, Rollin Style, One Piece Construction, Stainless Steel, Aluminum Flush Floor Entry, Full View Glass Door, Independent Heat & Humidity Controls, Auto Injection Moisture System-No Water Pans, Easy to Use Controls, Holds (2) Standard Sheet Pan Rack & (1) Double Standard Sheet Pan Rack, No Drain Required, 1/4" NPT Water Connection Required for Moisture, One Year Labor & Two Year Parts Warranty

DRAWINGS (Exterior)

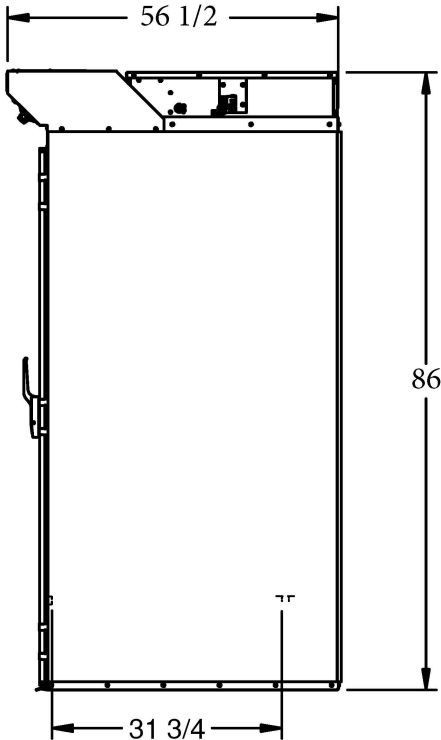
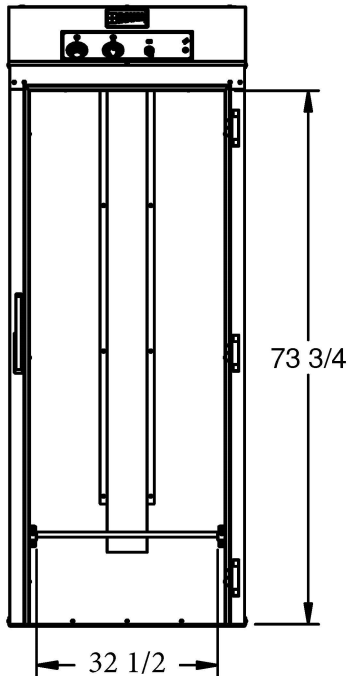
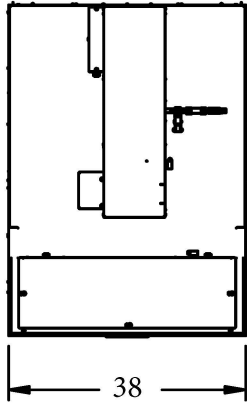

DRAWINGS (Interior)
Interior Height - 73-3/4"

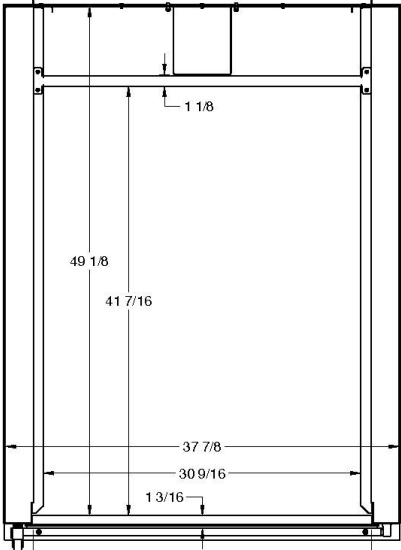

5600 13th Street
Menominee, MI 49858
sales@nu-vu.com
(800) 338-9886 Toll Free
(906) 843-4401 Phone
(906) 863-5889 Fax
www.doyon.qc.ca

**SPECIFICATIONS SUBJECT TO CHANGE WITHOUT NOTICE
KCL & REVIT DRAWINGS UPON REQUEST**

Proofer, Rollin, Single
MODEL: DRIP1



Rack Not Included

FEATURES & BENEFITS

- Stainless Steel Construction—Aluminum Flush Floor Entry
- Ships in One Piece
- Left or Right Hinge Door (Must Specify)
- Full View Glass Door
- Angled Controls for Ease of Use
- Accommodates (1) Single Full-size Pan Rack
- Independent Heat, Humidity, & Timer Controls
- Manual Controls
- Auto Injection Moisture System (Requires Water Connection)
- No Drain Required
- One Year Labor & Two Year Parts Warranty

OPTIONS & ACCESSORIES

- Water Filter (PLF240)
- Stainless Steel Door (Suffix SD)
- Door Bumpers (Suffix DB)

STANDARD PRODUCT WARRANTY

One Year Labor and Two Year Parts

DIMENSIONS & SHIPPING WEIGHT

33"W X 46 1/2"D X 86"H x 42 1/4" Base Depth
(838 mm X 1181 mm X 2184 mm x 1073mm)
400 lb (182 kg)

ELECTRICAL SYSTEM

1 Phase:

120V - 39 A - 4.7 kW - 60 Hz - 2 wires + ground

1 Phase (with Neutral):

208V - 28 A - 5.7 kW - 60 Hz - 2 wires + ground

240V - 24 A - 5.7 kW - 60 Hz - 2 wires + ground

DOOR OPENING DIMENSION

27"L x 73 1/2"H
(686mm x 1867mm)

FINISH

Stainless Steel

WATER CONNECTION

1/4" NPT

SHORT SPECIFICATION

Proofer, Electric, Rollin Style, One Piece Construction, Stainless Steel, Aluminum Flush Floor Entry, Full View Glass Door, Independent Heat & Humidity Controls, Auto Injection Moisture System-No Water Pans, Easy to Use Controls, Holds (1) Standard Sheet Pan Rack, No Drain Required, 1/4" NPT Water Connection Required for Moisture, One Year Labor & Two Year Parts Warranty

DRAWINGS (Exterior)

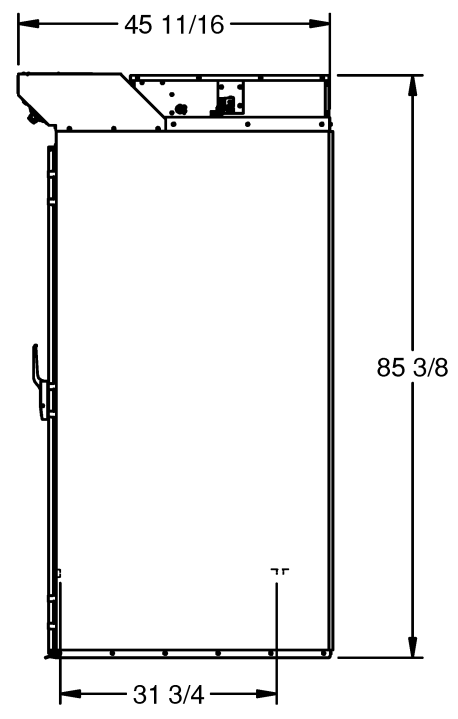
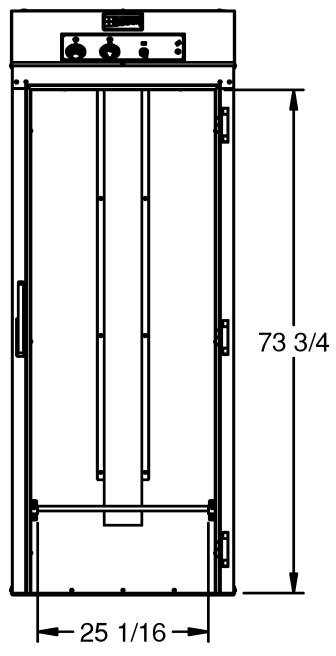
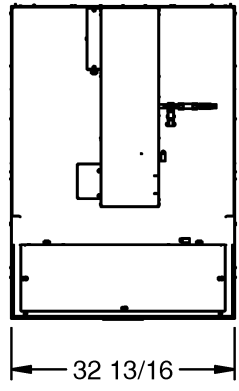

DRAWINGS (Interior)
Interior Height - 73-3/4"

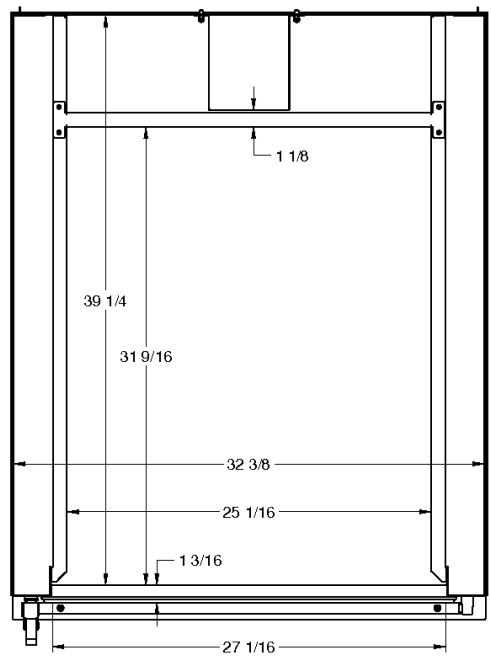

5600 13th Street
Menominee, MI 49858
sales@nu-vu.com
(800) 338-9886 Toll Free
(906) 843-4401 Phone
(906) 863-5889 Fax
www.doyon.qc.ca

**SPECIFICATIONS SUBJECT TO CHANGE WITHOUT NOTICE
KCL & REVIT DRAWINGS UPON REQUEST**