



Equipment for the Foodservice Industry

value + quality + service

Back Bar Glass Door Coolers

CBBGD2-48CC



CBBGD2-48CC

Features

Features:

- All steel construction with two exterior options
- - Exterior covered in an easy to maintain black vinyl
- Counter tops and interiors are made with Type 304 Stainless Steel
- Recessed handles
- Door equipped with locks for security
- Self-closing doors equipped to stay open when past 90 degrees
- Adjustable/removable plastic coated shelves

- Refrigeration system holds 33°F to 38°F (-0.5°C to 3.3°C) for optimum food preservation
- Removable door gasket
- Foamed-in polyurethane cell insulation

Warranty:

- 2 year parts and labour; 5 years on compressor
- Specifications subject to change without notice.



CBBGD2-48CC Specifications

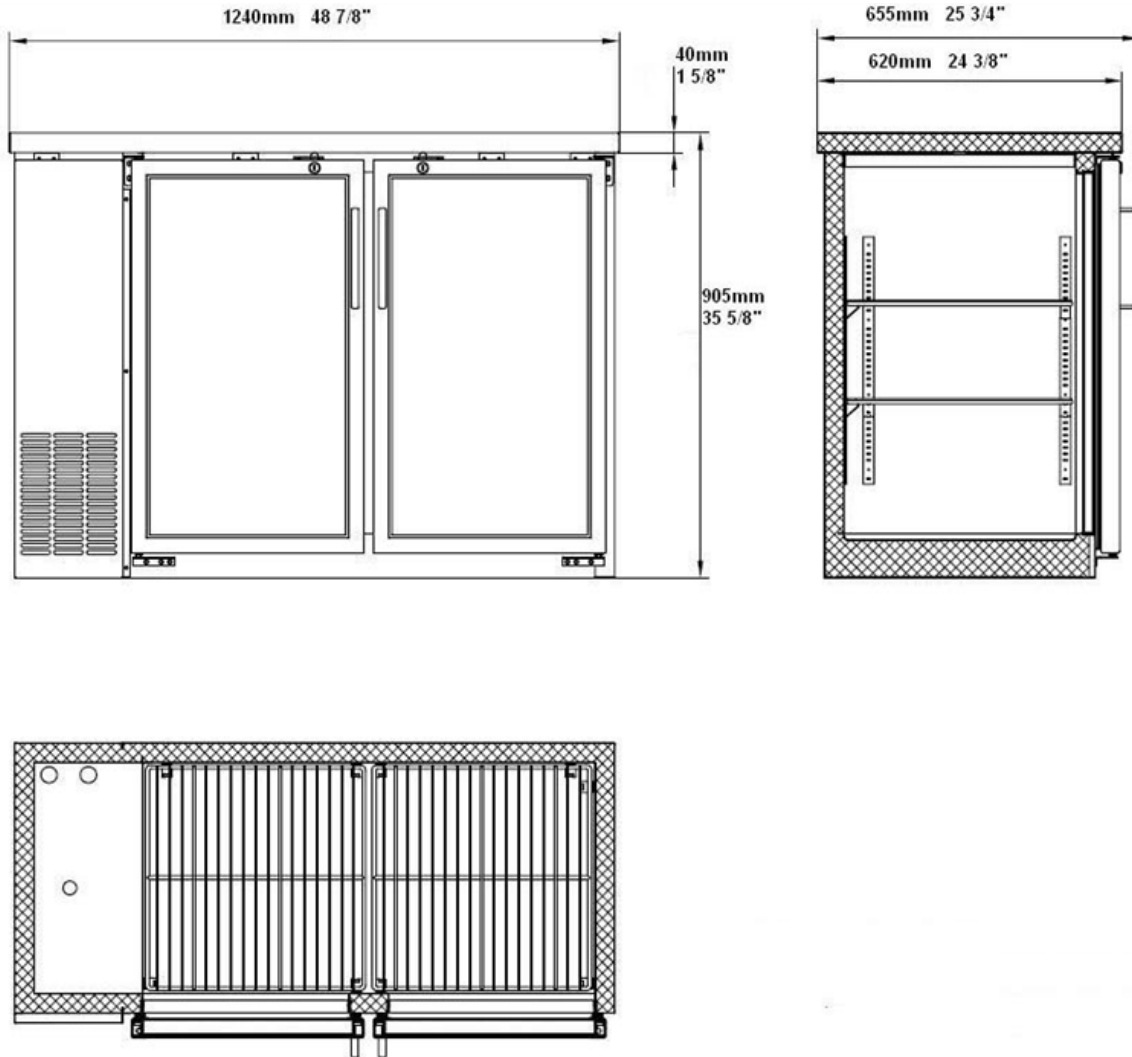

Model	Doors	Dimension (mm) (inch)			HP	Voltage	Amps	Capacity (L) (Cu Ft.)	Net Weight (KG) (LBS)	Temperature Range	NEMA Config.
		L	D	H							
CBBGD2-48CC	2	1242.1	619.8	904.2	1/3	115/60/1	6.4	334.1	117.9	0.5 ~ 3.3°C	5-15P ⓘ
		48.9	24.4	35.6							