

ICB TWIN TF 1.0 Gal PE, 120/240V SST

25.1" x 23.5" x 22.6"
(63.8cm x 59.7cm x 57.4cm)



- Intuitive 4.3" touchscreen with user interface provides an enhanced experience when operating and programming the brewers
- SmartWAVE sprayhead technology creates an industry best uniformity of extraction for exceptionally smooth tasting coffee
- Platinum Edition SmartWave technology delivers a timed air purge at the end of the brew cycle, removing residual water from the sprayhead, reducing lime build up and ultimately extending the life of the equipment
- The ICB Twin Infusion Series coffee brewer delivers twice the brew capacity, from a single platform
- Multiple recipes from one footprint --- with six brew buttons and two batch sizes
- Large 5.6 gallon (21.2L) tank provides back-to-back brewing capacity
- USB port for easy programming
- Digital readout displays in English, Spanish, or French ---for easier programming and control
- Energy-saver mode reduces tank temperature during idle periods
- Electronic funnel lock prevents removal of each brew funnel until drip- through is complete
- ICB Twin TF 54200.0100 is compatible with new TF 1.0-gallon Baseless ThermoFresh® Servers, all previous generations of TF 1.0-gallon Baseless TF Servers, and Airpots

Agency:



Specifications

Product #: 54200.0100

Water Access: Plumbed

Interface: Wireless

Finish: Stainless

Funnel: Smart Funnel

Faucet: Lower

Legs: 4" Satin Nickel Legs

Additional Features

Hot Water Button

Electrical & Capacity

Volts	Amps	Watts	Cord Attached	Plug Type	8oz cups/hr 236ml cups/hr	Input H ₂ O Temp.	Phase	# Wires plus Ground	Hertz
120/240	25	6000	Yes/	-	280	60°F (15.5°C)	1	3	60

Plumbing Requirements

PSI	kPa	Fitting Supplied	Water Flow Required (GPM)
20-90	138-621	3/8" Male Flare Fitting	1.00

CAD Drawings

2D	Revit	KLC
●		



BUNN® reserves the right to change specifications and product design without notice. Such revisions do not entitle the buyer to corresponding changes, improvements, additions or replacements for previously purchased equipment. For most current specifications and other info visit bunn.com.

Created on:
08/13/2018

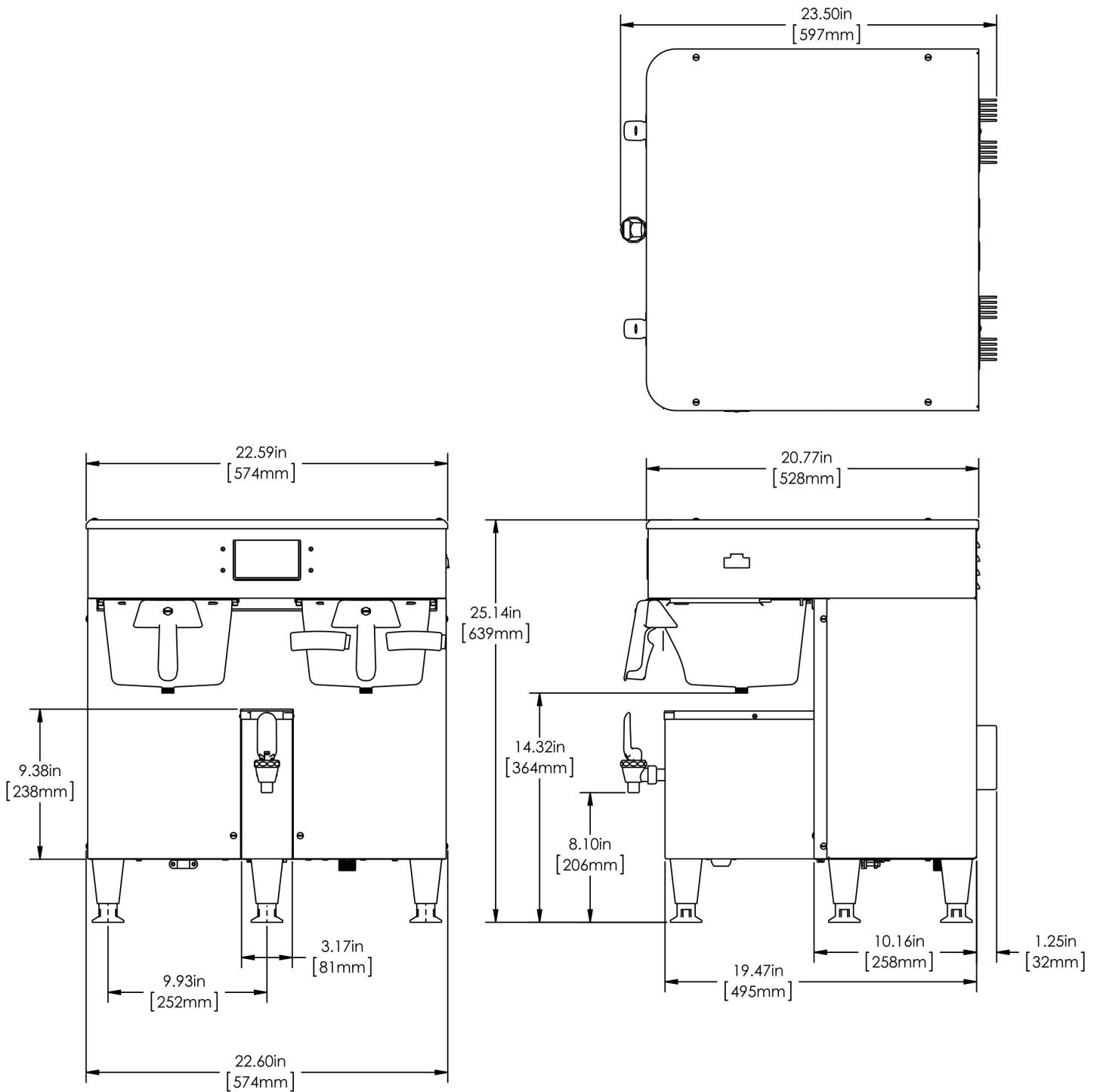

Unit			Shipping					
	Width	Height	Depth	Width	Height	Depth	Weight	Volume
English	22.6 in.	25.1 in.	23.5 in.	22.6 in. in.	25.1 in. in.	19.5 in. in.	75.750 lbs	6.402 ft ³
Metric	57.4 cm	63.8 cm	59.7 cm	57.4 cm cm	63.9 cm cm	49.5 cm cm	34.360 kgs	0.181 m ³



BUNN® reserves the right to change specifications and product design without notice. Such revisions do not entitle the buyer to corresponding changes, improvements, additions or replacements for previously purchased equipment. For most current specifications and other info visit bunn.com.

Created on:
08/13/2018

Related Products & Accessories: ICB TWIN TF 1.0 Gal PE, 120/240V SST(54200.0100)



WATER FILTER,
EQHP-10L

Product #: 39000.0001



WATER FILTER,
EQHP-10

Product #: 39000.0004



STAND ASSY, TF
SERVER GEN3

Product #: 39795.0200



BUNN® reserves the right to change specifications and product design without notice. Such revisions do not entitle the buyer to corresponding changes, improvements, additions or replacements for previously purchased equipment. For most current specifications and other info visit bunn.com.

Created on:
08/13/2018

Serving & Holding Options: ICB TWIN TF 1.0 Gal PE, 120/240V SST(54200.0100)



TF SERVER, 1G DSG
GEN3

Product #:42700.0200



TF SERVER, 1G DSG
NOBASE GEN3

Product #:42700.0250



TF SERVER, 1.5G DSG
GEN3

Product #:42750.0200



TF SERVER, 1.5G DSG
NONBASE GEN3

Product #:42750.0250



TF SERVER, 1G MECH
GEN3

Product #:44000.0200



TF SERVER, 1G MECH
NOBASE GEN3

Product #:44000.0250



TF SERVER, 1.5G MECH
GEN3

Product #:44050.0200



TF SERVER, 1.5G MECH
NOBASE GEN3

Product #:44050.0250



BUNN® reserves the right to change specifications and product design without notice. Such revisions do not entitle the buyer to corresponding changes, improvements, additions or replacements for previously purchased equipment. For most current specifications and other info visit bunn.com.

Created on:
08/13/2018