



# REFRIGERATION

SERVING THE FOOD INDUSTRY SINCE 1951

## HEAVY DUTY GLASS DOOR BOTTLE COOLERS

Item: 50058  
Model: BB-CN-0012-GH

Item: 50060  
Model: BB-CN-0016-GH

Item: 50062  
Model: BB-CN-0020-GH



**KEEP BEVERAGES CHILLED AND READY TO SERVE**

Perfect for any restaurant and/or bar, the heavy duty glass door bottle coolers are designed with enduring quality and value. The exterior comprises of attractive corrosion resistant vinyl on steel in black finish. Electronic control system makes it easy to adjust temperature set point and defrost frequency.



### WARRANTY

2 YEARS PARTS & LABOR  
5 YEARS ONLY ON COMPRESSOR

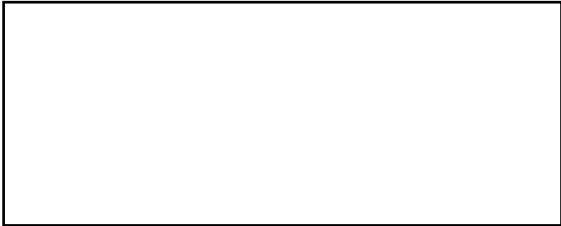

Authorized Dealer

# REFRIGERATION

49-INCH HEAVY DUTY GLASS DOOR BOTTLE COOLER



## Features:

- Durable stainless steel top, interior walls, floor and ceiling
- Exterior construction is attractive corrosion resistant vinyl on steel in black finish
- Self-closing doors with locks
- LED interior lighting
- Adjustable heavy-duty PVC coated shelves
- Electronic control system makes it easy to adjust temperature set point and defrost frequency
- Temperature range from 0-5°C / 33-41°F



## TECHNICAL SPECIFICATION

ITEM NUMBER	50058
MODEL	BB-CN-0012-GH
POWER	1/5 HP
PRODUCT CAPACITY	672 - 12 oz. cans
	2 - kegs
NUMBER OF DOORS	384 - 12 oz. bottles
	2
TEMPERATURE RANGE	33°F - 41°F / 0.5°C - 5°C
CAPACITY	11.8 cu. ft. / 335 L
NUMBER OF SHELVES	4
ELECTRICAL	115V / 60Hz / 1Ph
AMPS	2.88
REFRIGERANT	R290
DIMENSIONS (DWH)	48.8" x 24.4" x 35.6"
	1240 x 620 x 905 mm
INTERIOR DIMENSIONS (DWH)	36 1/4" x 18 1/2" x 30 1/2"
	920 x 470 x 775 mm
PACKAGING DIMENSIONS	51 1/8" x 27 4/8" x 42 3/8"
	1300 x 700 x 1075 mm
WEIGHT	98 kg. / 216 lbs.
PACKAGING WEIGHT	118 kg. / 260 lbs.

## TECHNICAL DRAWING AND DIMENSIONS

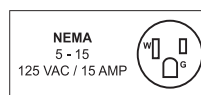
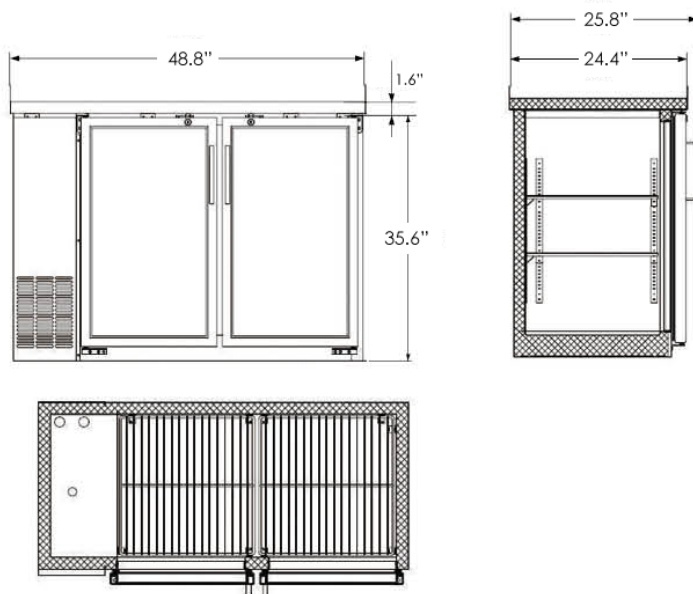

## OMCAN INC.

Telephone: 1-800-465-0234

Fax: (905) 607-0234

Email: sales@omcan.com

Website: www.omcan.com



Follow us to keep up to date with the latest news and offers



2017.E.O.E

# REFRIGERATION

61-INCH HEAVY DUTY GLASS DOOR BOTTLE COOLER



## Features:

- Durable stainless steel top, interior walls, floor and ceiling
- Exterior construction is attractive corrosion resistant vinyl on steel in black finish
- Self-closing doors with locks
- LED interior lighting
- Adjustable heavy-duty PVC coated shelves
- Electronic control system makes it easy to adjust temperature set point and defrost frequency
- Temperature range from 0-5°C / 33-41°F



## TECHNICAL SPECIFICATION

ITEM NUMBER	<b>50060</b>
MODEL	BB-CN-0016-GH
POWER	1/5 HP
PRODUCT CAPACITY	912 - 12 oz. cans
	2 - kegs
NUMBER OF DOORS	2
	TEMPERATURE RANGE
CAPACITY	15.8 cu. ft. / 446 L
NUMBER OF SHELVES	4
ELECTRICAL	115V / 60Hz / 1Ph
AMPS	2.88
REFRIGERANT	R290
DIMENSIONS (WDH)	60.8" x 24.4" x 35.6"
	1544 x 620 x 905 mm
INTERIOR DIMENSIONS (DWH)	20" x 48.2" x 31"
	507 x 1224 x 787 mm
PACKAGING DIMENSIONS	27.6" x 63.4" x 42.3"
	701 x 1610 x 1074 mm
WEIGHT	326 lbs. / 148 kg.
PACKAGING WEIGHT	380 lbs. / 173 kg.

## TECHNICAL DRAWING AND DIMENSIONS

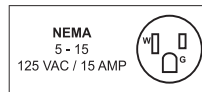
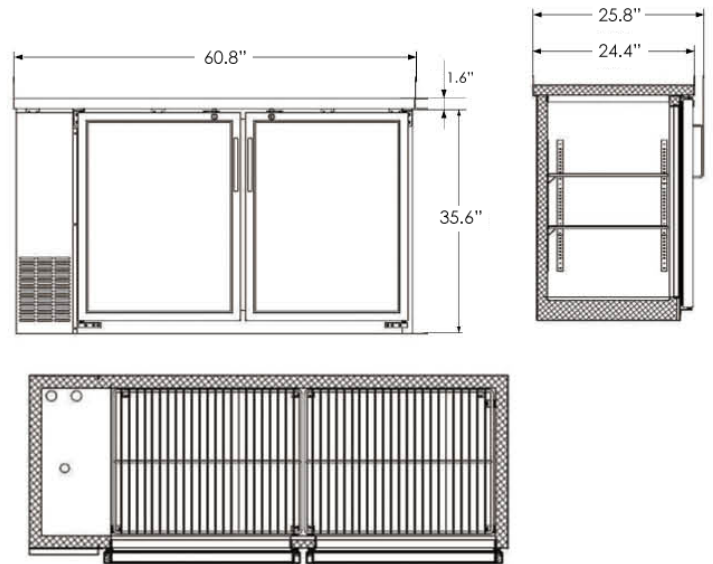

## LIMITED WARRANTY

1 YEAR PARTS AND LABOR  
5 YEARS PARTS ON COMPRESSOR

## OMCAN INC.

Telephone: 1-800-465-0234

Fax: (905) 607-0234

Email: sales@omcan.com

Website: www.omcan.com



Follow us to keep up to date with the latest news and offers



2017.E.O.E

# REFRIGERATION

73-INCH HEAVY DUTY GLASS DOOR BOTTLE COOLER



## Features:

- Durable stainless steel top, interior walls, floor and ceiling
- Exterior construction is attractive corrosion resistant vinyl on steel in black finish
- Self-closing doors with locks
- LED interior lighting
- Adjustable heavy-duty PVC coated shelves
- Electronic control system makes it easy to adjust temperature set point and defrost frequency
- Temperature range from 0-5°C / 33-41°F



## TECHNICAL SPECIFICATION

ITEM NUMBER	<b>50062</b>
MODEL	BB-CN-0020-GH
POWER	1/4+
PRODUCT CAPACITY	1152 - 12 oz. cans
	3 - kegs
NUMBER OF DOORS	624 - 12 oz. bottles
	3
TEMPERATURE RANGE	33°F - 41°F / 0.5°C - 5°C
CAPACITY	19.6 cu. ft. / 556 L
NUMBER OF SHELVES	6
ELECTRICAL	115V / 60Hz / 1Ph
AMPS	3.96
REFRIGERANT	R290
DIMENSIONS (DWH)	72 3/4" x 24 3/8" x 35 5/8" 1848 x 620 x 905 mm
INTERIOR DIMENSIONS (DWH)	60 1/8" x 18 1/2" x 30 1/2" 1528 x 470 x 775 mm
PACKAGING DIMENSIONS	75 2/8" x 27 4/8" x 42 3/8" 1910 x 700 x 1075 mm
WEIGHT	141 kg. / 310 lbs.
PACKAGING WEIGHT	175 kg. / 385 lbs.

## TECHNICAL DRAWING AND DIMENSIONS

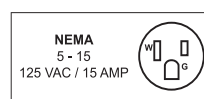
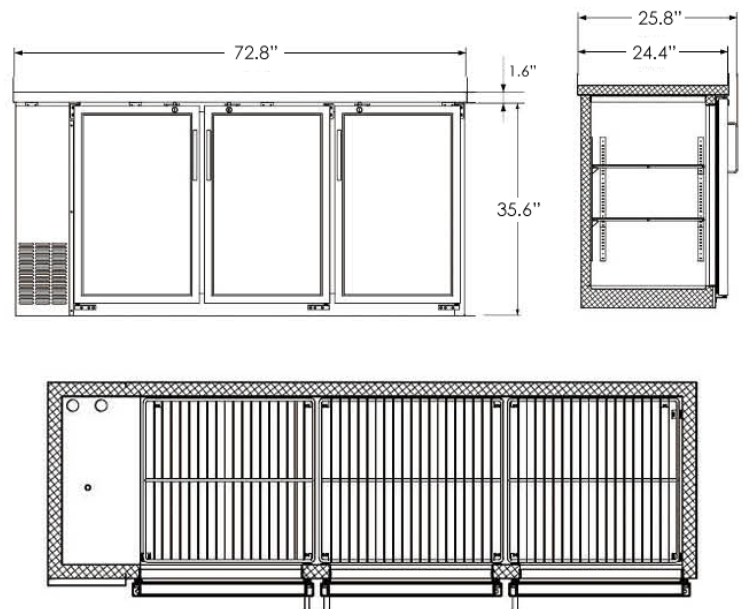

## LIMITED WARRANTY

1 YEAR PARTS AND LABOR  
5 YEARS PARTS ON COMPRESSOR

## OMCAN INC.

Telephone: 1-800-465-0234

Fax: (905) 607-0234

Email: sales@omcan.com

Website: www.omcan.com



Follow us to keep up to date with the latest news and offers



2015.E.O.E