



REFRIGERATION

SERVING THE FOOD INDUSTRY SINCE 1951

128 L COUNTERTOP CURVED GLASS REFRIGERATED DISPLAY

Item: 44260

Model: RS-CN-0128-A



Model RS-CN-0128-A shown

ATTRACTIVELY DISPLAY FOOD MERCHANDISE AND INCREASE IMPULSE SALE

Omcan's Countertop Curved Glass Refrigerated Display is perfect for supermarkets and sandwich shops. Features an attractive smooth finish, curved glass, and stainless steel body. Comes with digital temperature controller and automatic defrost system. The sliding doors at the back allow for easy access to product while still maintaining the quality of the refrigerated merchandise.



WARRANTY

1 YEAR PARTS AND LABOR
5 YEARS PARTS ON COMPRESSOR



SHIPPED ON PALLET

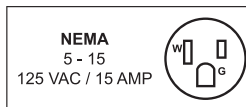

Authorized Dealer

REFRIGERATION

128 L CURVED GLASS REFRIGERATED DISPLAY
ITEM 44260 | MODEL: RS-CN-0128-A



Item 44260 shown

TECHNICAL SPECIFICATIONS

ITEM NUMBER	44260
MODEL	RS-CN-0128-A
TEMPERATURE RANGE	2°C - 8°C / 35.6°F - 46.4°F
CAPACITY (L / CU. FT.)	128 L / 4.52 cu. ft.
POWER	0.345 kW
CURRENT	3.82A
REFRIGERANT	R134a/220g
NUMBER OF SHELVES	2
ELECTRICAL	110V / 60Hz / 1Ph
INTERIOR DIMENSIONS (DWH)	14.25" x 33" x 15" / 361.95 x 838.2 x 381 mm
DIMENSIONS (DWH)	21.25" x 36.37" x 31.5" / 539.75 x 923.80 x 800.1 mm
BASE DIMENSIONS (DWH)	21.5" x 33" x 8.35" / 546.10 x 838.2 x 212.09 mm
PACKAGING DIMENSIONS (DWH)	24" x 39" x 37.8" / 610 x 990 x 960 mm
NET WEIGHT	198.5 lbs. / 90 kg
GROSS WEIGHT	233.7 lbs. / 106 kgs

FEATURES

- Two sliding doors in the back
- Stainless Steel exterior and interior
- Forced air circulation system
- High quality digital temperature controller
- Middle or high back pressure hermetic compressor
- Automatic defrost system
- R134a Gas, Ozone friendly

TECHNICAL DRAWINGS AND DIMENSIONS

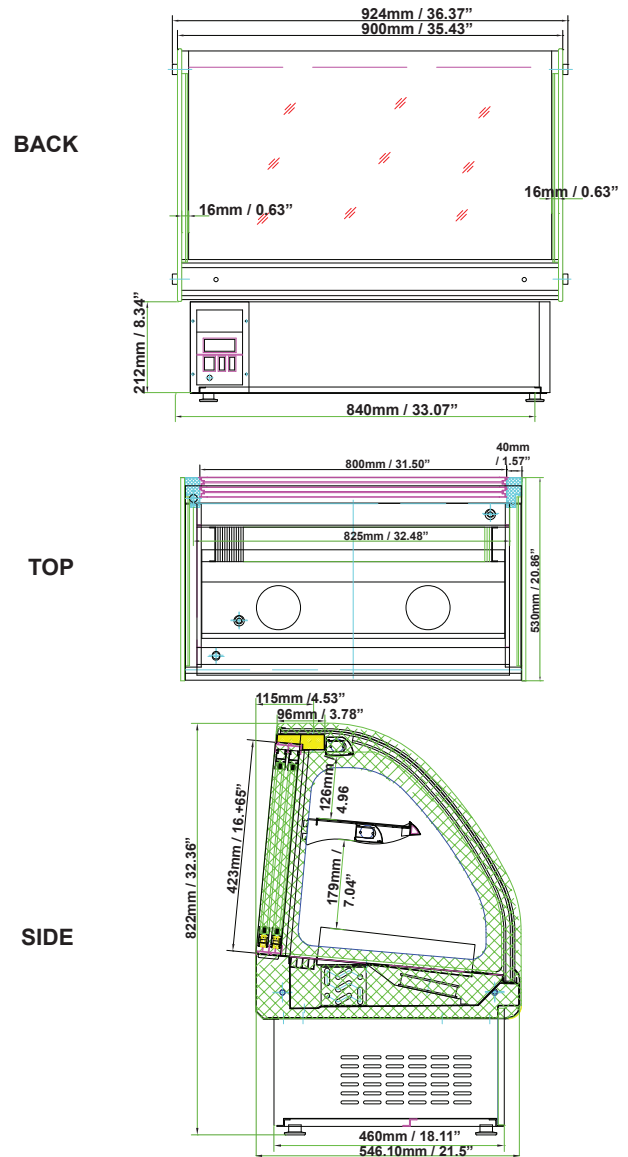

OMCAN INC.

Telephone: 1-800-465-0234
Fax: (905) 607-0234
Email: sales@omcan.com
Website: www.omcan.com



Follow us to keep up to date with the latest news and offers

