



POTATO PEELER PI-10

10 Kg. / 22 pounds load per cycle.



Capacity per load: 22 lbs
Timer (min-max): 0 ' - 6 '
Total loading: 0.75 Hp
Electrical supply: 120V / 60 Hz / 1~ (4 A)
Electrical connection: --

External dimensions (WxDxH)

- ✓ Width: 17.1 "
- ✓ Depth: 25 "
- ✓ Height: 26.3 "

External dimensions with stand

- ✓ Width with stand: 17 "
- ✓ Depth with stand: 25.1 "
- ✓ Height with stand: 41 "

Net weight: 86 lbs

AVAILABLE MODELS

1000608 Potato peeler PI-10 120/60/1

* Ask for special versions availability

SALES DESCRIPTION

Stainless steel construction commercial potato peeler.
Also suitable to peel carrots and other similar products.
0-6 min. timer.
Removable turntable for easy cleaning.

- ✓ Construction in stainless steel.
- ✓ Lateral stirrers covered with silicon carbide abrasive (approved by NSF).
- ✓ Aluminium base plate lined with silicon carbide abrasive (approved by NSF), easily removable for cleaning purposes.
- ✓ Auto-drag of waste to the drain.
- ✓ Energy efficiency owing to engine optimisation.
- ✓ Lifiable transparent polycarbonate cover, complete with locking and safety device.
- ✓ Aluminium door with hermetic seal and safety device.
- ✓ Waterproof control board (IP65): Improved reliability against moisture and water splash.
- ✓ Water inlet system with non-return air break.
- ✓ Auxiliary contact for external electric valve.
- ✓ 0-6min timer and possibility of continuous operation.

OPTIONAL

- Stainless steel floor stand.
- Filter with no-foam feature.

ACCESSORIES

- Stands for potato peelers

SPECIFICATIONS

Hourly production: 450 lbs / 550 lbs



SAMMIC S.p.A.
Basiglio, 1 - 20720 AZZOGNANO
www.sammic.com

Intertek

DYNAMIC PREPARATION
COMMERCIAL FOOD PEELER

product sheet
updated 03/30/23



POTATO PEELER PI-10

10 Kg. / 22 pounds load per cycle.



DYNAMIC PREPARATION
COMMERCIAL FOOD PEELER

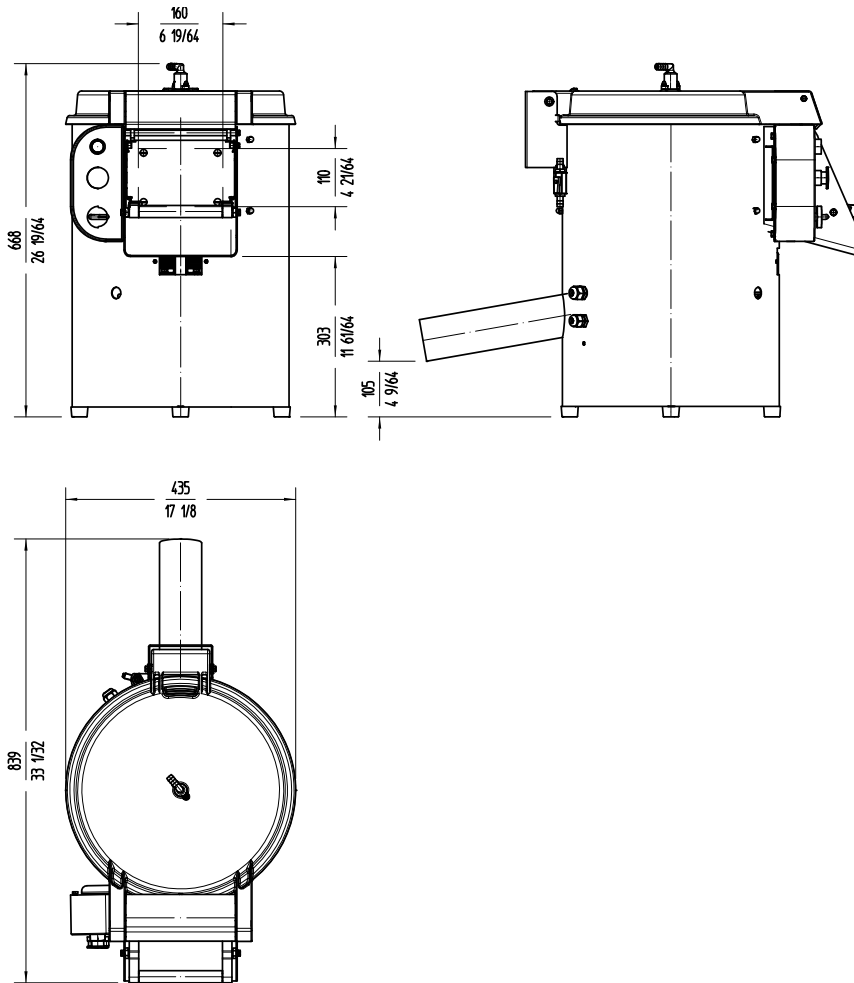

sammic | www.sammic.us
Food Service Equipment Manufacturer

usa@sammic.com
1225 Hartrey Avenue
60202-1056 Evanston, IL

phone +1 (224) 307-2232
toll free +1 844 275 3848



Project	Date
Item	Qty
Approved	

product sheet
updated 03/30/23