



Mee Loft PFD Wear and Use Guide



Image 1.1



Image 1.2

This guide outlines the steps to don and use the Mee Loft PFD. It accompanies the Mee Loft PFD Care and Maintenance guide as well as the most current Australian Parachute Federation Equipment Standard; at the time of writing, No. APF071206-K [Subject: Personal Flotation Device (PFD)]. The Life Jacket is Australian Certified AS4758.1, Level 100. Full manufacturing records are kept at Mee Loft. For any further questions please contact Mee Loft directly.

When ready for wear the PFD bag looks like Image 1.1. Image 1.2 shows what the PFD bladder looks like when removed from the bag. It is important to regularly check the PFD bag to ensure it is free from rips, tears or punctures. This type of damage on the outside covering may indicate that the inflatable chamber has been exposed to damaging elements. PFDs should not be bleached, ironed, dry cleaned, or tumble dried. Handwash with mild detergent only. Store in dry condition, do not expose to sun.

The inflatable chamber should be checked for leaks at the beginning of each season and at least every two months during high use periods. Annual servicing is an APF requirement for recreational use. In the case of commercial use, 6 monthly servicing is recommended. This inflatable PFD does not have inherent buoyancy, it provides flotation only when inflated. Flotation devices only reduce the risk of drowning. They do not guarantee rescue.

How to Wear

Step 1: Wear like a belt, pass waist belt around body and buckle close. Adjust webbing to ensure a snug fit on waist. PFD bag should be at the wearers front. Excess waist belt webbing should be secured with elastic keepers.

Step 2: Unzip pouch completely and remove the PFD bladder. Pull the PFD bladder over the head. Ensure head is through the head hole and chest strap is comfortable. Gas bottle and oral inflation tube should be on the external/visible side of wearer.

Step 3: After donning, locate the Jerk tab for the mechanism (Yellow tab, as seen in Image 1.3). Make sure that you are comfortable locating the Jerk tab with either hand. Inflatable PFDs are very difficult to don when fully inflated. Should an emergency develop, be prepared to use it!

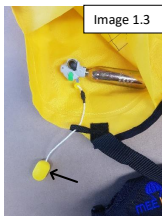

Always wear your PFD OVER, not under clothing. Wear as the outermost garment.

CAUTION: Bulky clothing may affect the ability of this PFD to turn the wearer to a face-up position in the water. Practice closing hardware, and adjusting straps before use or prior to in-water testing.

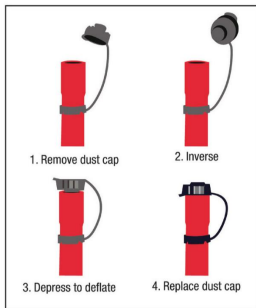

The PFD requires re-arming with a new cylinder after each CO₂ inflation. CO₂ cylinders are good for ONE (1) inflation and cannot be recharged. Inspect CO₂ cylinder for rust. A rusty cylinder needs to be replaced.

The PFD can be manually inflated using the oral tube located on the wearers left side. Grasp the oral tube and bring to mouth. Remove dust cap, blow air through the oral tube until the inflatable chamber is firm. It is important not to fully inflate orally then manually or automatically inflate with the CO₂ cylinder. This will damage the PFD to the point that it will not hold air or float. Do not inflate with a pump or air compressor.

To deflate depress the oral valve (located inside end of oral tube) using the protective dust cap or tab provided by inserting into the end of Oral Tube. Gently

compress air out of the inflatable chamber while depressing the Oral Valve. If for any reason the Oral Valve remains open, depress it several times. If it does not release, discontinue use and contact Mee Loft.

How to Repack

If your PFD is wet, allow it to dry fully before storing it. Follow the images below to pack the PFD bladder back into the PFD bag, for more detailed instructions refer to the Mee Loft Care and Maintenance guide.

