

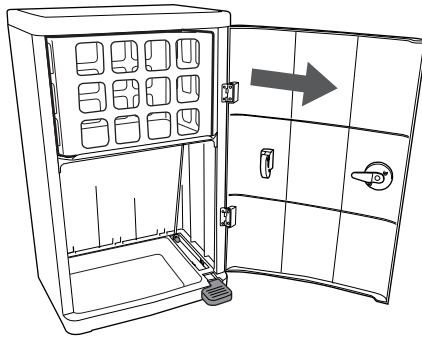

JANIBELL REFILL INSTALLATION INSTRUCTION

1

Open front door and pull out empty refill cartridge.



2

Slide new refill over empty refill cartridge.

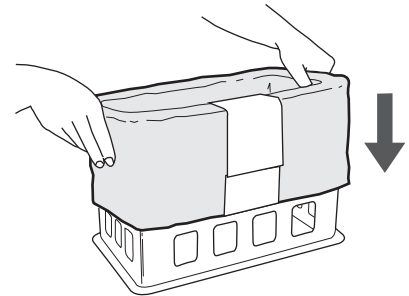

3

Remove the paper band and pull up OUTER LAYER of the refill.

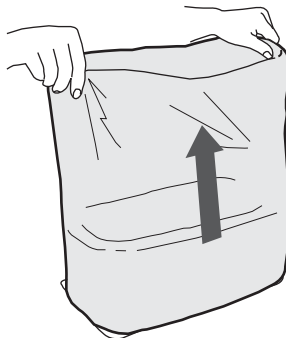

4

Push refill down through the middle of the cartridge.

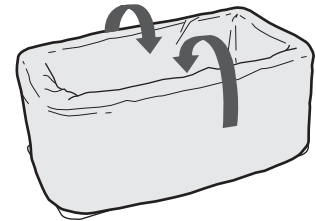

5

Insert the cartridge, with the newly installed refill back into the can.

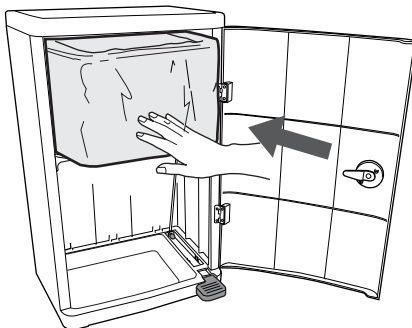

6

Pull refill down and tie a knot.

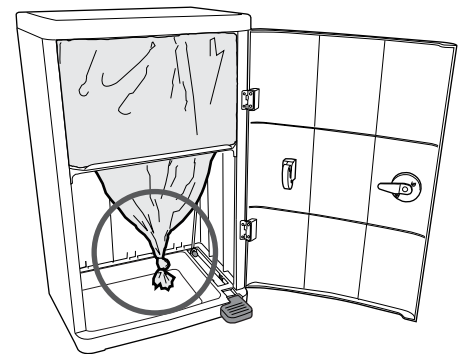

For further assistance please visit www.janibell.com, or, call our Customer Service Department at 1-800-856-0332 Monday through Friday, 7:00 am ~ 3:30 pm PST.



M250H - REFILL INSTALLATION INSTRUCTION

- 1** Lift out empty refill liner cartridge.

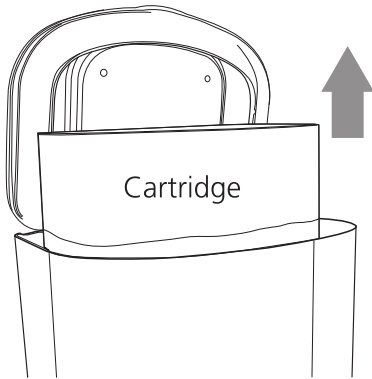

- 2** Slide new refill liner over cartridge.

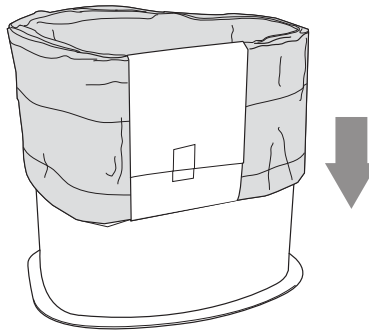

- 3** Remove paper band. Pull up OUTER layer of refill liner.

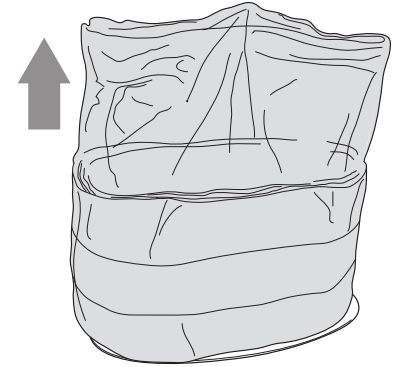

- 4** Pull refill liner down through the middle of the cartridge.

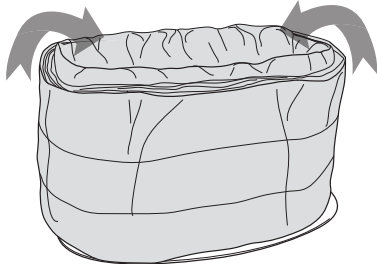

- 5** Return cartridge with curved side towards front of pail.

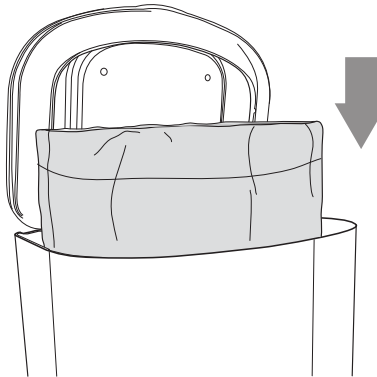

- 6** Pull refill liner down and tie a knot.

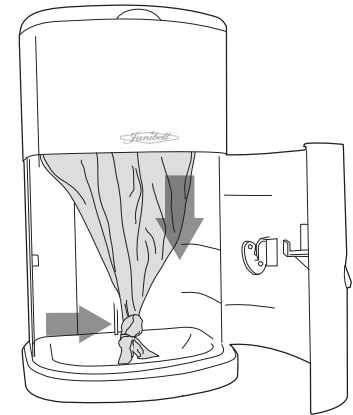

For further assistance please visit www.janibell.com, or, call our Customer Service Department at 1-800-856-0332 Monday through Friday, 7:00 am ~ 3:30 pm PST.

- 1** Open Janibell Mobile and remove empty cartridges.

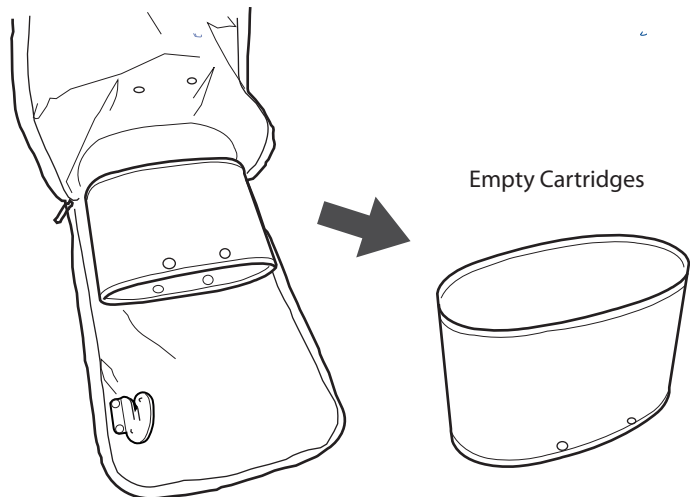

- 2** Slide new refill into both cartridges.

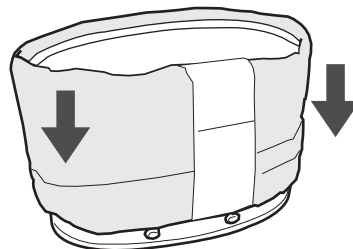

- 3** Remove the paper band and pull up OUTER LAYER of refill and push it down through the middle of the cartridges.

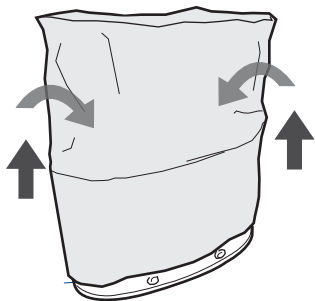

- 4** Re-attach the cartridges, with the newly installed refill.

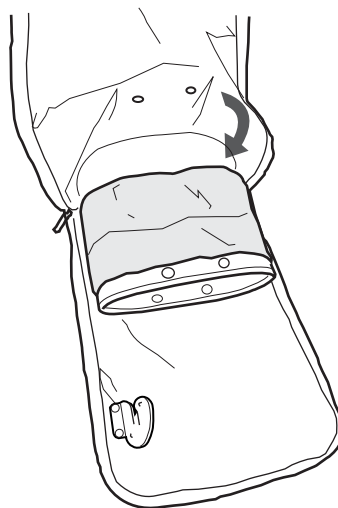

- 5** Pull refill down through the middle of cartridges and tie a knot.

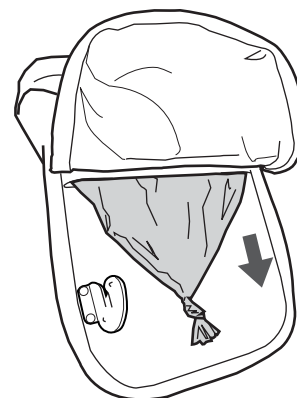

For further assistance please visit www.janibell.com, or, call our Customer Service Department at 1-800-856-0332 Monday through Friday, 7:00 am ~ 3:30 pm PST.