



Chester Machine Tools



2017 Catalogue

KEY TYPE DRILL CHUCKS



Size	Taper	Stock Code	Weight
0.6-6mm	JT1	005-102	0.25kg
1-10mm	JT2	005-104	0.25kg
1-13mm	JT6	005-106	0.5kg
3-16mm	JT6	005-108	0.5kg

KEYLESS DRILL CHUCKS



Size	Taper	Stock Code	Weight
0.5-6mm	JT1		0.25kg
1-10mm	JT2	005-115	0.25kg
1-13mm	JT6	005-114	0.5kg
3-16mm	JT6	005-113	0.5kg

MORSE TAPER DRILL CHUCK ARBORS



Shank	Chuck Taper	Fitting	Stock Code	Weight
MT1	JT1	"	005-202	0.25kg
MT1	JT2	"	005-203	0.25kg
MT1	JT6	"	005-204	0.25kg
MT2	JT1	Tang	005-207	0.25kg
MT2	JT2	"	005-208	0.25kg
MT2	JT6	"	005-209	0.25kg
MT2	JT3	"	005-232	0.25kg
MT3	JT2	"	005-214	0.25kg
MT3	JT6	"	005-215	0.25kg
MT4	JT6	"	005-218	0.5kg

DRILL CHUCK ARBORS-ISO



Shank	Chuck Taper	Fitting	Stock Code	Weight
ISO30	JT6	M12	005-222	0.5kg
ISO40	JT6	M16	005-224	1kg
ISO50	JT6	M24	005-226	3kg

DRILL CHUCK ARBORS-R8



Shank	Chuck Taper	Fitting	Stock Code	Weight
R8	JT6	7/16"	005-220	0.25kg

DRILL CHUCK AND ARBOR SETS



KEYTYPE DRILL CHUCK AND ARBOR

Drill Chuck & Arbor
0.6-6mm/MT1
0.6-6mm/MT2
1-10mm/MT1
1-10mm/MT2
1-10mm/MT3
1-13mm/MT2
1-13mm/MT3
3-16mm/MT2
3-16mm/MT3



KEYLESS DRILL CHUCK & ARBOR

Drill Chuck & Arbor
0.6-6mm/MT1
0.6-6mm/MT2
1-10mm/MT1
1-10mm/MT2
1-10mm/MT3
1-13mm/MT2
1-13mm/MT3
3-16mm/MT2
3-16mm/MT3

CHESTER MILLING COLLET CHUCK SET

These collets will hold plain shank or threaded shank end mills, slot drills and twist drills



CHESTER MILLING COLLET CHUCK SET

Model	Shank	Collets	No. of	Tapping Collets	Stock Code of Shank	Weight
MT2 metric	MT2	4, 5, 6, 8, 10, 12, 14, 16mm	8	M10	003 - 101	2kg
MT3 metric	MT3	4, 5, 6, 8, 10, 12, 14, 16mm	8	M12	003 - 102	2kg
R8 metric	R8	4, 5, 6, 8, 10, 12, 14, 16mm	8	7/16" UNF	003 - 103	2kg
MT2 imperial	MT2	1/8", 3/16", 1/4", 5/16", 3/8", 1/2", 9/16", 5/8"	8	M10	003 - 104	2kg
MT3 imperial	MT3	1/8", 3/16", 1/4", 5/16", 3/8", 1/2", 9/16", 5/8"	8	M12	003 - 105	2kg

ADDITIONAL COLLET SETS

Model	Collets	No. of Collets	Stock code	Weight
Imperial Collets	1/8", 3/16", 1/4", 5/16", 3/8", 1/2", 9/16", 5/8"	8	003 - 204	1kg
Metric Collets	4, 5, 6, 8, 10, 12, 14, 16mm	8	003 - 205	1kg

ADDITIONAL COLLET HOLDERS

Shank	Tapping	Stock Code	Weight
MT2	M10	003 - 201	1kg
MT3	M12	003 - 202	1kg
R8	7/16" UNF	003 - 203	1kg

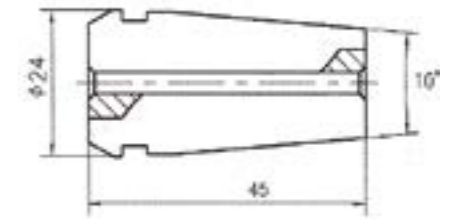

ENDMILL HOLDERS



MORSE TAPER

Size	Tapping	Size	Stock Code
MT3	M12	16mm	057-676
MT3	M12	17mm	057-677
MT3	M12	18mm	057-678
MT3	M12	19mm	057-679
MT3	M12	20mm	057-680
MT3	M12	21mm	057-681
MT3	M12	22mm	057-682
MT3	M12	23mm	057-683
MT3	M12	24mm	057-684
MT3	M12	25mm	057-685

R8 METRIC

Size	Taping	Stock Code
16	7/16	057-110
18	7/16	057-111
20	7/16	057-112
25	7/16	057-115
32	7/16	057-118

R8 IMPERIAL

Size	Taping	Stock Code
5/8	7/16	057-207
11/16	7/16	057-208
3/4	7/16	057-209
7/8	7/16	057-210
1	7/16	057-211
1 1/4	7/16	057-212

ER COLLET SYSTEMS

ER COLLET CHUCKS



Taper	Size	Stock Code	Weight
MT2	ER25	069-021	0.5kg
MT3	ER32	069-071	0.5kg
R8	ER16	069-061	0.5kg
R8	ER25	069-062	0.75kg
R8	ER32	069-063	1kg
R8	ER40	069-064	1kg
ISO30	ER16	069-031	0.5kg
ISO30	ER25	069-032	0.75kg
ISO30	ER32	069-033	1kg
ISO40	ER16	069-041	1kg
ISO40	ER25	069-042	1kg
ISO40	ER32	069-043	1kg
ISO50	ER16	069-051	1.5kg
ISO50	ER25	069-052	1.5kg
ISO50	ER32	069-053	1.5kg

ER COLLETS



Range	ER16	E20	ER25	ER32	ER40	Weight
2-3mm	069-103	069-203	069-303	069-403	069-503	0.25kg
3-4mm	069-104	069-204	069-304	069-404	069-504	0.25kg
4-5mm	069-105	069-205	069-305	069-405	069-505	0.25kg
5-6mm	069-106	069-206	069-306	069-406	069-506	0.25kg
6-7mm	069-107	069-207	069-307	069-407	069-507	0.25kg
7-8mm	069-108	069-208	069-308	069-408	069-508	0.25kg
8-9mm	069-109	069-209	069-309	069-409	069-509	0.25kg
9-10mm	069-110	069-210	069-310	069-4091	069-526	0.25kg
10-11mm	-	069-211	069-311	069-410	069-510	0.25kg
11-12mm	-	069-212	069-312	069-411	069-511	0.25kg
12-13mm	-	069-213	069-313	069-412	069-512	0.25kg
13-14mm	-	-	069-314	069-413	069-513	0.25kg
14-15mm	-	-	069-315	069-414	069-514	0.25kg
15-16mm	-	-	069-316	069-415	069-515	0.25kg
16-17mm	-	-	-	069-416	069-516	0.25kg
17-18mm	-	-	-	069-417	069-517	0.25kg
18-19mm	-	-	-	069-418	069-518	0.25kg
19-20mm	-	-	-	069-419	069-519	0.25kg
20-21mm	-	-	-	-	069-525	0.25kg
21-22mm	-	-	-	-	069-520	0.25kg
22-23mm	-	-	-	-	069-521	0.25kg
23-24mm	-	-	-	-	069-522	0.25kg
24-25mm	-	-	-	-	069-523	0.25kg
25-26mm	-	-	-	-	069-524	0.25kg

ER COLLET CHUCK SPANNERS



Size	Stock Code	Weight
ER16	069-002	0.25kg
ER20	069-003	0.25kg
ER25	069-004	0.25kg
ER32	069-005	0.25kg
ER40	069-006	0.25kg

ER COLLET CHUCK SETS EACH SET INCLUDES COLLETS, SPANNER AND CHUCK



Taper	Size	No of Collets	Size of Collets	Stock Code	Weight
MT2	ER25	6	6,8,10,12,16,20	069-610	2.5kg
MT3	ER32	6	6,8,10,12,16,20	069-611	2.5kg
MT3	ER32	12	3,4,5,6,8,10,12,14,15,16,18,20	069-612	3kg
R8	ER32	6	6,8,10,12,16,20	069-613	2.5kg
R8	ER32	12	3,4,5,6,8,10,12,14,15,16,18,20	069-614	3kg
ISO30	ER32	12	3,4,5,6,8,10,12,14,15,16,18,20	069-615	3kg

COLLET RACKS



Size	Stock Code	Weight
MT1	003-RACK-MT1	0.5kg
MT2	003-RACK-MT2	0.5kg
MT3	003-RACK-MT3	0.5kg

EACH UNIT IS A RIGID STEEL CONSTRUCTION POWDER COATED

R8 COLLETS

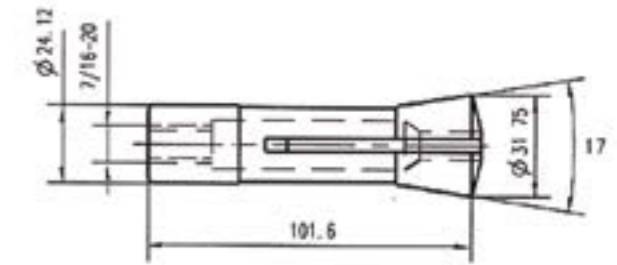

Metric Size	Stock Code	Tapping	Weight
3mm	006-103	7/16"UNF	0.25kg
4mm	006-104	7/16"UNF	0.25kg
5mm	006-105	7/16"UNF	0.25kg
6mm	006-106	7/16"UNF	0.25kg
7mm	006-107	7/16"UNF	0.25kg
8mm	006-108	7/16"UNF	0.25kg
9mm	006-109	7/16"UNF	0.25kg
10mm	006-110	7/16"UNF	0.25kg
11mm	006-111	7/16"UNF	0.25kg
12mm	006-112	7/16"UNF	0.25kg
13mm	006-113	7/16"UNF	0.25kg
14mm	006-114	7/16"UNF	0.25kg
15mm	006-115	7/16"UNF	0.25kg
16mm	006-116	7/16"UNF	0.25kg
17mm	006-117	7/16"UNF	0.25kg
18mm	006-118	7/16"UNF	0.25kg
19mm	006-119	7/16"UNF	0.25kg
20mm	006-120	7/16"UNF	0.25kg

Imperial Size	Stock Code	Tapping	Weight
1/8"	006-203	7/16"UNF	0.25kg
3/16"	006-204	7/16"UNF	0.25kg
1/4"	006-205	7/16"UNF	0.25kg
5/16"	006-206	7/16"UNF	0.25kg
3/8"	006-207	7/16"UNF	0.25kg
7/16"	006-208	7/16"UNF	0.25kg
1/2"	006-209	7/16"UNF	0.25kg
9/16"	006-210	7/16"UNF	0.25kg
5/8"	006-211	7/16"UNF	0.25kg
3/4"	006-212	7/16"UNF	0.25kg
13/16"	006-213	7/16"UNF	0.25kg
7/8"	006-214	7/16"UNF	0.25kg
11/16"	006-215	7/16"UNF	0.25kg

MORSE TAPER COLLETS

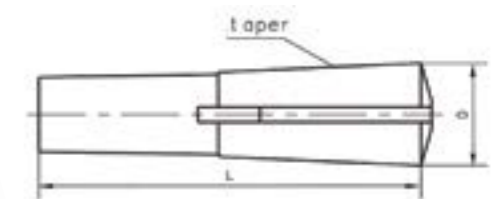

MT1 L = 57mm D = 12.2mm
 MT2 L = 68mm D = 18mm
 MT3 L = 86mm D = 24.1mm

MORSE TAPER 3

Tapping	Size	Stock Code	Weight
M12	1/8"	058-111	0.25kg
M12	1/4"	058-112	0.25kg
M12	5/16"	058-128	0.25kg
M12	3/8"	058-113	0.25kg
M12	1/2"	058-114	0.25kg
M12	9/16"	058-129	0.25kg
M12	5/8"	058-115	0.25kg
M12	3/4"	058-116	0.25kg
M12	3mm	058-126	0.25kg
M12	4mm	058-117	0.25kg
M12	5mm	058-118	0.25kg
M12	6mm	058-119	0.25kg
M12	8mm	058-120	0.25kg
M12	10mm	058-121	0.25kg
M12	12mm	058-122	0.25kg
M12	14mm	058-123	0.25kg
M12	16mm	058-124	0.25kg
M12	18mm	058-125	0.25kg
1/2"	1/8"	058-160	0.25kg
1/2"	1/4"	058-161	0.25kg
1/2"	5/16"	058-162	0.25kg
1/2"	3/8"	058-163	0.25kg
1/2"	1/2"	058-164	0.25kg
1/2"	9/16"	058-165	0.25kg
1/2"	5/8"	058-166	0.25kg
1/2"	3/4"	058-167	0.25kg
1/2"	3mm	058-170	0.25kg
1/2"	4mm	058-171	0.25kg
1/2"	5mm	058-172	0.25kg
1/2"	6mm	058-173	0.25kg
1/2"	8mm	058-174	0.25kg
1/2"	10mm	058-175	0.25kg
1/2"	12mm	058-176	0.25kg
1/2"	14mm	058-177	0.25kg
1/2"	16mm	058-178	0.25kg
1/2"	18mm	058-179	0.25kg

MORSE TAPER 1

Tapping	Size	Stock Code	Weight
M6	2mm	058-002	0.1kg
M6	3mm	058-003	0.1kg
M6	4mm	058-004	0.1kg
M6	6mm	058-006	0.1kg
M6	8mm	058-008	0.1kg

MORSE TAPER 2

Tapping	Size	Stock Code	Weight
M10	1/8"	058-101	0.2kg
M10	1/4"	058-102	0.2kg
M10	3/8"	058-103	0.2kg
M10	1/2"	058-104	0.2kg
M10	4mm	058-105	0.2kg
M10	5mm	058-106	0.2kg
M10	6mm	058-107	0.2kg
M10	8mm	058-108	0.2kg
M10	10mm	058-109	0.2kg
M10	12mm	058-110	0.2kg
3/8"	4mm	058-130	0.2kg
3/8"	5mm	058-130A	0.2kg
3/8"	6mm	058-131	0.2kg
3/8"	8mm	058-132	0.2kg
3/8"	10mm	058-133	0.2kg
3/8"	12mm	058-134	0.2kg
3/8"	1/4"	058-137	0.2kg
3/8"	1/8"	058-138	0.2kg
3/8"	3/8"	058-139	0.2kg
3/8"	1/2"	058-140	0.2kg

CNC TOOLING



Drill Chuck

Range	Shank	Stock Code	Weight
1-13mm	BT40	069-834	0.5kg



ER16



ER32

Collet Chucks

Shank	Fitting	Stock Code	Weight
BT40	ER16	069-835	0.5kg
BT40	ER32	069-836	0.5kg



Shank	Arbor Size	Stock Code	Weight
BT40	6mm	069-800	0.5kg
BT40	8mm	069-801	0.5kg
BT40	10mm	069-802	0.5kg
BT40	12mm	069-803	0.5kg
BT40	16mm	069-804	0.5kg
BT40	20mm	069-805	0.5kg
BT40	25mm	069-806	0.5kg
BT40	32mm	069-807	0.5kg

Morse Taper Shank Tool Holders

Shank	Fitting	Stock Code	Weight
BT40	MT1	069-837	0.5kg
BT40	MT2	069-838	0.5kg
BT40	MT3	069-839	0.5kg
BT40	MT4	069-840	0.5kg



Rigid Tapping Head

Range	Shank	Stock Code	Weight
M3-M14S	BT40	069-808	0.5kg

Tap Adapters

Thread Size	Diameter	Stock Code	Weight
M2	2.8x2.1	069-809	0.5kg
M3	3.5x2.7	069-810	0.5kg
M4	4.5x3.4	069-811	0.5kg
M5/M6	6.0x4.9	069-812	0.5kg
M8	8.0x6.2	069-813	0.5kg
M10	10.0x8.0	069-814	0.5kg
M12	9.0x7.0	069-815	0.5kg

Combi Cutter Holders



Milling Cutter Holder				
Shank	Arbor Size	Stock Code	Weight	
BT40	16mm	069-841	0.25kg	
BT40	22mm	069-842	0.25kg	
BT40	27mm	069-843	0.25kg	
BT40	32mm	069-844	0.25kg	
BT40	40mm	069-845	0.25kg	
Shoulder Milling Cutter Body				
Diameter	Tooth	Mount	Stock Code	Weight
40mm	4	E	069-846	0.5kg
50mm	5	E1	069-847	0.5kg
63mm	6	E2	069-848	0.5kg
100mm	8	E3	069-849	0.5kg
125mm	8	E4	069-850	0.5kg
Face Milling Cutter Body				
Diameter	Tooth	Mount	Stock Code	Weight
50mm	4	E1	069-851	0.5kg
63mm	5	E1	069-852	0.5kg
80mm	6	E2	069-853	0.5kg
100mm	6	E3	069-854	0.5kg
125mm	7	E4	069-855	0.5kg

Milling Cutter Inserts

	Stock Code	Weight
10 inserts for Shoulder Mill	069-856	0.5kg
10 inserts for Face Mill	069-857	0.5kg



Collet Chuck

Fitting	Shank	Stock Code	Weight
ER32	BT40	069-816	0.5kg

Tap Collets

Fitting	Diameter	Stock Code	Weight
ER32	3.5x2.7	069-817	0.5kg
ER32	4.0x3.0	069-818	0.5kg
ER32	4.5x3.4	069-819	0.5kg
ER32	5.5x4.3	069-820	0.5kg
ER32	6.0x4.9	069-821	0.5kg
ER32	7.0x5.5	069-822	0.5kg
ER32	8.0x6.2	069-823	0.5kg
ER32	9.0x7.0	069-824	0.5kg
ER32	10.0x8.0	069-825	0.5kg
ER32	11.0x9.0	069-826	0.5kg
ER32	12.0x9.0	069-827	0.5kg
ER32	14.0x11.0	069-828	0.5kg
ER32	16.0x12.0	069-829	0.5kg
ER32	18.0x14.5	069-830	0.5kg
ER32	20.0x16.0	069-831	0.5kg



	Shank	Stock Code	Weight
Pull Stud (Coolant Hole)	BT40	069-832	0.5kg
Pull Stud (No Coolant Hole)	BT40	069-833	0.5kg

POZI-LOCK COLLET CHUCK SETS

Pozi-Lock Collet Chuck Set with 4 Collets

Model	Shank	Collets	No. of Collets	Tapping of Shank	Stock Code	Weight
MT2 Metric	MT2	6, 10, 12, 16mm	4	M10	004 - 101	2kg
MT3 Metric	MT3	6, 10, 12, 16mm	4	M12	004 - 102	2kg
R8 Metric	R8	6, 10, 12, 16mm	4	7/16" UNF	004 - 103	2kg
ISO 30 Metric	ISO 30	6, 10, 12, 16mm	4	M12	004 - 104	2.5kg
ISO 40 Metric	ISO 40	6, 10, 12, 16mm	4	M16	004 - 105	2.5kg
MT2 Imperial	MT2	1/4" 3/8" 1/2" 5/8"	4	M10	004 - 106	2kg
MT3 Imperial	MT3	1/4" 3/8" 1/2" 5/8"	4	M12	004 - 107	2kg
R8 Imperial	R8	1/4" 3/8" 1/2" 5/8"	4	7/16" UNF	004 - 108	2kg
ISO 30 Imperial	ISO 30	1/4" 3/8" 1/2" 5/8"	4	M12	004 - 109	2.5kg
ISO 40 Imperial	ISO 40	1/4" 3/8" 1/2" 5/8"	4	M16	004 - 110	2.5kg

Each set contains either 4 metric or 4 imperial collets.

Pozi-Lock Collet Chuck Set with 8 Collets

Model	Shank	Collets	No. of Collets	Tapping of Shank	Weight
MT2 Metric	MT2	6, 10, 12, 16mm 1/4" 3/8" 1/2" 5/8"	8	M10	2kg
MT3 Metric	MT3	6, 10, 12, 16mm 1/4" 3/8" 1/2" 5/8"	8	M12	2kg
R8 Metric	R8	6, 10, 12, 16mm 1/4" 3/8" 1/2" 5/8"	8	7/16" UNF	2kg
ISO 30 Metric	ISO 30	6, 10, 12, 16mm 1/4" 3/8" 1/2" 5/8"	8	M12	2.5kg
ISO 40 Metric	ISO 40	6, 10, 12, 16mm 1/4" 3/8" 1/2" 5/8"	8	M16	2.5kg

Each set contains 4 metric and 4 imperial collets.



supplied in plastic case

Taper	Connection	Diameter	Tool Size	Tapping	Stock Code	Weight
MT2	1 1/2" x 18T.P.I	50mm	1/2"	M10	001 - 400	0.5kg
MT3	1 1/2" x 18T.P.I	50mm	1/2"	M12	001 - 401	0.5kg
R8	1 1/2" x 18T.P.I	50mm	1/2"	7/16" UNF	001 - 402	0.5kg
ISO 30	1 1/2" x 18T.P.I	50mm	1/2"	M12	001 - 404	0.5kg
ISO 40	1 1/2" x 18T.P.I	50mm	1/2"	M16	001 - 405	1kg

BORING HEADS



Model	Diameter	Height	Bore	Graduation	Connection	Stock Code	Weight
2" x 1/2"	50mm	61.6mm	1/2"	0.01mm	1 1/2" x 18T.P.I	001 - 101	0.5kg
2" x 12mm	50mm	61.6mm	12mm	0.01mm	1 1/2" x 18T.P.I	001 - 102	0.5kg
3" x 20mm	75mm	80.2mm	3/4"	0.01mm	1 1/2" x 18T.P.I	001 - 103	2kg
4" x 20mm	100mm	93.2mm	1"	0.01mm	1 1/2" x 18T.P.I	001 - 104	4kg

BORING HEAD SHANKS



Taper	Connection	Length	Tapping	Stock Code	Weight
MT2	1 1/2" x 18T.P.I	93mm	M10	001 - 201	0.5kg
MT3	1 1/2" x 18T.P.I	110mm	M12	001 - 202	0.5kg
MT4	1 1/2" x 18T.P.I	133mm	M16	001 - 203	1kg
R8	1 1/2" x 18T.P.I	132.5mm	7/16" UNF	001 - 204	0.5kg
ISO 30	1 1/2" x 18T.P.I	102mm	M12	001 - 205	0.5kg
ISO 40	1 1/2" x 18T.P.I	135mm	M16	001 - 206	1kg

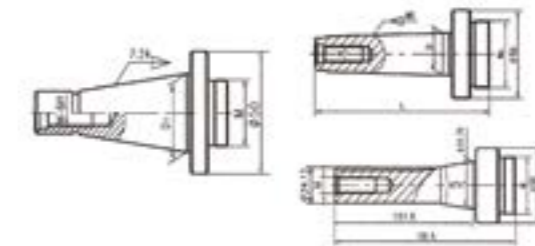

ADDITIONAL CHUCKS

Model	Shank	Thread of Shank	Stock Code	Weight
MT2 Chuck	MT2	M10	004 - 201	1kg
MT3 Chuck	MT3	M12	004 - 202	1kg
R8 Chuck	R8	7/16" UNF	004 - 203	1kg
ISO 30 Chuck	ISO 30	M12	004 - 204	1kg
ISO 40 Chuck	ISO 40	M16	004 - 205	1kg

ADDITIONAL COLLETS

Collet	Stock Code	Weight
10mm	004 - 207	0.25kg
6mm	004 - 208	0.25kg
12mm	004 - 209	0.25kg
16mm	004 - 210	0.25kg
1/4"	004 - 211	0.25kg
3/8"	004 - 212	0.25kg
1/2"	004 - 213	0.25kg
5/8"	004 - 214	0.25kg

All collet chucks are threaded to accept machine drawbar
'Pozi-lock' collet sets are used to hold threaded shank end mills and slot drills.

BORING & FACING HEAD

SPECIFICATION

Model	BFH212A	BFH213A	BFH214A
Max. Facing and Boring Diameter	150mm	350mm	450mm
Max. Stroke of Slide	+/- 15mm	+/- 25mm	+/- 50mm
Fine Feed per Graduation	0.005mm	0.005mm	0.005mm
Manual Feed per Revolution	2mm	3mm	3mm
Self-acting Feed per Revolution	0.02, 0.04, 0.06, 0.08, 0.10, 0.12 mm	0.03, 0.06, 0.09, 0.12, 0.15, 0.18 mm	0.03, 0.06, 0.09, 0.12, 0.15, 0.18 mm
Diameter of Tool Post Holes in Slide	18mm	22mm	22mm
Maximum Diameter of Slide	90mm	120mm	168mm
Height of Head Without Shank	87.5mm	118mm	118mm
Weight of Head Without Shank	2.9kgs	6.1kgs	7.8kgs
Length of Sliding Block (L)	75mm	105mm	160mm
Width of Sliding Block (B)	70mm	90mm	90mm
ID of Bushing	4, 8, 12mm	8, 10, 12, 14mm	8, 10, 12, 14mm
Stock Code	001-111	001-112	001-113



Available Shanks
R8
MT3-6
ISO,CT,BT 30, 40, 45, 50
TZ10
MTW3-6
DIN40, 45, 50
Metric 80
ISO,ST 40, 45, 50
TZ32, 40, 45

BORING TOOLS



Size	Nos. of Pieces	Stock Code	Weight
3/8"	9	001 - 341	0.5kg
1/2"	9	001 - 342	0.5kg
5/8"	12	001 - 343	1kg
3/4"	12	001 - 344	2.5kg

BORING BARS & HOLDERS



BORING BARS

Dia of Bar	Length	Size for Toolbit (square)	Stock Code	Weight
3/8"	4"	1/8"	001 - 370	0.25kg
3/8"	6"	1/8"	001 - 371	0.25kg
1/2"	9"	3/16"	001 - 372	0.25kg
3/4"	12"	1/4"	001 - 373	0.5kg
1"	12"	5/16"	001 - 374	1kg

BORING BAR HOLDERS

Dia: of Bar	External Section	Stock Code	Weight
3/8"	1/2"	001 - 391	0.25kg
1/2"	5/8"	001 - 392	0.5kg
3/4"	1"	001 - 393	0.5kg

POZI-LOCK COLLET CHUCK SETS

Pozi-Lock Collet Chuck Set with 4 Collets

Model	Shank	Collets	No. of Collets	Tapping of Shank	Stock Code	Weight
MT2 Metric	MT2	6, 10, 12, 16mm	4	M10	004 - 101	2kg
MT3 Metric	MT3	6, 10, 12, 16mm	4	M12	004 - 102	2kg
R8 Metric	R8	6, 10, 12, 16mm	4	7/16" UNF	004 - 103	2kg
ISO 30 Metric	ISO 30	6, 10, 12, 16mm	4	M12	004 - 104	2.5kg
ISO 40 Metric	ISO 40	6, 10, 12, 16mm	4	M16	004 - 105	2.5kg
MT2 Imperial	MT2	1/4" 3/8" 1/2" 5/8"	4	M10	004 - 106	2kg
MT3 Imperial	MT3	1/4" 3/8" 1/2" 5/8"	4	M12	004 - 107	2kg
R8 Imperial	R8	1/4" 3/8" 1/2" 5/8"	4	7/16" UNF	004 - 108	2kg
ISO 30 Imperial	ISO 30	1/4" 3/8" 1/2" 5/8"	4	M12	004 - 109	2.5kg
ISO 40 Imperial	ISO 40	1/4" 3/8" 1/2" 5/8"	4	M16	004 - 110	2.5kg

Each set contains either 4 metric or 4 imperial collets.

Pozi-Lock Collet Chuck Set with 8 Collets

Model	Shank	Collets	No. of Collets	Tapping of Shank	Weight
MT2 Metric	MT2	6, 10, 12, 16mm 1/4" 3/8" 1/2" 5/8"	8	M10	2kg
MT3 Metric	MT3	6, 10, 12, 16mm 1/4" 3/8" 1/2" 5/8"	8	M12	2kg
R8 Metric	R8	6, 10, 12, 16mm 1/4" 3/8" 1/2" 5/8"	8	7/16" UNF	2kg
ISO 30 Metric	ISO 30	6, 10, 12, 16mm 1/4" 3/8" 1/2" 5/8"	8	M12	2.5kg
ISO 40 Metric	ISO 40	6, 10, 12, 16mm 1/4" 3/8" 1/2" 5/8"	8	M16	2.5kg

Each set contains 4 metric and 4 imperial collets.



supplied in plastic case

Taper	Connection	Diameter	Tool Size	Tapping	Stock Code	Weight
MT2	1 1/2" x 18T.P.I	50mm	1/2"	M10	001 - 400	0.5kg
MT3	1 1/2" x 18T.P.I	50mm	1/2"	M12	001 - 401	0.5kg
R8	1 1/2" x 18T.P.I	50mm	1/2"	7/16" UNF	001 - 402	0.5kg
ISO 30	1 1/2" x 18T.P.I	50mm	1/2"	M12	001 - 404	0.5kg
ISO 40	1 1/2" x 18T.P.I	50mm	1/2"	M16	001 - 405	1kg

BORING HEADS



Model	Diameter	Height	Bore	Graduation	Connection	Stock Code	Weight
2" x 1/2"	50mm	61.6mm	1/2"	0.01mm	1 1/2" x 18T.P.I	001 - 101	0.5kg
2" x 12mm	50mm	61.6mm	12mm	0.01mm	1 1/2" x 18T.P.I	001 - 102	0.5kg
3" x 20mm	75mm	80.2mm	3/4"	0.01mm	1 1/2" x 18T.P.I	001 - 103	2kg
4" x 20mm	100mm	93.2mm	1"	0.01mm	1 1/2" x 18T.P.I	001 - 104	4kg

BORING HEAD SHANKS



Taper	Connection	Length	Tapping	Stock Code	Weight
MT2	1 1/2" x 18T.P.I	93mm	M10	001 - 201	0.5kg
MT3	1 1/2" x 18T.P.I	110mm	M12	001 - 202	0.5kg
MT4	1 1/2" x 18T.P.I	133mm	M16	001 - 203	1kg
R8	1 1/2" x 18T.P.I	132.5mm	7/16" UNF	001 - 204	0.5kg
ISO 30	1 1/2" x 18T.P.I	102mm	M12	001 - 205	0.5kg
ISO 40	1 1/2" x 18T.P.I	135mm	M16	001 - 206	1kg

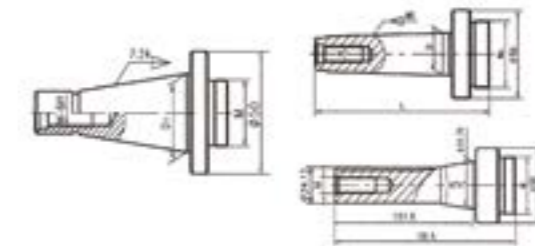

ADDITIONAL CHUCKS

Model	Shank	Thread of Shank	Stock Code	Weight
MT2 Chuck	MT2	M10	004 - 201	1kg
MT3 Chuck	MT3	M12	004 - 202	1kg
R8 Chuck	R8	7/16" UNF	004 - 203	1kg
ISO 30 Chuck	ISO 30	M12	004 - 204	1kg
ISO 40 Chuck	ISO 40	M16	004 - 205	1kg

ADDITIONAL COLLETS

Collet	Stock Code	Weight
10mm	004 - 207	0.25kg
6mm	004 - 208	0.25kg
12mm	004 - 209	0.25kg
16mm	004 - 210	0.25kg
1/4"	004 - 211	0.25kg
3/8"	004 - 212	0.25kg
1/2"	004 - 213	0.25kg
5/8"	004 - 214	0.25kg

All collet chucks are threaded to accept machine drawbar
'Pozi-lock' collet sets are used to hold threaded shank end mills and slot drills.

BORING & FACING HEAD

SPECIFICATION

Model	BFH212A	BFH213A	BFH214A
Max. Facing and Boring Diameter	150mm	350mm	450mm
Max. Stroke of Slide	+/- 15mm	+/- 25mm	+/- 50mm
Fine Feed per Graduation	0.005mm	0.005mm	0.005mm
Manual Feed per Revolution	2mm	3mm	3mm
Self-acting Feed per Revolution	0.02, 0.04, 0.06, 0.08, 0.10, 0.12 mm	0.03, 0.06, 0.09, 0.12, 0.15, 0.18 mm	0.03, 0.06, 0.09, 0.12, 0.15, 0.18 mm
Diameter of Tool Post Holes in Slide	18mm	22mm	22mm
Maximum Diameter of Slide	90mm	120mm	168mm
Height of Head Without Shank	87.5mm	118mm	118mm
Weight of Head Without Shank	2.9kgs	6.1kgs	7.8kgs
Length of Sliding Block (L)	75mm	105mm	160mm
Width of Sliding Block (B)	70mm	90mm	90mm
ID of Bushing	4, 8, 12mm	8, 10, 12, 14mm	8, 10, 12, 14mm
Stock Code	001-111	001-112	001-113



Available Shanks
R8
MT3-6
ISO,CT,BT 30, 40, 45, 50
TZ10
MTW3-6
DIN40, 45, 50
Metric 80
ISO,ST 40, 45, 50
TZ32, 40, 45

BORING TOOLS



Size	Nos. of Pieces	Stock Code	Weight
3/8"	9	001 - 341	0.5kg
1/2"	9	001 - 342	0.5kg
5/8"	12	001 - 343	1kg
3/4"	12	001 - 344	2.5kg

BORING BARS & HOLDERS



BORING BARS

Dia of Bar	Length	Size for Toolbit (square)	Stock Code	Weight
3/8"	4"	1/8"	001 - 370	0.25kg
3/8"	6"	1/8"	001 - 371	0.25kg
1/2"	9"	3/16"	001 - 372	0.25kg
3/4"	12"	1/4"	001 - 373	0.5kg
1"	12"	5/16"	001 - 374	1kg

BORING BAR HOLDERS

Dia: of Bar	External Section	Stock Code	Weight
3/8"	1/2"	001 - 391	0.25kg
1/2"	5/8"	001 - 392	0.5kg
3/4"	1"	001 - 393	0.5kg

5C COLLETS

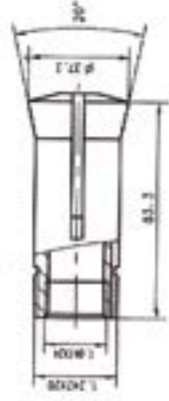

Metric Size	Stock Code	Weight
3mm	068 - 103	0.25kg
4mm	068 - 104	0.25kg
5mm	068 - 105	0.25kg
6mm	068 - 106	0.25kg
7mm	068 - 107	0.25kg
8mm	068 - 108	0.25kg
9mm	068 - 109	0.25kg
10mm	068 - 110	0.25kg
11mm	068 - 111	0.25kg
12mm	068 - 112	0.25kg
13mm	068 - 113	0.25kg
14mm	068 - 114	0.25kg
15mm	068 - 115	0.25kg
16mm	068 - 116	0.25kg
17mm	068 - 117	0.25kg
18mm	068 - 118	0.25kg
19mm	068 - 119	0.25kg
20mm	068 - 120	0.25kg
21mm	068 - 121	0.25kg
22mm	068 - 122	0.25kg
23mm	068 - 123	0.25kg
24mm	068 - 124	0.25kg
25mm	068 - 125	0.25kg

Imperial Size	Stock Code	Weight
1/8"	068 - 202	0.25kg
3/16"	068 - 203a	0.25kg
1/4"	068 - 204	0.25kg
5/16"	068 - 205	0.25kg
3/8"	068 - 206	0.25kg
7/16"	068 - 207	0.25kg
1/2"	068 - 208	0.25kg
9/16"	068 - 209	0.25kg
5/8"	068 - 210	0.25kg
11/16"	068 - 211	0.25kg
3/4"	068 - 212	0.25kg
13/16"	068 - 213	0.25kg
7/8"	068 - 214	0.25kg
15/16"	068 - 215	0.25kg
1"	068 - 216	0.25kg



5C EMERGENCY COLLETS

	Stock Code	Weight
Steel	068 - 001	0.25kg
Brass	068 - 002	0.25kg
Nylon	068 - 003	0.01kg

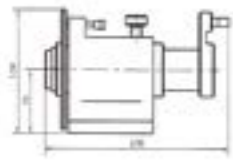

5C SPIN INDEXING UNIT

Stock Code	Weight
068 - 308	6.5kg



Stock Code	Weight
068 - 309	1.5kg

5C COLLET STOP

Stock Code	Weight



5C EXPANDING COLLETS

	Stock Code	Weight
Set of 4 Pieces 1/4" to 1 7/8"	068 - 031	3kg

5C H/V FIXTURE

Stock Code	Weight
068 - 303	5kg



5C PRECISION INDEXER

Stock Code	Weight
068 - 310	13kg



REDUCING SLEEVES



Outside Taper	Inside Taper	Fitting	Stock Code	Weight
MT2	MT1	open	013-100	0.1kg
MT2	MT1	tang	013-101	0.1kg
MT3	MT1	tang	013-102	0.2kg
MT3	MT2	tang	013-103	0.1kg
MT3	MT2	open	013-104	0.1kg
MT4	MT2	tang	013-105	0.5kg
MT4	MT3	tang	013-106	0.5kg
MT4	MT3	open	013-107	0.3kg
MT5	MT2	tang	013-108	1.4kg
MT5	MT3	tang	013-109	1.3kg
MT5	MT3	open	013-110	1.3kg
MT5	MT4	tang	013-111	0.9kg
MT5	MT4	open	013-112	0.9kg
MT6	MT3	open	013-113	3.5kg
MT6	MT4	open	013-114	3.1kg
R8	MT1	7/16" UNF	013-116	0.4kg
R8	MT2	7/16" UNF	013-117	0.4kg
R8	MT3	7/16" UNF	013-118	0.4kg
ISO 30	MT1	M12	013-128	0.8kg
ISO 30	MT2	M12	013-119	0.8kg
ISO 30	MT3	M12	013-120	0.8kg
ISO 40	MT1	M16	013-130	0.8kg
ISO 40	MT2	M16	013-121	0.8kg
ISO 40	MT3	M16	013-122	0.8kg
ISO 40	R8	M16	013-127	0.8kg
ISO 50	MT1	M24	013-131	3kg
ISO 50	MT2	M24	013-123	2.9kg
ISO 50	MT3	M24	013-124	2.5kg
ISO 50	MT4	M24	013-125	2.5kg
ISO 50	MT5	M24	013-126	3.2kg
ISO 50	R8	M24	013-129	3kg

STEP UP SLEEVES



Outside Taper	Inside Taper	Fitting	Stock Code	Length	Diameter	Weight
MT1	MT2	tang	013-143	160mm	30mm	0.5kg
MT2	MT3	tang	013-140	196mm	30mm	0.6kg
MT3	MT4	tang	013-141	240mm	48mm	1.5kg
MT4	MT5	tang	013-142	300mm	63mm	3.1kg

STUB MILLING ARBORS



Shank	Diameter	Tapping	D1	D2	L	L1	Weight	Stock Code
MT2	22mm	M10	17.78mm	22mm	171mm	63mm	0.5kg	060-101
MT3	22mm	M12	17.78mm	22mm	206mm	63mm	0.6kg	060-102
R8	22mm	7/16"	22mm		206mm	63mm	0.7kg	060-103
MT2	1"	M10	23.82mm	25.4mm	157mm	50.8mm	0.5kg	060-104
MT3	1"	M12	23.82mm	25.4mm	175mm	50.8mm	0.6kg	060-105
R8	1"	7/16"	25.4mm		192mm	50.8mm	1kg	060-106
R8	1 1/4"	7/16"	13.75mm		196mm	50.8mm	1kg	060-107

COMBINATION SHELL END MILL ARBORS



Spindle Taper	Tapping	Diameter	Stock Code	Weight
MT3	M12	1"	044 - 013	1kg
MT3	M10	22mm	044 - 016	1kg
R8	7/16"	1"	044 - 023	1kg
R8	7/16"	22mm	044 - 026	1kg
R8	7/16"	27mm	044 - 027	1kg
ISO30	M12	1"	044 - 033	1.5kg
ISO30	M12	22mm	044 - 036	1.5kg
ISO30	M12	27mm	044 - 037	1.5kg
ISO40	M16	1"	044 - 043	2kg
ISO40	M16	22mm	044 - 046	2kg
ISO40	M16	27mm	044 - 047	2kg
ISO50	M24	1"	044 - 053	4kg
ISO50	M24	22mm	044 - 056	4kg
ISO50	M24	27mm	044 - 057	4kg

LONG MILLING ARBORS



Spindle Taper	Length	Diameter	Weight	Stock Code
ISO 30	315mm	1"	4kg	060 - 203
ISO 40	315mm	1"	5kg	060 - 204
ISO 40	415mm	1"	5kg	060 - 205
ISO 40	515mm	1"	7kg	060 - 206

SHELL END MILL ARBORS

Spindle Taper	Tapping	Diameter	Stock Code	Weight
R8	7/16" unf	1"	044 - 004	1kg
MT3	M12	1"	044 - 003	1kg

AUTO REVERSE TAPPING HEAD



Model	Capacity	Torque Setting	Arbors Supplied as Standard	Weight	Stock Code
Tap 7	M2 - M7	4	MT2 - MT3	1.5kg	002 - 101
Tap 12	M5 - M12	4	MT3 - MT4	3kg	002 - 102
Tap 20	M8 - M20	4	MT3 - MT4	6kg	002 - 103
Spare Collet	M2			0.1kg	002 - 104
Spare Collet	M7			0.1kg	002 - 105
Spare Collet	M5			0.1kg	002 - 106
Spare Collet	M12			0.1kg	002 - 107
Spare Collet	M8			0.1kg	002 - 108
Spare Collet	M20			0.1kg	002 - 109

MULTI HEAD TAILSTOCK

Economical method of producing repeat work on a conventional lathe. This simple multi tool holder reduces tool change, and setup time. Available in MT1, MT2, MT3, MT4 shanks.

Taper	Stock Code	Weight
MT1	055-201	5kgs
MT2	055-202	5kgs
MT3	055-203	5.5kgs
MT4	055-204	5.5kgs



ACCESSORIES

- Reaming Collet
- 2 Drill Chucks
- Live Center
- Tapping Collet
- Die Holder

QUICK CHANGE TOOLPOSTS

Model	Size A	Size B	Size C	Size D	Stock Code	Weight
Piston T-1	63.5mm	94.45mm	57.15mm	14.29mm	009 - 250-100	2kg
Dovetail T-2	76.2mm	117.46mm	69.85mm	15.88mm	009 - 250-200	4kg
Dovetail T-3	82.55mm	130.18mm	76.2mm	19.05mm	009 - 250-300	6kg
Dovetail T-4	123.85mm	158.75mm	92.06mm	22.26mm	009 - 250-400	8kg

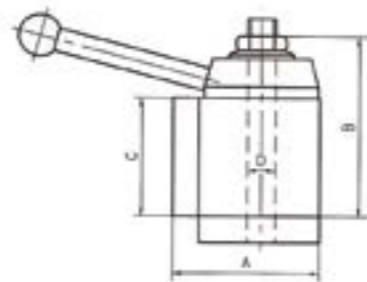

All Toolposts will require some machining by the customer to fit the individual lathe. Toolposts bought when purchasing a lathe can be fitted prior to despatch..

QUICK CHANGE TOOLHOLDERS

SQUARE TURNING AND FACING HOLDER

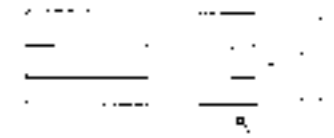

A	B	C	D	Tool Bit Range	Maximum Tool Size	To Fit Toolpost	Stock Code	Weight
11.8mm	17.70mm	25.40mm	38.10mm	4.76-12.7	12mm	T-1	009-250-101	0.5 kg
12.7mm	15.88mm	27.78mm	44.45mm	6.3-15.9	16.5mm	T-2	009-250-201	0.5 kg
15.88mm	19.05mm	38.89mm	53.98mm	12.7-19.05	19.5mm	T-3	009-250-301	1.5 kg
19.05mm	25.40mm	43.66mm	63.50mm	12.7-25.4	26mm	T-4	009-250-401	1.5 kg

VEE TURNING BORING AND FACING HOLDER HOLDER



A	B	C	D	Tool Bit Range	Maximum Tool Size	To Fit Toolpost	Stock Code	Weight
11.8mm	17.70mm	25.40mm	38.10mm	4.76-12.7	12mm	T-1	009-250-102	0.5 kg
12.7mm	15.88mm	27.78mm	44.45mm	6.3-15.9	16.5mm	T-2	009-250-202	0.5 kg
15.88mm	19.05mm	38.89mm	53.98mm	12.7-19.05	19.5mm	T-3	009-250-302	1.5 kg
19.05mm	25.40mm	43.66mm	63.50mm	12.7-25.4	26mm	T-4	009-250-402	1.5 kg

HEAVY DUTY BORING BAR HOLDER



A	B	C	D	Maximum Tool Size	To Fit Toolpost	Stock Code	Weight
19.05mm	38.1mm	15.88mm	19.05mm	19.05mm	T-1	009-250-141	1.0 kg
25.4mm	50.8mm	19.05mm	25.4mm	25.4mm	T-2	009-250-241	3.0 kg
25.4mm	50.8mm	25.4mm	31.7mm	25.4mm	T-3	009-250-341	3.0 kg

UNIVERSAL PARTING BLADE HOLDER

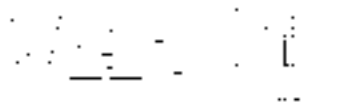

A	B	C	Blade Height	To Fit Toolpost	Stock Code	Weight
4.76mm	12.7mm	38.1mm	12.7mm	T-1	009-250-107	0.5 kg
4.76mm	26.99mm	44.45mm	26.99mm	T-2	009-250-207	0.5 kg
4.76mm	19.05mm	50.8mm	19.05mm	T-3	009-250-307	1.5 kg
6.3mm	22.23mm	63.5mm	22.23mm	T-4	009-250-407	2.0 kg

MORSE TAPER HOLDER FOR DRILLING

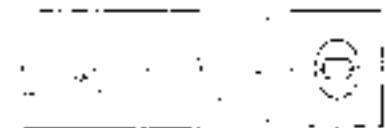

A	B	Maximum Tool Size	To Fit Toolpost	Stock Code	Weight
19.05mm	38.1mm	MT3	T-1	009-250-153	1.0 kg
22.23mm	44.45mm	MT3	T-2	009-250-253	1.0 kg
26.99mm	53.98mm	MT4	T-3	009-240-354	2.5 kg
31.7mm	63.5mm	MT4	T-4	009-250-454	2.5 kg

KNURLING TOOL

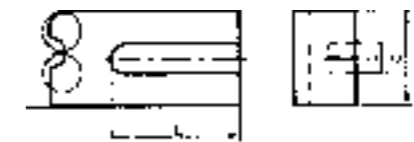





A	B	C	D	Maximum Tool Size	To Fit Toolpost	Stock Code	Weight
22.23mm	63.5mm	39.69mm	12.7mm	n/a	T-1	009-250-110	0.5 kg
25.4mm	41.28mm	44.45mm	15.9mm	n/a	T-2	009-250-210	0.5 kg
20.64mm	79.38mm	50.8mm	19.05mm	n/a	T-3	009-250-310	1.5 kg
39.08mm	95.25mm	63.5mm	25.4mm	n/a	T-4	009-250-410	2.0 kg



Chester Machine Tools

Head Office
Chester Machine Tools
Clywd Close
Hawarden Industrial Park
Hawarden
Chester
CH5 3PZ
United Kingdom

Midlands Office
Chester Machine Tools
Unit 4 Plant Lane Business Park
Plant Lane
Burntwood
Staffordshire
WS7 3GN
United Kingdom

 www.chestermachinetools.com
 sales@chestermachinetools.com
 +44 (0) 1244 531631
 +44 (0) 1244 531331

