

**DAWSON
61" CAST IRON
DOUBLE ROLL TUB**

Cat. No.
CTDRN61LP



L: 60 3/4"
W: 30 3/8"
H: 23 7/8" (from floor to top of tub)

Water depth: 14 1/2" to overflow

The following is recommended for CTDRN61LP tubs:

- Faucet: part #4602, 7393 or 7410
- Rigid, freestanding supplies: part #4502
- Leg tub drain: part #5599

Gallon Capacity: 30
Shipping Weight: 450 lbs.
Empty Weight: 270 lbs.
Filled Weight: 521 lbs.

Features:

- ▶ Inside finish is white enamel
- ▶ Elegant cast iron lion paw feet available in 5 finishes
- ▶ Tub exterior is white (epoxy)
- ▶ No faucet holes
- ▶ Feet are attached and leveled before shipment
- ▶ Tub is thoroughly inspected before shipment

Foot Finishes:

- BP** Polished Brass
- SN** Brushed Nickel
- CP** Polished Chrome
- WH** White
- ORB** Oil-rubbed Bronze



Custom Colors Available (inside of tub is always white enamel):
Painted bathtubs are considered "special order" and are not returnable
\$160 Bisque or Black \$250 Designer Color

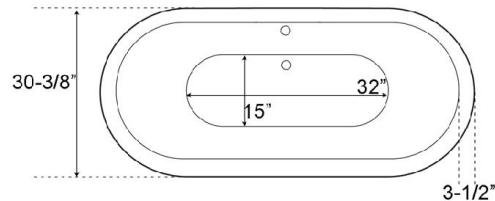
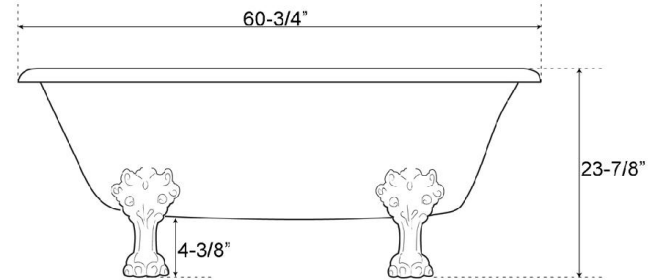

Dimensions of fixture are nominal and may vary within the range of tolerances established by ANSI Standard A112.19.2. Dimensions and specifications subject to change without notice.