

**BAROQUE
70" ACRYLIC
ROLL TOP TUB**

Cat. No.
ATR70LP



L: 69 1/2"
W: 31 1/2"
H: 23 1/2"

Water depth: 10" to overflow

Compliance Certification
Meets or exceeds the following specifications: ASME A112.19.2 2013 and CSA B45.1-13 for ceramic plumbing fixtures.

The following is recommended for ATR tubs:

- Tub wall-mounted faucets **4022, 4025 nor 4035**
- Double offset bath supplies: part **#5576**
- Leg tub drain: part **#5599**

Do not use with rigid, freestanding supplies

Gallon Capacity: 35
Shipping Weight: 375 lbs.
Empty Weight: 150 lbs.
Filled Weight: 443 lbs.

Features:

- ▶ Acrylic construction for lighter weight
- ▶ Cast aluminum lion paw feet available in 4 finishes
- ▶ 3-3/8" centers in tub wall
- ▶ Overflow is drilled
- ▶ Tub feet are attached and leveled before shipment
- ▶ Tub is thoroughly inspected before shipment

Feet Finishes:

- BN** Brushed Nickel
- CP** Polished Chrome
- PB** Polished Brass
- ORB** Oil Rubbed Bronze



Custom Colors Available (inside of tub is always white enamel):
Painted bathtubs are considered "special order" and are not returnable
\$160 Bisque or Black \$250 Designer Color

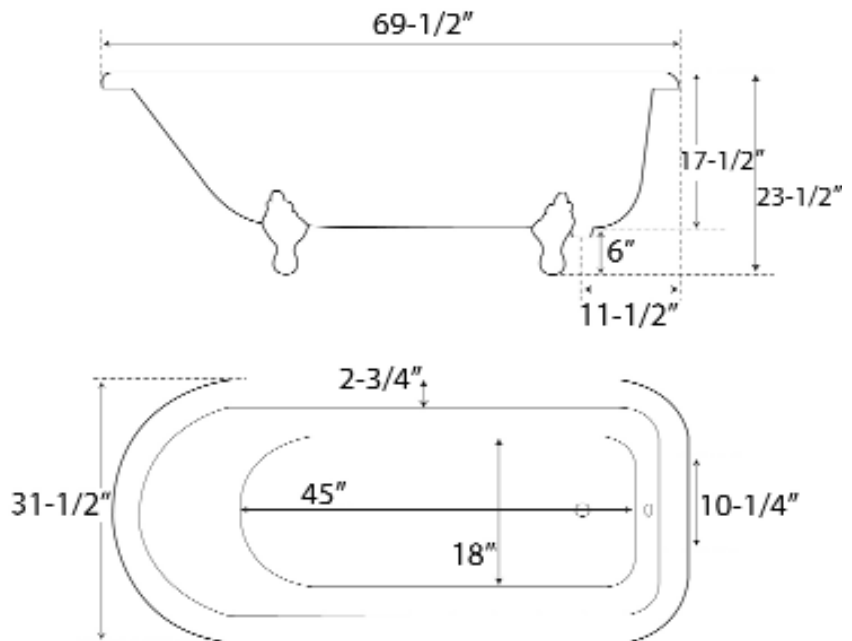

Dimensions of fixture are nominal and specifications subject to change without notice.