

VINdustry Wine Pegs & Panel Kits

3' Rectangular panel installation

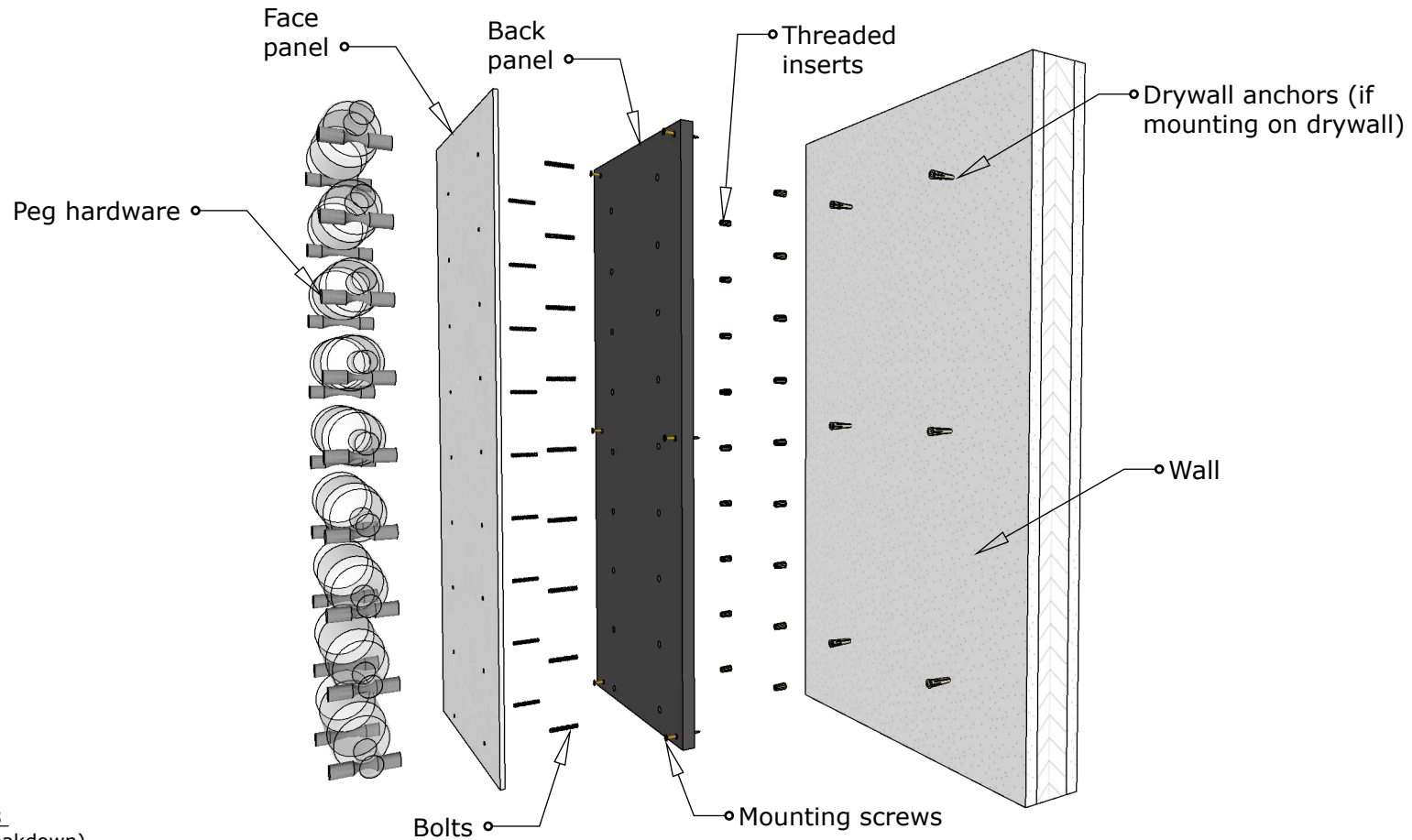

PG. 1 of 3
(parts breakdown)

Blue Grouse Wine Cellars

604.929.3180
1.888.400.CORK(2675)



VINdustry Wine Pegs & Panel Kits

3' Rectangular panel installation

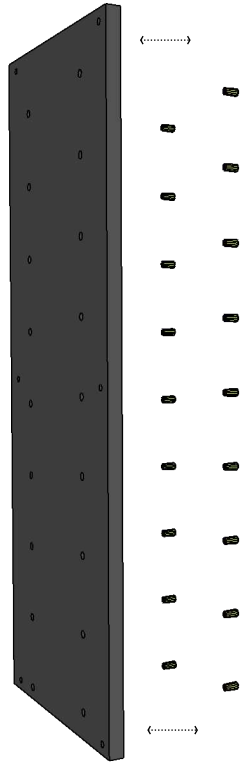

Step 1

Place threaded inserts into holes in back panel (threaded inserts can be placed from either side of the panel, a higher mounting hole on the right means your bottle neck will point right, and vice versa)

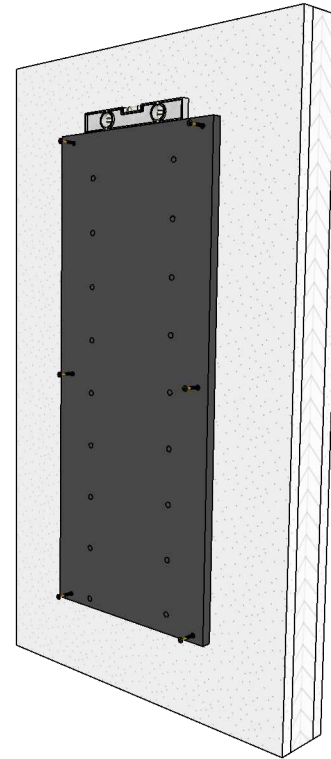

Step 2

Mount the back panel using predrilled mounting holes, use a level to ensure level installation (make sure the side of the panel you placed the threaded inserts into is facing the wall)
If using drywall anchors, install them first on the wall in locations corresponding with predrilled mounting holes on the panel

PG. 2 of 3
(installation)

Blue Grouse Wine Cellars

604.929.3180
1.888.400.CORK(2675)



VINdustry Wine Pegs & Panel Kits

3' Rectangular panel installation

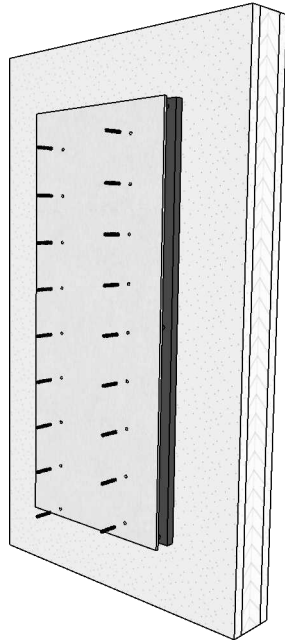

Step 3

Screw bolts into threaded inserts at the top of the panel and fit face panel over (make sure the bolts screw fully into inserts)

Step 4

Screw remaining bolts through face panel into threaded inserts

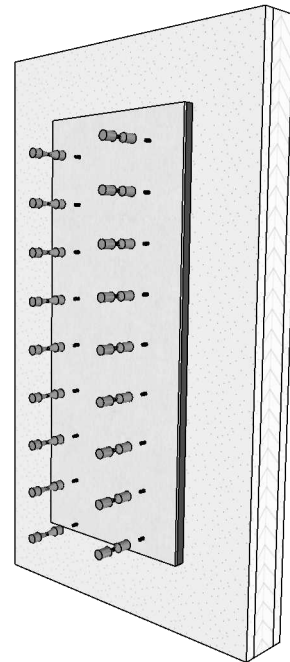

Step 5

Screw pegs onto bolts (screw pegs fully onto bolts for a tight fit and strong hold, make sure the peg supporting the neck of the bottle is installed higher than the peg supporting the body of the bottle)

PG. 3 of 3
(installation)

Blue Grouse Wine Cellars

604.929.3180

1.888.400.CORK(2675)

