

# ASSEMBLY INSTRUCTIONS POWER BURNER MODULE, 30"

P/N: **UF-PWB**

HARDWARE PROVIDED

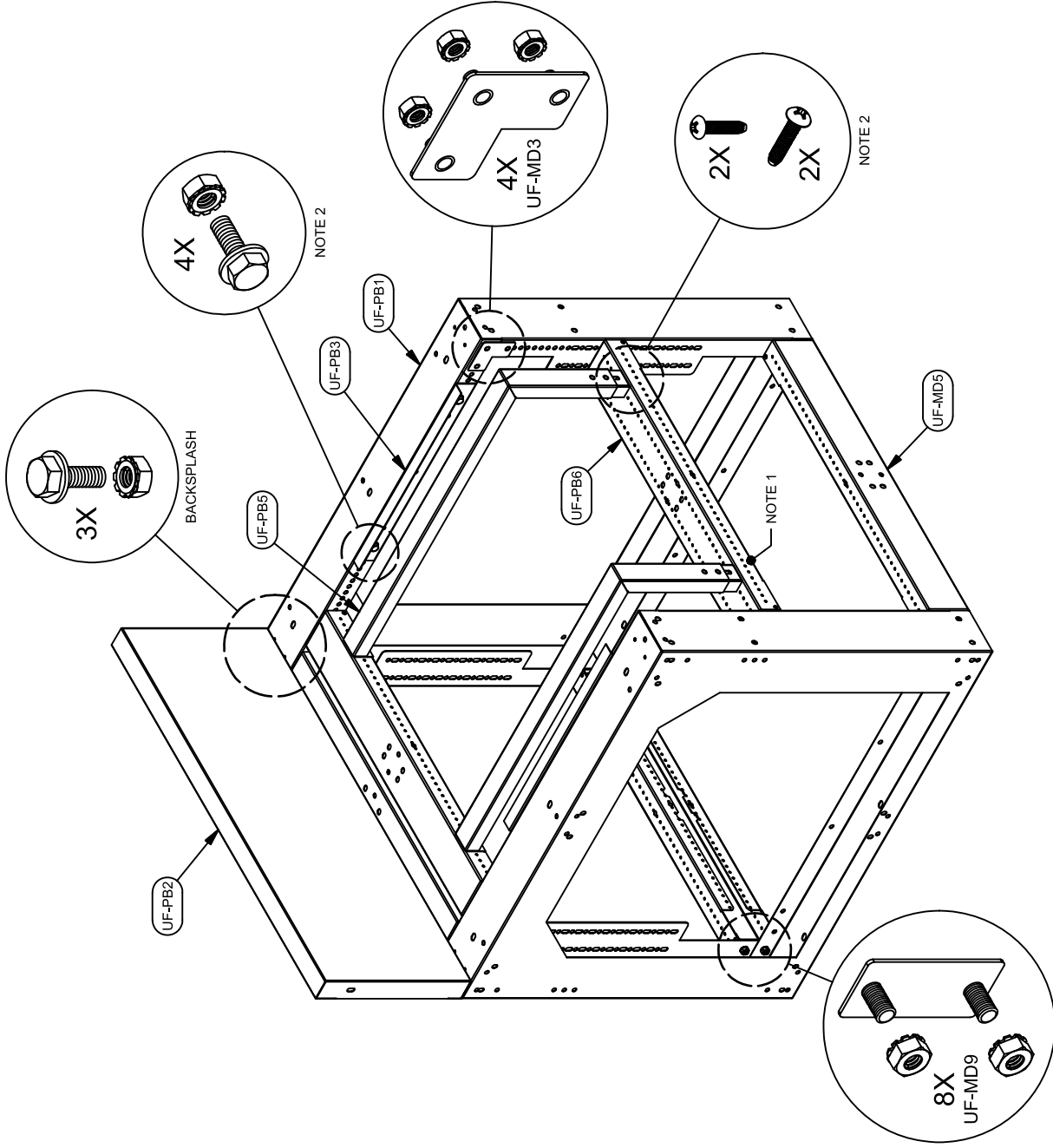
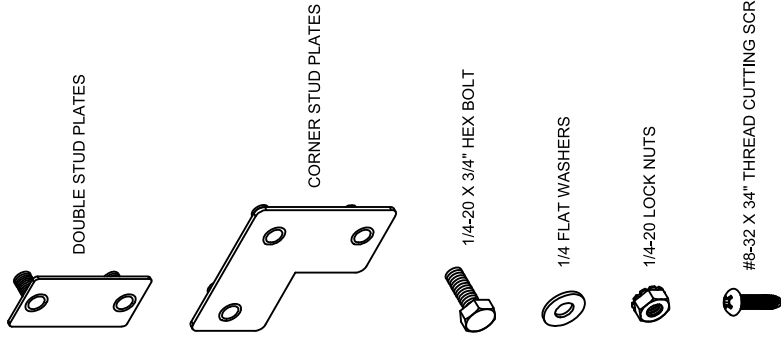

PN	DESCRIPTION	QTY
UF-PB1	POWER BURNER END PANEL, 24-3/8"	2
UF-PB2	POWER BURNER BACKSPLASH	1
UF-PB3	POWER BURNER Z-RAIL	2
UF-PB5	POWER BURNER SUPPORT ARM	2
UF-MD3	CORNER STUD PLATE	4
UF-MD5	HORIZONTAL CHANNEL, 23"	5
UF-PB6	POWER BURNER CHANNEL, 23"	1
UF-MD9	DOUBLE STUD PLATE	8

**NOTE 1**  
THIS HORIZONTAL CHANNEL CAN BE TURNED VERTICALLY TO MINIMIZE ACCESSORY OPENING IF NEEDED

**NOTE 2**  
DEPENDENT UPON THE SIZE OF YOUR POWER BURNER, USE ANY COMBINATION OF ADJUSTABLE L-SUPPORTS AND/OR Z-SPACERS TO CREATE THE DESIRED BURNER OPENING

All installations **must be ventilated** in compliance with applicable local, state, and federal codes  
All adjustments to be based on appliance manufacturer's recommendations and all local building codes