

# ASSEMBLY INSTRUCTIONS 90 DEG CORNER KIT

P/N: **UF-C90**

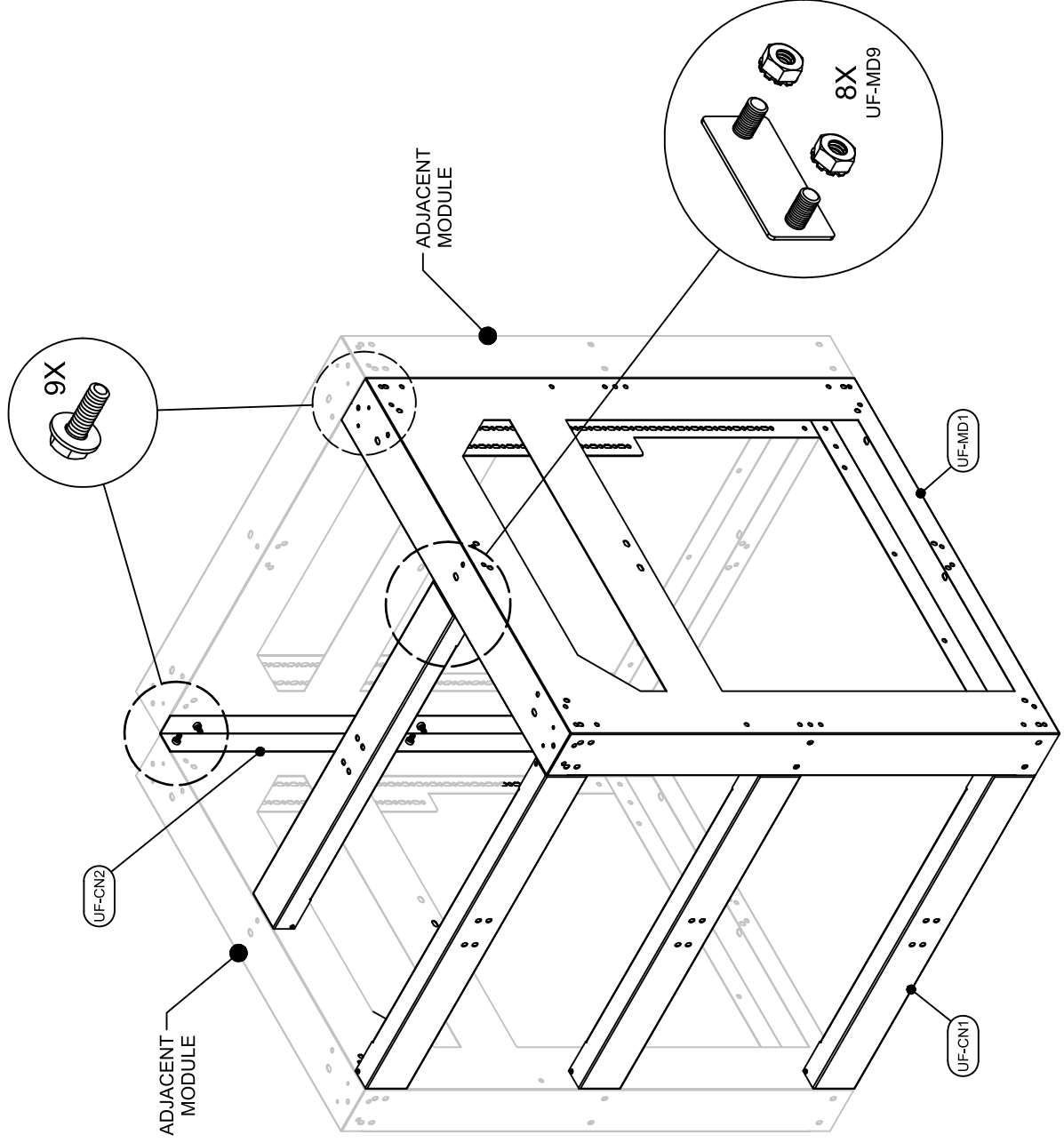

HARDWARE PROVIDED



DOUBLE STUD PLATES (UF-MD9)



1/4-20 X 3/4" HEX BOLT



1/4 FLAT WASHERS



1/4-20 LOCK NUTS

PARTS LIST		
PN	DESCRIPTION	QTY
UF-MD1	END PANEL OR SPACER	1
UF-CN1	HORIZONTAL CHANNEL, 26"	4
UF-CN2	90 DEG CORNER ANGLE	1
UF-MD9	DOUBLE STUD PLATE	8

All installations **must be ventilated** in compliance with applicable local, state, and federal codes  
All adjustments to be based on appliance manufacturer's recommendations and all local building codes