

Stella di Caffè



USER GUIDE

UNIC

Table of contents

SAFETY ADVICES	3
IMPORTANT NOTES	3
TURNING THE MACHINE ON	4
WARMING UP	4
MACHINE WARMED UP	4
DETAILED DESCRIPTION OF THE MENU	5
MENU NAVIGATION	6
SPECIAL MENU FUNCTIONS	6
CODES	7
UNLOCKING A LEVEL	7
CHANGING A PASSWORD	7
PARAMETERS	8
DATE & TIME	8
LANGUAGE	8
SOUND	8
DESKTOP BACKGROUND	9
LED BAND AND KEY LIGHTING	10
MACHINE SETTINGS	11
GROUP SETTINGS	11
<i>Temperature settings</i>	11
<i>Dose Settings</i>	12
<i>Pre-infusion settings</i>	13
<i>Self-time settings</i>	14
STEAM SETTINGS	15
STEAM AIR & HOT AIR SETTINGS	15
FAST SETTINGS	16
MISCELLANEOUS	17
PANEL CLEANING	18
DOSAMAT CONTROL BOX	19
CONTROL BOX 2 CUPS	19
CONTROL BOX 3 CUPS	20
MANUAL CONTROL BOX	20
CONTROL BOX STEAM AIR	21
HOT WATER / MANUAL TAP CONTROL BOX	21
STELLA PROGRAM FLOWCHART	22
LEVEL 0: USER	22
LEVEL 1: BREWER ROASTER	23
LEVEL 2: BARISTA	24
LEVEL 3: SUPERVISOR / OWNER	25
LEVEL USB:	26
CLEANING AND MAINTENANCE	27
DAILY	27
WEEKLY	27
OTHER	27

Safety advices

- This appliance is not intended for use by persons (including children) with reduced physical, sensory or mental capabilities, or lack of experience and knowledge, unless they have been given supervision or instruction concerning use of the appliance by a person responsible for their safety.
- Children should be supervised to ensure that they do not play with the appliance.
- This appliance is intended to be used only for its specific purpose.
The manufacturer shall not accept any liability for damages due to improper or wrong use.
- Access to the service area is restricted to persons having safety and hygiene knowledge with practical experience of the appliance.
- Before plugging in or unplugging the power cord, place the main switch to position "0".
- If the power cord is damaged, it must be replaced by the manufacturer, its service agent or similar qualified persons in order to avoid a hazard.
- For electrical safety, be sure the appliance is correctly earthed.
The manufacturer shall not accept any liability for damage due to faulty earth.
- Only a qualified technician is allowed to access the internal parts of the appliance for maintenance and service operation.
- Be careful of hot surfaces such as: cup warmer, group heads, hot water and steam outlets.
- Do not expose oneself to steam or hot water flow.

Important notes

- This appliance is intended to be:
 - Placed on an horizontal and stable surface
 - Used in an ambient temperature between 5°C and 35°C (41°F – 95°F).
 - Installed to comply with the national rules that may be applicable.
 - Connected to a water system with pressure ranging from 1 to 8 bar (0.1 to 0.8 Mega pascal)
- Before connecting the electrical supply, verify that the electrical network comply with the data plate of the appliance.
- For more details about installation, adjustments and connections, please refer to the installation guide or the technician guide.
- This appliance must not be exposed to water jet or splash.
- Be careful not to block the air inlets with towels or other items.
- If the appliance is to be stored with ambient temperature less than 5°C (41°F), the water circuit (boiler – pipes) should be emptied.

Turning the machine on

When the machine is turned on, the machine goes through a starting up procedure that allows it to check all of the elements. The process takes approximately **45 seconds**.

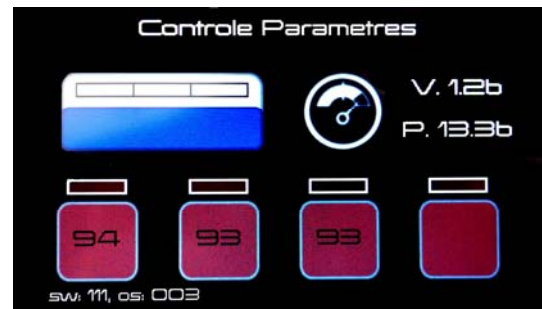
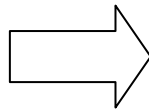
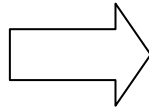

Never turn the machine on with the USB key inserted into the side of the machine.

Warming up

The machine begins the warming up process once the Control Parameters panel appears. Take into account approximately 1/2 hour for the machine to reach operating temperature.

Machine warmed up

The menu is not accessible if the machine is not warmed up. Once the machine is warmed up, just press on the screen to access the menu:

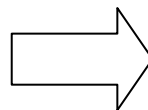
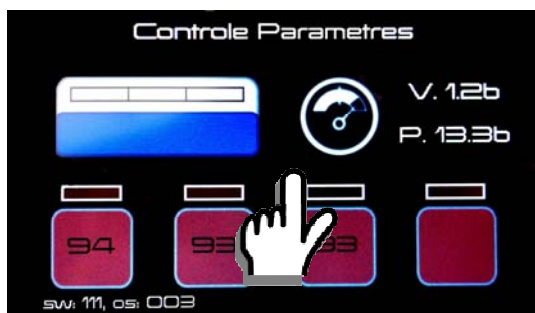

Detailed Description of the Menu



Codes: allow you to access the various menu levels.



Parameters: allow you to use to set parameters: *date and time, language, sound, desktop background, units, and lighting.*



Utilization: allows you to use or set parameters for the functions: *rinse group, cleaning group, coffee counters, maintenance planning, Led bar on/off, softener.*



Energy economics: allows you to use or set parameters for the functions: *day/night, groups watchfulness, stop group, programming day/night.*



Maintenance: allow you to use or set parameters for the functions: *component test, error list, event log, cooling, CIM (Machine card identity), and counters.*



Machine settings: allow you to use or set parameters for the functions: *group settings, steam settings, Steam Air, fast settings, stop group, and miscellaneous.*



Panel cleaning: allows you to deactivate the key sensitivity in order to clean the panel.

*The grayed icons are **inactive** or **locked**. To use these functions, you must have:*

- *Either an access code of the desired level;*
- *Or a USB key.*

Menu navigation

The icons mentioned above represent all of the menu navigation functions of the STELLA.

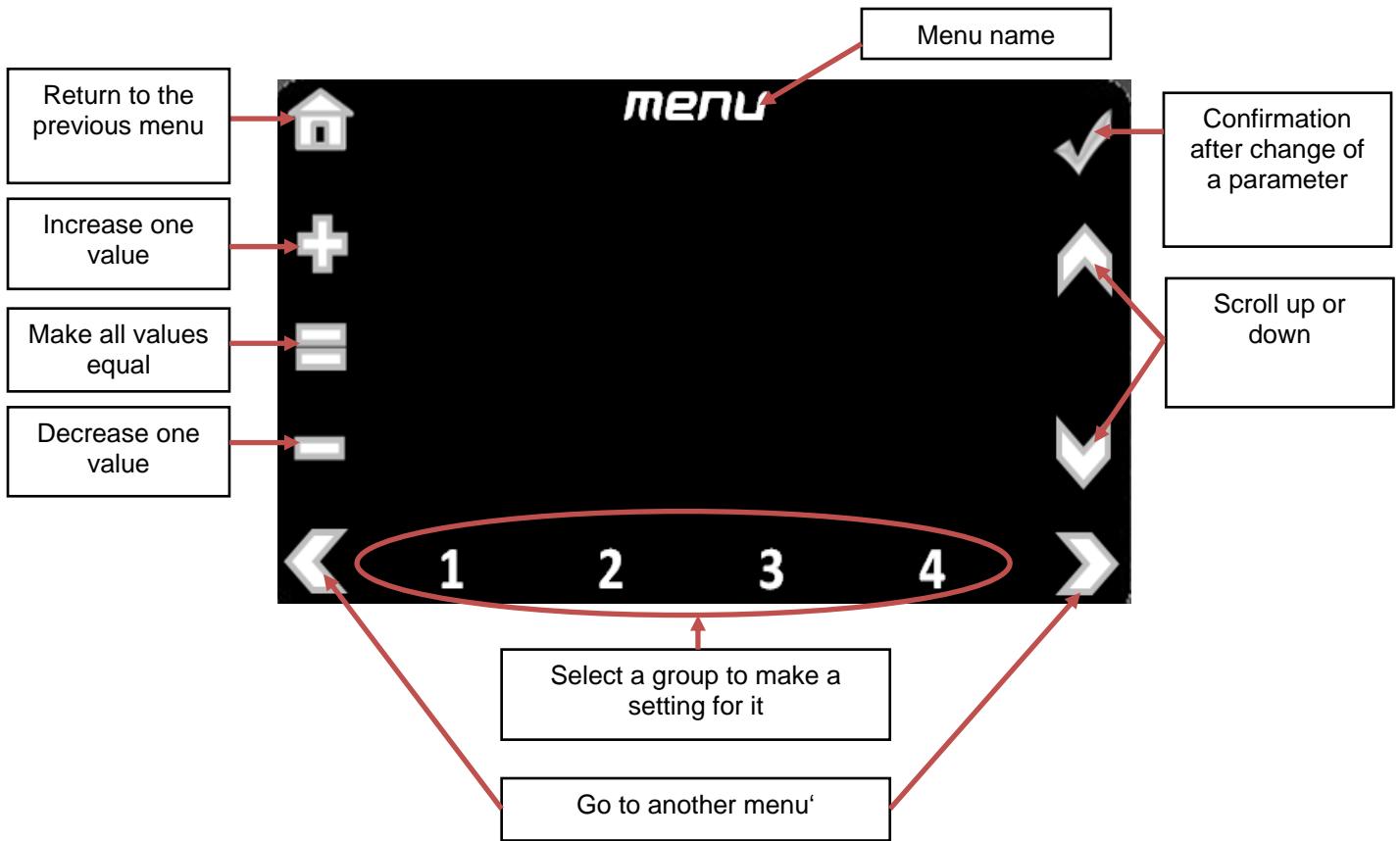

Special menu functions

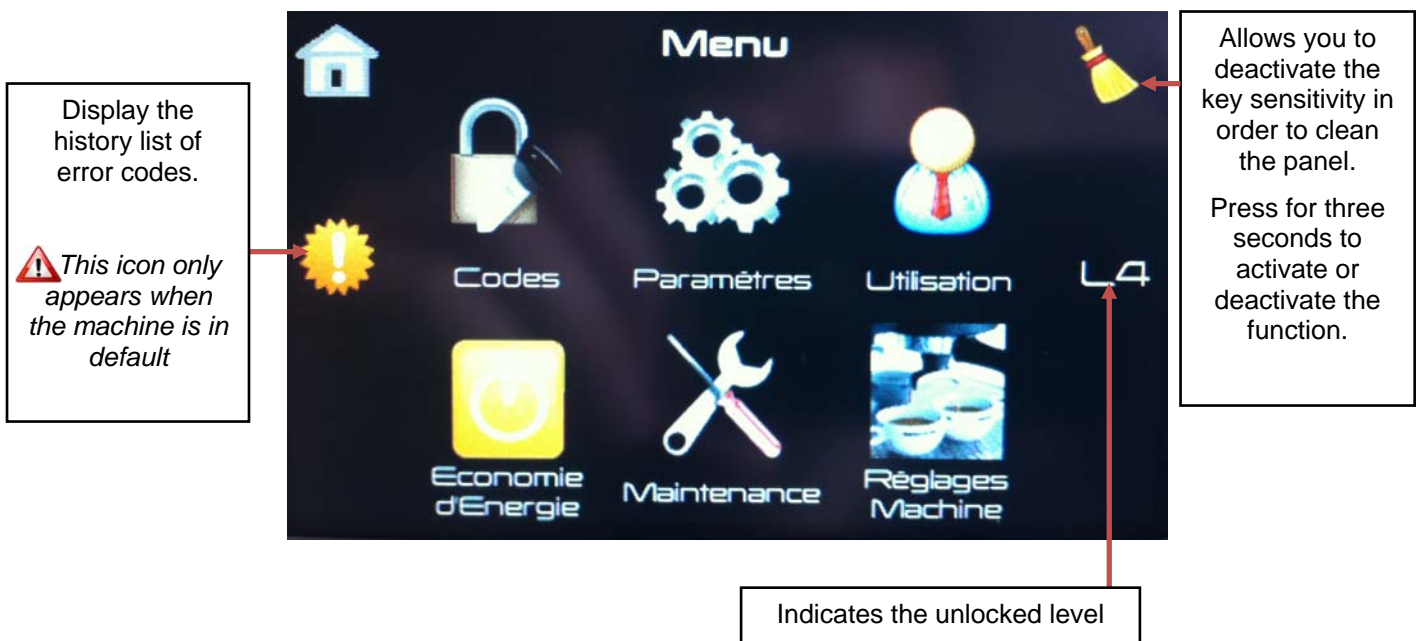

Codes (level 1, 2, 3)

By default, most menus are locked. The various settings and programming options are impossible. Access to settings is authorized by input of a code according to three access levels. **For more complete information, consult the chapter « Stella programming flowchart ».**

Unlocking a level

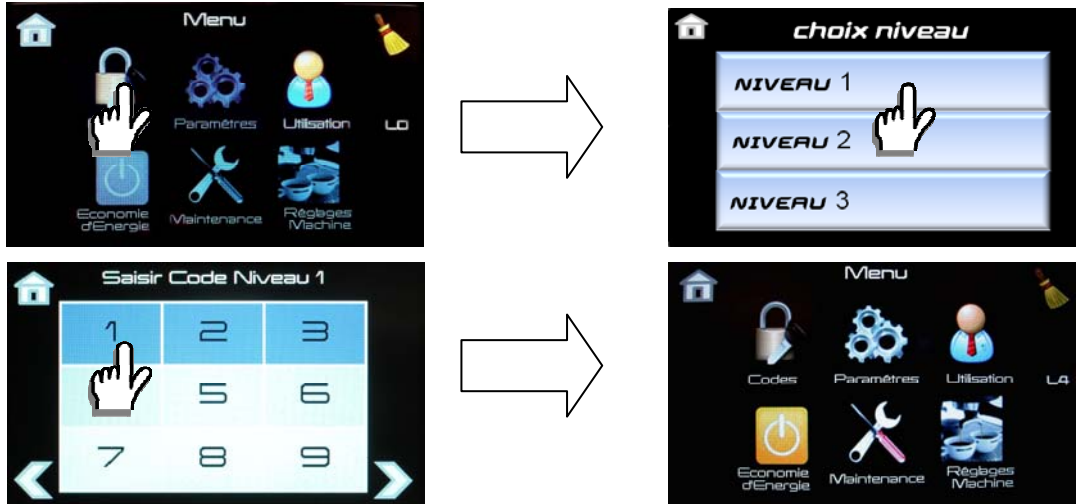

Enter the five digit code.

Once the code is entered, return to the main menu. The icons authorized by the level are no longer grayed out.

Note: If the entered code is incorrect, an error message appears. Reenter the code.

After entering the code, additional options are now available by re-clicking on "codes."

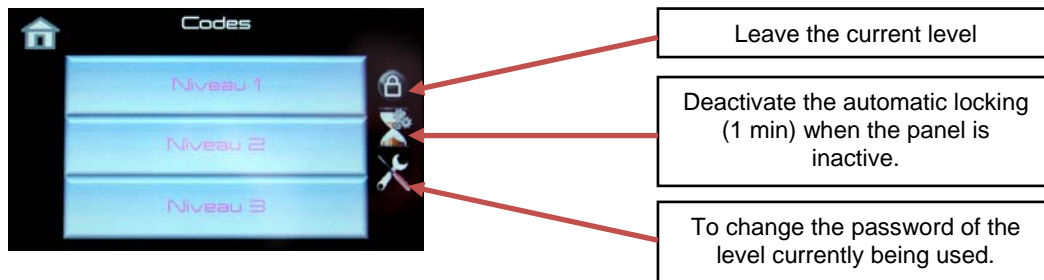

Changing a password (level 1, 2, 3)

To change the password of a level, it is necessary to have previously unlocked this access level.

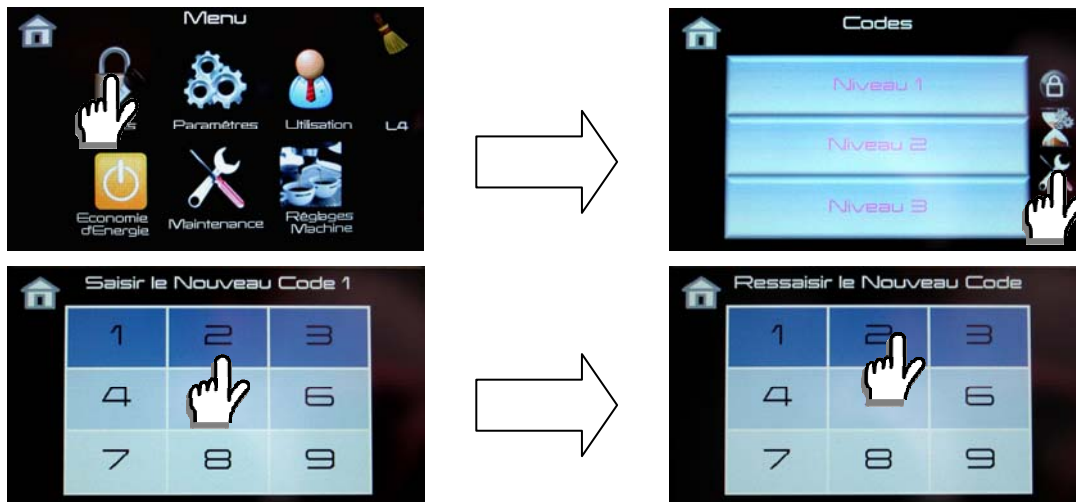

By default, the codes are the following:

Level 1 = 11111

Level 2 = 22222

Level 3 = 33333

Enter the new code for the level two times.

Parameters

Date & Time (level 1, 2, 3)

Allows you to set date and time.

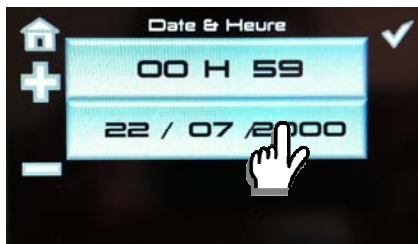
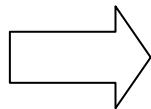

Touch the + and – keys to set the desired value.

- ✓ When you select a value to make a setting, the color of the value turns pink.
- ✓ Do not forget to confirm the setting in order to save the parameters.

Language (level 1, 2, 3)

Allows you to choose the menu language.

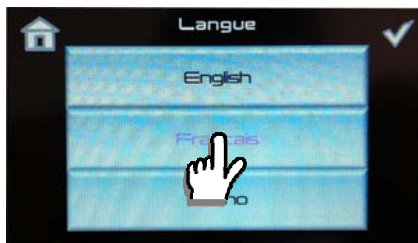
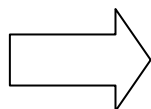

Touch the + and – keys to set the desired value.

- ✓ When you select a value to make a setting, the color of the value turns pink.
- ✓ Do not forget to confirm the setting in order to save the parameters.

Sound (level 1, 2, 3)

Allows you to activate or deactivate the sound and adjust the volume.

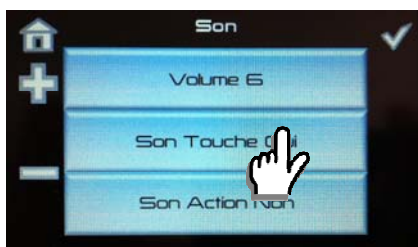
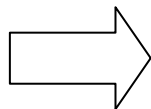

Touch the + and – keys to set the desired value.

- ✓ When you select a value to make a setting, the color of the value turns pink.
- ✓ Do not forget to confirm the setting in order to save the parameters.

Desktop background (level 1, 2, 3)

The desktop background allows you to attach a picture / photo or to view the machine parameters.

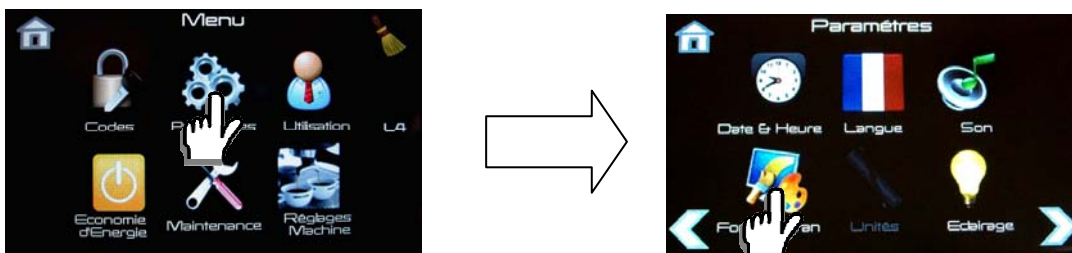

View of the programmed and actual temperature of each group.

View of the steam and pump pressure.

View of the steam and pump pressure, the temperature of each group, and the amount of water in the steam boiler. Cursors also indicate the activation of the heating elements.

(It is the screen that appears during the starting and warming up of the machine)



To select the desktop background



To view the desktop background



✓ Do not forget to confirm the setting in order to save the parameters.



Importing a desktop background:

- Before importing a desktop background, the USB key must be inserted into the side of the machine.
- The USB key and its images must be correctly formatted for the machine to be able to read them.



Contact your distributor for more specific information.

Led band and key lighting (level 1, 2, 3)

Allows you to change the color of the headband and keys.

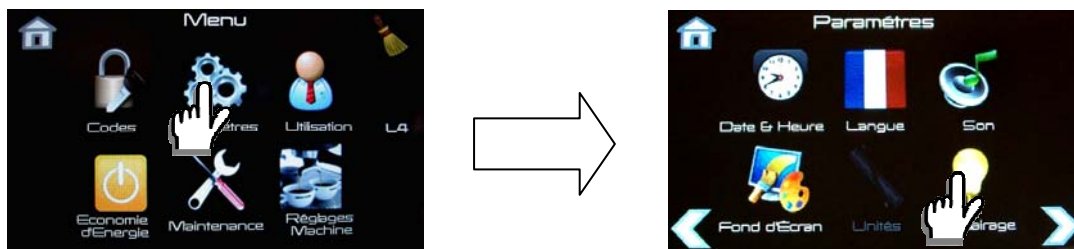

Touch the + and – keys to set the desired value.

- ✓ When you select a value to make a setting, the color of the value turns pink.
- ✓ Do not forget to confirm the setting in order to save the parameters.

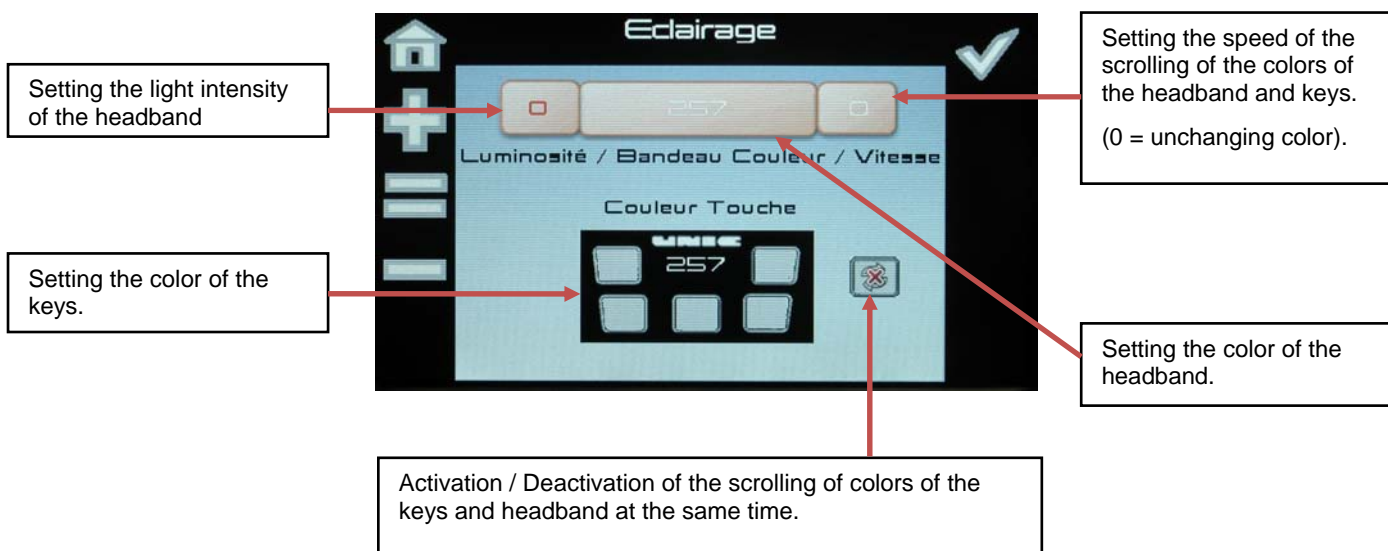

Activation / Deactivation of the scrolling of colors of the keys and headband at the same time.

Color	Value
White	0
Red	1
Yellow	40
Green	80
Cyan	120
Blue	160
Pink	220
Red	255

Machine settings (level 1, 2, 3)

Allow you to make various settings for the coffee machine: temperature, doses, pressures, etc...



Group settings (level 1, 2, 3)

Allow you to set and view the temperature of the groups, pre-infusion, self-times, and doses:

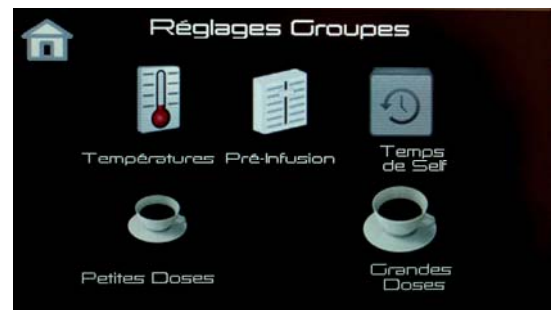
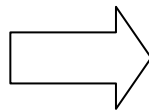

Temperature settings (level 1, 2, 3)

Allow you to set the temperature of each group.

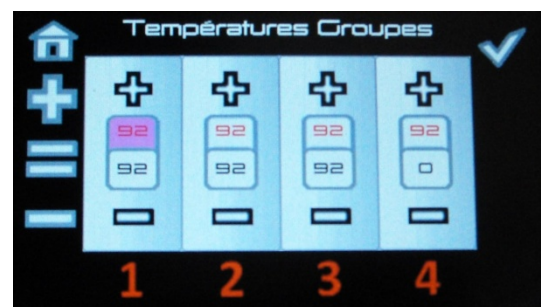
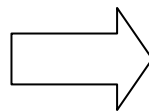
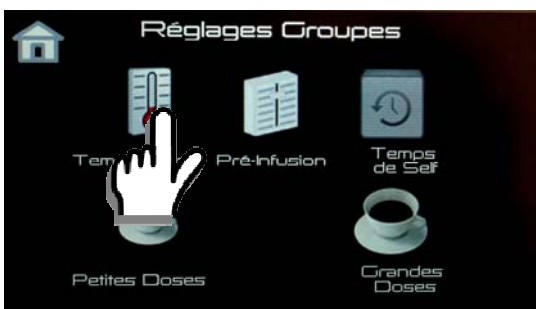

Programmed temperature.

Touch the + and - keys to set the desired value.

✓ Do not forget to confirm the setting in order to save the parameters.

Actual temperature (probe)

Select the group.

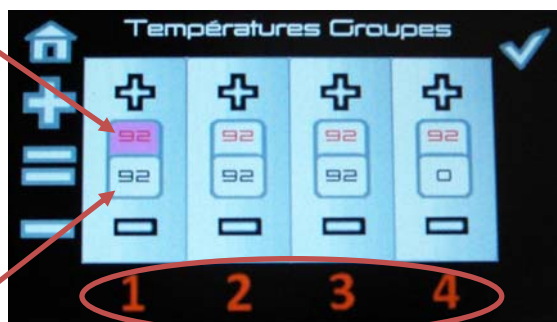

Dose Settings (level 1, 2, 3)

Allow you to set and view doses.

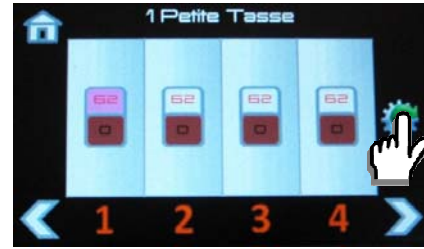
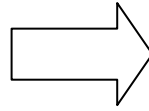

Do not forget to activate the **PRO**gramming mode.

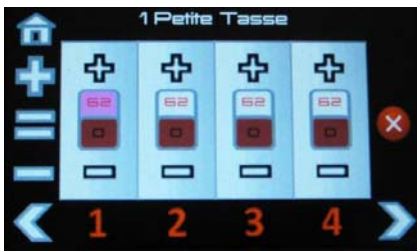

The point appears on the group display in **PRO**gramming mode.

If the **MAN** key is not enabled, press above (*Only for DOSAMAT machines*);
Set the desired portafilter, specifically: 1C, 2C, or 3C

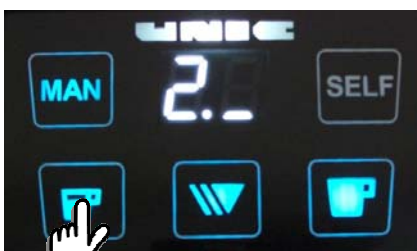

In this case, the two cup portafilter is set. Press small or large doses.

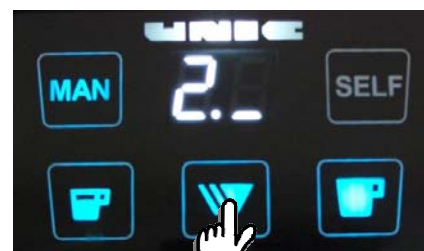
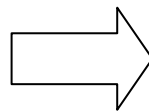

When the desired coffee dose is reached, stop the infusion by touching "continue/stop."

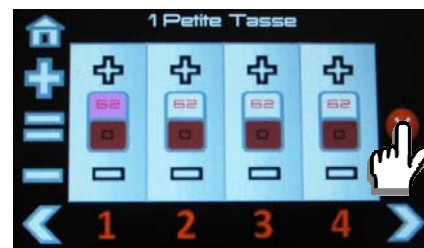
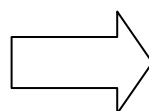
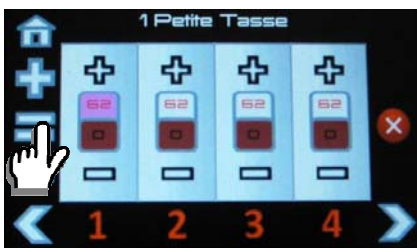

To obtain the same value for the other groups, press =.
Repeat the operation to set the other volumes.

Deactivate the **PRO**gramming mode to save the values.

Pre-infusion settings (level 1, 2, 3)

Allow you to set the wetting time of the coffee before infusion.

Pre-inf times "Open" is the time during which the electrovalve remains open (**T1**).

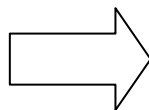

Touch the + and – keys to set the desired value.

Setting range: 0.1 sec à 10 sec

✓ Do not forget to confirm the setting in order to save the parameters.

Pre-inf times "Closed" is the time during which the electrovalve remains closed (**T2**).

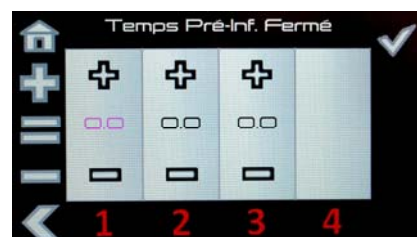
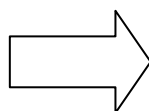
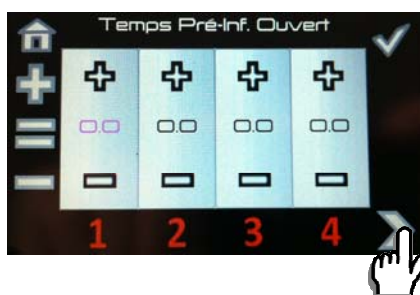

Touch the + and – keys to set the desired value.

Setting range: 0.1 sec à 10 sec

✓ Do not forget to confirm the setting in order to save the parameters.



When either of the two parameters is set at 0, the pre-infusion mode remains inactive. To activate the Pre-infusion, both times must be greater than 0.

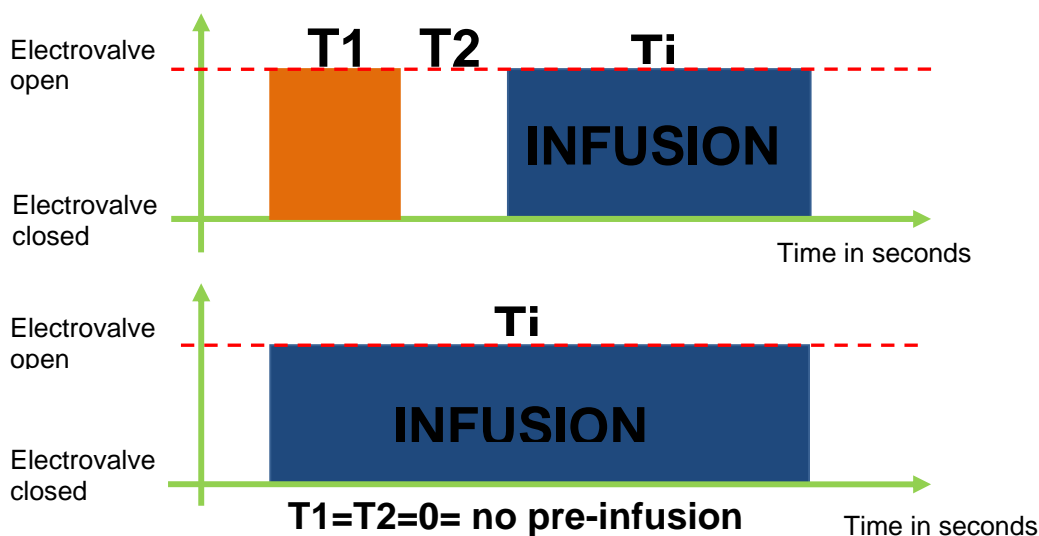

Self-time settings (level 1, 2, 3)

Allow you to set the time-delay letting you prepare the cups in SELF mode, before the onset of the automatic cycle.

Only for DOSAMAT machines.

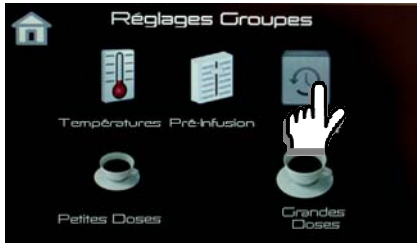

Touch the + and – keys to set the desired value.

Setting range: 0 to 10 sec., default setting 1 cup: 0.5 second

✓ Do not forget to confirm the setting in order to save the parameters.



Go to the 2 cup setting.

Touch the + and – keys to set the desired value.

Setting range: 0 to 10 sec., default setting 2 cups: 2.5 seconds

✓ Do not forget to confirm the setting in order to save the parameters.



Go to the 3 cup setting.

Touch the + and – keys to set the desired value.

Setting range: 0 to 10 sec., default setting 2 cups: 2.5 seconds

✓ Do not forget to confirm the setting in order to save the parameters.

Steam settings (level 1, 2, 3)

Allow you to set the pressure of steam boiler.

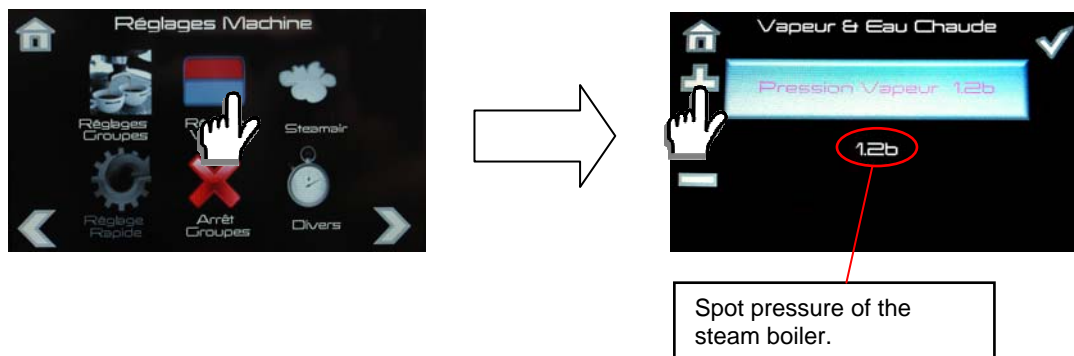

Touch the + and – keys to set the desired value.

Setting range: 0.7 Bar to 1.4 Bar, default setting 1 Bar

✓ Do not forget to confirm the setting in order to save the parameters.

Steam Air & hot air settings (level 1, 2, 3)

Allow you to set the Steam air or hot water control box settings:

- the temperature at the level of the thermostatic probe of the milk (*only for a machine with Steam Air*)
- the steam time-delay
- the volumes of hot water

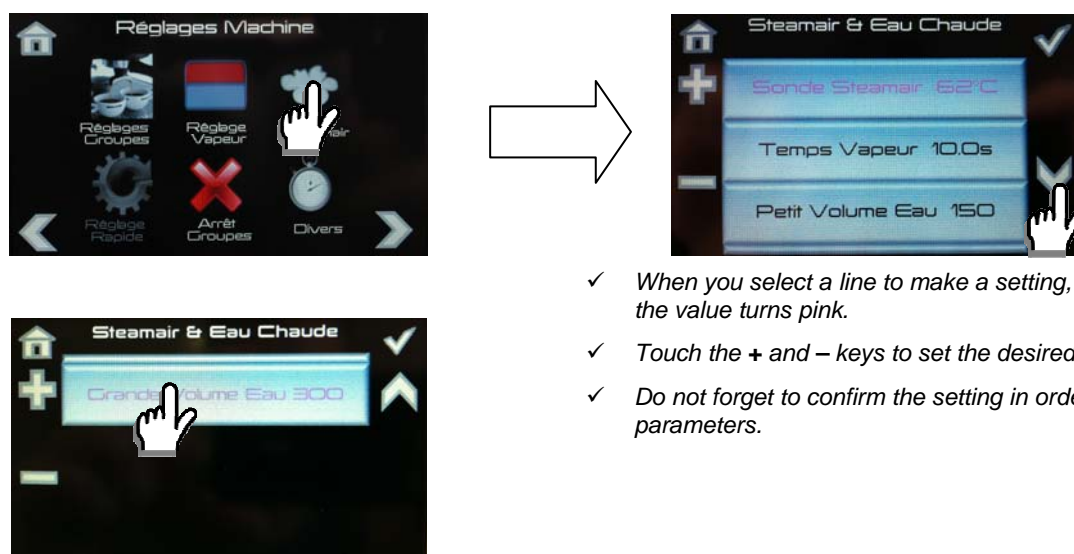

✓ When you select a line to make a setting, the color of the value turns pink.

✓ Touch the + and – keys to set the desired value.

✓ Do not forget to confirm the setting in order to save the parameters.

Setting range:

- Steam Air probe: 50°C to 90°C , default setting 62°C
- Steam time: 0 sec to 99 sec, default setting 10 sec
- Small water volume: 0 to 2000 ml , default setting 150 ml
- Large water volume: 0 to 2000 ml , default setting 300 ml

Fast Settings (level 1, 2, 3)

Allow you to set all the machine parameters on a single page. Report all the setting values of all the groups. Example: *setting group temperature at 90°C; all the groups are set at 90°C.*

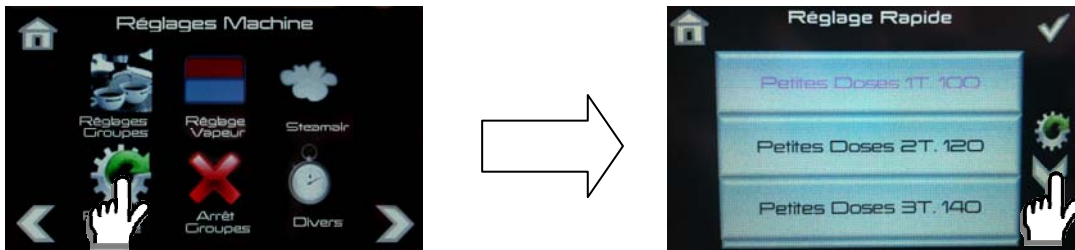

Scroll through the other settings using the navigation arrows:

Small Dose 1 Cup → Small dose 2 Cups → Small dose 3 Cups → Large dose 1 Cup → large dose 2 Cups → large dose 3 Cups → Self-time 1 Cup → Self-time 2 Cups → Self-time 3 Cups → Group temperature → Time of pre-infusion overture (T1) → Time of pre-infusion close (T2) → *pre-infusion pressure overture (P1)* → *pre-infusion pressure close (P2)*

- ✓ When you select a line to make a setting, the color of the value turns pink.
- ✓ Touch the + and – keys to set the desired value.
- ✓ Do not forget to confirm the setting in order to save the parameters.

Setting doses:

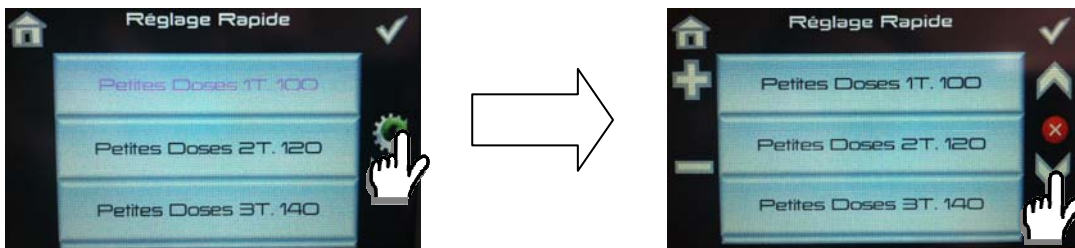

Do not forget to activate the **PRO**gramming mode.



The point appears on the group displays in the **PRO**gramming mode.

Set the desired portafilter.



In this case, the two cup portafilter is set.

Press small or large dose.

Repeat the operation to set the other volumes.

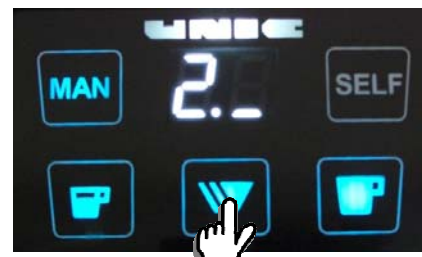

When the coffee dose is reached, stop the infusion by touching "continue/stop."

Repeat the operation to set the other volumes.

Deactivate the **PRO**gramming mode to save the values.

Miscellaneous (level 1, 2, 3)

Allows you to activate the chronometer function and set the dose priority at the start of a cycle: small dose, large dose, last dose used (*Only for DOSAMAT machines*).

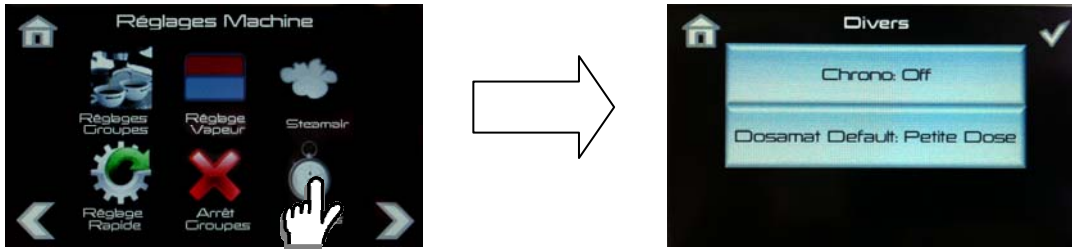

Setting of the chronometers display in the screen of each group:

CHRONO OFF = deactivated

CHRONO ON = Activated (visible at the end of the cycle)

DYNAMIC CHRONO = Activated (visible during the cycle)

Setting dose priority at the start of a cycle:

(Only for DOSAMAT machines)

SMALL DOSE
LARGE DOSE
LAST DOSE USED

Example: if 'small dose' is programmed, at the end of any cycle, the control box is reset at small dose.

- ✓ When you select a line to make a setting, the color of the value turns pink.
- ✓ Press the line to change the parameters.
- ✓ Do not forget to confirm the setting in order to save the parameters.

When the pre-infusion is activated, the chronometer displays two values at the end of the cycle:

- The first value represents the pre-infusion time in seconds (**T1+T2**).
- The second value represents cumulative time (pre-infusion + infusion) (**T1+T2 + Ti**).

In dynamic mode, the chronometer is only displayed at the end of the pre-infusion.

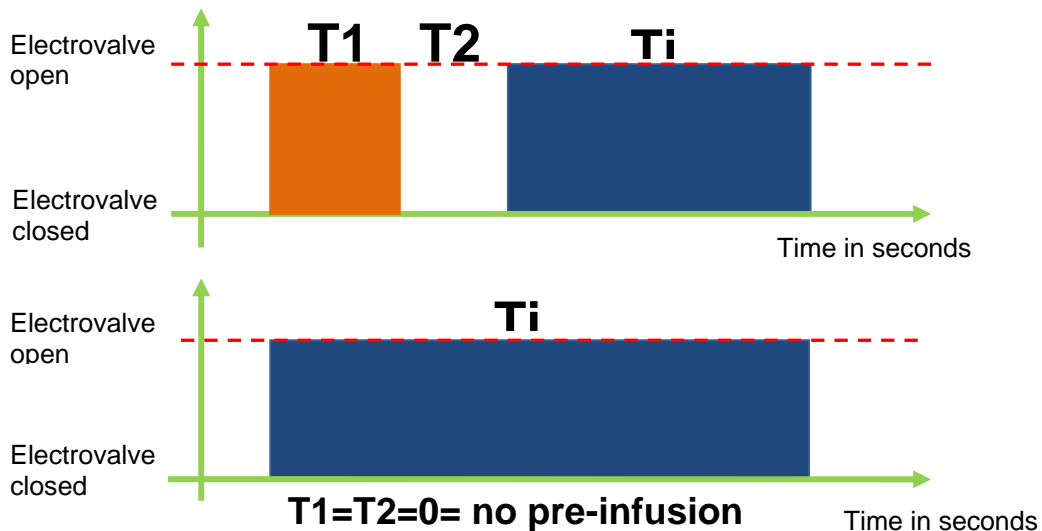

Panel cleaning

The clean panel mode deactivates the sensitivity of all of the touch keys in order to allow their cleaning.
Press the icon in the form of a broom until the boxes display "nC."

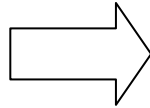

When the command boxes show "nC," all of the keys are deactivated.

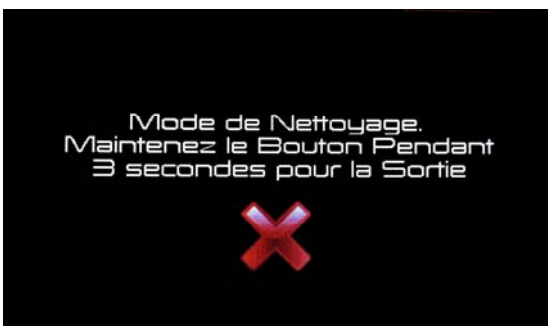

Press the red cross **for three seconds** to deactivate the cleaning mode and return to normal mode.



Do not clean the panel and screens with abrasive or chemical products.





- Use cold water and a microfiber cloth to clean the panel.



DESCRIPTION AND FUNCTION OF KEYS

Dosamat Control Box (reference 45100)







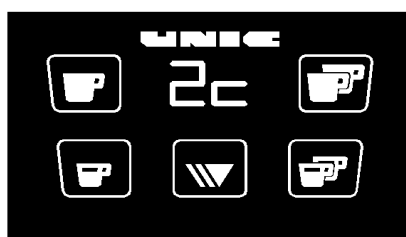

- The numbers **1** **2** **3** correspond to the selected portafilter (1 cup, 2 cups, or 3 cups).
- The keys   correspond respectively to the selection: (small dose) **C**, or (large dose) **C**.
- The key  selects the manual mode: Manual start of cycle.
- The key  selects the Self-mode: The automatic start of the cycle corresponding to the selected portafilter.
- The Continue/stop key  allows you to stop a cycle in the middle and continue a cycle in progress (non-dosed).

A short click at the end of the cycle allows you to display the infusion time for the cycle if the chronometer function was activated.

Note: it is possible to switch from a small cup to a large cup during the cycle and vice versa; in this case, if the change from large to small dose is made when the small dose has already passed, the cycle stops.

Control Box 2 cups (4 doses reference: 45102)







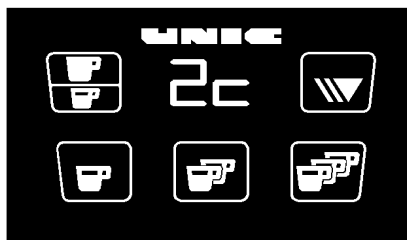

- The keys   correspond respectively to **1C** (1 small dose) and **2C** (2 small doses)
- The keys   correspond respectively to **1C** (1 large dose) and **2C** (2 large doses)
- The continue/stop key  allows you to do the following:
 - stop a cycle in progress
 - continue a cycle in progress (non-dosed).

- A short click at the end of the cycle also allows you to display the infusion time if the chronometer function was activated.

Note: it is possible to switch from a small cup to a large cup during the cycle and vice versa; in this case, if the change from large to small dose is made when the small dose has already passed, the cycle stops.

Control Box 3 cups (6 doses reference: 45103)



- The keys    correspond respectively to numbers 1 2 3 (1 dose, 2 doses, 3 doses)
- The key  allows you to select small dose **C**, or large dose **C**.
- The continue/stop key  allows you to do the following:
 - stop a cycle in progress:
 - continue a cycle in progress (non-dosed).
 - A short click at the end of the cycle also allows you to display the infusion time if the chronometer function was activated.

Note: it is possible to switch from a small cup to large cup during the cycle and vice versa; in this case, if the change from large to small dose is made when the small dose has already passed, the cycle stops..

Manual control box (ON/OFF reference: 45101)



- The display indicates the infusion time.



Cycle start





Cycle stop

Control Box Steam Air (reference 45100)



- The display shows the breakdown of the volume of the water dose, the steam time-delay, or displays the actual temperature of the Steam Air probe according to the cycle in progress.
- In case of simultaneous cycles, the display of the Steam Air temperature has priority.



- The keys   correspond respectively to the programmed small water dose and the programmed large water dose.



- The key  corresponds to time-delayed steam.



- The key  corresponds to the Steam Air mode (the cycle automatically stops when the programmed temperature is reached by the probe).



- The continue/stop key  allows you to do the following:
 - stop a cycle in progress
 - continue a cycle in progress (non-dosed).
 - A short click at the end of the cycle also allows you to display the infusion time if the chronometer function was activated.

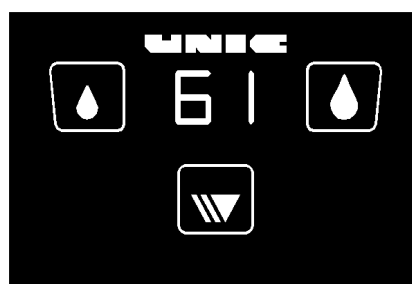

Note: it is possible to switch from a small dose to large dose during the cycle and vice versa; in this case, if the change from large to small dose is made when the small dose has already passed, the cycle stops.

Hot water / manual tap control box (reference 45100)



- The display indicates the breakdown of the programmed water dose.



- The keys   correspond respectively to the programmed small water dose and the programmed large water dose.



- The key  stops the cycle in progress.

Note: it is possible to switch from a small dose to a large dose during the cycle and vice versa; in this case, if the change from large to small dose is made when the small dose has already passed, the cycle stops.

Stella program flowchart



Level 0: User

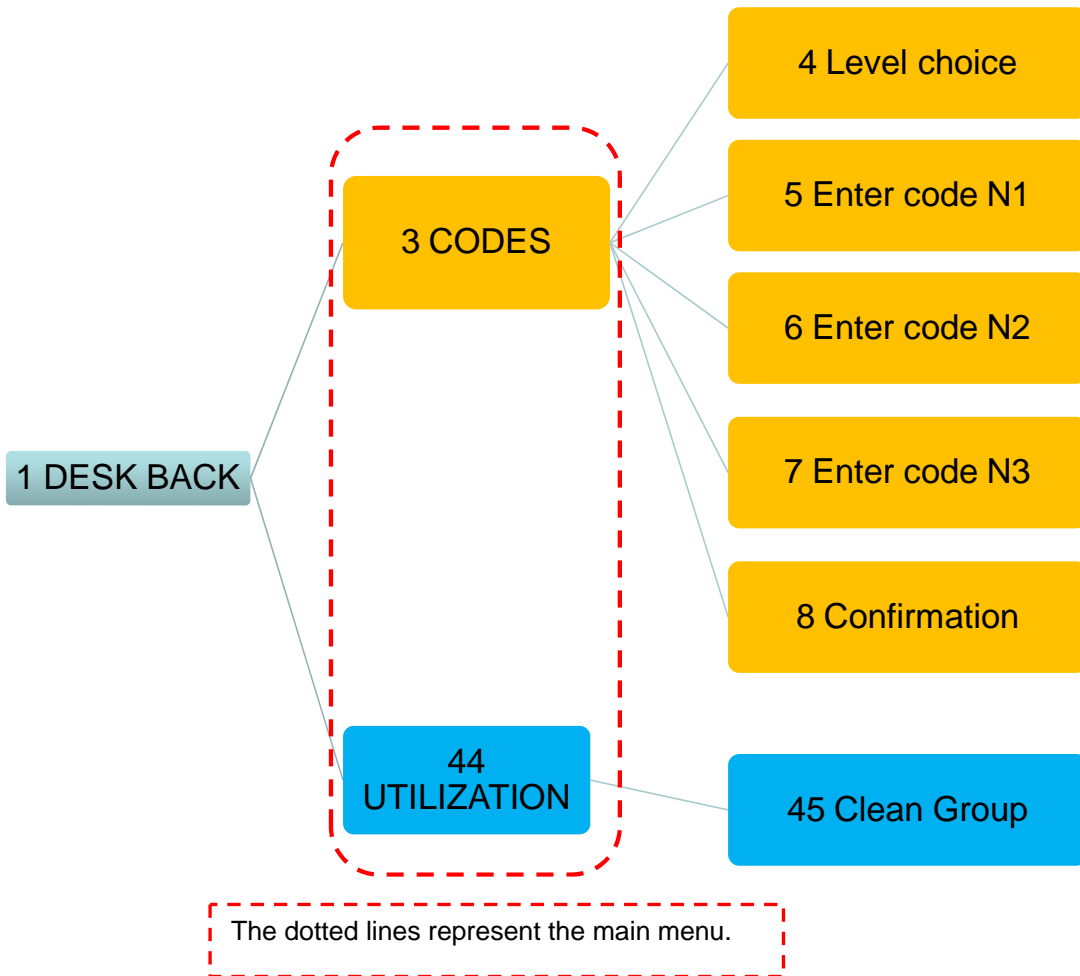



Level 1: Brewer Roaster

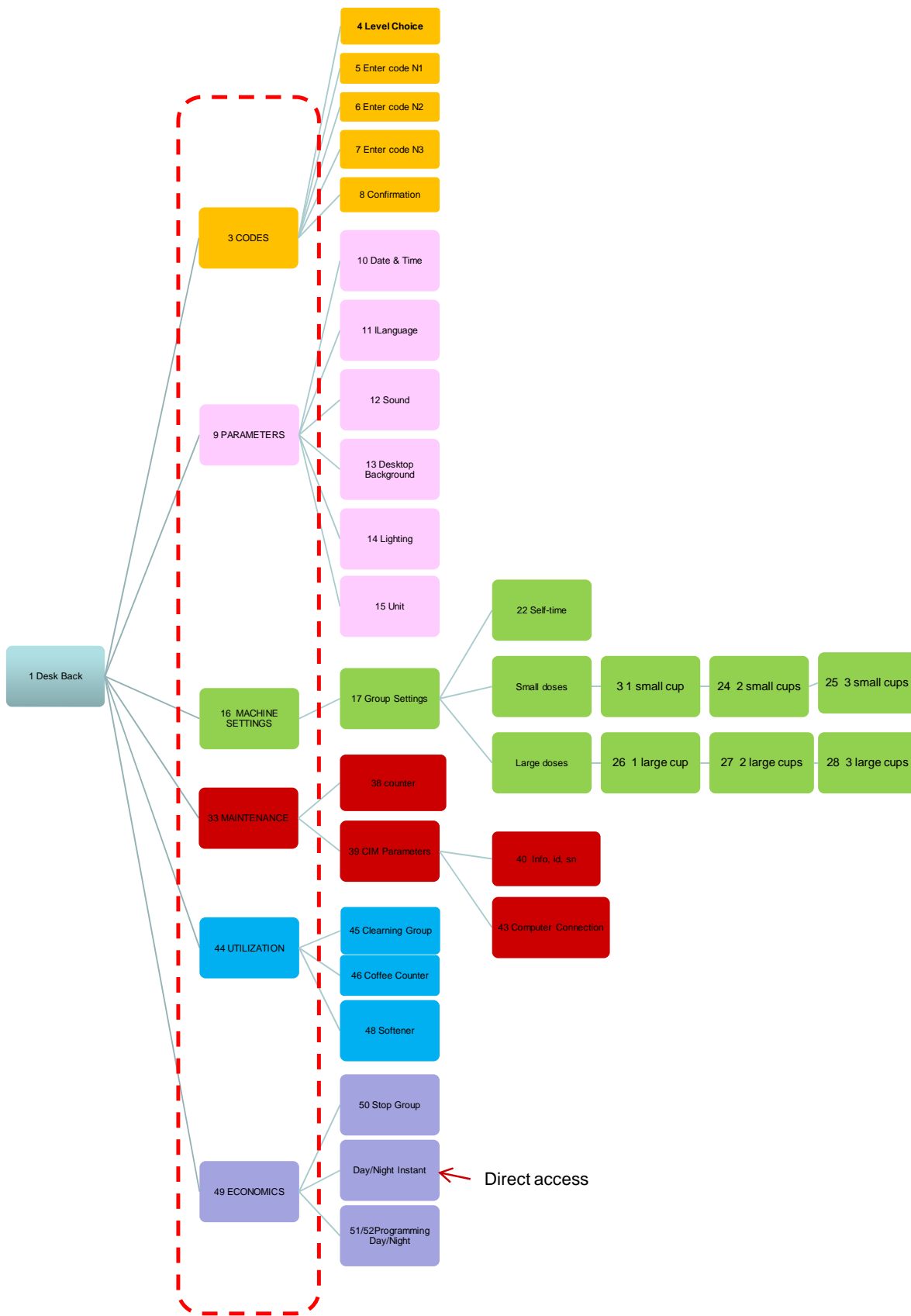

Direct access

The dotted lines represent the main menu.



Level 2: Barista

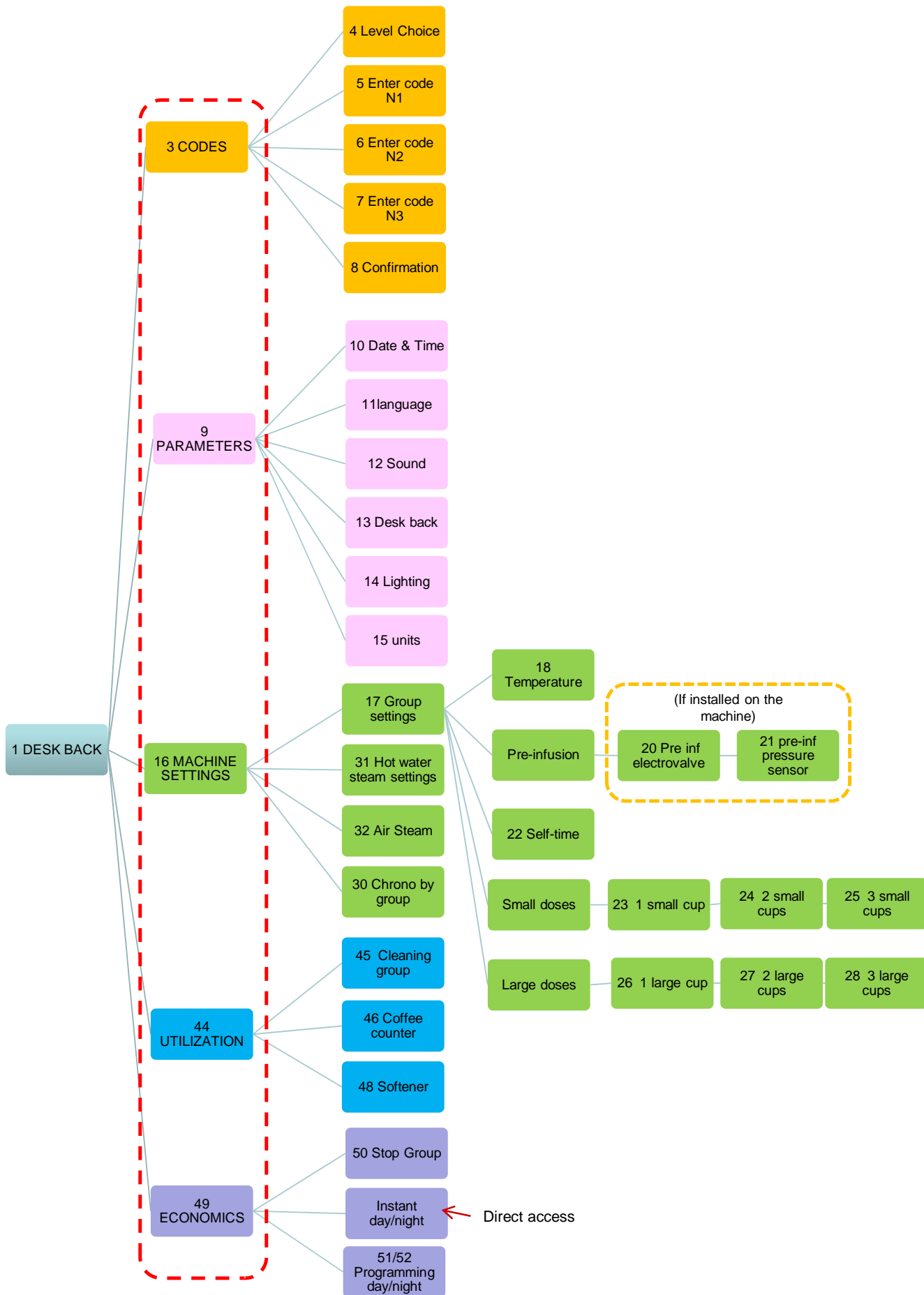

The dotted lines represent the main menu.



Level 3: Supervisor / Owner

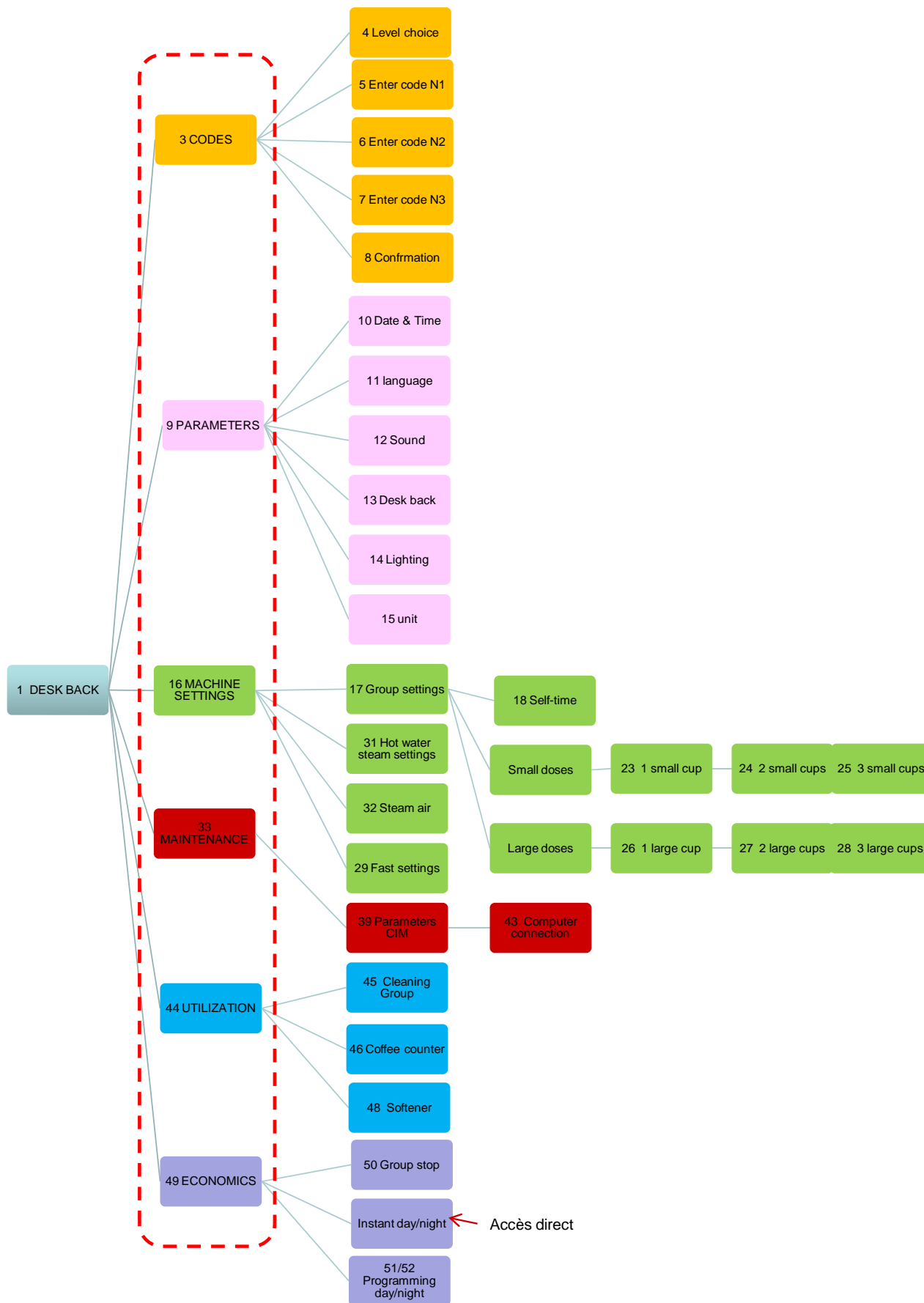

The dotted lines represent the main menu.



Level 4: Technician

Level USB:

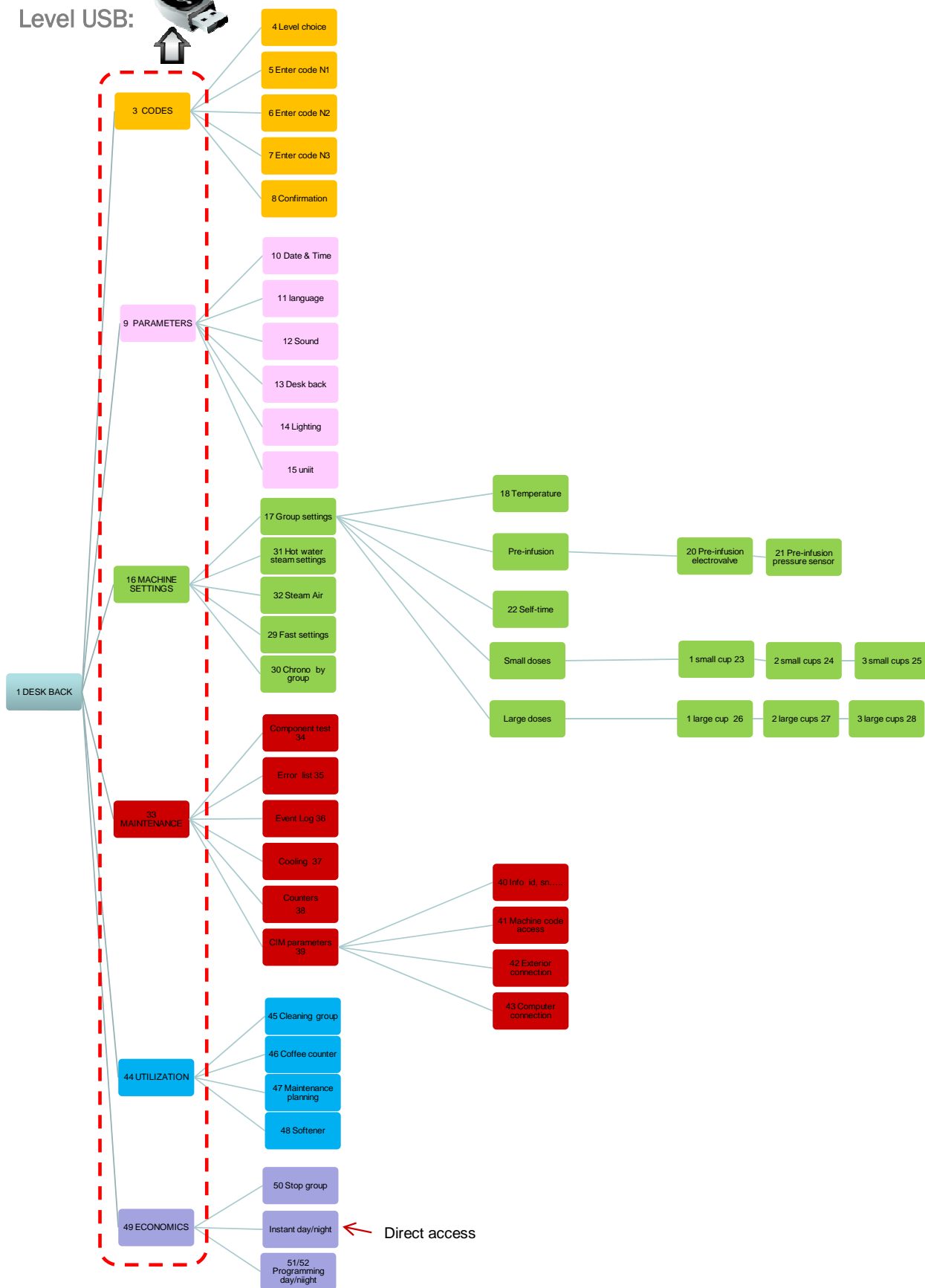

The dotted lines represent the main menu.

Cleaning and maintenance

After each use

Steam outlet tube :

After each use, clean the steam tube with a wet rag and push steam push-button for a short moment to eliminate the small amount of liquid (milk) left inside the tube.

Daily

Before the service or after few hours of inactivity:

Dispense to the drain:

- Through each coffee head and water nozzle 0.5 liter of water.
- Through each steam nozzle some steam for 1 minute.

"BEFORE PREPARING ANY BEVERAGE"

After the service:

Filter holder:

- Empty the filter holder.
- Insert the filter holder in the unit.
- Press the continue key to rinse the filter holder.

Repeat the operation for each filter holder

Decompression circuit:

- Take a filter-holder and remove its filter.
- Place the blind filter inside the filter holder.
- Insert and tight the filter-holder in the unit.
- Turn the unit on to put the filter-holder under pressure, and then stop it. Repeat this operation several times, each time removing the water from the filter-holder.

Repeat the operation for each unit

Filter holder gasket:

- Insert the filter-holder into the unit without tightening it.
- Turn the unit on, at the same time tightening and loosening alternately the filter-holder in order to create a leak at the filter-holder gasket for cleaning.

Repeat the operation for each unit

Weekly

In addition to daily cleaning:

Filter holder:

Remove the filter and wash the filter-holder and the filter in soapy water.

Overflow tray:

Remove the overflow tray to empty it and rinse it under the tap.

Decompression circuit:

Do the daily decompression circuit cleaning adding a detergent tablet into the filter holder and do a pause of 1 minute between 2 cycles but do not remove the water from the filter holder between 2 cycles. Then rinse by repeating several cleaning cycles as long as necessary to eliminate any residual of detergent with a minimum of 3 cycles

Other

Clean the body of the machine using a soft cloth and alcohol for the stainless-steel parts and a non-abrasive detergent for the painted parts.

To prevent scale, do not forget to regenerate your water softener periodically.

If descaling is necessary, the appliance has to be entrusted to manufacturer's service agent or other similar qualified person.

