

## Mythos II Grinder Spec Sheet

### Power Requirements

- Volts: 110 (voltage range of 110-125)
- Watts: 800
- Amp draw: 8
- Receptacle: Nema 5-15
- **Not compatible with GFCI outlets**



Nema 5-15

### Shipping Dimensions & Weight

- Height: 32 inches
- Depth: 12 inches
- Width: 23 inches
- Weight: 60 pounds

### Counter Space Requirements

- Height: 21 inches
- Depth: 17 inches
- Width: 8 inches
- Weight: 53 pounds

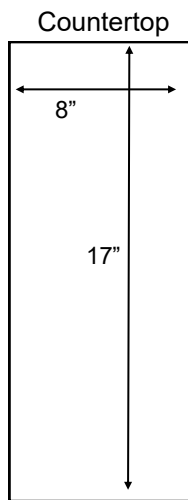

(Front)



NSF / ANSI Std.8

I, the customer, understand that these requirements must be in when the installer arrives. Failure to have the site ready will result in additional service and travel charges, and may cause further delays in installation.

Customer Name: \_\_\_\_\_ Signature: \_\_\_\_\_

Company Name: \_\_\_\_\_

Phone: \_\_\_\_\_ Fax: \_\_\_\_\_ Email: \_\_\_\_\_