



POUR'D

Syrup/Concentrate Dispense

BUILD YOUR BEVERAGE



SAMPLE RECIPE USING POUR'D:

- 1 Add ice to a highball glass.
- 2 Press **Button 1** to dispense 10ml of lemonade syrup + 180ml of water. (automated dilution and pre-set volume)
- 3 Press **Button 2** to add a 10ml shot of raspberry syrup (with no dilution.)
- 4 Top up with ice, mint and a slice of lemon.



Use POUR'D to dispense your choice of syrup-based beverages.

Simply set your ratio of syrup to water and your final desired beverage volume.

Plus, by adding a second control box, you can dispense another (non-diluted) syrup from the same POUR'D font.

This allows you to create a range of beverage options.

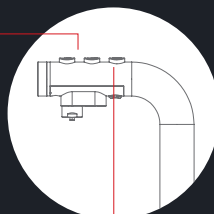

Buttons 1 + 2
Syrup/Concentrate 1*
(*can also be diluted with mains water for RTD beverage)

Button 3
Syrup/Concentrate 2
(cannot be diluted)

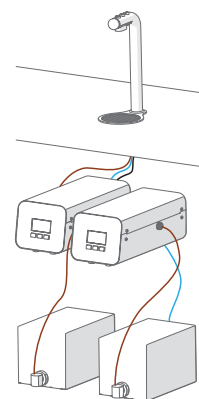

NOTE: When used with two control boxes, the POUR'D font can only dilute **ONE** syrup with water. The other syrup cannot be diluted with water.

www.marcobeveragesystems.com/pourd