



SPRITE AND MIDGET CATALOGUE



SPRITE



MIDGET

EASTLANDS INDUSTRIAL ESTATE, LEISTON, SUFFOLK. IP16 4LL.

TEL: +44 (0) 1728 832880 FAX: +44 (0) 1728 832881

WEBSITE: www.newtoncomm.co.uk

E-MAIL: sales@newtoncomm.co.uk

SPRITE AND MIDGET



NEWTON
COMMERCIAL 
classic car interior trim

Why Buy Newton

With over 40 years of experience, Newton Commercial are world leaders in interior trim, producing high quality products for all your interior upholstery needs. Our expertise and commitment to quality are highlighted by our British Motor Heritage approval and we are the only trimmers in the world with this unique quality status. Using our years of experience and knowledge in the classic car industry, we have developed a complete range of products for the Sprite and Midget models and have been supplying industry leaders within the MG classic car sector for a number of years.

They choose us because of our ability to provide high quality original styled interior trim handcrafted by our team of skilled professionals across our three sites in Suffolk, highlighting British manufacturing at its best. We have sourced original materials, correct to the original colour and grain of those used from the factory, perfect for those who are looking to reupholster their MG in its original glory. All our materials are sourced within the UK, and we pride ourselves on sourcing high quality automotive grade vinyl, leathers and carpets as close as possible to the original materials used in first production. Using original trim, we have researched and developed products that are produced as they were originally. Our panels are made using the correct thickness board, cut to the correct size and shape in our on site Suffolk factory using precision tooling to produce to the same high quality each time. Using our high frequency welding machine, we can create interior trim, exactly as the original Sprite and Midget vehicles to the high quality you expect of British classics. For those who are looking for the complete interior package, we have a team of skilled seat fitters who can refurbish customer supplied seat frames with brand new covers and foams, ensuring quality from beginning to end of your restoration. All our products are available to ship worldwide at competitive rates.

Our aftermarket sales care is second to none and we provide a standard 6 month returns policy on all products returned in their original state. With our expertise and knowledge, we are able to offer technical help for all your purchasing and fitting needs. This catalogue will help you explore our Sprite and Midget range, but our sales team is always on hand for more specific help, quotations, and free material samples. For products that unfortunately don't fit your high expectations our customer service team can help with any issues you may have, using our years of expertise in interior trim from development to production.

Brief History

The Austin-Healey Sprite is a small open sports car which was produced in Britain from 1958 to 1971. The Sprite was announced to the press in Monte Carlo by the British Motor Corporation on 20 May 1958, two days after that year's Monaco Grand Prix and subsequently enjoyed considerable competition success due to its exceptional handling. It was intended to be a low-cost sports car for a similar price of a Morris Minor, and with its distinctive Frogeye initial design became an instant hit. The Sprite was designed by the Donald Healey Motor Company and was unique for a sports car of the period in that it used a single chassis. Production was undertaken at the MG factory at Abingdon. It first went on sale at a price of £669, using a tuned version of the Austin A-Series engine and as many other components from existing cars as possible to keep production costs down.

When the MKII Sprite was introduced in 1961 it was joined by the MG version, the Midget. Enthusiasts often refer to these later Sprites and Midgets collectively as "Spridgets." The MG-badged version of the Sprite continued in production for several years after the Austin-Healey brand ceased to exist.

The MG Midget is a small two-seater sports car produced by MG from 1961 to 1979. The first version, announced at the end of June, 1961, was essentially a slightly more expensive version of the MKII Austin-Healey Sprite which meant that the Mark for the Midget will always be one behind the Sprite models. Many existing MG buyers turned to the Sprite to provide a modern low-cost sports car and so a MG version reusing the Midget name made sense. The new Midget differed from the Sprite only in its grille design, badging, and colour options and with the option of both leather seats and more external chrome trim as standard to justify its higher purchase price yet still using the same classic design that was well loved by sports car owners throughout the world.

SPRITE AND MIDGET



Suffolk Seats



Our range of Suffolk complete seats are the perfect option for those looking to add all the features and comfort of a modern seat that still fits with the classic styling of the Sprite and Midget. Our Suffolk seats as standard come with fully removable headrests and are fitted with a reclining mechanism and supplied mounted onto sliders for the perfect driving position for all users. Made in our Suffolk factory by our team of experienced seat trimmers as a complete bolt in option with all fixings included, these are available in both plain or perforated leather faced or in all vinyl in a range of colour combinations with your choice of piping colour, suitable for a variety of restorations.

DISTANCE BETWEEN SEAT SLIDE HOLE CENTRES

EARLY TYPE = 13 3/4" (349mm)

LATE TYPE = 15 1/8" (384mm)

EARLY TYPE	PART NUMBER	DESCRIPTION
	S922	LH LEATHER
	S923	RH LEATHER
	S928	LH VINYL
	S929	RH VINYL
	S930	LH PERF LEATHER
	S931	RH PERF LEATHER

LATE TYPE	PART NUMBER	DESCRIPTION
	S920	LH LEATHER
	S921	RH LEATHER
	S924	LH VINYL
	S925	RH VINYL
	S926	LH PERF LEATHER
	S927	RH PERF LEATHER



Complete Seat Refurbishment



For those looking to retain the classic simplicity of the Sprite and Midget range but wanting to use the experience of our skilled seat fitting team, we offer a complete seat refurbishment service. From customer seats supplied, we would remove the old components, sandblast and professionally respray the frames and then rebuild with new foams, diaphragms and seat covers made by our skilled professionals in our Suffolk factory. We can arrange collection of seat frames within the UK and as with all our products we are able to ship completed seat refurbishments worldwide. Upon receipt seats will be ready to bolt straight in, better than new.

DISTANCE BETWEEN SEAT SLIDE HOLE CENTRES

EARLY TYPE = 13 3/4" (349mm)

LATE TYPE = 15 1/8" (384mm)

PART NUMBER	DESCRIPTION	SEAT COVERS USED IN KIT
S201	VINYL 58-61 FROGEYE	SC201
S203	VINYL 64-66	SC203
S204	VINYL 67-68	SC204
S205	VINYL 1969 ONLY	SC205
S206	VINYL 1970 ON	SC206
S789	LEATHER 67-68	SC204
S792	LEATHER 1970 ON	SC206



SPRITE AND MIDGET



Car Identification

AUSTIN-HEALEY SPRITE

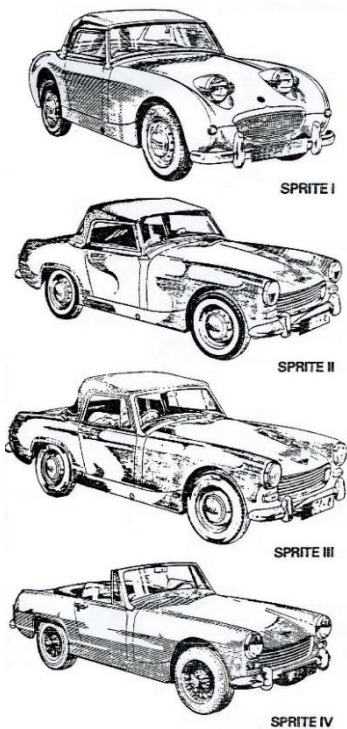

Model		Commencing	Finishing
Sprite Mark I (Frogeye)	Engine No. Car No.	9C/U/H101 AN5-501	9C/U/H49201 AN5-50116
Sprite Mark II	Engine No. {	9CG/ { $\begin{matrix} \text{Da/H} \\ \text{Da/L} \end{matrix} $ } 101	9CG/ { $\begin{matrix} \text{Da/H} \\ \text{Da/L} \end{matrix} $ } 36711
	Car No. {	10CG/ { $\begin{matrix} \text{Da/H} \\ \text{Da/L} \end{matrix} $ } 101	10CG/ { $\begin{matrix} \text{Da/H} \\ \text{Da/L} \end{matrix} $ } 21048
Sprite Mark III	Engine No.	10CC/Da/H101	10CC/Da/H16300
	Car No. Body No.	H/AN8-38829 ABL 030580	H-AN8-64734 Not available
Sprite Mark IV	Engine No. {	12CC/Da/H101	12CC/Da/H16300
	Car No. {	12CE/Da/H101	
	H-AN9 Body No. H-AN10 Body No.	H-AN9-64735 H-AN10-85287 ABL 055500 ABL 064518	H-AN9-85286 H-AN10-86403 Not available
Austin Sprite Mark IV	Engine No. Car No. Body No.	12CE/Da/H101 A-AN10-86804 Not available	Not available A-AN10-87824 Not available

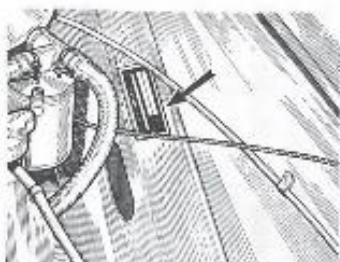

← WHERE TO FIND YOUR CAR NUMBER.

WHERE TO FIND YOUR ENGINE NUMBER. →

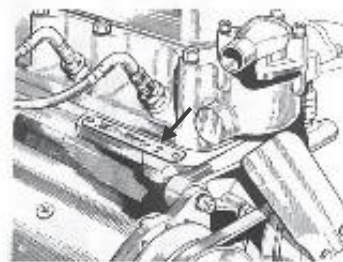

M.G. MIDGET

Model		Commencing	Finishing
Midget Mark I	Engine No. {	9CG/ { $\begin{matrix} \text{Da/H} \\ \text{Da/L} \end{matrix} $ } 101	9CG/ { $\begin{matrix} \text{Da/H} \\ \text{Da/L} \end{matrix} $ } 36711
	Car No. {	10CG/ { $\begin{matrix} \text{Da/H} \\ \text{Da/L} \end{matrix} $ } 101	10CG/ { $\begin{matrix} \text{Da/H} \\ \text{Da/L} \end{matrix} $ } 21048
Midget Mark II	Engine No.	10CC/Da/H101	10CC/Da/H16300
	Car No. Body No.	G-AN3-25788 GBE 025654	G-AN3-52389 GBE 052153
Midget Mark III	Engine No. {	12CC/Da/H101	Not available
	Car No. {	12CE/Da/H101	
	G-AN4 Body No.	12V/586F/101	
	G-AN5 Body No. {	12V/588F/101	
Midget 1500	Engine No.	FP001-E	Not available
	Car No.	G-AN4-52390	
	Body No.	G-AN5-74886 GBE 052400 GBE 064374 GBE 100101	

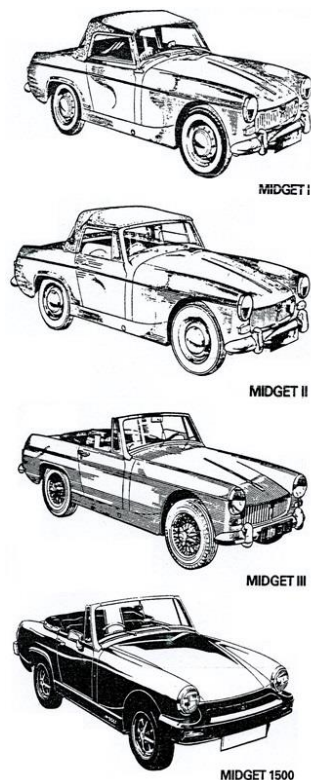

SPRITE AND MIDGET



NEWTON
COMMERCIAL 
classic car interior trim

Sprite MK.I Frogeye Model: AN5

1958-61

Engine 948cc

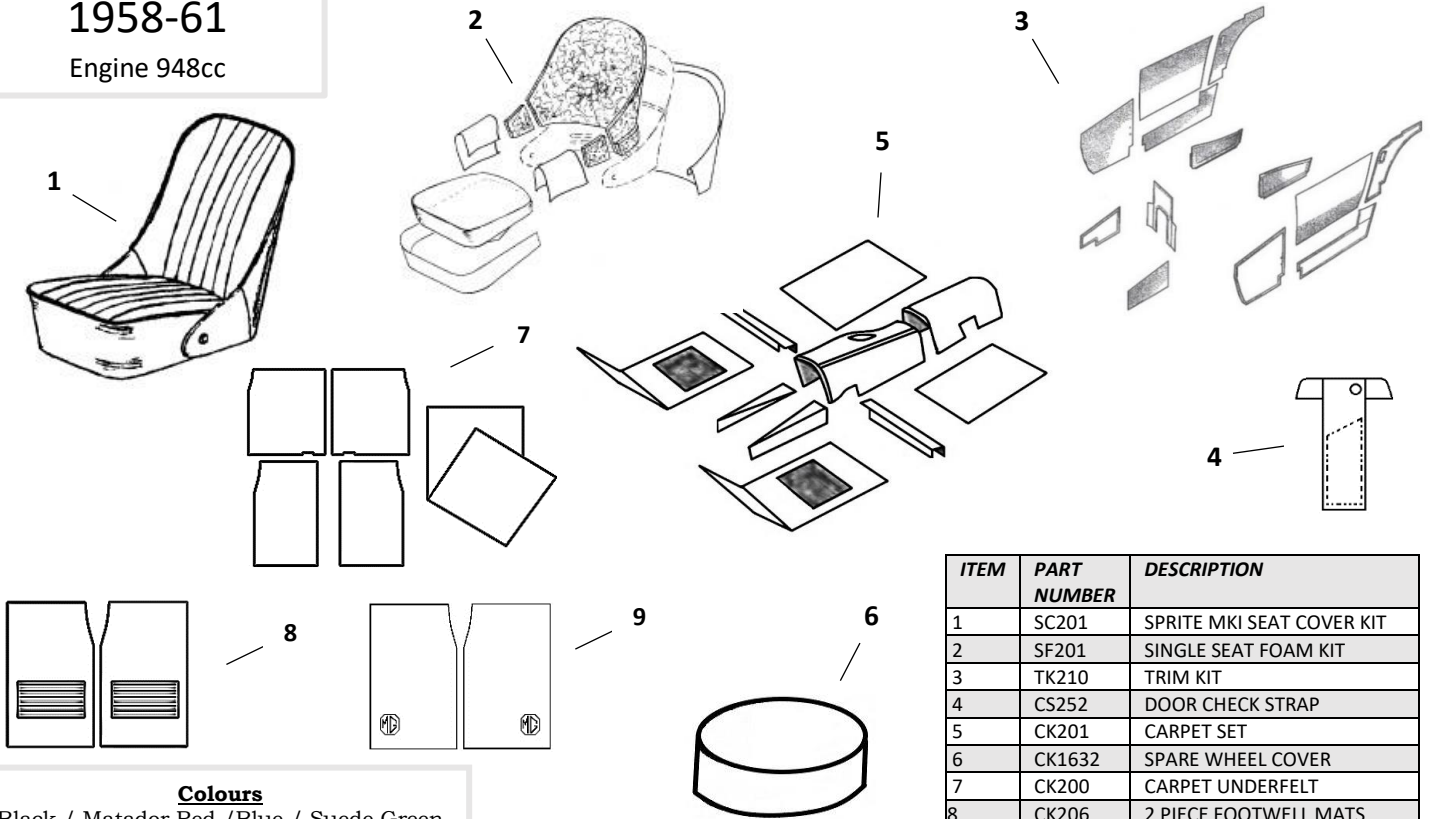

ITEM	PART NUMBER	DESCRIPTION
1	SC201	SPRITE MKI SEAT COVER KIT
2	SF201	SINGLE SEAT FOAM KIT
3	TK210	TRIM KIT
4	CS252	DOOR CHECK STRAP
5	CK201	CARPET SET
6	CK1632	SPARE WHEEL COVER
7	CK200	CARPET UNDERFELT
8	CK206	2 PIECE FOOTWELL MATS
9	CK214	2 PIECE OVERMATS

Colours

Black / Matador Red / Blue / Suede Green

(With alternative piping available on seat covers)

Sprite MK.II Model: H-AN-6

1961-62

Engine 948cc

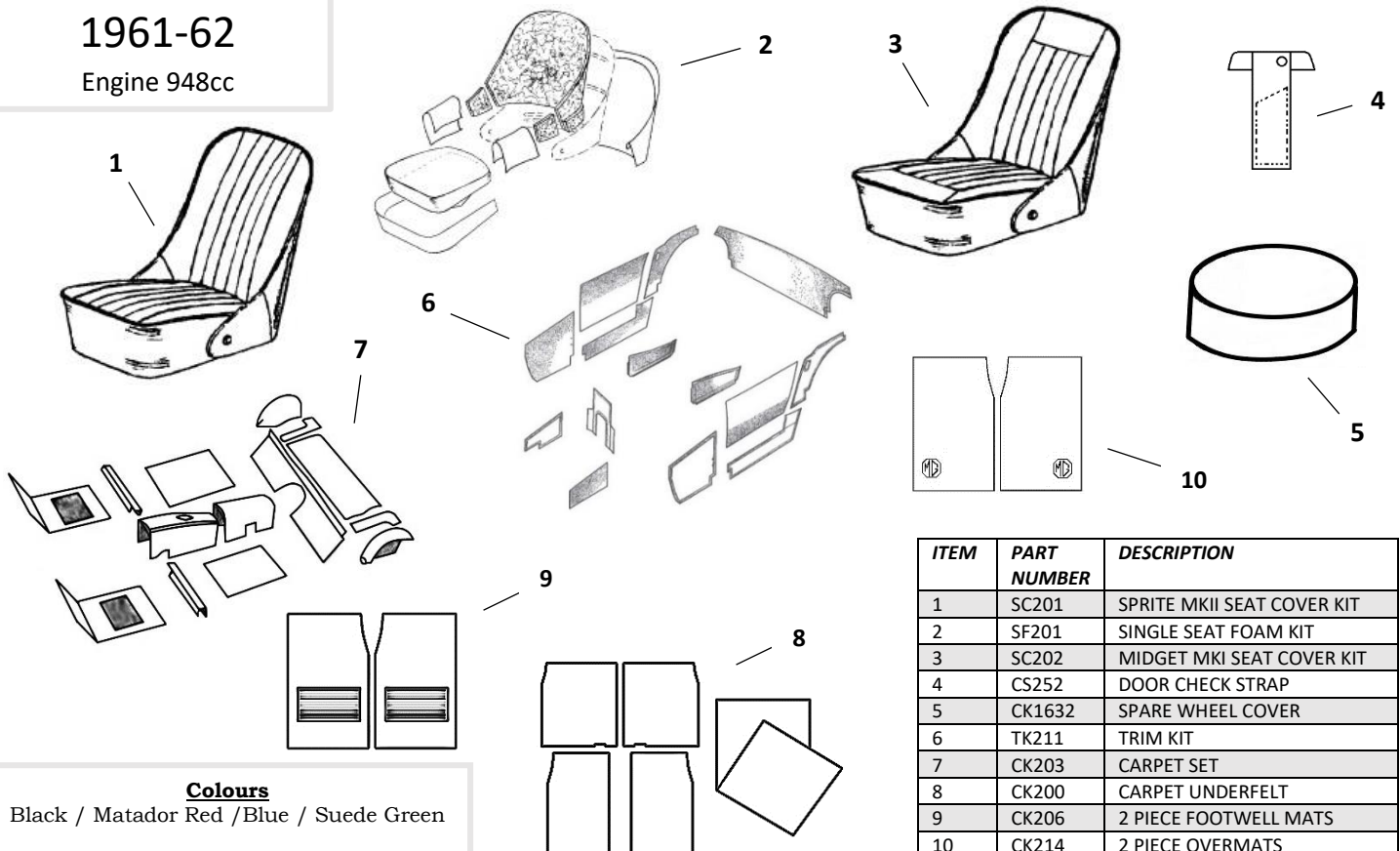

ITEM	PART NUMBER	DESCRIPTION
1	SC201	SPRITE MKII SEAT COVER KIT
2	SF201	SINGLE SEAT FOAM KIT
3	SC202	MIDGET MKI SEAT COVER KIT
4	CS252	DOOR CHECK STRAP
5	CK1632	SPARE WHEEL COVER
6	TK211	TRIM KIT
7	CK203	CARPET SET
8	CK200	CARPET UNDERFELT
9	CK206	2 PIECE FOOTWELL MATS
10	CK214	2 PIECE OVERMATS

Colours

Black / Matador Red / Blue / Suede Green

(With alternative piping available on seat covers)

Midget MK.I Model: G-AN-1

SPRITE AND MIDGET



NEWTON
COMMERCIAL 
classic car interior trim

Sprite MK.II Model: H-AN-7

Midget MK.I Model: G-AN-2

1962-64

Engine 1098cc

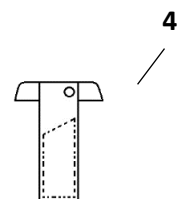
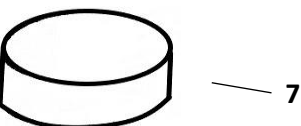
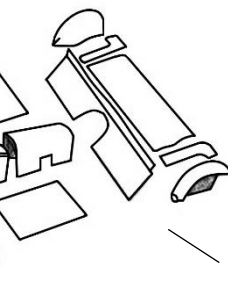
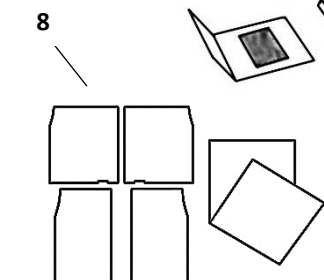
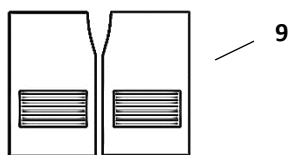
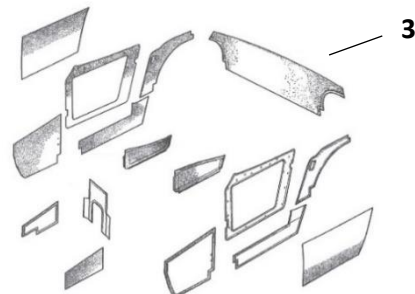
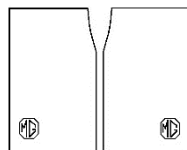
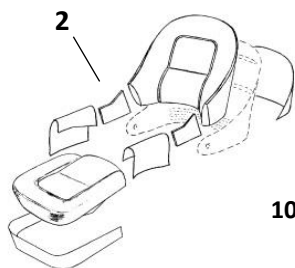
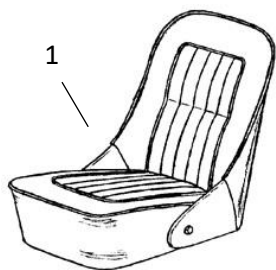

ITEM	PART NUMBER	DESCRIPTION
1	SC203	SPRITE MKII + MIDGET MKI SEAT COVER KIT
2	SF203	SINGLE SEAT FOAM KIT
3	TK209	TRIM KIT
4	CS252	DOOR CHECK STRAP
5	CHA455	GEAR LEVER GAITER
6	CK203	CARPET SET
7	CK1632	SPARE WHEEL COVER
8	CK200	CARPET UNDERFELT
9	CK206	2 PIECE FOOTWELL MATS
10	CK214	2 PIECE OVERMATS

Colours

Black / Matador Red / Cornflower Blue

(With alternative piping available on seat covers)

Sprite MK.III

1965-66 sprite only
H-AN-8 = 55501 to 64734. Not used on Midget MK2

Midget MK.II

1964-66 - All Midget MK2 and Early Sprite MK3
H-AN-8 = 38829 to 55500 / G-AN-3 = 25788 to 52389

1964-66

Engine 1098cc

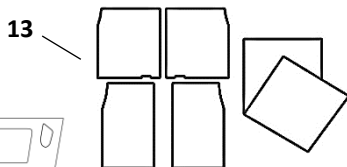
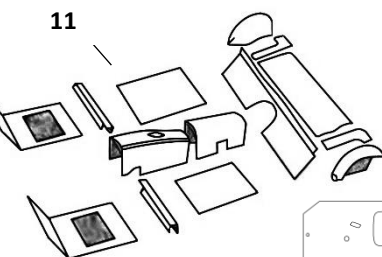
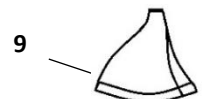
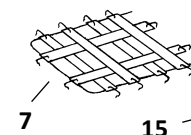
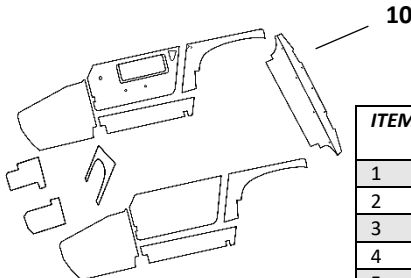
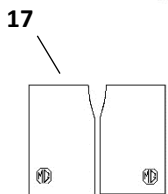
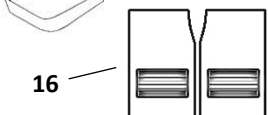
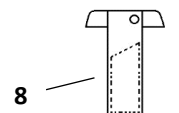
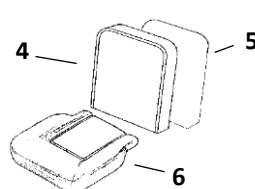
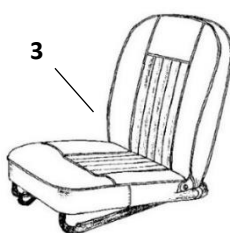
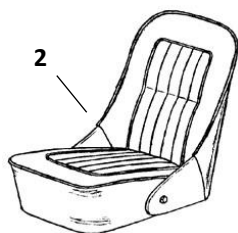
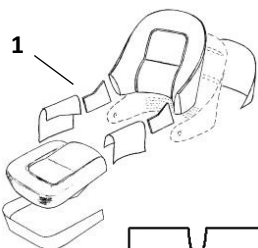

ITEM	PART NUMBER	DESCRIPTION
1	SF203	SINGLE SEAT FOAM KIT
2	SC203	SPRITE MKIII SEAT COVER KIT
3	SC204	MIDGET MKII SEAT COVER KIT
4	SF071	SQUAB FOAM
5	SBB3008	SQUAB BACKBOARD
6	SF204	BASE FOAM
7	AHA9928	BASE DIAPHRAGM
8	CS252	DOOR CHECK STRAP
9	CHA455	GEAR LEVER GAITER
10	TK212	TRIM KIT (SEE ACCESSORIES PAGE FOR INDIVIDUAL PANELS)
11	CK203	CARPET SET
12	CK1632	SPARE WHEEL COVER
13	CK200	CARPET UNDERFELT
14	DL225	DOOR LINER 64-69
15	DC245	DOOR TOP COVER KIT
16	CK206	2 PIECE FOOTWELL MATS
17	CK214	2 PIECE OVERMATS

COLOURS

Black/White / Red/White / Blue/White

CARPET - Black / Navy / Autumn Leaf / Red

SPRITE AND MIDGET



NEWTON
COMMERCIAL 
classic car interior trim

Sprite MK.IV Model: H-AN-9

Midget MK.III Model: G-AN-4

1967-68

Engine 1275cc

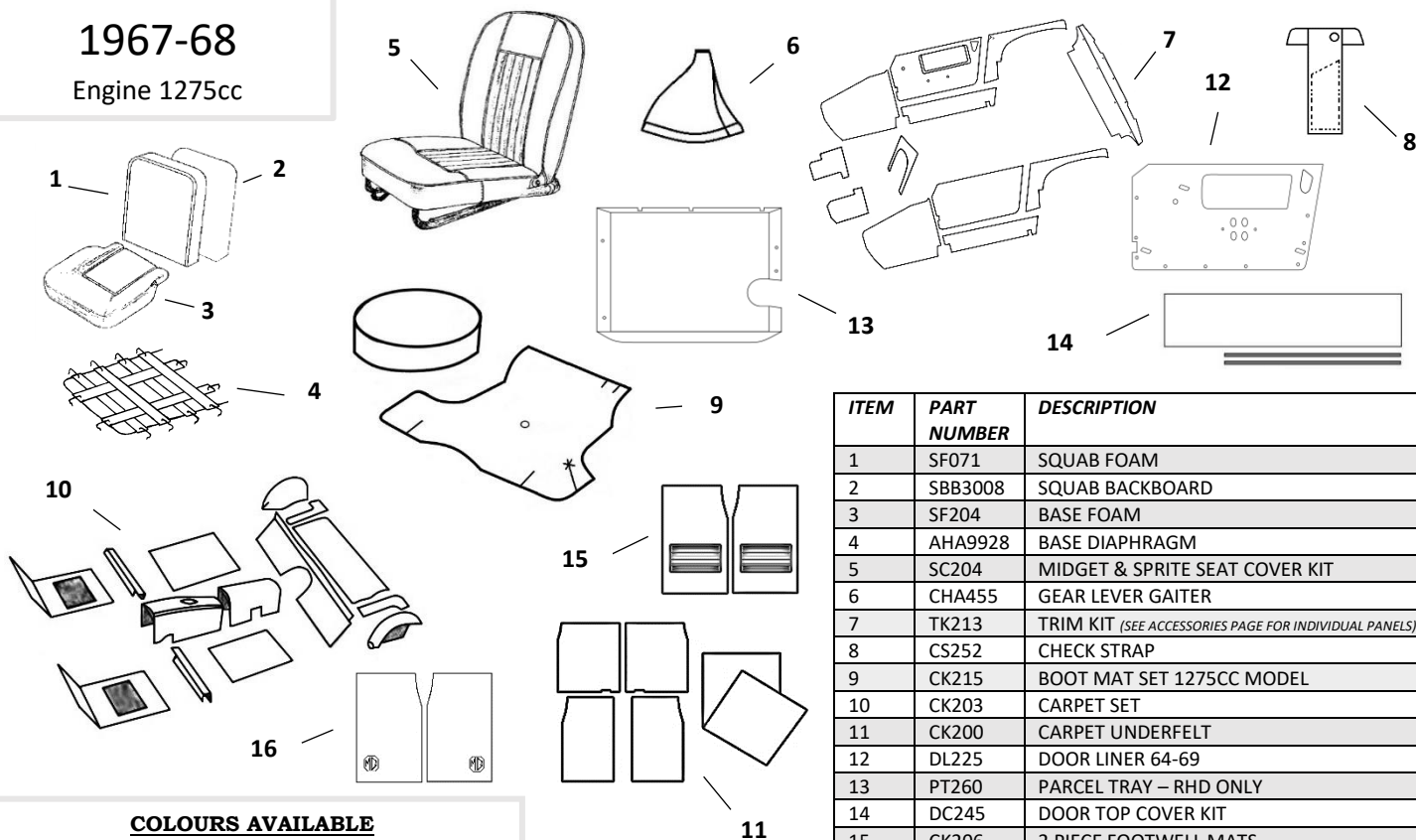

ITEM	PART NUMBER	DESCRIPTION
1	SF071	SQUAB FOAM
2	SBB3008	SQUAB BACKBOARD
3	SF204	BASE FOAM
4	AHA9928	BASE DIAPHRAGM
5	SC204	MIDGET & SPRITE SEAT COVER KIT
6	CHA455	GEAR LEVER GAITER
7	TK213	TRIM KIT (SEE ACCESSORIES PAGE FOR INDIVIDUAL PANELS)
8	CS252	CHECK STRAP
9	CK215	BOOT MAT SET 1275CC MODEL
10	CK203	CARPET SET
11	CK200	CARPET UNDERFELT
12	DL225	DOOR LINER 64-69
13	PT260	PARCEL TRAY - RHD ONLY
14	DC245	DOOR TOP COVER KIT
15	CK206	2 PIECE FOOTWELL MATS
16	CK214	2 PIECE OVERMATS

COLOURS AVAILABLE

Black/White Red/White Blue/White

CARPET - Black / Navy / Autumn Leaf / Red

Sprite MK.IV Model: G-AN-4 - 66226 to 74885

Midget MK.III Model: H-AN-9 - 77591 to 85286

1969 ONLY

Engine 1275cc

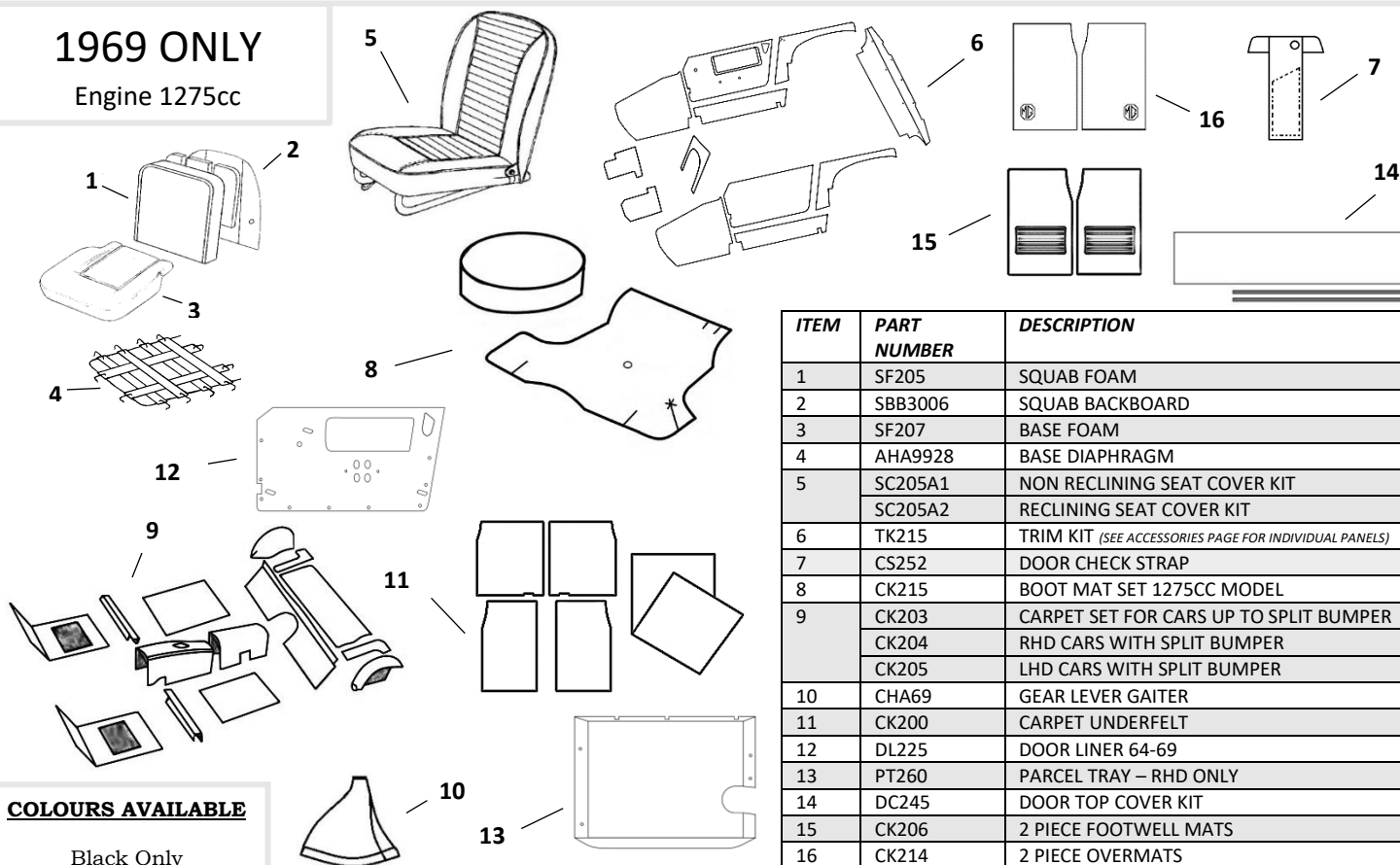

ITEM	PART NUMBER	DESCRIPTION
1	SF205	SQUAB FOAM
2	SBB3006	SQUAB BACKBOARD
3	SF207	BASE FOAM
4	AHA9928	BASE DIAPHRAGM
5	SC205A1	NON RECLINING SEAT COVER KIT
	SC205A2	RECLINING SEAT COVER KIT
6	TK215	TRIM KIT (SEE ACCESSORIES PAGE FOR INDIVIDUAL PANELS)
7	CS252	DOOR CHECK STRAP
8	CK215	BOOT MAT SET 1275CC MODEL
9	CK203	CARPET SET FOR CARS UP TO SPLIT BUMPER
	CK204	RHD CARS WITH SPLIT BUMPER
	CK205	LHD CARS WITH SPLIT BUMPER
10	CHA69	GEAR LEVER GAITER
11	CK200	CARPET UNDERFELT
12	DL225	DOOR LINER 64-69
13	PT260	PARCEL TRAY - RHD ONLY
14	DC245	DOOR TOP COVER KIT
15	CK206	2 PIECE FOOTWELL MATS
16	CK214	2 PIECE OVERMATS

COLOURS AVAILABLE

Black Only

SPRITE AND MIDGET



NEWTON
COMMERCIAL 
classic car interior trim

Midget MK.III

Model: H-AN-10 and A-AN -10

Sprite MK.IV

Model: G-AN-5

Midget 1500

Model: G-AN-6

1970-1980

Engine 1275cc & 1500cc

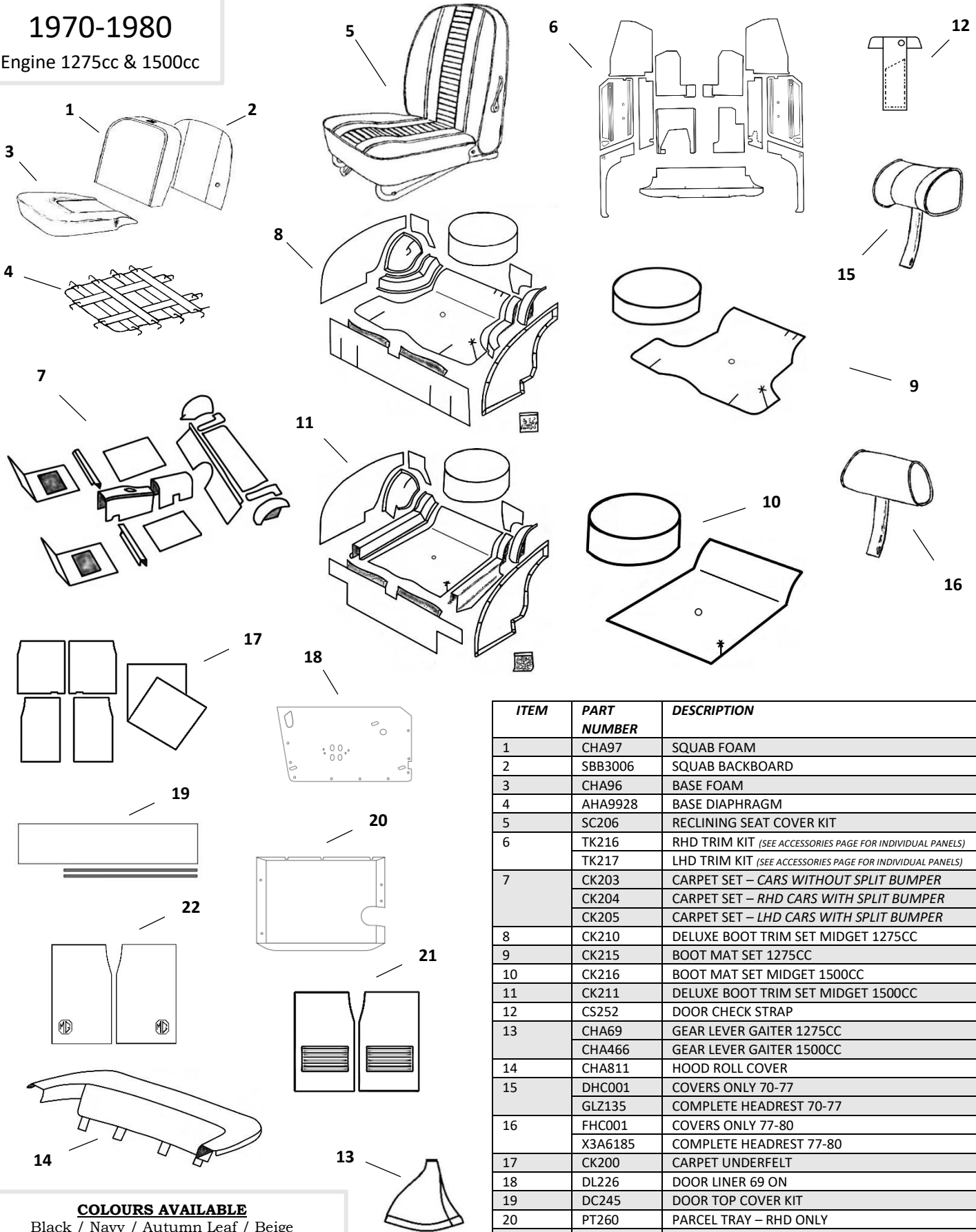

ITEM	PART NUMBER	DESCRIPTION
1	CHA97	SQUAB FOAM
2	SBB3006	SQUAB BACKBOARD
3	CHA96	BASE FOAM
4	AHA9928	BASE DIAPHRAGM
5	SC206	RECLINING SEAT COVER KIT
6	TK216	RHD TRIM KIT (SEE ACCESSORIES PAGE FOR INDIVIDUAL PANELS)
	TK217	LHD TRIM KIT (SEE ACCESSORIES PAGE FOR INDIVIDUAL PANELS)
7	CK203	CARPET SET - CARS WITHOUT SPLIT BUMPER
	CK204	CARPET SET - RHD CARS WITH SPLIT BUMPER
	CK205	CARPET SET - LHD CARS WITH SPLIT BUMPER
8	CK210	DELUXE BOOT TRIM SET MIDGET 1275CC
9	CK215	BOOT MAT SET 1275CC
10	CK216	BOOT MAT SET MIDGET 1500CC
11	CK211	DELUXE BOOT TRIM SET MIDGET 1500CC
12	CS252	DOOR CHECK STRAP
13	CHA69	GEAR LEVER GAITER 1275CC
	CHA466	GEAR LEVER GAITER 1500CC
14	CHA811	HOOD ROLL COVER
15	DHC001	COVERS ONLY 70-77
	GLZ135	COMPLETE HEADREST 70-77
16	FHC001	COVERS ONLY 77-80
	X3A6185	COMPLETE HEADREST 77-80
17	CK200	CARPET UNDERFELT
18	DL226	DOOR LINER 69 ON
19	DC245	DOOR TOP COVER KIT
20	PT260	PARCEL TRAY - RHD ONLY
21	CK206	PAIR OF FOOTWELL MATS
22	CK214	2 PIECE OVERMATS

COLOURS AVAILABLE

Black / Navy / Autumn Leaf / Beige

CARPET - Black / Navy / Autumn Leaf / Red



SPRITE AND MIDGET

Accessories - Individual Trim Kit Items

1964-1969

ITEMS FROM A TK212, TK213 AND TK215

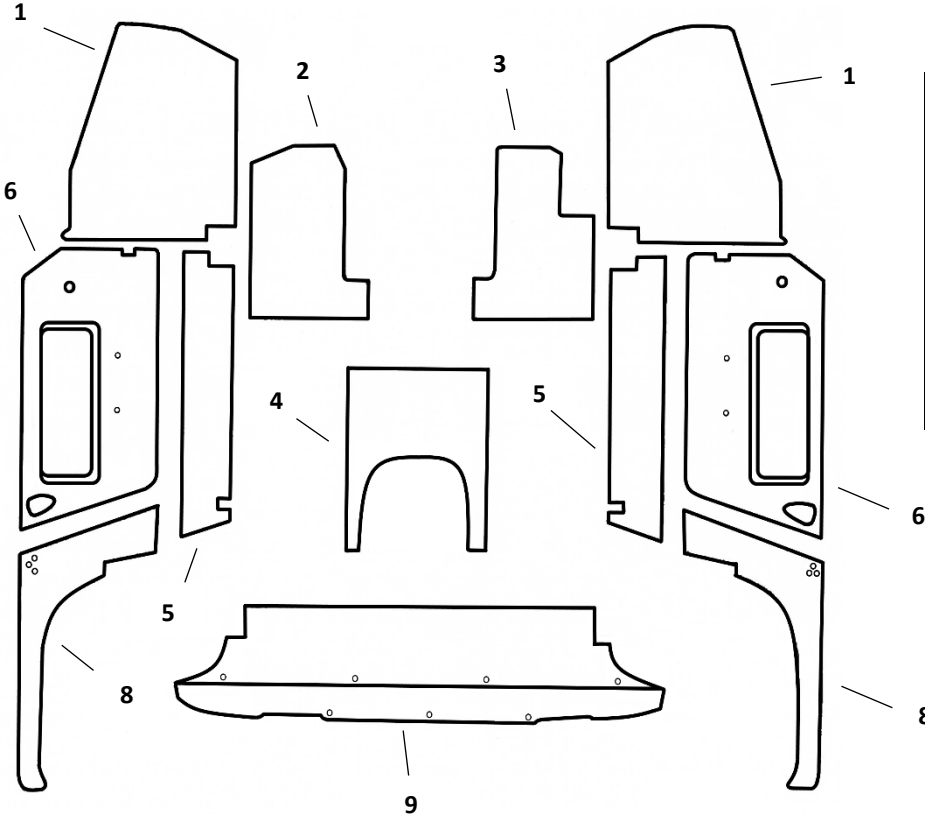

ITEM	PART NUMBER	DESCRIPTION
1	FL236	64-69 SCUTTLES
2	FL238	64-69 LH TUNNEL SIDE
3	FL239	64-69 RH TUNNEL SIDE
4	FL237	64-69 TUNNEL FRONT
5	SL251	64-69 SILL LINER
6	DP223	64-69 DOOR PANEL
7	WA243	64-66 WHEEL ARCH PANEL
8	WA244	67-69 WHEEL ARCH PANEL
9	CP237	COCKPIT PANEL <small>(WHITE PIPE AS USED IN TK212 AND TK213 - 61-64)</small>
	CP238	COCKPIT PANEL <small>(SELF COLOURED PIPE AS USED IN TK215 - 64-69)</small>

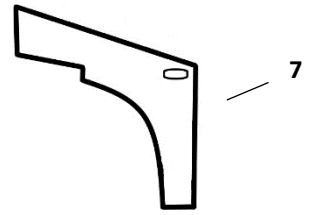

1969 ON

ITEMS FROM A TK216 AND TK217

ITEM	PART NUMBER	DESCRIPTION
1	FL240	69 ON SCUTTLES
2	FL242	69 ON TUNNEL SIDE
3	FL243	69 ON RH1 TUNNEL SIDE
4	FL241	69 ON TUNNEL FRONT
5	FL244	69 ON RH2 TUNNEL SIDE
6	FL245	LHD TUNNEL SIDE LATE
7	SL250	69 ON SILL LINER
8	DP244	69 ON DOOR PANEL
9	WA245	69 ON WHEEL ARCH PANEL
10	CP239	69 ON COCKPIT PANEL <small>(WELDED DESIGN)</small>

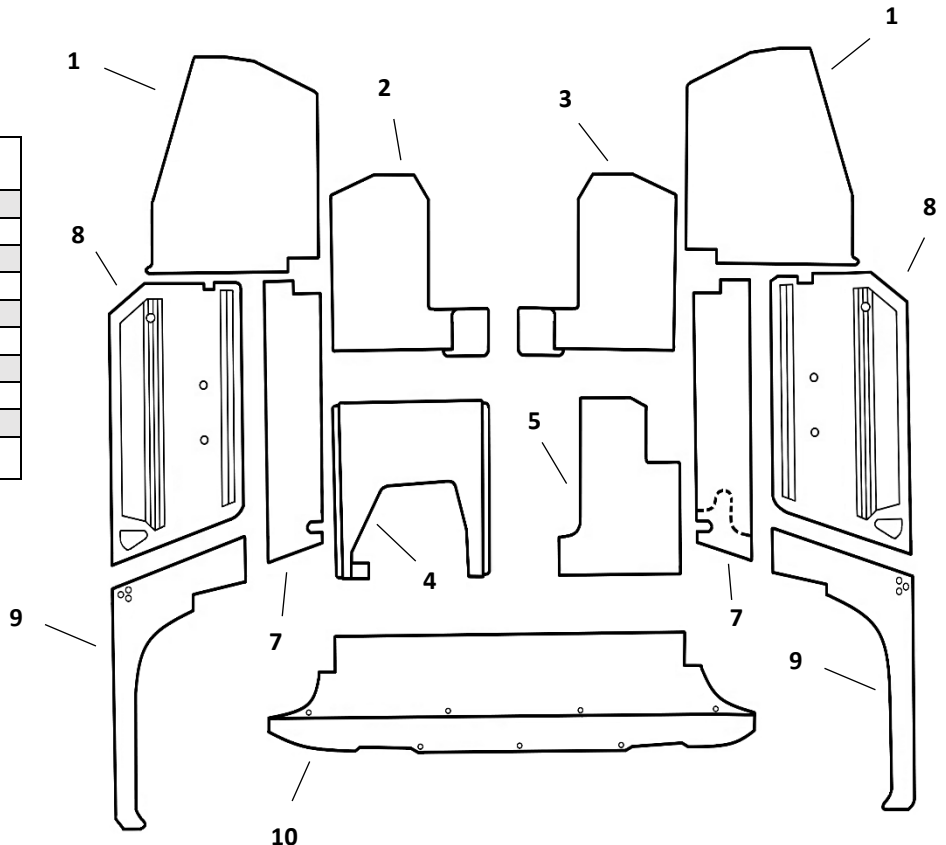
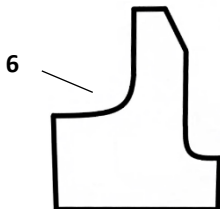

SPRITE AND MIDGET



Accessories - Continued

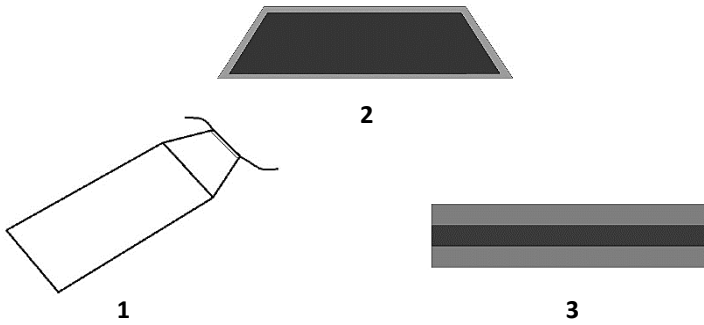

ITEM	PART NUMBER	DESCRIPTION
1	AHA8324	HOOD BAG IN GREY TWILL
2	AHA9054Q1	VELCRO HOOD / BODY PLATE
3	AHA9055Q1	VELCRO HOOD / BODY NO PLATE

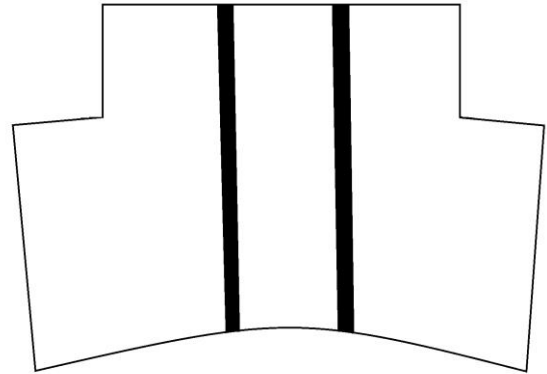

CK753 MIDGET 5 SPEED TUNNEL CARPET

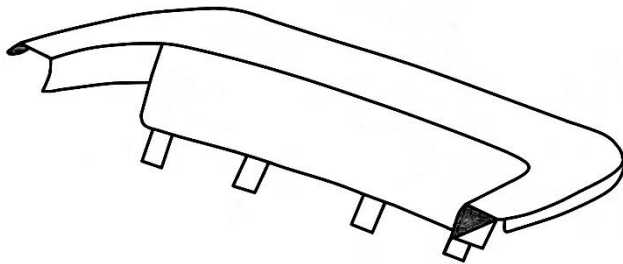

CHA811 HOOD COVER

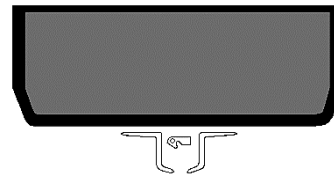

1

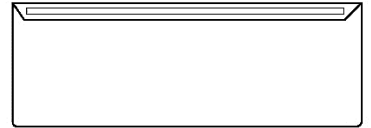

2

ITEM	PART NUMBER	DESCRIPTION
1	VT8021	MIDGET WINDSTOP
2	VT8022	MIDGET WINDSTOP BAG

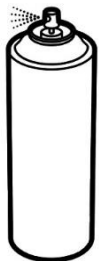

1



2

ITEM	PART NUMBER	DESCRIPTION
1	CK990	SPRAY GLUE <small>(UK ONLY)</small>
2	C707	PACK OF 20 SEAT CLIPS

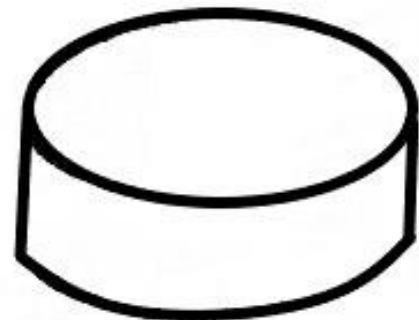

PART NUMBER	DESCRIPTION
VWC102	VINYL SPARE WHEEL COVER INNER
VWC104	VINYL SPARE WHEEL COVER OUTER



ARE YOU AWARE THAT **NEWTON COMMERCIAL** ALSO PRODUCES INTERIOR TRIM FOR THE FOLLOWING VEHICLES?

CLASSIC MINI

MORRIS MINOR

MG T – TYPE

MGB

MGA

MGF

MG MIDGET

A.H. SPRITE

TRIUMPH TR2 - 3

TRIUMPH TR4 – 6

TRIUMPH HERALD

TRIUMPH VITESSE

TRIUMPH SPITFIRE

TRIUMPH GT6

VW CLASSIC BEETLE

VW TYPE 2 VAN

VW TYPE 25 VAN

VW TYPE 4 VAN

VW KARMANN GHIA

VW GOLF MK 1 & MK11

VW SCIROCCO MK1 & 11

VW CORRADO

LOTUS ELAN 62 – 73

PORSCHE

MX5

FORD ESCORT & CAPRI

PEUGEOT

DAIMLER

PLUS MANY OTHERS!

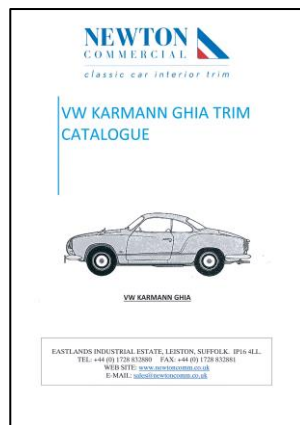
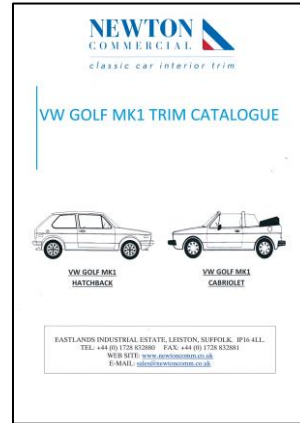
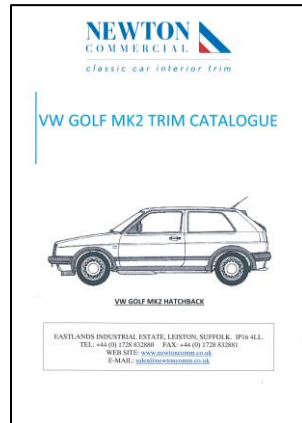

PLEASE VISIT OUR WEBSITE OR CONTACT OUR SALES TEAM FOR INFORMATION, CATALOGUES, COLOUR SAMPLES AND PRICES.

EASTLANDS INDUSTRIAL ESTATE, LEISTON, SUFFOLK. IP16 4LL.
TEL: +44 (0) 1728 832880 FAX: +44 (0) 1728 832881
WEBSITE: www.newtoncomm.co.uk
E-MAIL: sales@newtoncomm.co.uk



NEWTON
COMMERCIAL 
classic car interior trim

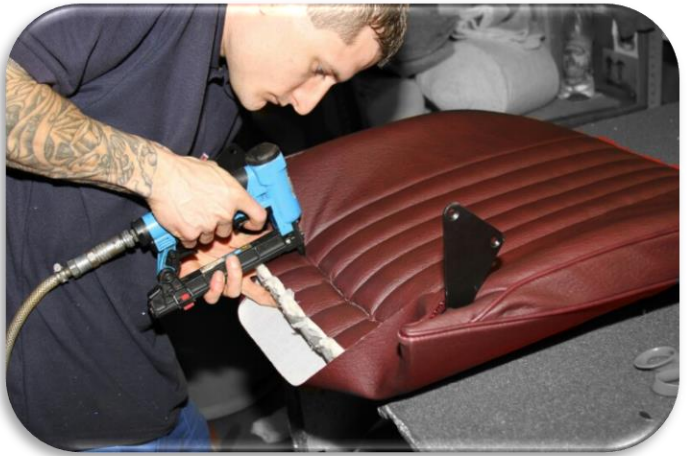

Newton Commercial
Eastlands Ind Estate,
Leiston, IP16 4LL

TEL: +44(01728) 832880

sales@newtoncomm.co.uk

www.newtoncomm.co.uk