

MINI A-POST LINERS
PART NUMBER DT3080 FITTING INSTRUCTIONS

1) We will first look at fitting the RH A-Post Liner.

2) Open the RH door and pull the draught excluder away from the A-Post area next to the front screen.

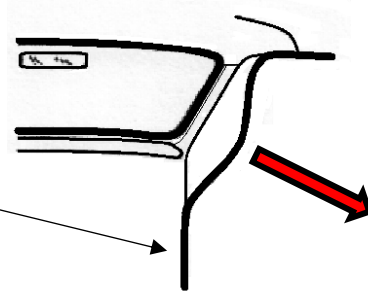

3) Select the RH Liner

BOTTOM

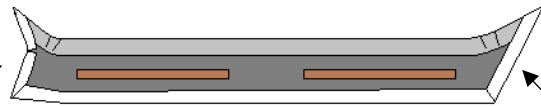

REAR VIEW SHOWN

TOP

4) Next carry out a 'dry run', offer the liner into position by pushing the straight front edge fully into the corner, up against the rubber window seal and against the metal of the A-post itself. The bottom shaped edge should sit firmly against the dash top.

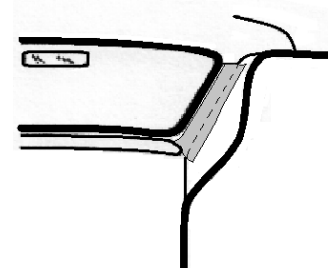

5) You will see from the 'dry run' that the top & bottom ends of the liner need to be slightly bent in order to sit properly against the metal; As shown right.

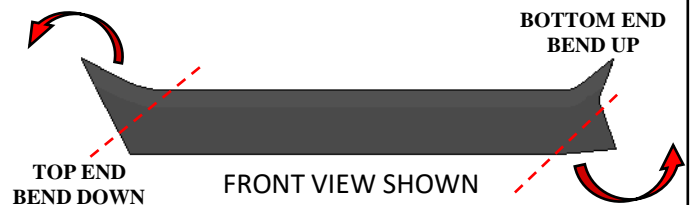

6) Peel off backing from the double-sided tape on the rear of the liner. Re-fit the liner in the same way as in the 'dry run', trying not to allow the tape to stick to the metal until it is correctly positioned. When satisfied that all is correct, push the centre portion of the liner firmly

7) Fold the flap of the liner over the edge of the door opening, (Some contact adhesive may be used here to keep it in place) trim off any excess then push the draught excluder back into position.

8) Repeat this procedure for the LH A-Post.

The job is now complete.

HAPPY MOTORING.

