

How to use

1

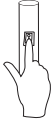

Turn the power switch ON.

2

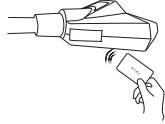

Swipe the RF-Card under the control panel, to start to set the correct time.

3



Increase the time by 1 minute intervals by using your right hand up or down next to the control panel as shown in the picture.

4



Decrease the time by 1 minute intervals by moving your left hand up or down next to the control panel as shown in the picture.

5



After the correct time is set, you can start the treatment by pressing the start button on top of the control panel.

How to use the Control Panel with the remote >>>

Use the BLUE LEDs for a wavelength of 470 nm

Increase the time by 1 minute intervals

Press the start button to start the treatment after setting the correct time



Use the RED LEDs for a wavelength of 640 nm

Decrease the time by 1 minute intervals

Press the fan for extra cooling

TECHNICAL SPECIFICATIONS:
Type: Single arm mounted Teeth Whitening Light
Extension arm: 80 cm
Special Feature: Infrared operated controls with dual light spectrum
Wavelength: 475 nm – 640 nm options
Power supply: 100v – 240v.
Fixing: Bayonet screw poles, steel arm and aluminum wheelbase
Test Symbol: UL
Mark of conformity: CE
GENERAL SPECIFICATIONS:
Temp Rise @ Patients Head Area - < 2 degrees C
Life Cycle Of LEDs – 25,000+ hours
Light Source – LED (light emitting diode)
LED Power – 36 Watts

FEATURES:
Multi Lens Matrix
Ultra-Violet Free Light
16 Points of Light
Flexible Steel Goose Neck Arm
Touch-Free Adjustable Operating Times
Remote Control Functions
Adjustable Light Spectrum
ELECTRICAL:
Voltage (input) – 100v AC – 240v AC. 50-60Hz
Voltage (output) – 12V DC
WARRANTY:
1 Year Parts

ADAE teeth whitening unit



Discover the most sophisticated accelerator light ever build

Introducing ADAE new teeth whitening light

Through extensive research in LED lighting and oral hygiene we present to you our White Diamond – a step forward in oral hygiene and teeth whitening efficiency.

The White Diamond with its Blue LED and Red LED wavelengths are able to accelerate teeth whitening gels for increased whitening results and help cure gum disease, through the elimination of harmful bacteria.

Weighing in at a substantial 15 kilograms, this light also has the specification statistics that meet or exceed all lights available on the dental equipment market today.

Infrared sensors

Using Infrared sensors for touch-free time adjustment makes treatments easier and prevents cross contamination, for optimum hygiene efficiency.

Blue LEDs

Blue LED wavelength of 475nm – accelerates teeth whitening gels and kills plaque.

Red LEDs

RED LED wavelength of 640nm – heals sore gums, reduces redness and increases blood flow to the area.



Whiter teeth in minutes	The finest LEDs for a brighter light	Flawless teeth whitening results	Proven success
-------------------------	--------------------------------------	----------------------------------	----------------

How to assemble



Assembly Steps:

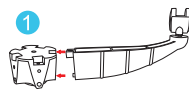
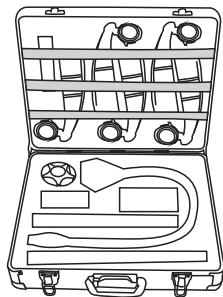

Viewing the bottom of the wheel arm and the wheel base, as shown to the left, insert the wheel arm into the wheel base.

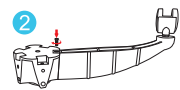

Fix the wheel base and wheel arm together with the supplied screw, and tighten with a hex wrench in a clockwise direction.



Assemble and fix the other four wheel arms to the wheel base as in steps 1 and 2.

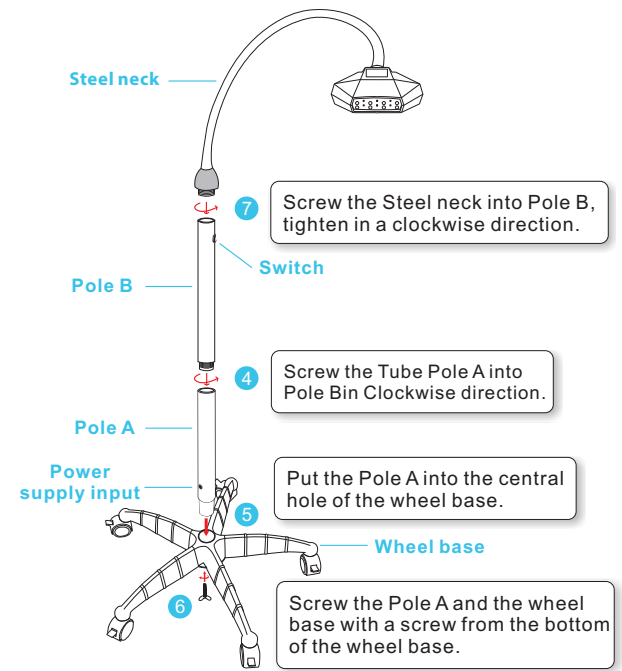

How to install dental unit >>>

Appendix:

① Dental chair pole ② Rubber protective strip ③ Main unit part ④ Part ⑤ Bolts ⑥ Light

Assemble the machine by following the steps shown in the picture.

1. Start with the protective strip ②, wrap it around the pole ①.
2. Put parts ③ and ④ into its correct position according to the picture.
3. Put the bolts ⑤ through the holes in part ④ and tighten the bolts into the main unit part ③.
4. Attach the light ⑥ to main part ③, screw clockwise to tighten.

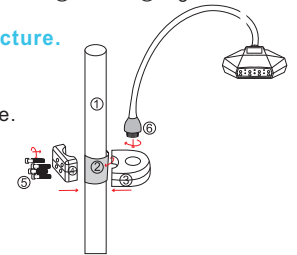

How to install spa model >>>

Appendix:

① Screw ② Light Connection ③ Clamp ④ Clamp Screw ⑤ Light

Assemble the machine by following the steps shown in the picture.

1. To secure the clamp to a table or specific area. Move the clamp ③ into position; tighten the clamp screw ④ clockwise to secure the clamp into place.
2. Once in place, insert the light connection ② into the top of the secured clamp. Tighten the screw ① clockwise to secure the light connection ② into the lamp ③.
3. Screw the light ⑤ into light connection ②, clockwise to tighten.

