

SCAN TO WATCH



or go to this link to watch [www.bit.ly/shower-arm-installation](http://www.bit.ly/shower-arm-installation)

INSTALLATION INSTRUCTIONS

1. Remove existing shower head and clean the shower arm pipe.

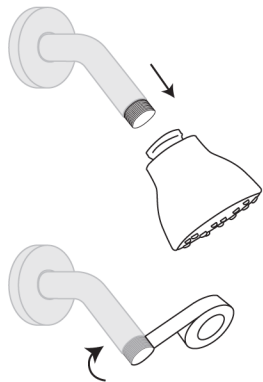

2. Wrap existing shower arm pipe with provided thread seal tape. At least 3 wraps, clockwise.

3. Slightly loosen the wing nut on the female connector side, pull the connector away from the wing nut and rotate it 180 degrees so it point outwards. *(Do not remove wing nuts.)*

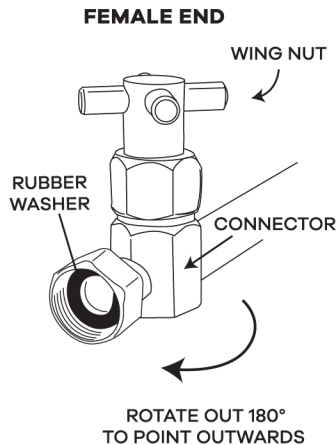

4. Push the connector back in and tighten the wing nut back down.

5. With the rubber washer seated inside the female connector, hand-tighten it the shower arm pipe. Ensure you hold the arm in its upright position and only rotate the female connector when tightening, not the entire adjustable arm.

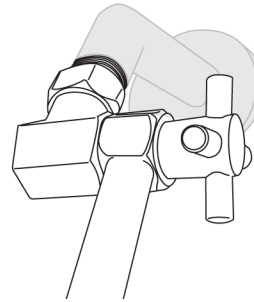

6. Finish tightening with an adjustable wrench. The adjustable arm should be upright and in alignment with the shower arm pipe.

7. Once fully tightened by hand and with a wrench, tighten each set screw on the female nut to lock into place.

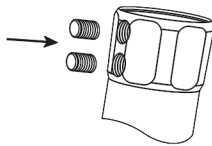

8. Slightly loosen the wing nut on the male connector side, pull the connector away from the wing nut and rotate it 180 degrees so it points outwards. *(Do not remove wing nuts.)*

9. Push the connector back in and tighten the wing nut back down.

10. Install your shower head!

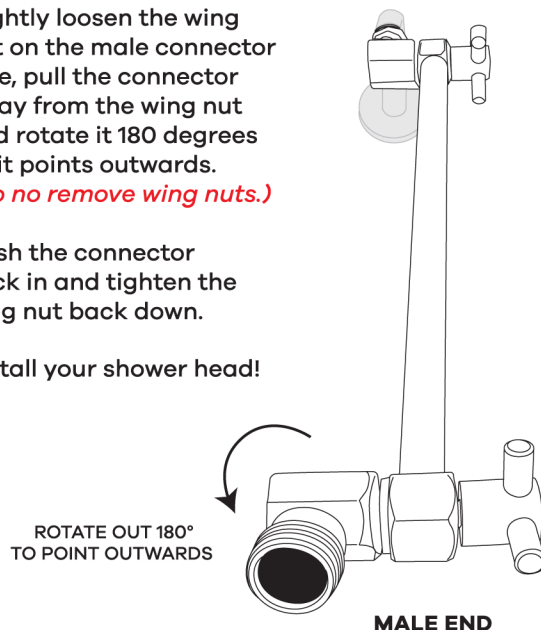

ADJUST ARM UP or DOWN

1. Slightly loosen the wing nut near the shower arm pipe. *(Do not remove wing nuts.)*
2. Pull the shower arm away from the female connector to disengage the gears. (Should be a fingernail-sized gap between the two fittings.)
3. Adjust the arm up or down to find your ideal position.
4. Push the arm back in with the gears lined up to reengage the gears.
5. Tighten the wing nut back down.

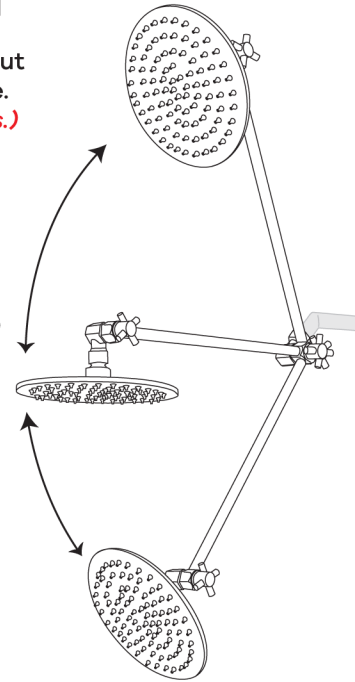

ADJUST SHOWER HEAD ANGLE

1. Slightly loosen the wing nut near the shower head. *(Do not remove wing nuts.)*
2. Pull the shower head away from the wing nut to disengage the gears. Should be a fingernail-sized gap between the two fittings.)
3. Adjust the shower head to find your ideal position.
4. Push the shower head back in with the gears lined up to re-engage the gears.
5. Tighten the wing nut back down.

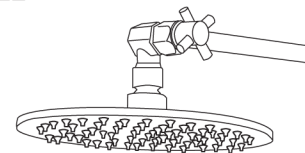

**NEED HELP?**  
 Contact us now: 854-888-9231  
[contact@hammerheadshowers.com](mailto:contact@hammerheadshowers.com)