

## ACCESSORIES & SPARES

The comprehensive Webley Tri pump kit also contains spares which should be kept safe for servicing your pump for it's product lifetime. The spare seals kit is to facilitate future repairs by competent airgun repairer with experience working with airgun stirrup pumps.

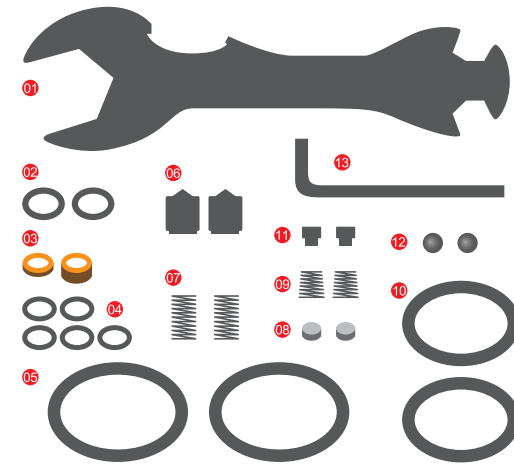

<b>01-special spanner</b> .....	1 pc
<b>02-high pressure stem sealing ring</b> .....	2 pcs
<b>03-high pressure piston ring</b> .....	2 pcs
<b>04-O-ring</b> .....	5 pcs
<b>05-outer tube piston ring</b> .....	2 pcs
<b>06-check valve</b> .....	2 pcs
<b>07-check valve spring</b> .....	2 pcs
<b>08-sealing gasket of bleed valve</b> .....	2 pcs
<b>09-high pressure piston spring</b> .....	2 pcs
<b>10-low pressure piston ring</b> .....	2 pcs
<b>11-high pressure spool valve</b> .....	2 pcs
<b>12-inlet hole one-way seal ball</b> .....	2 pcs
<b>13-allen spanner</b> .....	1 pc



HIGH PRESSURE  
PUMP



# ACCUPUMP

## HIGH PRESSURE PUMP



Instruction Manual

## SPECIFICATIONS

- 1- **Length:**630mm Closed,1100mm Open
- 2- **Weight:**2.4kg
- 3- **Max. Pressure:** 310 BAR, 4100psi or 31 MPa
- 4- **Webley Tri-Filter system™**
- 5- **Pump designed for continual use up to 2 hours based on 200bar**
- 6- **Output nut:**M10x1,**Quick connector:**8mm and **1/8 BSP connector**
- 7- **Quality Liquid Filled Pressure Gauge**
- 8- **Folding Base Plate**

## NOMENCLATURE

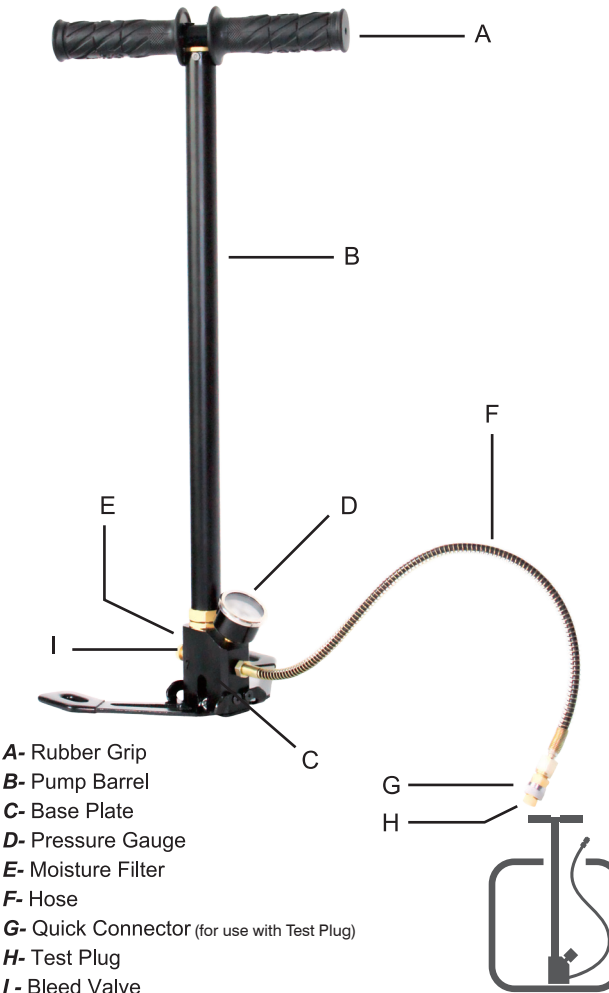

- A-** Rubber Grip
- B-** Pump Barrel
- C-** Base Plate
- D-** Pressure Gauge
- E-** Moisture Filter
- F-** Hose
- G-** Quick Connector (for use with Test Plug)
- H-** Test Plug
- I-** Bleed Valve

## ASSEMBLY

The Webley Accupump comes ready assembled and only requires the connector supplied with your gun to be attached to the hose connections. Please ensure all connections are tight.

## OPERATIONS

- 1- Read this manual fully before attempting to operate this Airgun filling system
- 2- Attach the fill nozzle provided with your PCP Air rifle to one of the adaptors supplied. Make sure your connection is tightened up correctly.
- 3- Check the bleed valve is tightened.
- 4- Place your feet comfortably on the base plate extensions. Grip the handles firmly.
- 5- Start pumping slowly by raising the handles as far as possible, then pushing down firmly to your original position. Continue pumping until you've reached the stated fill pressure in your airguns manual.
- 6- Before disconnecting the pump from your airgun you must bleed the air remaining in the hose, to do this unscrew the bleed valve anticlockwise, you will hear air escaping through the system. You can now remove your fill nozzle from the gun.
- 7- Continuously bleed the moisture trap when filling larger capacity airguns.

## WARNINGS & MAINTENANCE

- 1- This pump is designed for filling PCP air rifles only.
- 2- If possible use your pump in low moisture environments
- 3- The spare seal kits is for the use of a competent airgun repairer with experience working with airgun stirrup pumps.
- 4- Do not pump continually for more than 5 minutes and leave the pump for 15 minutes After each pumping period loosen the bleed valve so that excessive heat / moisture will be expelled. The ideal method of using this pump is to top up after approximately 50 shots. This will allow the pump to cool down and will increase the longevity of the seals. Pump Slowly and deliberately stopping at end of the top stroke and the end of the bottom stroke, this allows the air flow through the system correctly. This pump compresses in both directions, it is important that both strokes are completed fully.
- 5- As the pumping effort increases use your body weight to assist pump on the down stroke. It is recommended that the pump should be cleaned and lubricated, lubrication should be applied lightly on the cylinder visible when the pump is extended. Only use silicon grease.

- 6- Make sure you always unscrew the bleed valve before you disconnect your PCP otherwise seals on the fill nozzle will get damaged, this process also removes moisture from the system.
- 7- Do not exceed the maximum fill pressure recommended for your PCP air rifle.
- 8- Only use the pump on firm, level, non slip surfaces.
- 9- Do not use this pump if you have a physical illness or condition that could be affected by using this pump.
- 10- Never attempt to dismantal or modify this pumping system in any way, always observe this instruction manual.
- 11- Attempting to disassemble, abuse or modification of the pump will immediately invalidate the warranty.
- 12- Never dismantle the pump, in the event of a problem Contact your dealer.
- 13- The pump is equipped with a particle filter that might need replacement after a long periods of use.
- 14- Make sure that all conectors, adaptors and airhoses are in good order before using this pump.
- 15- Compressed air is dangerous never apply compressed air to the skin or direct it at a person. Even air at a pressure of 15 psi can cause serious injury.

## PRESSURE CHECK

- 1- To check that this pump is working correctly first put the supplied brass test plug into the 8mm quick fill connection. Open the bleed valve and cycle the pump 20 times.
- 2- Tighten the bleed valve, cycle the pump up to 100 bar then open the bleed valve to release the compressed air.
- 3- Repeat stage two, this time up to 200 bar, wait for two minutes and check that the pressure remains the same (200 bar)

This shows the system is working correctly

## ONE YEAR WARRANTY

Webley Accupumps are manufactured to the highest standards using the finest materials to give a lifetime of service In the unlikely event of there being a defect within one year of purchase, Webley undertakes to repair or replace the pump (at Webley's discretion). Warranty is only valid for the original purchaser and cannot be transferred the subsequent owners. Warranty must be registered to be valid.

Register your warranty, view all conditions and see all Webley and Webley and Scott's products at:

[www.webley.co.uk](http://www.webley.co.uk)