

WEBLEY PRECISION AIRGUNS



WEBLEY
VMXTM
CO₂ AIR PISTOL

VMXTM PISTOL USER MANUAL

WARNING: Not a toy. Adult supervision required. Misuse or careless use may cause serious injury or death. Always wear eye protection when using this airgun. This airgun is intended for use by those 18 years of age or older. May be dangerous up to 275m/301yds. **READ ALL INSTRUCTIONS BEFORE USING.**

WARNING: Do not brandish or display this airgun in public; it may confuse people and may be a crime. Police and others may think it is a firearm. Do not change the coloration or markings to make it look more like a firearm - that is dangerous and may be a crime. **IMPORTANT:** adult supervision required. Must be 18 years of age or older to purchase. Buyer and user have the duty to obey all laws regarding the use and ownership of this airgun.



www.webley.co.uk
sales@webley.co.uk



WARNINGS

Not a toy adult supervision required misuse or careless use may cause serious injury or death. Always wear eye protection when using this airgun. This airgun is intended for use by those 18 years of age or older.

THE BASIC SAFETY RULES

1. Treat every pistol as if it is loaded.
2. Never point a pistol at anyone, or allow anyone to point a pistol at you even if you think it is not loaded.
3. Always carry the pistol so that the direction of the muzzle is under control, even if you stumble.
4. Always be sure of your target and what lies behind it, before you squeeze the trigger.
5. Never leave a loaded pistol unattended.
6. Beware of targets which tend to cause ricochets.

Keeping to these rules will ensure safe and enjoyable sport with your new air pistol.

THE LAW

**KNOW THE LAW ON AIRGUNS AND OBEY IT.
ACT RESPONSIBLY, ACT SAFELY AND ENJOY YOUR SHOOTING!**

PELLET VERSION

Always use quality .177 & .22 airgun pellets. Never use any damaged, tarnished or previously used pellets



KNOW YOUR AIRGUN

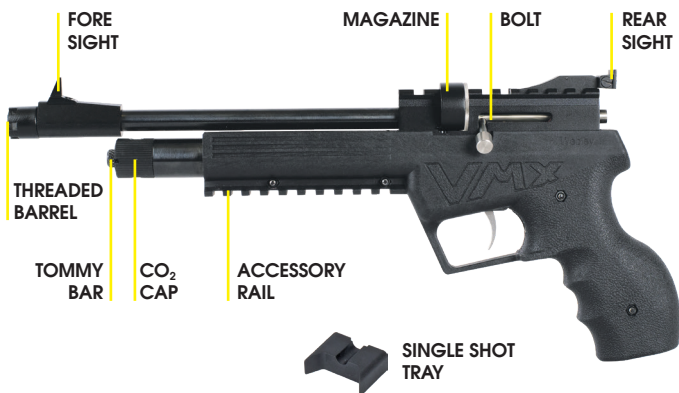

LOADING INSTRUCTIONS

Loading a 12 gram CO₂ Capsule

To load the CO₂ capsule remove the CO₂ cap by twisting it anti-clockwise. The Tommy Bar can be unscrewed from the front of the Cap and used to lever the Cap off if its on too tight.

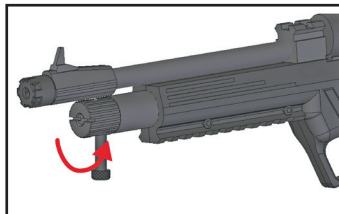

Place the CO₂ capsule in the tube, refit the end cap and tighten quickly. Add a small amount of silicon grease to the tip of the CO₂ capsule to extend seating seal life.

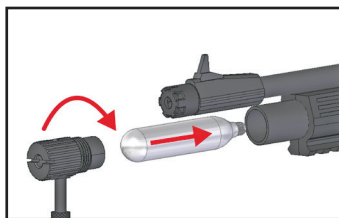

Note. When storing your pistol remove the CO₂ capsule.

LOADING INSTRUCTIONS

Single Shot Tray

Pull the bolt to its rear position. Place the pellet into the trough in the Single Shot Tray Dome or Flat head forward. Push the bolt forward and lock in position.

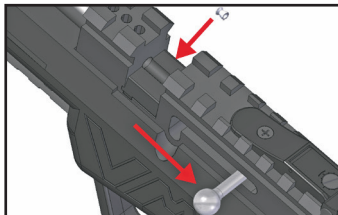

Magazine

Rotate the transparent faceplate anticlockwise until it stops. Keeping tension on the faceplate, insert a pellet skirt first through the front end of the magazine. This will lock the internal spring in place. Rotate the faceplate to the next empty chamber and place pellets in nose first through the faceplate.

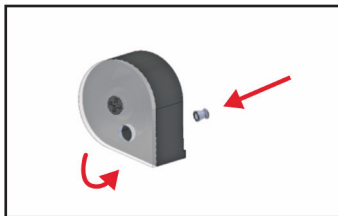

LOADING INSTRUCTIONS

Using the Magazine

Pull the bolt back and remove the Single Shot Tray, push the Magazine from the left side of the gun until it clicks.

Push the bolt fully forward and you are ready to fire.

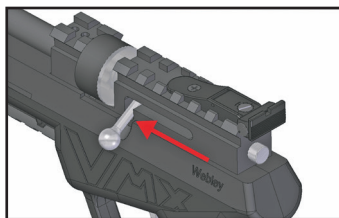
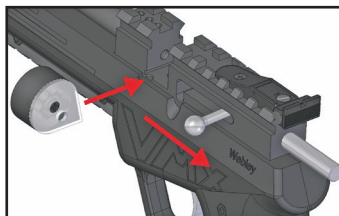

SIGHT ADJUSTMENTS

Adjusting the Rear Sight

All adjustments for windage and elevation are made by adjusting the rear sights. By turning screw 1 clockwise you move your grouping downwards. By turning screw 2 clockwise, you will move your grouping towards the right.

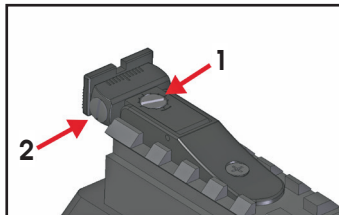

As you turn screw 2, you must do the opposite to screw 3 for every turn.

Try to take at least 3 shots between adjustments to achieve a precise grouping.

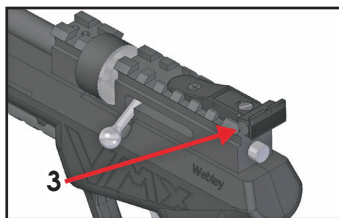

WEBLEY PRECISION AIRGUNS



WEBLEY
VMX[™]
CO₂ AIR PISTOL



www.webley.co.uk
sales@webley.co.uk